

ROUTE NO.	SECTION	CITY	TOTAL SHEETS	SHEET NO.
STEVENS CREEK BIKEWAY	99-P4000-00-BT	DECATUR PARK DIST	145	1
FED. ROAD DIST. NO.	ILLINOIS	PROJECT	TE-00D7(27)	

STATE OF ILLINOIS
DEPARTMENT OF TRANSPORTATION
PLANS FOR
PROPOSED LOCAL AGENCY IMPROVEMENT
ILLINOIS FIRST PROJECT

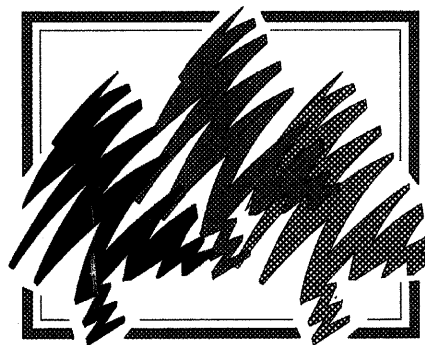

Decatur Park District

STEVENS CREEK BIKEWAY - PHASE I

SECTION 99-P4000-00-BT
PROJECT TE - 00D7 (27)
C - 97 - 024 - 07
MACON COUNTY, ILLINOIS

Station Equation
Sta. 416+11.61 BK=
Sta. 415+64.77 AHD

Sta. 378+69.23 BK=
Sta. 400+00.00 AHD

Sta. 260+26.38 BK=
Sta. 300+00.00 AHD

Sta. 117+81.82 BK=
Sta. 200+00.00 AHD

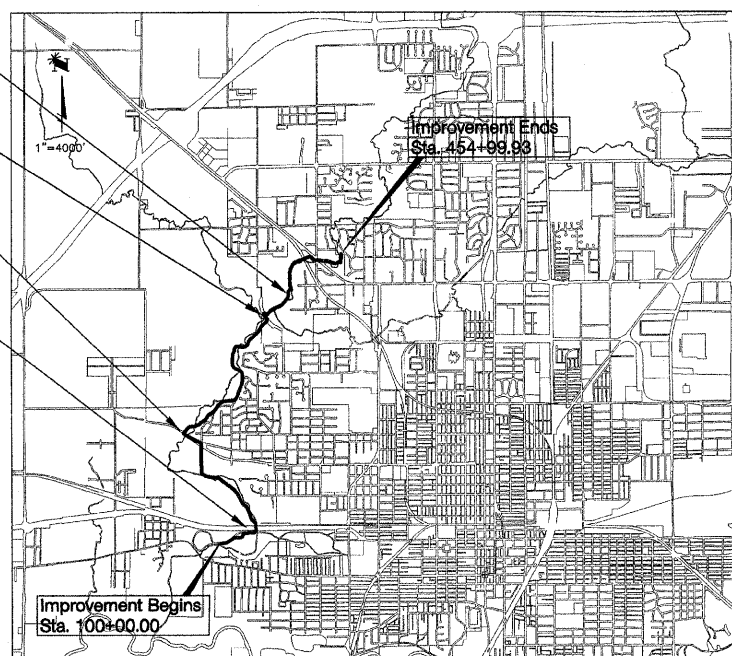

LOCATION MAP
TOTAL LENGTH OF IMPROVEMENT = 21,224.20 FEET = 4.019 MILES
NET LENGTH OF IMPROVEMENT = 21,158.19 FEET = 4.007 MILES
DESIGN DESIGNATION

INDEX TO SHEETS
SEE SHEET NO. 2

I.D.O.T. STANDARDS

- 280001-05 TEMPORARY EROSION CONTROL SYSTEMS
- 285001-02 FABRIC FORMED CONCRETE REVETMENT MATS
- 424001-05 CURB RAMPS FOR SIDEWALKS
- 542301-02 PRECAST REINFORCED CONCRETE FLARED END SECTION
- 542311-01 GRATING FOR CONCRETE FLARED END SECTION
- 542401-01 METAL END SECTIONS FOR PIPE CULVERTS
- 602301-02 INLET, TYPE A
- 602401-02 MANHOLE, TYPE A
- 602601-02 PRECAST REINFORCED CONCRETE FLAT SLAB TOP CONCRETE CURB, TYPE B AND COMBINATION CONCRETE CURB AND GUTTER
- 630001-08 STEEL PLATE BEAM GUARDRAIL
- 631011-06 TRAFFIC BARRIER TERMINAL, TYPE 2
- 701901-01 TRAFFIC CONTROL DEVICES
- 720001-01 SIGN PANEL MOUNTING DETAILS
- 720006-02 SIGN PANEL ERECTION DETAILS
- 720011-01 METAL POSTS FOR SIGNS, MARKERS & DELINEATIONS
- BLR 14-10 PCC PAVEMENT (NONREINFORCED)

UTILITIES

UTILITY	LOCATION	COORDINATE
AMEREN IP	500 S. 27TH STREET DECATUR, IL 62521	800.892.7715
SBC	990 SOUTHSIDE DRIVE DECATUR, IL 62521	217.429.8596
INSIGHT COMMUNICATIONS	1275 N WATER STREET DECATUR, IL 62521	217.424.8474
CITY OF DECATUR	#1 GARY K ANDERSON PLAZA DECATUR, IL 62523	217.424.2747
SANITARY DISTRICT OF DECATUR	501 S DIPPER LAKE DECATUR, IL 62522	217.422.6931
GAS AND ELECTRIC		
TELEPHONE POLES, BOXES, CABLE		
POLES, BOXES, CABLES		
SEWERS, WATER MAINS		
MANHOLES, SEWERS		

CONTRACT NUMBER 95493

Underground facilities, structures and utilities have been plotted from available surveys and records and their locations must be considered approximate only. There may be others, the existence of which is presently not known. The depth of utilities is assumed to be normal and customary. Contractor shall verify location and depth of all utilities prior to construction.

IT'S THE LAW IN ILLINOIS
PRIOR TO COMMENCING ANY CONSTRUCTION OR EXCAVATION, THE CONTRACTOR SHALL VERIFY THE LOCATION OF ALL UTILITIES BY CALLING:
J.U.L.I.E. * 1 - 8 0 0 - 8 9 2 - 0 1 2 3

* Joint Utilities Locating Information for Excavators.

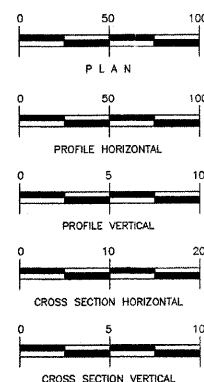

by *Michael H. Price*
date 9/29/2009
expires NOV.30.2009

STATE OF ILLINOIS
DEPARTMENT OF TRANSPORTATION
DECATUR PARK DISTRICT OF ILLINOIS, A MUNICIPAL CORPORATION

APPROVED: *9-10-09* 2009
Michael H. Price
EXECUTIVE DIRECTOR

PASSED: *11/3* 2009
Maureen Elwell
DISTRICT 7 ENGINEER OF LOCAL ROADS & STREETS

Releasing for Bid Based on Limited Review: *11/3* 2009
Ronald D. Dushell
DEPUTY DIRECTOR OF HIGHWAYS, REGION 4 ENGINEER