

ROUTE NO.	SECTION	CITY	TOTAL SHEETS	SHEET NO.
STEVENS CREEK BIKEWAY	99-P4000-00-BP	DECATUR PARK DIST	145	41
FED. ROAD DIST. NO.		ILLINOIS	PROJECT TE-0007(27)	

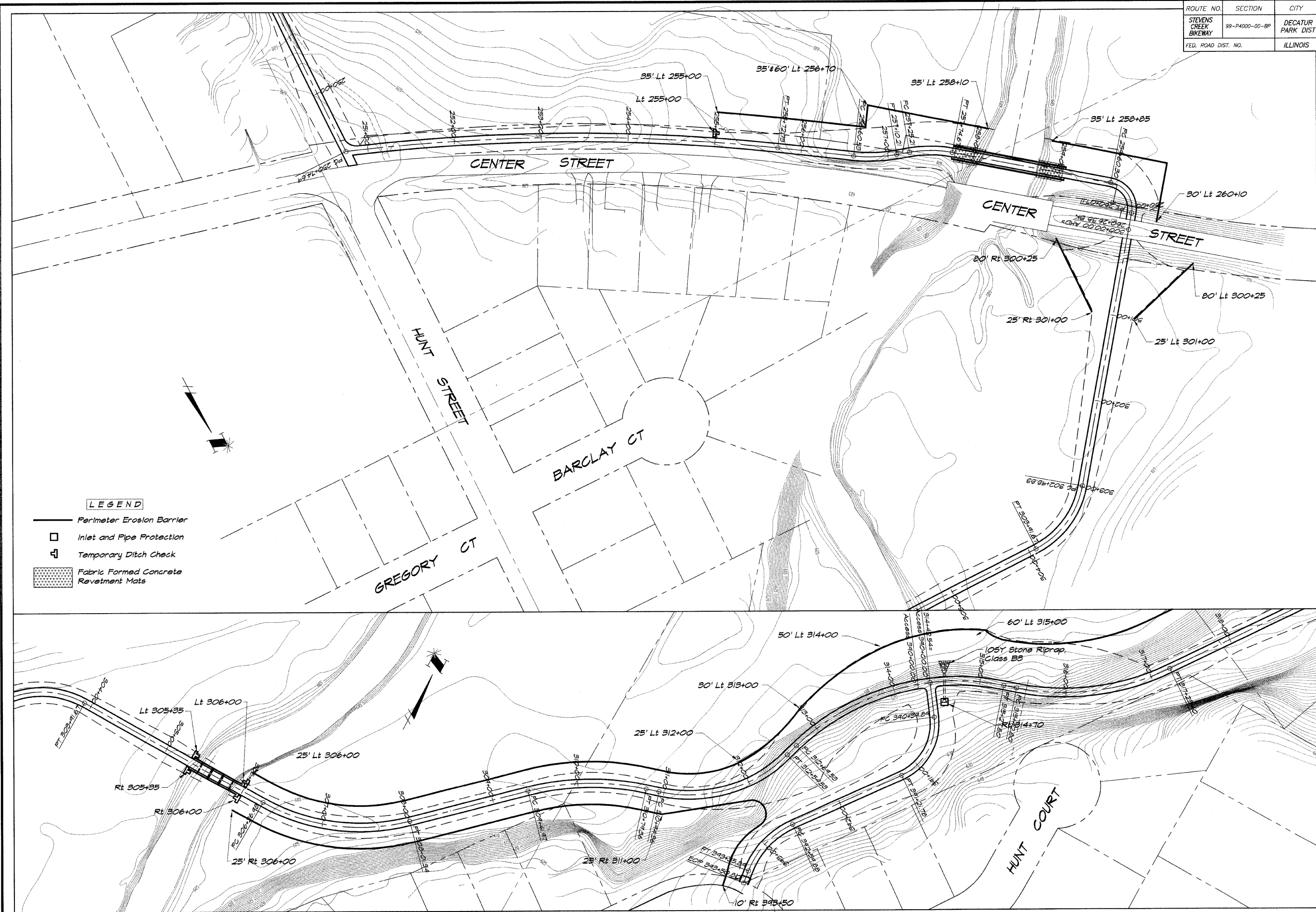

LEGEND

- Perimeter Erosion Barrier
- Inlet and Pipe Protection
- Temporary Ditch Check
- Fabric Formed Concrete Revetment Mats

BAINBRIDGE & ASSOCIATES, INC.
G&B MILANSKI
 Consulting Engineers
 1070 SOUTH TAYLORVILLE ROAD
 DECATUR, ILLINOIS 62521-1825
 Phone: 618-281-1825

DESIGNED	SCALE	REVISIONS
MHP	1" = 50'	
DATE	May 2002	
FIELD BOOK	99099	
XXX		

DECATUR PARK DISTRICT
 STEVENS CREEK BIKEWAY - PHASE I
 EROSION CONTROL PLAN