

ROUTE NO.	SECTION	CITY	TOTAL SHEETS	SHEET NO.
STEVENS CREEK BIKEWAY	99-P4000-00-BP	DECATUR PARK DIST	145	43
FED. ROAD DIST. NO.		ILLINOIS	PROJECT TE-0007(27)	

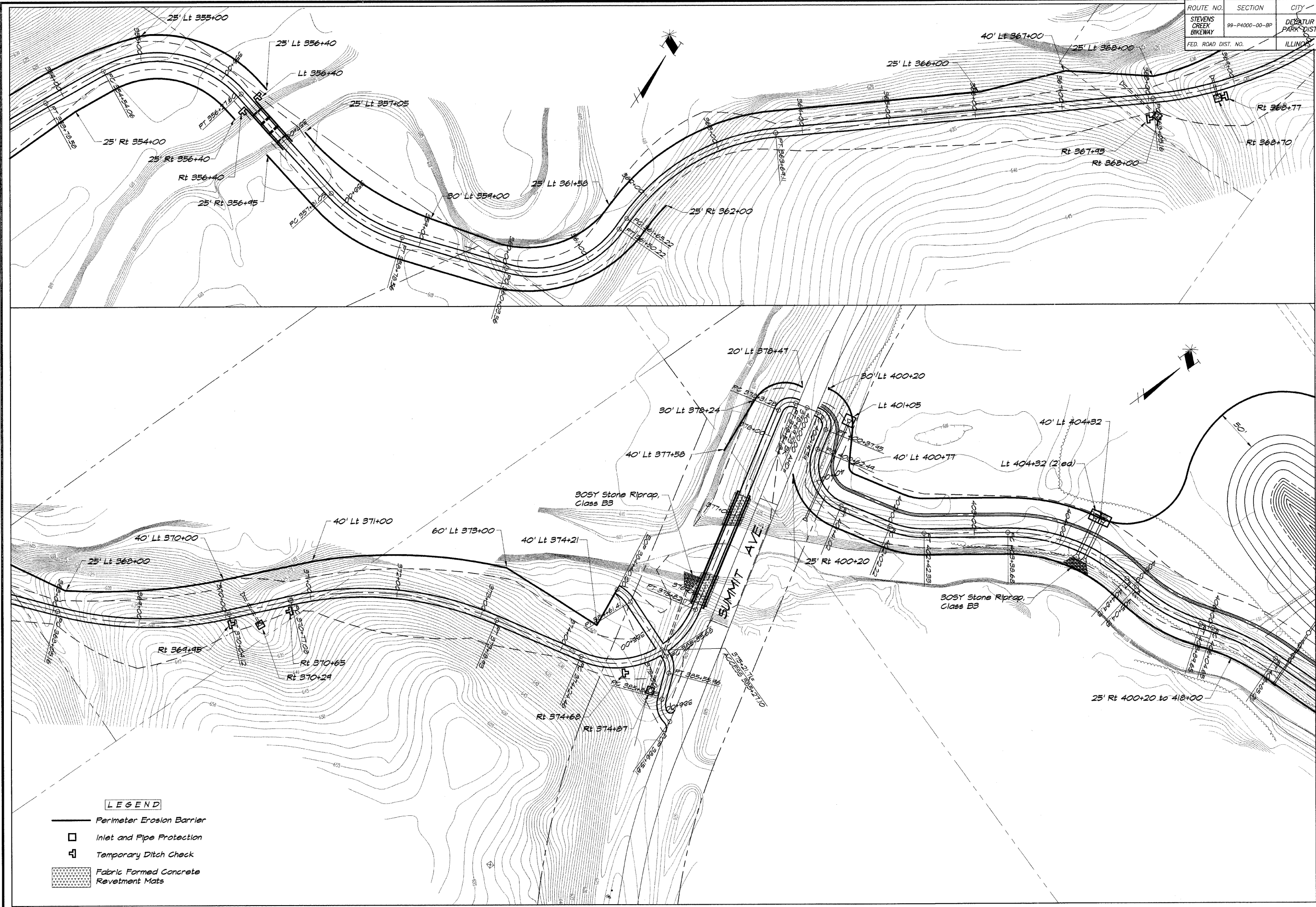

BATHURIDGE & ASSOCIATES, INC.
 Consulting Engineers
GEE MILANSKI
 1870 SOUTH TAYLORVILLE ROAD
 DECATUR, ILLINOIS 62526
 Phone: 314/398-1800

REVISIONS		
NO.	BY	DATE

DESIGNED	SCALE	DATE	JOB NO.
MHP	1" = 50'	May 2002	99049
DRAWN	FIELD BOOK		XXX
P			

DECATUR PARK DISTRICT
 STEVENS CREEK BIKEWAY - PHASE I
 EROSION CONTROL PLAN