

ROUTE NO.	SECTION	CITY	TOTAL SHEETS	SHEET NO.
STEVENS CREEK BIKEWAY	89-P4000-00-BP	DECATUR PARK DIST	145	47
FED. ROAD DIST. NO.	ILLINOIS		PROJECT TE-0007(27)	

BATNBRIDGE & ASSOCIATES, INC.
G&B MILANSKI
 Consulting Engineers
 100 SOUTH TAYLORVILLE ROAD
 DECATUR, ILLINOIS
 PHONE NUMBER 184-5125

DESIGNED	SCALE	REVISIONS
MHP	1" = 50'	NO. BY DATE
FIELD BOOK	DATE	
XXXX	May 2002	
	JOB NO.	
	PROJ	

DECATUR PARK DISTRICT
 STEVENS CREEK BIKEWAY - PHASE I
 PAVEMENT MARKING AND SIGNING PLAN

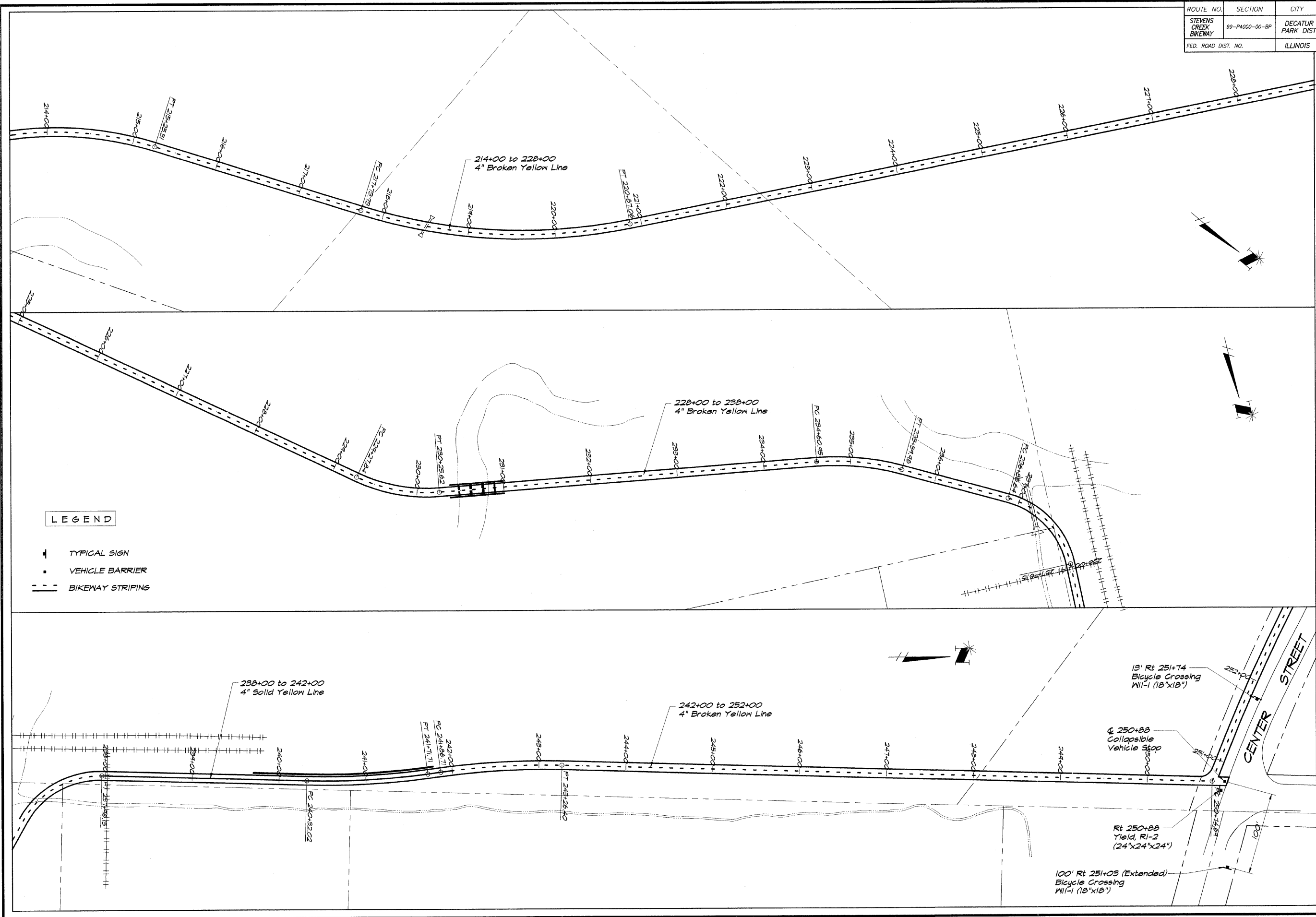

LEGEND

- ⊥ TYPICAL SIGN
- VEHICLE BARRIER
- BIKEWAY STRIPING