

ROUTE NO.	SECTION	CITY	TOTAL SHEETS	SHEET NO.
STEVENS CREEK BIKEWAY	89-P4000-00-BP	DECATUR PARK DIST	145	48
FED. ROAD DIST. NO.		ILLINOIS	PROJECT TE-0007(27)	

BATNRIDGE & ASSOCIATES, INC.  
 Consulting Engineers  
 1870 SOUTH TAYLORVILLE ROAD  
 DECATUR, ILLINOIS 62526-2588

REVISIONS	NO.	BY	DATE

DESIGNED: MFP  
 DRAWN: P mls  
 FIELD BOOK: XXX

SCALE: 1" = 50'  
 DATE: May 2002  
 JOB NO.: 95099

**DECATUR PARK DISTRICT**  
 STEVENS CREEK BIKEWAY - PHASE I  
 PAVEMENT MARKING AND SIGNING PLAN

SHEET NO.  
**48**  
 OF  
 145

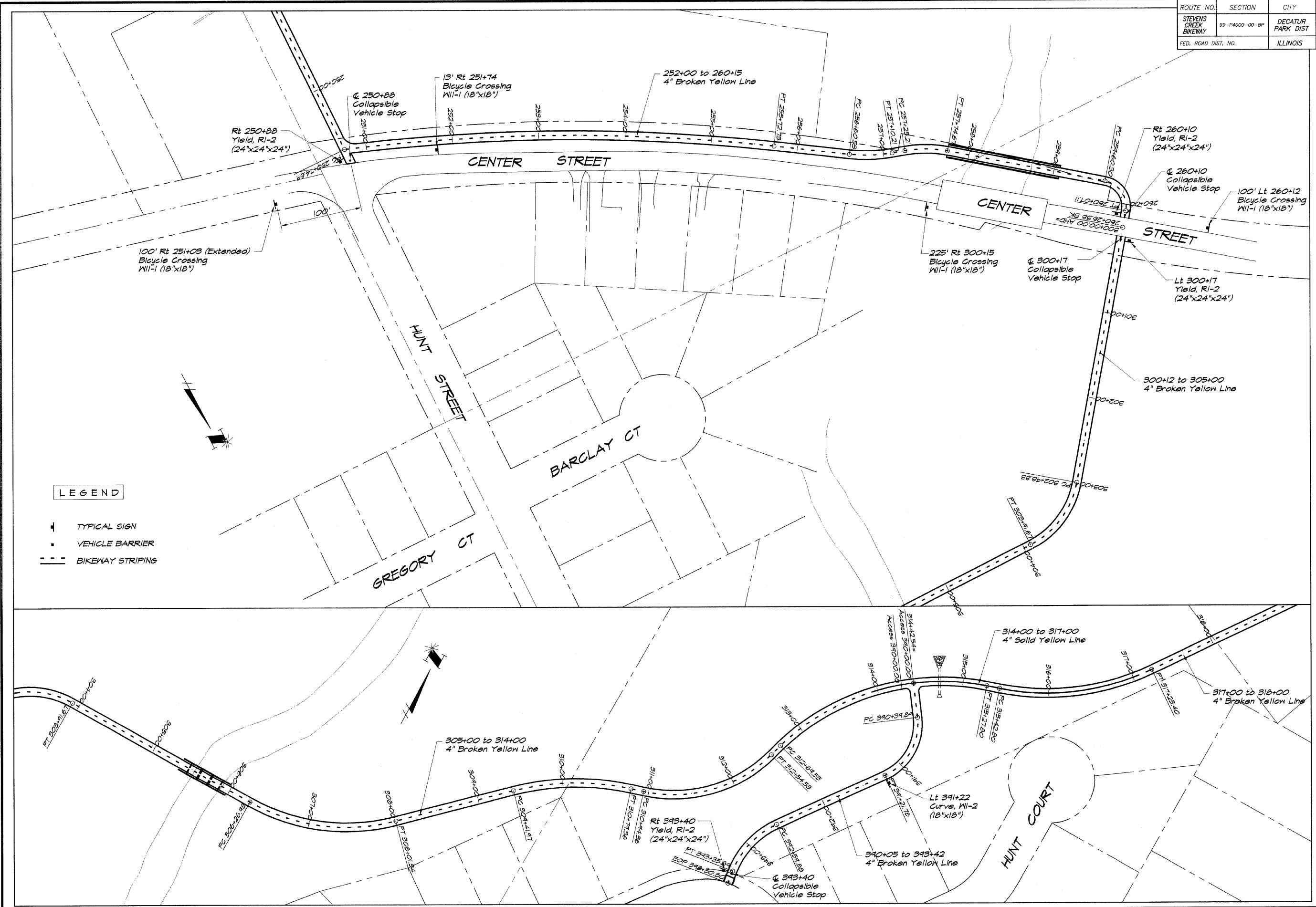

**LEGEND**

- ▲ TYPICAL SIGN
- VEHICLE BARRIER
- BIKEWAY STRIPING