

ROUTE NO.	SECTION	CITY	TOTAL SHEETS	SHEET NO.
STEVENS CREEK BIKEWAY	95-P4000-00-BP	DECATUR PARK DIST	145	95
ROAD DIST. NO.	ILLINOIS		PROJECT TE-0007(27)	

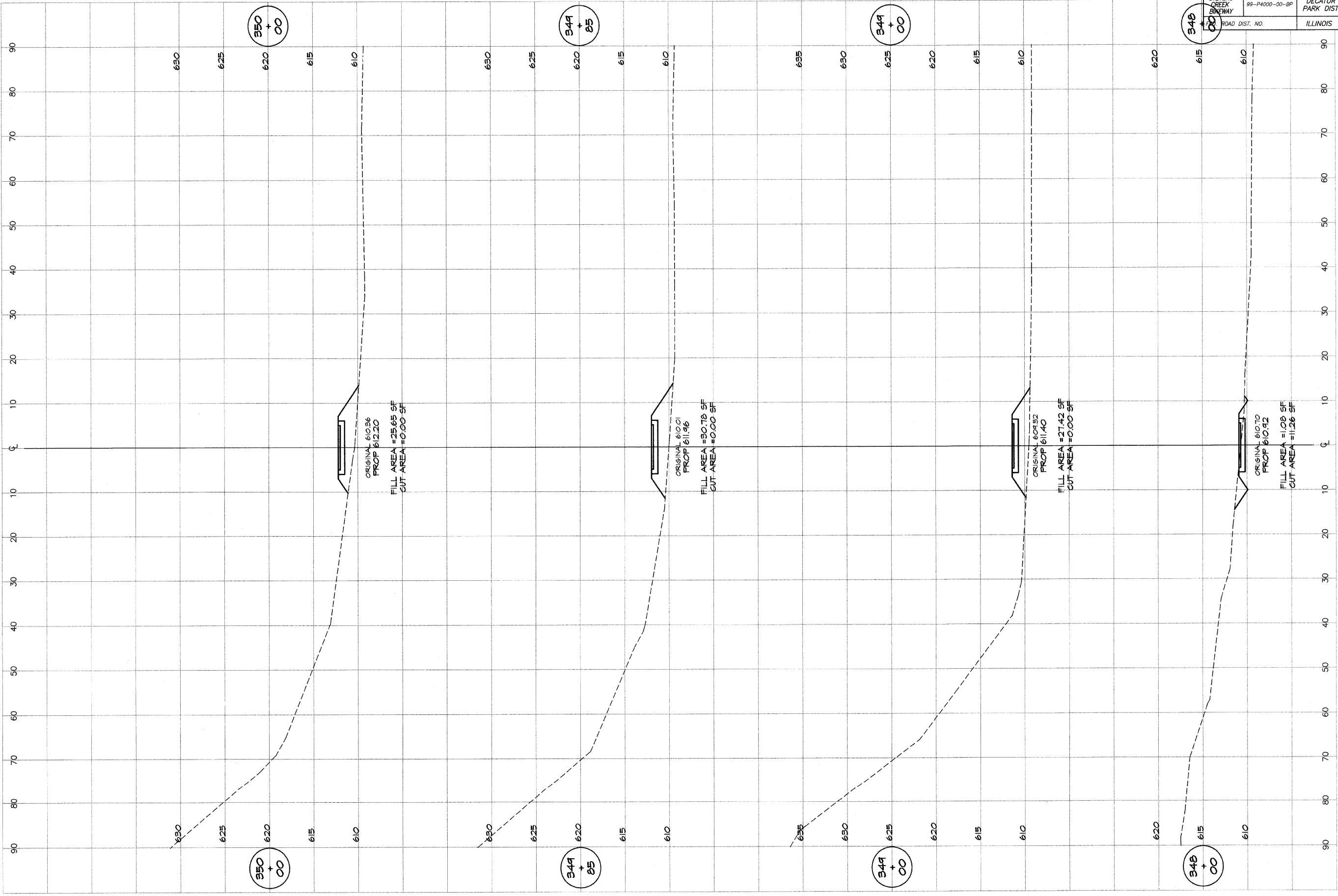

**BATHBRIDGE**  
**G&B**  
**MILAWSKI**  
**& ASSOCIATES, INC.**  
 Consulting Engineers

1870 SOUTH TAYLORVILLE ROAD  
 DECATUR, ILLINOIS  
 62526-1840

DESIGNED	SCALE	REVISIONS
MJP	as noted	NO. BY DATE
DRN	DATE	
P m/l/s	Jan 2004	
FIELD BOOK	JOB NO.	
XXX	95099	

**DECATUR PARK DISTRICT**  
 STEVENS CREEK BIKEWAY - PHASE I  
 CROSS SECTIONS  
 CENTER TO SUMMIT