

ROUTE NO.	SECTION	CITY	TOTAL SHEETS	SHEET NO.
STEVENS CREEK BIKEWAY	49-P4000-00-BP	DECATUR PARK DIST	145	114
FED. ROAD DIST. NO.	ILLINOIS		PROJECT TE-0007(27)	

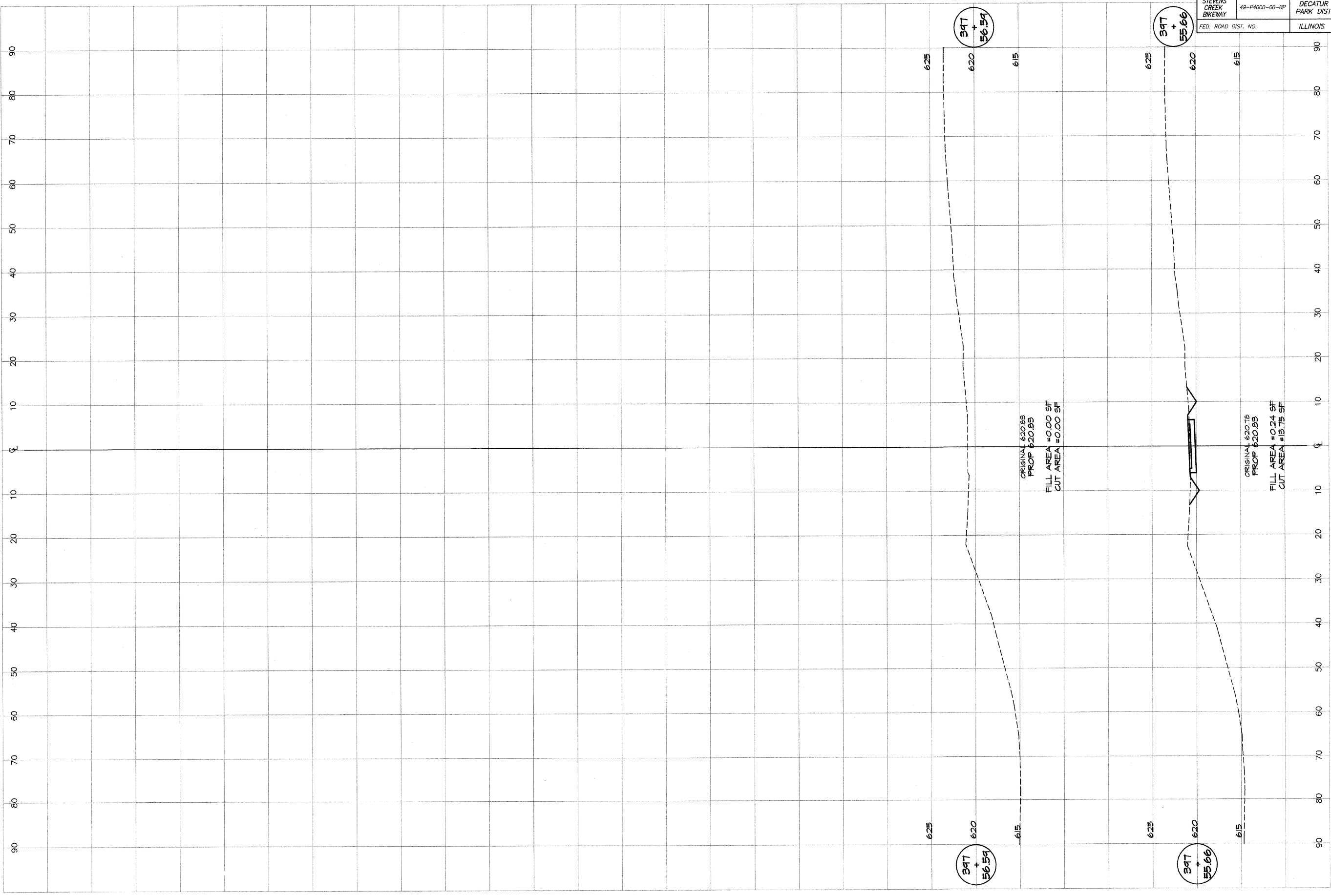

BATNEBRIDGE
G&B
MILANSKI
 & ASSOCIATES, INC.
 Consulting Engineers

1810 SOUTH TAYLORVILLE ROAD
 DECATUR, ILLINOIS 62526

DESIGNED	SCALE	REVISIONS
MHP	as noted	NO. BY DATE
MAP	DATE	
P. Mills	JAN 2004	
FIELD BOOK	JOB NO.	
XXX	99099	

DECATUR PARK DISTRICT
 STEVENS CREEK BIKEWAY - PHASE I
 CROSS SECTIONS
 RAVINA PARK ROAD ACCESS