

ROUTE NO.	SECTION	CITY	TOTAL SHEETS	SHEET NO.
STEVENS CREEK BIKEWAY	99-P4000-00-BP	DECATUR PARK DIST	145	131
ROAD DIST. NO.			ILLINOIS	PROJECT TE-0007(27)

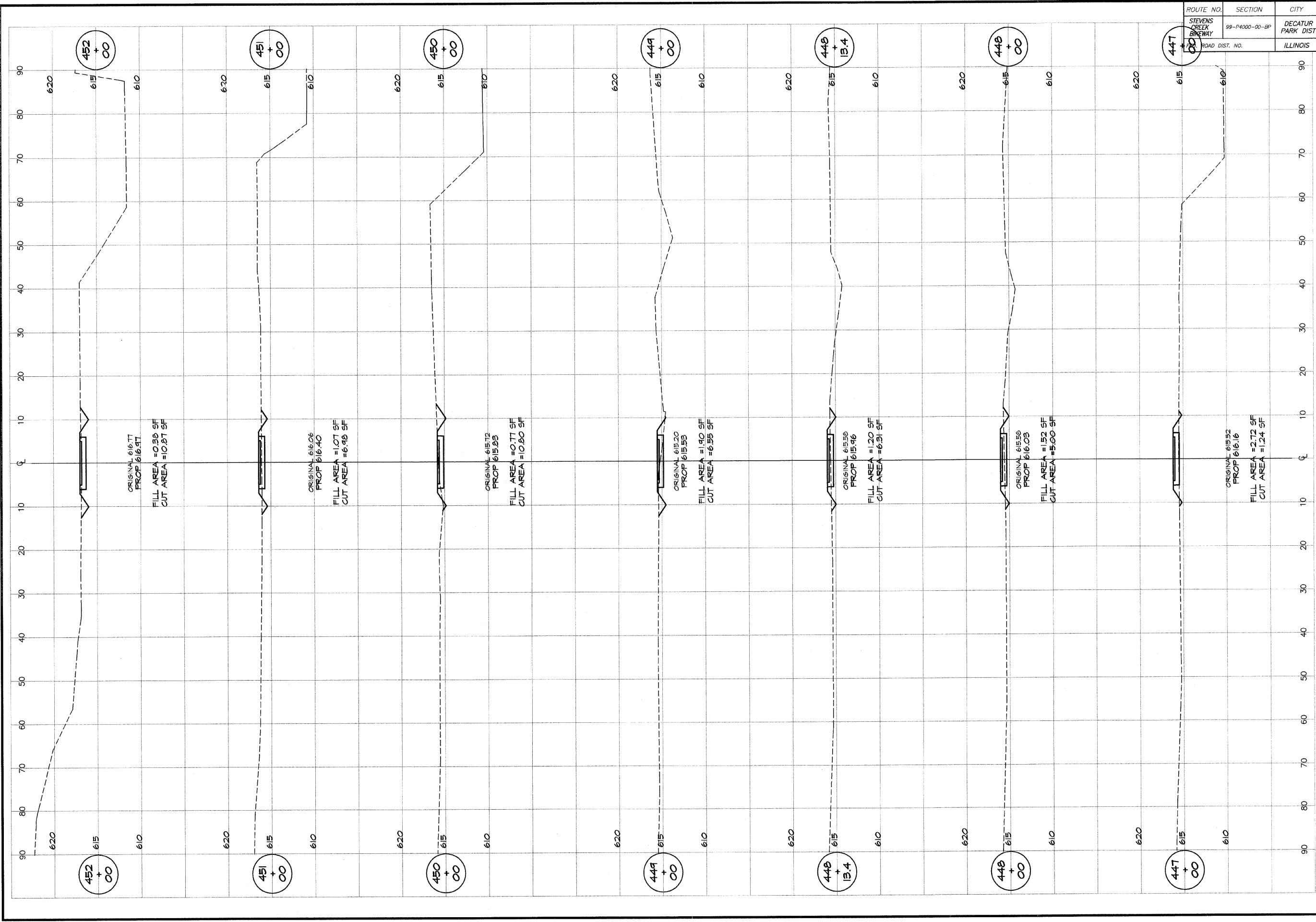

DECATUR PARK DISTRICT
 STEVENS CREEK BIKEWAY - PHASE I
 CROSS SECTIONS
 SUMMIT TO GREENDELL

DESIGNED	SCALE	REVISIONS
MHP	as noted	NO. BY DATE
P. Mills	DATE	
FIELD BOOK	JAN 2004	
XXX	JOB NO.	
	99099	

BATNEBRIDGE
GEB
MILANSKI
 & ASSOCIATES, INC.
 Consulting Engineers

160 SOUTH TAYLORVILLE ROAD
 DECATUR, ILLINOIS 62526
 License No. 184-021265