

EXISTING STRUCTURE: Sta. 5+00.2 - Single span precast deck beam bridge on closed timber abutments and timber wingwalls. 30.0' bk.-bk. abuts.; 22.5' o.-o. deck. Structure closed to traffic.

No Salvage

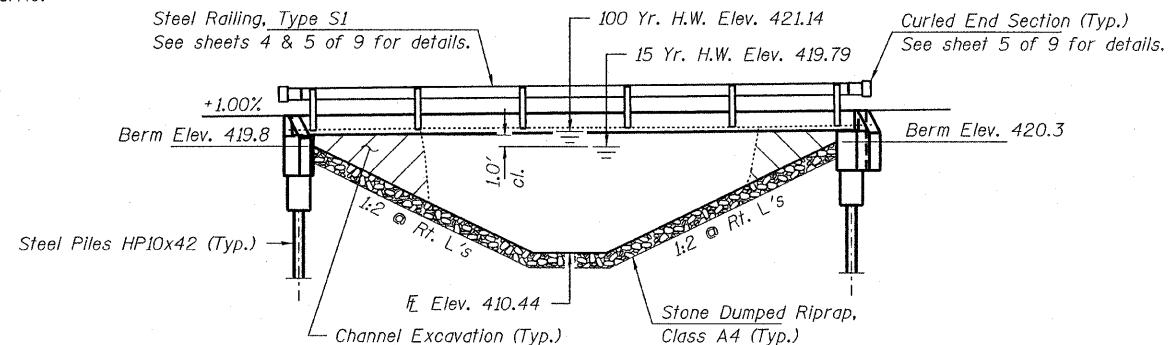

ELEVATION

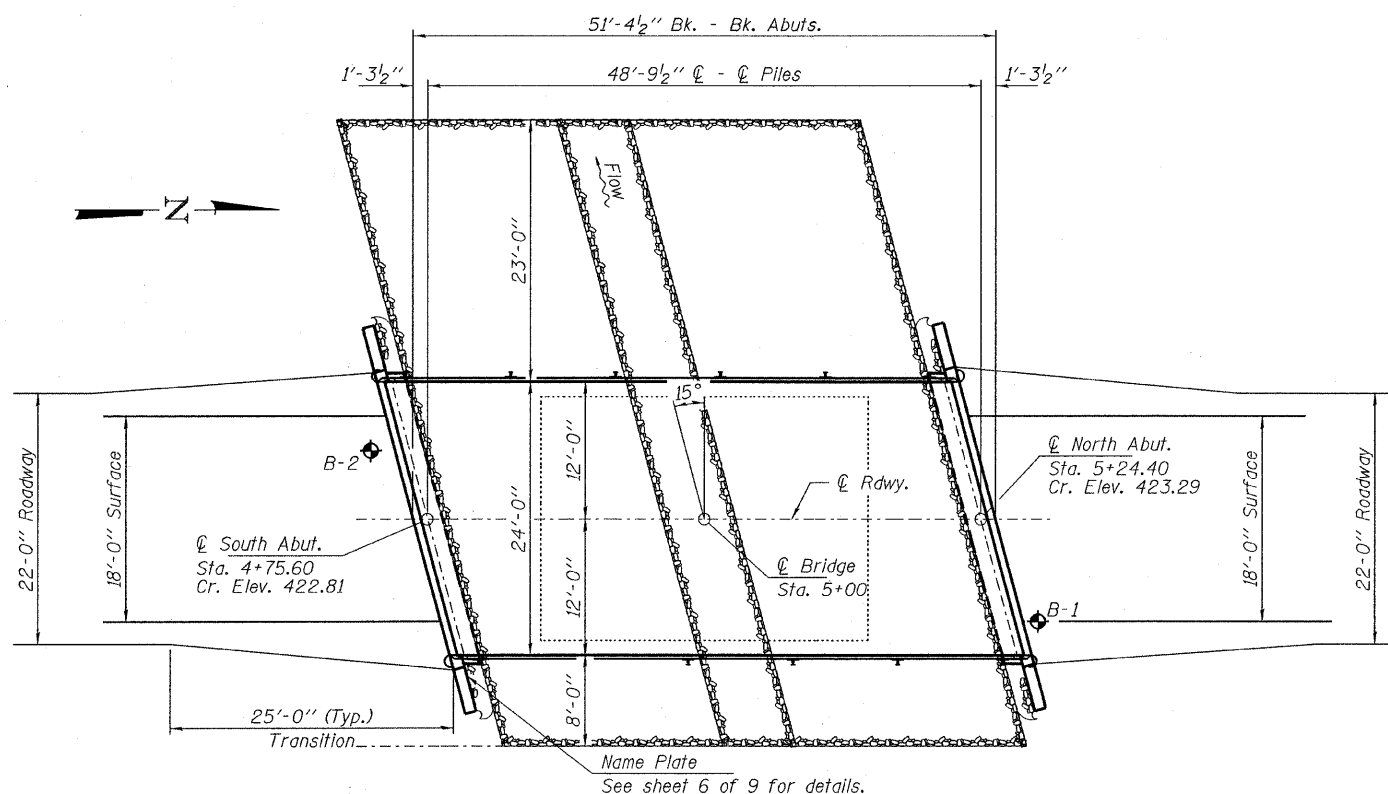

PLAN

DESIGN STRESSES

FIELD UNITS

f'c = 3,500 psi  
fy = 60,000 psi (Reinf.)

PRECAST PRESTRESSED UNITS

f'c = 6,000 psi  
f'cl = 5,000 psi  
fpu = 270,000 psi (1/2" low lax. strands)  
fpbt = 201,960 psi (1/2" low lax. strands)  
fy = 60,000 psi (Reinf.)

LOADING HL-93

Design Specifications: 2007 AASHTO LRFD with all applicable interims. 50#/Sq. Ft. Included in dead load for future wearing surface.

DESIGNED - A.S.L.
CHECKED - S.W.M.
DRAWN - D.A.B.
CHECKED - D.T.M.

SEISMIC DATA

Seismic Performance Zone (SPZ) = 2  
Design Spectral Acceleration at 1.0 sec. (Sp1) = 0.264g  
Design Spectral Acceleration at 0.2 sec. (Sp5) = 0.632g  
Soil Site Class = D

WATERWAY INFORMATION

Drainage Area = 2.4 Sq. Mi.		Existing Low Grade Elev. 420.60 @ Sta. 4+00		Proposed Low Grade Elev. 420.83 @ Sta. 3+00		
Flood	Freq. Yr.	Q C.F.S.	Opening Sq. Ft. Exist. Prop.	Natural H.W.E. Exist. Prop.	Head - Ft. Exist. Prop.	Headwater El. Exist. Prop.
Design	15	1247	206 250	419.79 0.24 0.13	420.03 419.92	
Max. Calc.	100	2200	206 295	421.14 1.00 0.45	422.14 421.59	

GENERAL NOTES

Layout of the slope protection system may be varied to suit ground conditions in the field as directed by the Engineer.  
Excavation behind existing abutment walls shall be performed to balance front and back soil pressure before removing the existing superstructure.  
Reinforcement bars shall conform to the requirements of ASTM A 706 Gr 60 (IL Modified). See Special Provisions.  
Excavation required to construct the Abutments shall be included in the cost of Concrete Structures. No additional compensation will be allowed for Structure Excavation.  
All proposed construction activities shall be in accordance with Nationwide Permit number 14 of the Department of the Army authorized under Section 404 of the Clean Water Act. The IEPA has issued Section 401 Water Quality Certification for this activity. See Special Provisions for conditions. See sheet 9 of 9 for Borings.

BEAR CREEK  
BUILT 20\_\_ BY  
EDWARDS COUNTY  
SEC. 07-00064-00-BR  
C.H. 4  
STR. NO. 024-3137  
LOADING HL-93

NAME PLATE

See Std. 515001

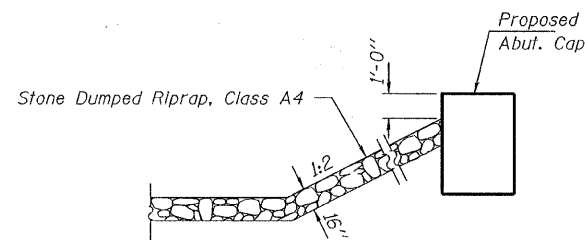

SECTION A-A

Note: See Special Provisions for Stone Dumped Riprap, Class A4.

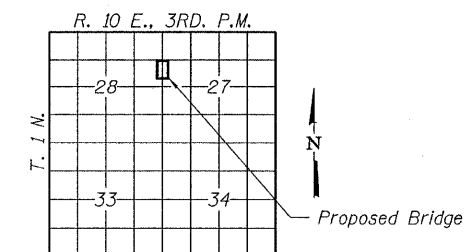

LOCATION SKETCH

TOTAL BILL OF MATERIAL

ITEM	UNIT	SUPER	SUB	TOTAL
Channel Excavation	Cu. Yd.			95
Stone Dumped Riprap, Class A4	Ton			244
Removal of Existing Structures	Each			1
Concrete Structures	Cu. Yd.		23.4	23.4
Concrete Encasement	Cu. Yd.		2.8	2.8
Precast Prestressed Concrete Deck Beams (21" Depth)	Sq. Ft.	1,200		1,200
Reinforcement Bars	Pound		2,510	2,510
Steel Railing, Type S1	Foot	97		97
Furnishing Steel Piles HP10x42	Foot		360	360
Driving Piles	Foot		360	360
Name Plates	Each		1	1

I certify that to the best of my knowledge, information and belief, this bridge design is structurally adequate for the design loading shown on the plans. The design is an economical one for the style of structure and complies with requirements of the current "AASHTO LRFD Specifications."

Steven W. Megginson 10/15/09  
ILLINOIS STRUCTURAL NO. 081-6064



Expires 11-30-2010

GENERAL PLAN AND ELEVATION  
STRUCTURE NO. 024-3137

<b>HAMPTON, LENZINI &amp; RENWICK, INC.</b> CIVIL & STRUCTURAL ENGINEERS LAND SURVEYORS <b>HLR</b> 3085 STEVENSON DRIVE, SUITE 201 SPRINGFIELD, ILLINOIS 62703 (217) 546-3400 PROJECT NUMBER: 09.0047.130 DATE: 10/15/09	SHEET NO. 1	C.H.	SECTION	COUNTY	TOTAL SHEETS	SHEET NO.
	9 SHEETS	4	07-00064-00-BR	EDWARDS	13	5
			CONTRACT NO. 95606			
		FED. ROAD DIST. NO.	ILLINOIS	FED. AID PROJECT		