

ROUTE NO.	SECTION	COUNTY	TOTAL SHEETS	SHEET NO.
FAU 7432	*	MACON	47	10
FEDERAL DIST. NO.	ILLINOIS	PROJECT		

\*08-00602-00-BR

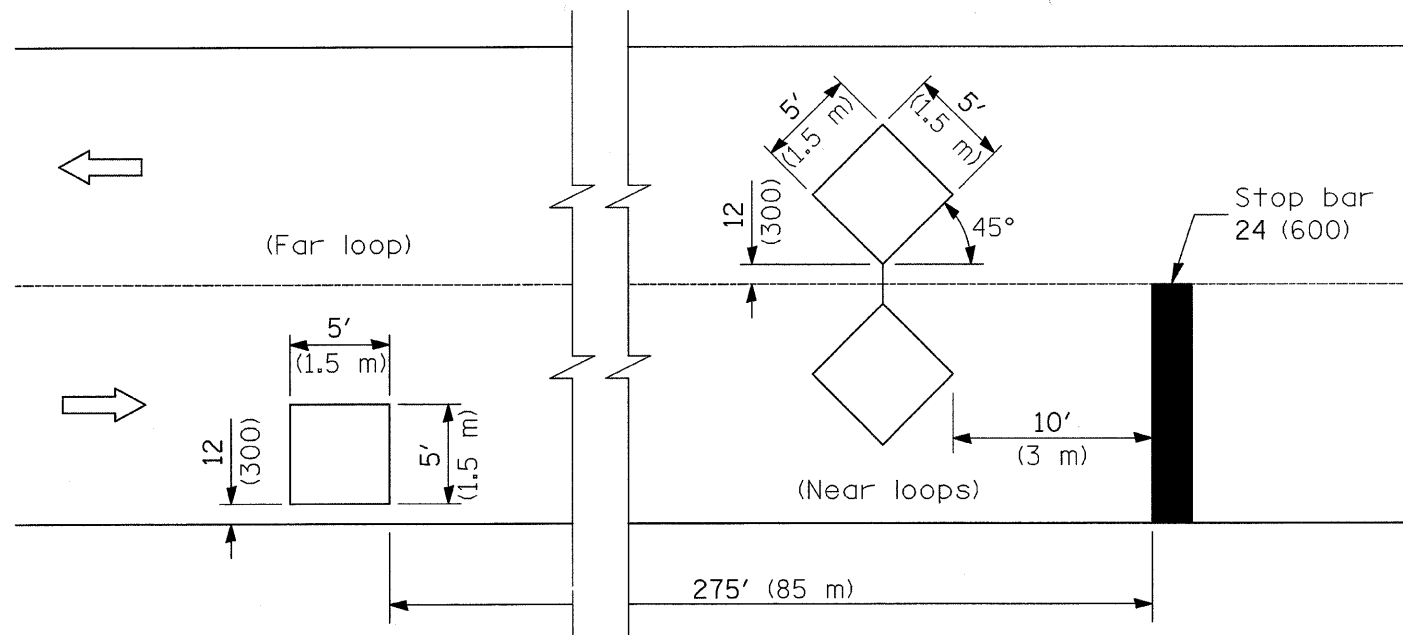

DETECTOR LOOPS

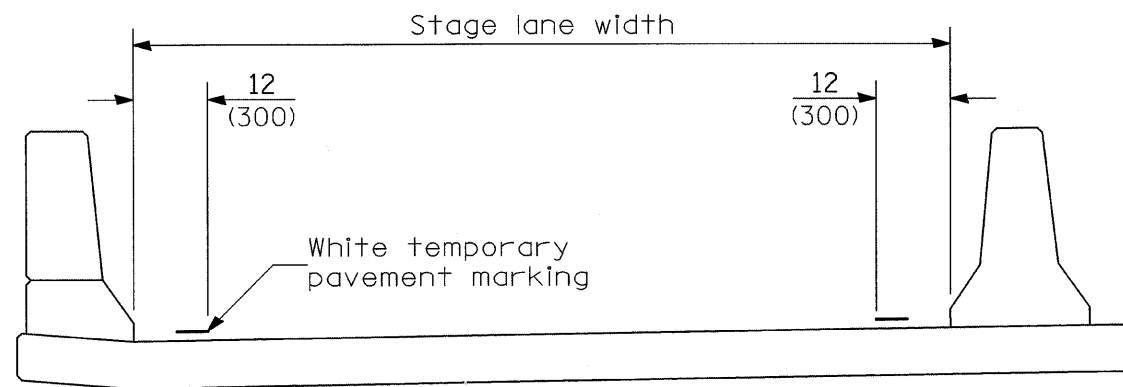

TEMPORARY PAVEMENT MARKING

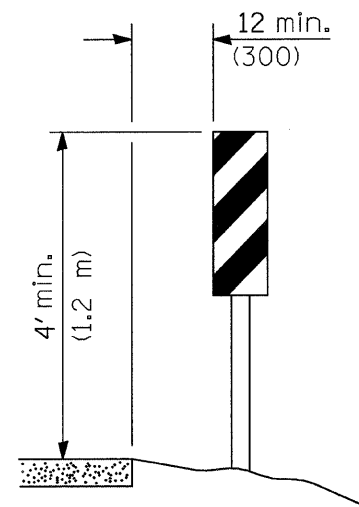

VERTICAL PANELS  
(Post mounted, one each side)

TRAFFIC SIGNAL SEQUENCE						
PHASE	A			B		
INTERVAL	1	2	3	4	5	6
NORTHBOUND	G	Y	R	R	R	R
SOUTHBOUND	R	R	R	G	Y	R
WESTBOUND	R	R	R	R	R	R

TEMPORARY CONCRETE BARRIER	
NORMAL POSTED SPEED	TAPER RATIO
40 mph AND ABOVE	12:1
BELOW 40 mph	8:1

GENERAL NOTES

Temporary concrete barrier shall be according to Standard 704001.

All dimensions are in inches (millimeters) unless otherwise shown.

TRAFFIC CONTROL PLAN			
REVISIONS	SECTION 08-00602-00-BR	MACARTHUR RD OVER STEVENS CR	DRAWN BY DATE
1	CITY OF DECATUR	MACON COUNTY	DLB 7/09
2			CHECKED BY DATE
3			PPW 7/09
4			BOOK NUMBER
5			486
6			PROJECT No.
7			5307
8			SHEET No.
9			
10			

**HOMER L. CHASTAIN & ASSOCIATES, LLP**  
CONSULTING ENGINEERS  
184-90197

DECATUR CHICAGO  
(317) 422-8644 (773) 714-0050

ROCKFORD  
(815) 489-0050