

PROPERTY OWNER:
STUTZ EXCAVATING INC.
3837 FOSTERBURG ROAD
ALTON, IL 62002
(618)-259-2485

LT. STA. 200+92 TO STA. 201+00
1 EACH TRAFFIC BARRIER TERMINAL,
TYPE 1 (SPECIAL) TANGENT
LT. STA. 200+92
1 EACH TRAFFIC MARKER - DIRECT APPLIED

RT. STA. 200+71 TO STA. 201+00
29 FT. STEEL PLATE BEAM GUARDRAIL, TYPE A

PROPERTY OWNER:
JOHN H. STUTZ
7666 STUTZ
ALTON, IL 62002
(618)-259-1172

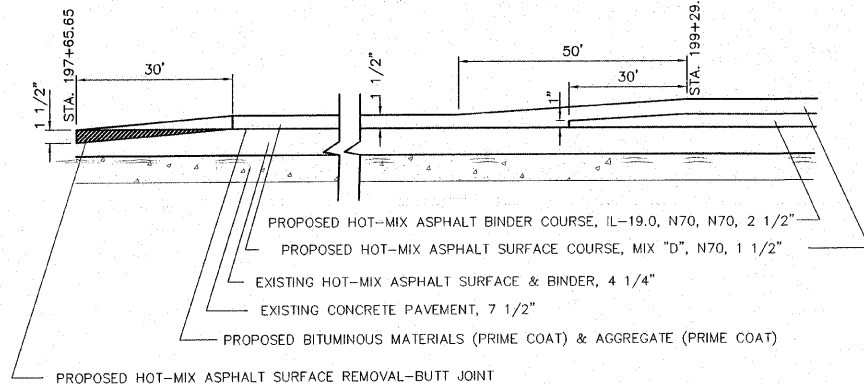
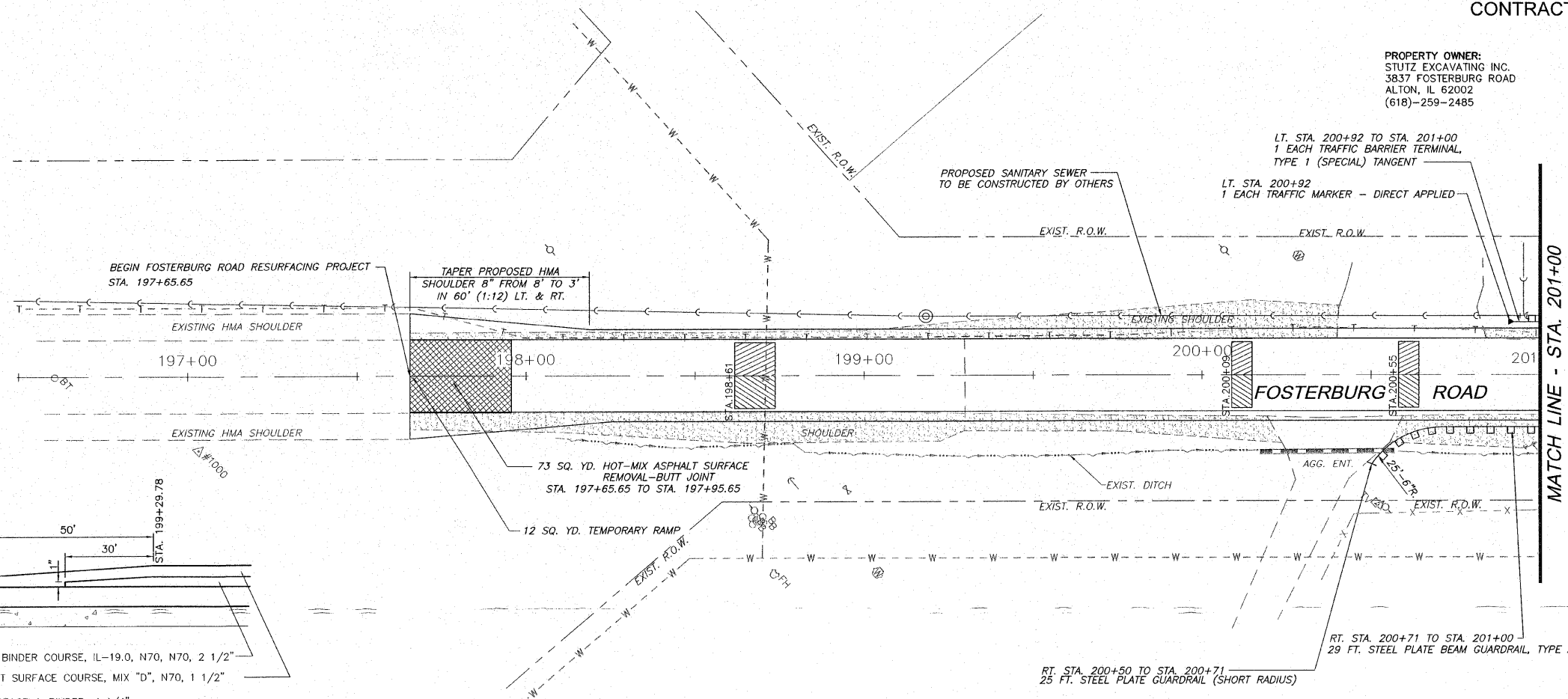
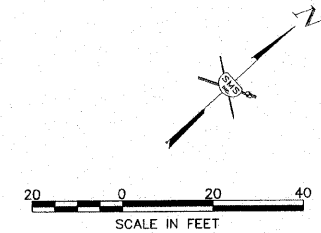

BUTT JOINT AND TRANSITION DETAIL
TO BE USED: STA. 197+65.65 TO 199+29.78

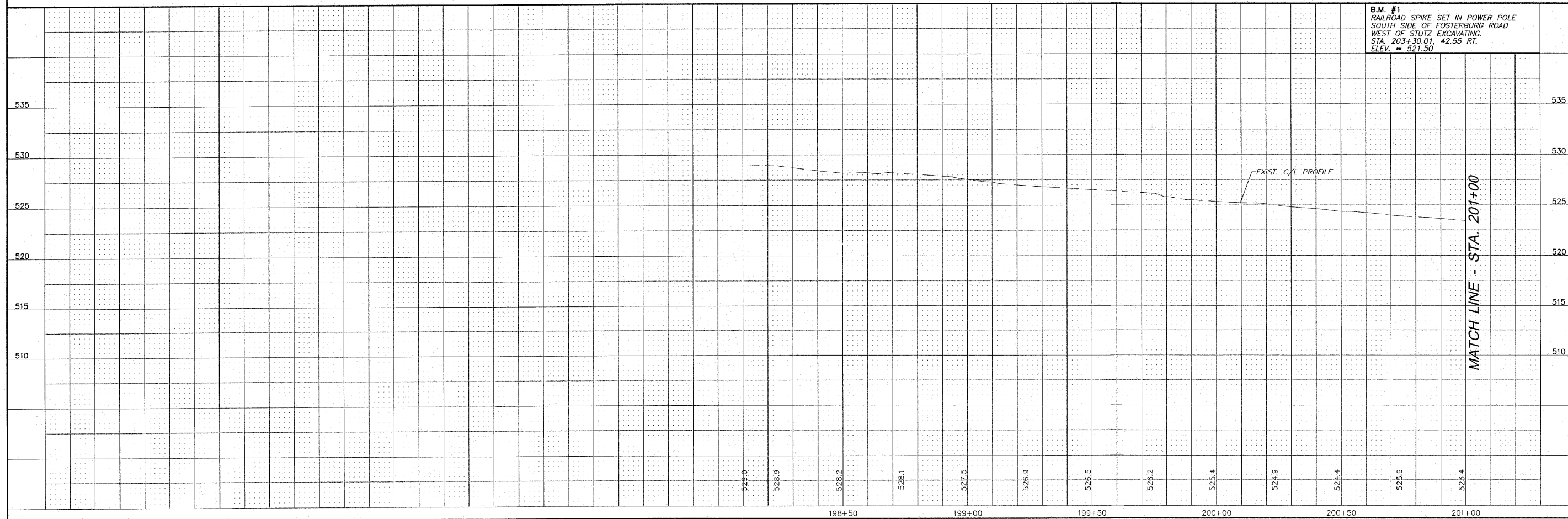

REVISIONS

SMS Sheppard, Morgan & Schwaab, Inc.
CONSULTING ENGINEERS AND LAND SURVEYORS
215 Market Street, P.O. Box E, Alton, IL 62002 618-259-9755 E-mail: mail@smsengr.com
10 Central Industrial Drive, Suite 3, Granite City, IL 62040 618-977-9700 E-mail: mail@smsengr.com
DESIGN FIRM # 184-000992

ALTON, ILLINOIS - FOSTERBURG ROAD IMPROVEMENTS
FAU ROUTE 9002
SECTION 09-00218-05-RS
PLAN AND PROFILE

REF. BK.	PG.
JOB NO. 207632.1	
DSN. BY: LDA	
DWN. BY: CAD	
CHK. BY: LDA	
DATE: OCTOBER, 2009	
SCALE: HORIZ: 1"=20'	
VERT: 1"=5'	
SHEET 4	OF 8