

Route	Section	County	Total Sheets	Sheet No.
9550	09-00086-00-RS	SALINE	12	5
City of Harrisburg		Sloan Street		

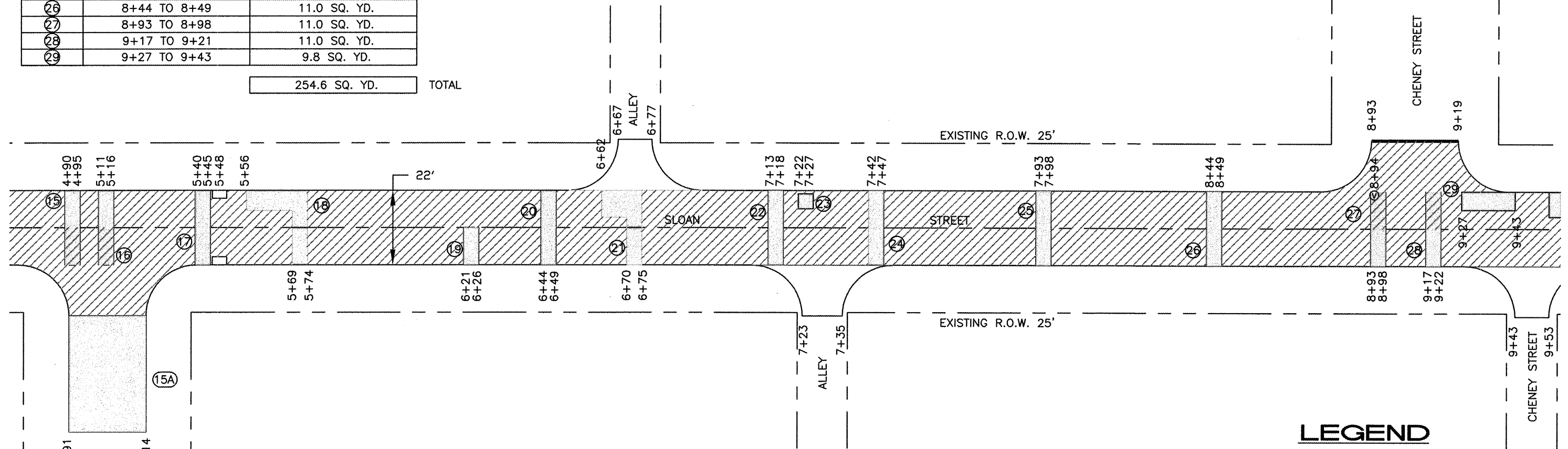





CONTRACT NO. 99401

CLASS B PATCHES, TYPE II, 8 INCH		
AREA #	LOCATION	AMOUNT TO BE REMOVED
15	4+90 TO 4+95	11.0 SQ. YD.
15A	4+91 TO 5+14	89.4 SQ. YD.
16	5+11 TO 5+16	11.0 SQ. YD.
17	5+40 TO 5+45	11.0 SQ. YD.
18	5+56 TO 5+74	20.0 SQ. YD.
19	6+21 TO 6+26	5.5 SQ. YD.
20	6+44 TO 6+49	11.0 SQ. YD.
21	6+62 TO 6+75	17.7 SQ. YD.
22	7+13 TO 7+18	11.0 SQ. YD.
23	7+22 TO 7+27	2.2 SQ. YD.
24	7+42 TO 7+47	11.0 SQ. YD.
25	7+93 TO 7+98	11.0 SQ. YD.
26	8+44 TO 8+49	11.0 SQ. YD.
27	8+93 TO 8+98	11.0 SQ. YD.
28	9+17 TO 9+21	11.0 SQ. YD.
29	9+27 TO 9+43	9.8 SQ. YD.

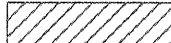
254.6 SQ. YD. TOTAL



LEGEND

-  CLASS B PATCHES, TYPE II, 8 INCH
-  AREA OF HMA OVERLAY
-  AREA OF HMA SURFACE REMOVAL AND HMA OVERLAY
-  MANHOLE TO BE ADJUSTED
-  MANHOLE ADJUSTMENT, SPECIAL
-  WATER VALVE TO BE ADJUSTED
-  BUTT JOINT TO BE CONSTRUCTED
-  EXISTING INLET

SLOAN STREET - FEAZEL STREET TO CHENEY STREET
STATION 4+90 TO 9+43