

STATE OF ILLINOIS
DEPARTMENT OF TRANSPORTATION
DIVISION OF HIGHWAYS

**PROPOSED
HIGHWAY PLANS**

FAP ROUTE 322 (US 51)
SECTION (10,10-2,11-1,12-1,13)RS-3
PROJECT ACNHPP-0322 (113)
3P RESURFACING
JACKSON/UNION COUNTY

F.A.P. RTE.	SECTION	COUNTY	TOTAL SHEETS	SHEET NO.
322	(10,10-2,11-1,12-1,13) RS-3	JACKSON/UNION	18	1
ILLINOIS			78491	

FOR INDEX OF SHEETS, SEE SHEET NO. 3

TRAFFIC DATA

US 51 TRAFFIC DATA

2016 ADT = 6,080 WITH 9% TRUCKS

2036 ADT = 7,420 WITH 9% TRUCKS

TOWNSHIPS

MAKANDA
COBDEN
ANNA

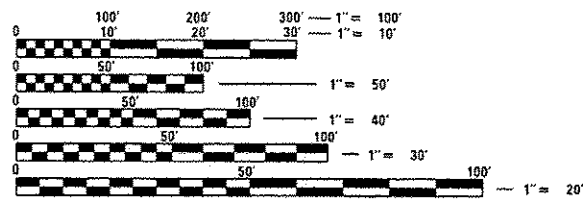

FULL SIZE PLANS HAVE BEEN PREPARED USING STANDARD ENGINEERING SCALES. REDUCED SIZED PLANS WILL NOT CONFORM TO STANDARD SCALES. IN MAKING MEASUREMENTS ON REDUCED PLANS, THE ABOVE SCALES MAY BE USED.

J.U.L.I.E.
JOINT UTILITY LOCATION INFORMATION FOR EXCAVATION
1-800-892-0123
OR 811

PROJECT ENGINEER: CHARLES STEIN
DESIGNER: BRANDY MAES

CONTRACT NO. 78491

C-99-059-15

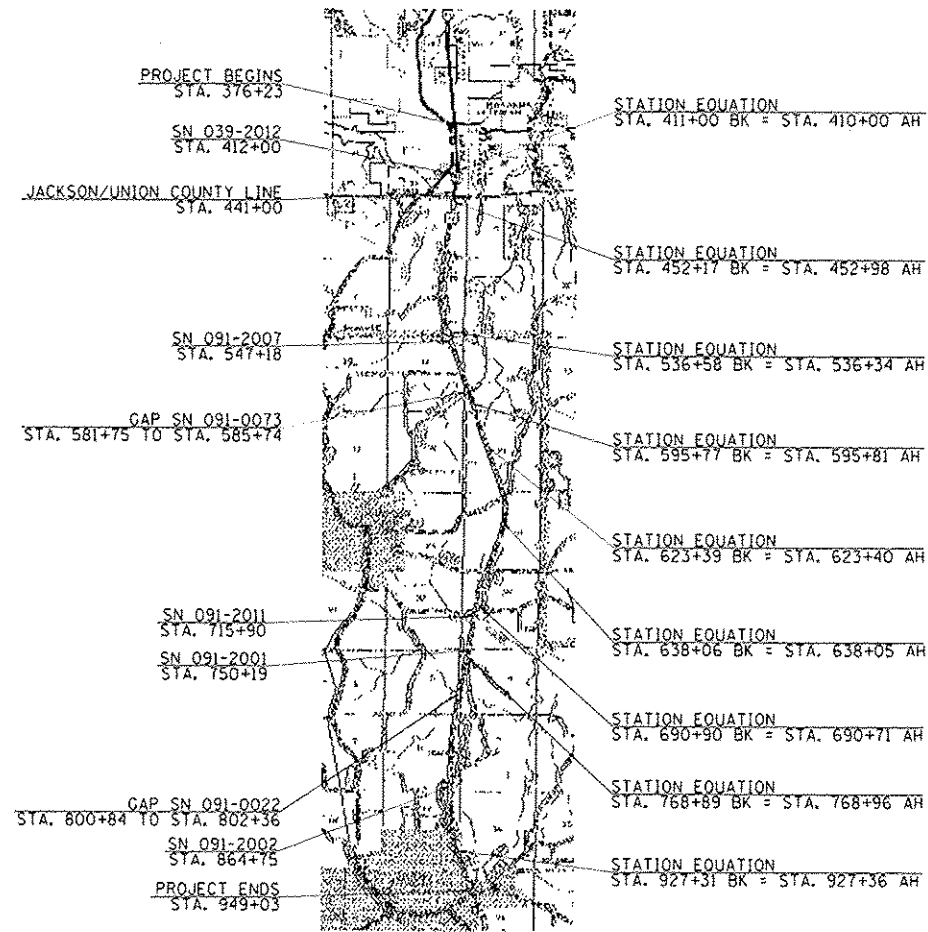

GROSS LENGTH = 57,327 FT. = 10.9 MILE
NET LENGTH = 56,776 FT. = 10.8 MILE

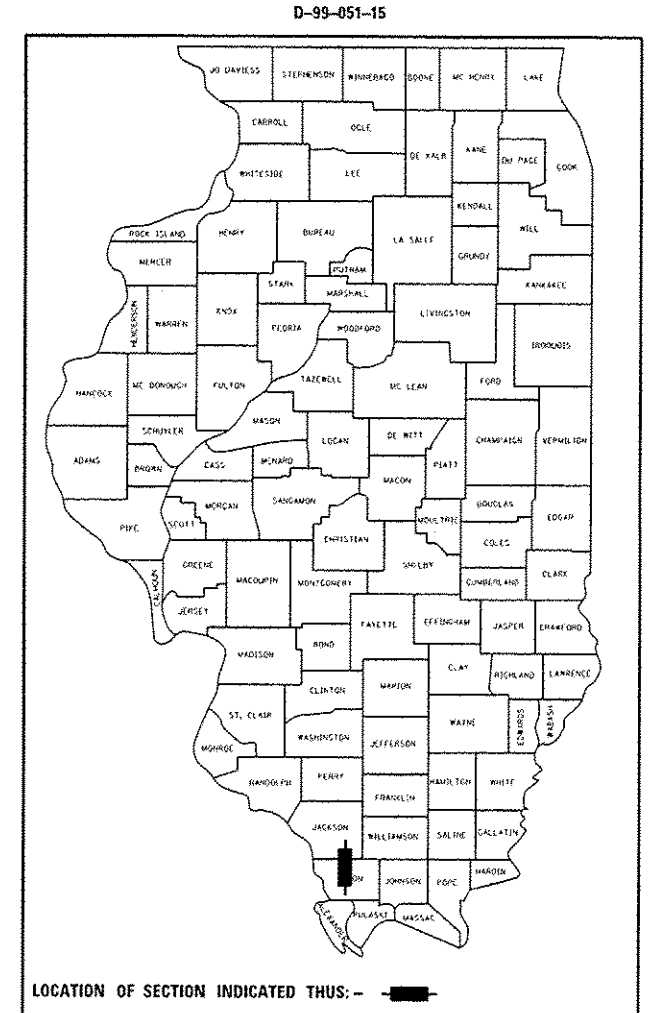

STATE OF ILLINOIS
DEPARTMENT OF TRANSPORTATION
DIVISION OF HIGHWAYS

SUBMITTED Oct 2 2015

Arthur J. Keenan
DEPUTY DIRECTOR OF HIGHWAYS, REGION ENGINEER

Dec 4 2015
John D. Baranzelli PE
ENGINEER OF DESIGN AND ENVIRONMENT

Dec 4 2015
Omar Osman PE
DIRECTOR OF HIGHWAYS, CHIEF ENGINEER

PRINTED BY THE AUTHORITY
OF THE STATE OF ILLINOIS

Prepared By:

DISTRICT STUDIES & PLANS ENGINEER

Examined By:

DISTRICT LAND ACQUISITION ENGINEER

Examined By:

DISTRICT PROGRAM DEVELOPMENT ENGINEER

Examined By:

DISTRICT OPERATIONS ENGINEER

Examined By:

DISTRICT PROJECT IMPLEMENTATION ENGINEER

Examined By:

DISTRICT CONSTRUCTION ENGINEER

Examined By:

DISTRICT MATERIALS ENGINEER

FILE NAME:	USER NAME:	DESIGNED -	REVISED -
PROJECT:	PROJECT:	DRAWN -	REVISED -
DATE:	DATE:	CHECKED -	REVISED -
		DATE -	REVISED -

STATE OF ILLINOIS
DEPARTMENT OF TRANSPORTATION

SIGNATURE SHEET

SCALE: SHEET OF SHEETS STA. TO STA.

F.A.P. RTE.	SECTION	COUNTY	TOTAL SHEETS	SHEET NO.
322	(10,10-2,11-1,12-1,13) RS-3	*	18	2
CONTRACT NO. 78491			ILLINOIS FED. AID PROJECT	

INDEX OF SHEETS

<u>SHEET NO.</u>	<u>DESCRIPTION</u>
1	COVER SHEET
2	SIGNATURE SHEET
3	INDEX OF SHEETS, HIGHWAY STANDARDS & COMMITMENTS
4	GENERAL NOTES & MIX DESIGN
5-7	SUMMARY OF QUANTITIES
8	TYPICAL SECTIONS
9-15	SCHEDULES
16-18	DETAILS

HIGHWAY STANDARDS

000001-06	Standard Symbols, Abbreviations and Patterns
406201-01	Mailbox Turnout
442101-07	Class B Patches
701306-03	Lane Closure, 2L, 2W, Slow Moving Operations Day Only, for Speeds > 45 MPH
701311-03	Lane Closure, 2L, 2W, Moving Operations - Day Only
701336-06	Lane Closure, 2L, 2W, Work Areas in Series, for Speeds > 45 MPH
701901-04	Traffic Control Devices
780001-05	Typical Pavement Markings
781001-03	Typical Applications Raised Reflective Pavement Markers

COMMITMENTS

NONE

FILE NAME =	USER NAME = mssbl	DESIGNED -	REVISED -	STATE OF ILLINOIS DEPARTMENT OF TRANSPORTATION	INDEX, STANDARDS & COMMITMENTS	F.A.P. RTE.	SECTION	COUNTY	TOTAL SHEETS	SHEET NO.	
p:\NLS\884EB\INTEG\illinois.gov\100710	Documents\DOT Offices\District 9\Projects\78491\78491.dgn	CHECKED -	REVISED -			322	(10,10-2,11-1,12-1,13)	RS-3		18	3
Default	PLOT SCALE = 100.0000' / 1" =	DATE -	REVISED -			CONTRACT NO. 78491					
	PLOT DATE = 10/14/2015					ILLINOIS FED. AID PROJECT * JACKSON/UNION					

GENERAL NOTES

FACTORS USED FOR ESTIMATING PLAN QUANTITIES ARE AS FOLLOWS AND SHALL NOT BE USED FOR THE BASIS OF FINAL QUANTITIES:

ALL HOT-MIX ASPHALT
2.016 TONS/CU. YD.

ALL AGGREGATE
2.05 TONS/CU. YD.

RIPRAP
1.50 TONS/CU. YD.

THE CONTRACTOR SHALL STAMP STATIONING IN THE PROPOSED HOT MIX ASPHALT SURFACE AT 300 FT. INTERVALS ON ALTERNATING SIDES OF THE PAVEMENT AND AS DIRECTED BY THE ENGINEER. THE STATION SYMBOL STAMPS USED SHALL BE FURNISHED BY THE CONTRACTOR. THEY SHALL BE 5 1/2 IN. TALL, OF A DESIGN APPROVED BY THE ENGINEER, AND SHALL REMAIN THE PROPERTY OF THE CONTRACTOR.

SAW CUTS REQUIRED FOR BUTT JOINTS SHALL NOT BE PAID FOR SEPARATELY BUT SHALL BE INCLUDED IN THE COST OF THE BUTT JOINT.

THE QUANTITY SHOWN IN THE PLANS FOR PATCHING AND THE ASSOCIATED BITUMINOUS MATERIALS (PRIME COAT) ARE ESTIMATES. THE ACTUAL AMOUNT OF PATCHING REQUIRED SHALL BE DETERMINED BY THE ENGINEER IN THE FIELD.

EXISTING CONCRETE PATCHES ENCOUNTERED DURING MILLING OPERATIONS SHALL BE MILLED WITH THE SURROUNDING HMA SURFACE REMOVAL. NO ADDITIONAL COMPENSATION WILL BE PROVIDED.

ALL EQUIPMENT USED FOR THE PLACEMENT OF THE INCIDENTAL HOT-MIX ASPHALT SURFACING SHALL BE APPROVED BY THE ENGINEER PRIOR TO ITS USE.

IN ADDITION TO THE REQUIREMENTS OF ARTICLE 107.16, THE CONTRACTOR SHALL PROTECT THE SURFACE OF ALL BRIDGE DECKS AND BRIDGE APPROACH PAVEMENTS IN A MANNER SATISFACTORY TO THE ENGINEER BEFORE ANY EQUIPMENT IS ALLOWED TO CROSS THE STRUCTURE. PROTECTION SHALL BE PROVIDED FOR ALL EQUIPMENT AS DEFINED IN ARTICLE 101.17 REGARDLESS IF TRACK MOUNTED OR WHEELED.

THE QUANTITY OF SHORT TERM PAVEMENT MARKINGS SHOWN IN THE PLANS IS BASED ON ONE APPLICATION EACH FOR THE HMA SURFACE REMOVAL, SURFACE COURSE, AND BINDER COURSE.

BITUMINOUS RESURFACING SHALL BE PLACED IN A SEQUENCE THAT WILL MINIMIZE THE TIME THE CENTERLINE EDGE IS EXPOSED TO TRAFFIC. WHEN AT THE END OF A DAY'S OPERATION THE EXPOSED CENTERLINE EDGE IS GREATER THAN 2,000 FT., THE CONTRACTOR SHALL BE REQUIRED TO PAVE IN THE ADJACENT LANE ON THE FOLLOWING WORK DAY. PRIOR TO WINTER SHUTDOWN, RESURFACING ON ADJACENT LANES IS TO BE BROUGHT UP TO THE SAME ELEVATION.

PRIOR TO PLACEMENT OF THE FINAL PAVEMENT MARKINGS THE RESIDENT ENGINEER SHOULD CONTACT THE BUREAU OF OPERATIONS AND ARRANGE FOR INSPECTION AND APPROVAL OF THE PAVEMENT MARKING LAYOUT.

MIX DESIGN

Locations	Hot-Mix Asphalt Surface Course
Mixture Use(s):	Hot-Mix Asphalt Surface Course, Mix D, N90
AC/PG:	PG64-22
ABR % (Max):	See Special Provision
Design Air Voids:	4.0 %, 90 Gyration Design
Mixture Composition: (Gradation Mixture)	IL-9.5 mm
Friction Aggregate:	D Surface
Quality Management Program:	OCP

Locations	Hot-Mix Asphalt Leveling Binder Course
Mixture Use(s):	Hot-Mix Asphalt Leveling Binder, N90, IL-9.5mm Fine Grade
AC/PG:	PG64-22
ABR % (Max):	See Special Provision
Design Air Voids:	4.0 %, 90 Gyration Design
Mixture Composition: (Gradation Mixture)	IL-9.5mm Fine Grade
Friction Aggregate:	None
Quality Management Program:	OCP

Locations	Hot-Mix Asphalt Shoulders and Incidental HMA Surfacing
Mixture Use(s):	Hot-Mix Asphalt Surface Course, Mix C, N70
AC/PG:	PG64-22
ABR % (Max):	See Special Provision
Design Air Voids:	4.0 %, 70 Gyration Design
Mixture Composition: (Gradation Mixture)	IL-9.5 mm
Friction Aggregate:	C Surface
Quality Management Program:	OCP - Hot-Mix asphalt Shoulders QCOA - Incidental Hot-Mix Asphalt Surfacing

MTD CROSSING RESTRICTIONS TABLE

SN & CENTERLINE STATION ROUTE US 51	EXISTING FILL HEIGHT OVER BOX CULVERT	THICKNESS OF EXISTING PAVEMENT OVER BOX CULVERT	MTD CROSSING RESTRICTIONS
	FOOT	INCH	
SN 039-2012 (STA. 412+00)	66.5		TBD
SN 091-2007 (STA. 547+18)	34.2		TBD
SN 091-0073 (STA. 582+19)			TBD
SN 091-2011 (STA. 715+90)	6.8		TBD
SN 091-2001 (STA. 750+19)	15.2		TBD
SN 091-0022 (STA. 801+60)			TBD
SN 091-2002 (STA. 864+75)	19.0		TBD

*The Contractor shall refer to BDE Special Provision for Material Transfer Device.

SUMMARY OF QUANTITIES

COUNTY:	UNION	JACKSON
ROUTE:	FAP 322, US 51	
FUNDING:	80% FED/20% STATE	
LOCATION:	RURAL	

CODE NUMBER	ITEM DESCRIPTION	UNIT	TOTAL QUANTITY	ROADWAY	
				0005	0005
40600275	BITUMINOUS MATERIALS (PRIME COAT)	POUND	136,200	120,539	15,661
40600647	LEVELING BINDER (MACHINE METHOD), IL-9.5FG, N90	TON	6,341	5,573	768
40600982	HOT-MIX ASPHALT SURFACE REMOVAL - BUTT JOINT	SO YD	2,708	2,295	413
40600990	TEMPORARY RAMP	SO YD	214	196	18
40603345	HOT-MIX ASPHALT SURFACE COURSE, MIX "D", N90	TON	13,095	11,555	1,540
40800050	INCIDENTAL HOT-MIX ASPHALT SURFACING	TON	360	320	40
44000153	HOT-MIX ASPHALT SURFACE REMOVAL, 1"	SO YD	150,959	132,689	18,270
44000155	HOT-MIX ASPHALT SURFACE REMOVAL, 1 1/2"	SO YD	5,596	5,596	0
44200982	CLASS B PATCHES, TYPE II, 11 INCH	SO YD	3,037	2,821	216
44200986	CLASS B PATCHES, TYPE III, 11 INCH	SO YD	275	173	102
44201299	DOWEL BARS 1 1/2"	EACH	7,360	6,760	600
44213100	PAVEMENT FABRIC	SO YD	275	173	102

12

SUMMARY OF QUANTITIES - CONT

COUNTY:	UNION	JACKSON
ROUTE:	FAP 322, US 51	
FUNDING:	80% FED/20% STATE	
LOCATION:	RURAL	

CODE NUMBER	ITEM DESCRIPTION	UNIT	TOTAL QUANTITY	ROADWAY	
				0005	0005
44213200	SAW CUTS	FOOT	16,284	14,850	1,434
48102100	AGGREGATE WEDGE SHOULDER, TYPE B	TON	2,104	1,821	283
48203100	HOT-MIX ASPHALT SHOULDERS	TON	4,782	4,291	491
67000400	ENGINEER'S FIELD OFFICE, TYPE A	CAL MO	8	6	2
67100100	MOBILIZATION	LSUM	1.0	0.8	0.2
70100460	TRAFFIC CONTROL AND PROTECTION, STANDARD 701306	LSUM	1.0	0.8	0.2
70100600	TRAFFIC CONTROL AND PROTECTION, STANDARD 701336	LSUM	1.0	0.8	0.2
70106800	CHANGEABLE MESSAGE SIGN	CAL MO	1.0	0.8	0.2
70300100	SHORT TERM PAVEMENT MARKING	FOOT	17,033	15,060	1,973
70300210	TEMPORARY PAVEMENT MARKING LETTERS AND SYMBOLS	SO FT	219	146	73
70300220	TEMPORARY PAVEMENT MARKING - LINE 4"	FOOT	146,742	129,818	16,924
70300280	TEMPORARY PAVEMENT MARKING - LINE 24"	FOOT	70	70	0

12

SUMMARY OF QUANTITIES - CONT

COUNTY:	UNION	JACKSON
ROUTE:	FAP 322, US 51	
FUNDING:	80% FED/20% STATE	
LOCATION:	RURAL	

CODE NUMBER	ITEM DESCRIPTION	UNIT	TOTAL QUANTITY	ROADWAY	
				0005	0005
70301000	WORK ZONE PAVEMENT MARKING REMOVAL	SO FT	164,063	145,094	18,969
* 78009000	MODIFIED URETHANE PAVEMENT MARKING - LETTERS AND SYMBOLS	SO FT	218	145	73
* 78009004	MODIFIED URETHANE PAVEMENT MARKING - LINE 4"	FOOT	146,492	129,568	16,924
* 78009024	MODIFIED URETHANE PAVEMENT MARKING - LINE 24"	FOOT	70	70	0
* 78100100	RAISED REFLECTIVE PAVEMENT MARKER	EACH	744	658	86
78300200	RAISED REFLECTIVE PAVEMENT MARKER REMOVAL	EACH	710	628	82
<input type="checkbox"/> X2503100	MOWING	UNIT	649	506	143
<input type="checkbox"/> Z0076600	TRAINEES	Hour	500	500	
Z0034105	MATERIAL TRANSFER DEVICE	TON	19,436	17,128	2,308
<input type="checkbox"/> Z0076604	TRAINEES TRAINING PROGRAM GRADUATE	Hour	500	500	

- * SPECIALTY ITEM
- NON-PART. (100% STATE)
- 0042

- ① PROP. HMA SURFACE REMOVAL, 1"
- ② PROP. HMA SURFACE REMOVAL, 1 1/2"
- ③ PROP. HMA BINDER COURSE, 3/4"
- ④ PROP. HMA SURFACE COURSE, 1 1/2"
- ⑤ PROP. HMA SHOULDERS, 1 1/4"
- ⑥ PROP. AGGREGATE SHOULDER WEDGE, 1 1/4"
- ⑦ EXIST. AGGREGATE SUBBASE, 4"
- ⑧ EXIST. PCC PAVEMENT, 8"
- ⑨ EXIST. HMA OVERLAY, 2 1/2"
- ⑩ EXIST. HMA SHOULDER, 8"
- ⑪ EXIST. AGGREGATE SHOULDER, 8"
- ⑫ EXIST. RAISED MEDIAN

HMA SURFACE REMOVAL, 3/4"

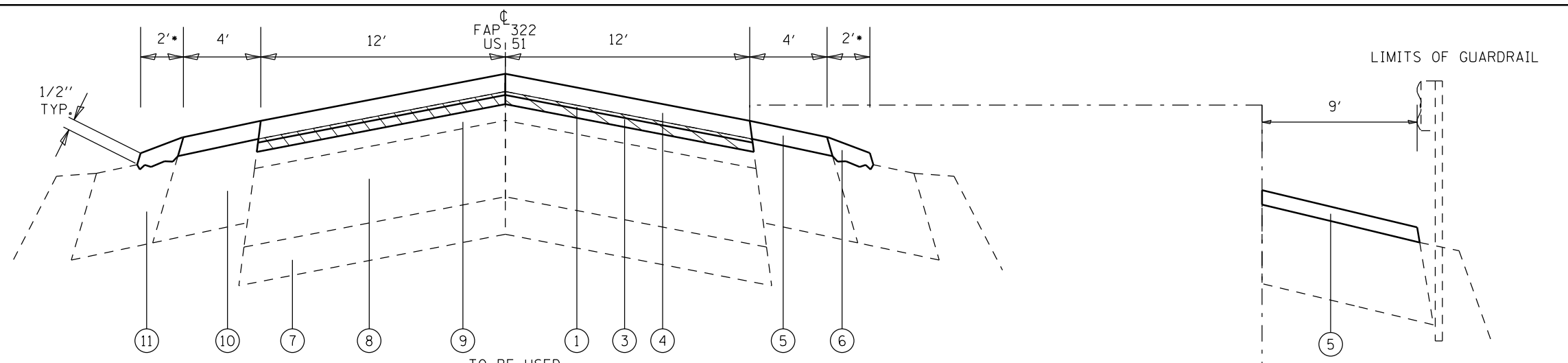

TO BE USED:

JACKSON COUNTY	UNION COUNTY	UNION COUNTY
STA. 376+23 TO STA. 376+53	STA. 441+00 TO STA. 452+17	STA. 690+71 TO STA. 706+77
STA. 387+84 TO STA. 411+00	STA. 452+98 TO STA. 536+58	STA. 722+07 TO STA. 768+89
STA. 410+00 TO STA. 441+00	STA. 536+34 TO STA. 595+77	STA. 768+96 TO STA. 800+84
	STA. 595+81 TO STA. 623+39	STA. 802+36 TO STA. 927+31
	STA. 623+40 TO STA. 638+06	STA. 927+36 TO STA. 939+89
	STA. 638+05 TO STA. 690+90	

TO BE USED:
SEE SHOULDER SCHEDULE,
ON SHEETS 12 & 13, FOR
LEFT AND RIGHT STATIONS

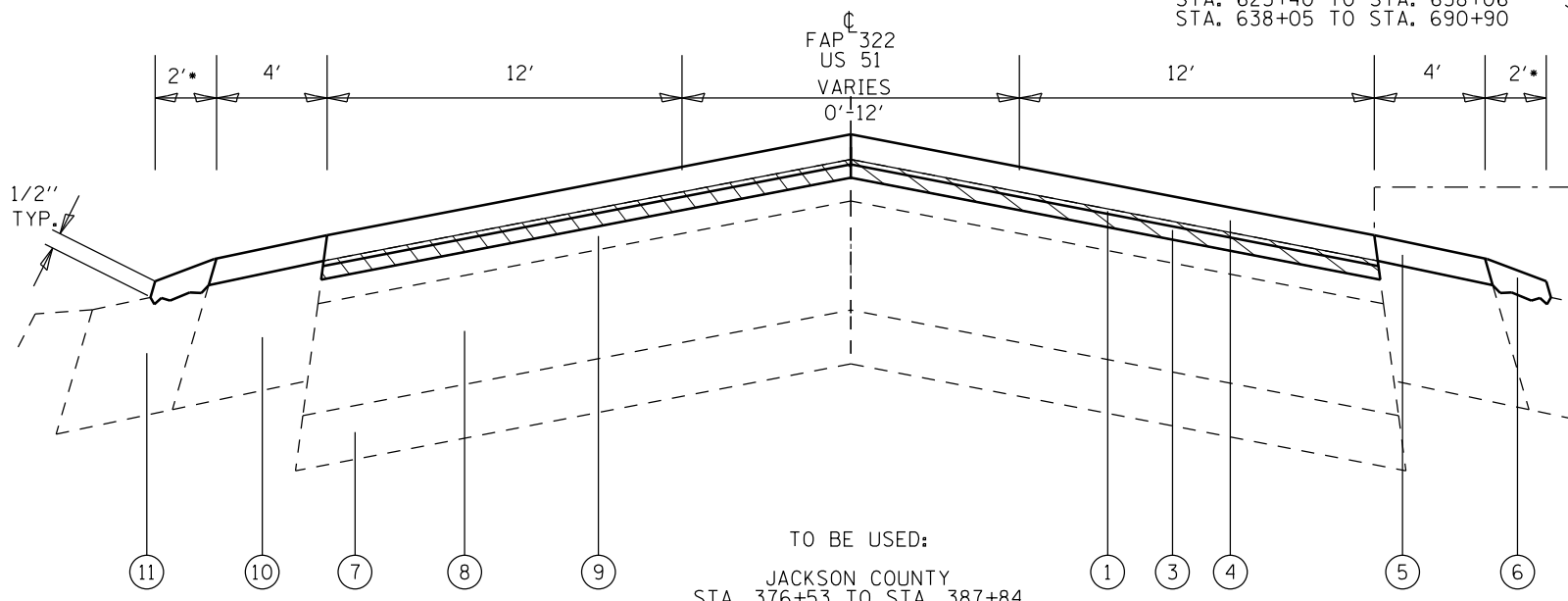

TO BE USED:

JACKSON COUNTY
STA. 376+53 TO STA. 387+84
UNION COUNTY
STA. 706+77 TO STA. 722+07

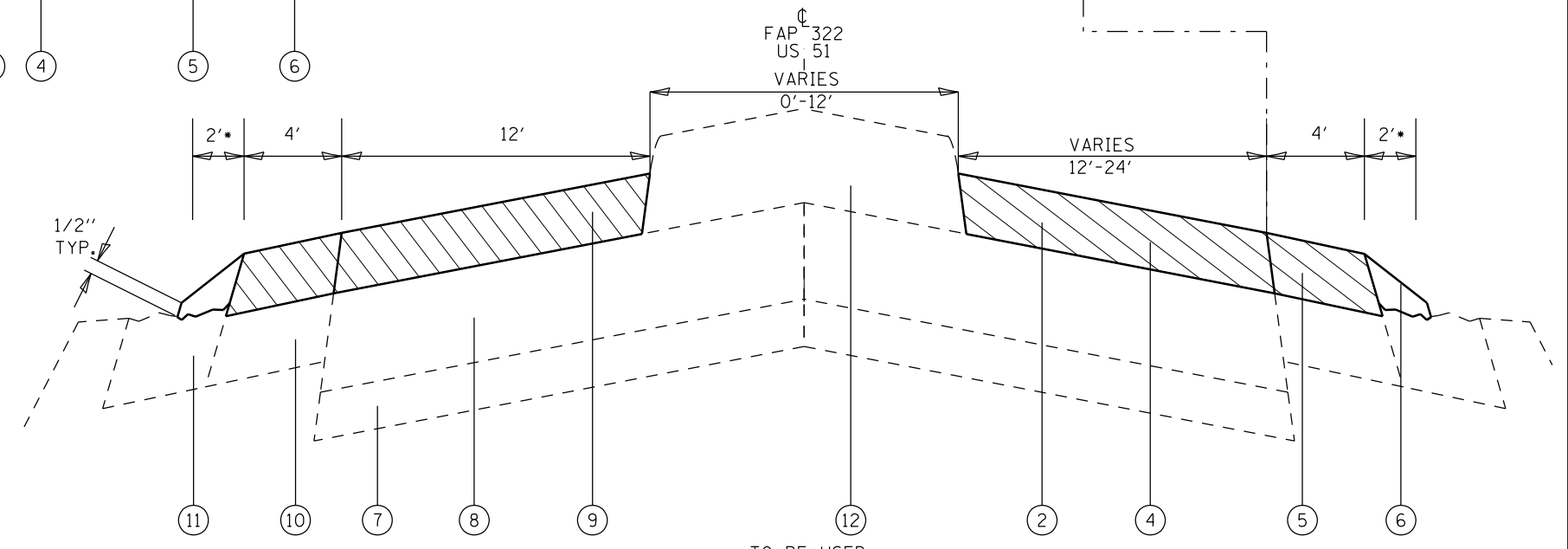

TO BE USED:

UNION COUNTY
STA. 939+89 TO STA. 949+03

* ADDITIONAL QUANTITY HAS BEEN ADDED TO AGGREGATE SHOULDER WEDGE QUANTITY TO CORRECT LOW SHOULDER AREAS

FILE NAME =	USER NAME = maebl	DESIGNED -	REVISED -	STATE OF ILLINOIS DEPARTMENT OF TRANSPORTATION	TYPICAL SECTIONS			F.A.P. RTE. 322	SECTION (10,10-1,11-1,12-1,13) RS-3	COUNTY *	TOTAL SHEETS 18	SHEET NO. 8
Default	Documents\DOT Offices\District 9\Projects\78491\Drawings\CADsheets\78491.sht.dgn	CHECKED -	REVISED -		SCALE:	SHEET	OF SHEETS	STA.	TO STA.	CONTRACT NO. 78491		
	PLOT SCALE = 100.0000' / in.	DATE -	REVISED -							ILLINOIS FED. AID PROJECT		
	PLOT DATE = 10/14/2015									* JACKSON/UNION		

MAINLINE SCHEDULE

LOCATION			PAVEMENT REMOVAL, 1"	PAVEMENT REMOVAL, 1 1/2"	HMA SURFACE COURSE, 1 1/2"	HMA LEVELING BINDER COURSE, 3/4"	MATERIAL TRANSFER DEVICE	BITUMINOUS MATERIALS (PRIME COAT)*	HMA SURFACE REMOVAL - BUTT JOINT*	TEMP RAMP	REMARKS
STA.	TO	STA.	SQ YD	SQ YD	TON	TON	TON	POUND	SQ YD	SQ YD	
JACKSON COUNTY											
376+23	TO	376+48	40		7	0	7	60	36	18	BUTT JOINT
376+48	TO	387+84	3787		319	160	479	2556			TURN LANE SECTION
387+84	TO	411+00	6176		519	260	779	4169			
411+00	=	410+00	STATION EQUATION								
410+00	TO	441+00	8267		695	348	1043	5580			
JACKSON COUNTY TOTALS			18270	0	1540	768	2308	12365	36	18	
UNION COUNTY											
441+00	TO	452+17	2979		251	126	377	2011			
452+17	=	452+98	STATION EQUATION								
452+98	TO	536+58	22294		1873	937	2810	15048			
536+58	=	536+34	STATION EQUATION								
536+34	TO	581+50	12043		1012	506	1518	8129			
581+50	TO	581+75	40		7	0	7	60	36	18	TRANSITION TO STRUCTURE
581+75	TO	585+74	GAP SN 091-0073								
585+74	TO	585+99	40		7	0	7	61	36	18	TRANSITION TO STRUCTURE
585+99	TO	595+77	2608		220	110	330	1761			
595+77	=	595+81	STATION EQUATION								
595+81	TO	623+39	7355		618	309	927	4965			
623+39	=	623+40	STATION EQUATION								
623+40	TO	638+06	3910		329	165	494	2639			
638+06	=	638+05	STATION EQUATION								
638+05	TO	690+90	14094		1184	592	1776	9513			
690+90	=	690+71	STATION EQUATION								
690+71	TO	706+77	4283		360	180	540	2891			
706+77	TO	722+07	5100		429	215	644	3443			TURN LANE SECTION
722+07	TO	768+89	12486		1049	525	1574	8428			
768+89	=	768+96	STATION EQUATION								
768+96	TO	800+59	8435		709	355	1064	5694			
800+59	TO	800+84	40		7	0	7	60	36	18	TRANSITION TO STRUCTURE
800+84	TO	802+36	GAP SN 091-0022								
802+36	TO	802+61	40		7	0	7	60	36	18	TRANSITION TO STRUCTURE
802+61	TO	927+31	33254		2794	1397	4191	22446			
927+31	=	927+36	STATION EQUATION								
927+36	TO	934+33	1859		157	79	236	1255			
934+33	TO	939+64	1829		154	77	231	1235			LANES WIDEN TO END OF JOB
939+64	TO	939+89	0	150	12	0	12	49			TRANSITION TO INLAY
939+89	TO	949+03	0	5446	376	0	376	2012		124	1 1/2" INLAY, MILL EOS TO EOS
UNION COUNTY TOTALS			132689	5596	11555	5573	17128	91760	144	196	
TOTALS			150959	5596	13095	6341	19436	104125	180	214	

* SEE SHOULDER, SIDEROAD AND ENTRANCE SCHEDULES FOR ADDITIONAL PAVEMENT QUANTITIES

FILE NAME =	USER NAME = maesbl	DESIGNED -	REVISED -	STATE OF ILLINOIS DEPARTMENT OF TRANSPORTATION	MAINLINE SCHEDULE	F.A.P. RTE.	SECTION	COUNTY	TOTAL SHEETS	SHEET NO.	
p:\11\084EBIDINTEG\illinois.gov\PIWIDOT\Documents\DOT Offices\District 9\Projects\78491\Drawings\CAD\Sheets\78491.sht.dgn		CHECKED -	REVISED -			322	(10,10-1,11-1,12-1,13) RS-3	*	18	9	
Default	PLOT SCALE = 100.0000' / 1in.	DATE -	REVISED -			CONTRACT NO. 78491					
	PLOT DATE = 10/14/2015					SCALE:	SHEET	OF	SHEETS	STA.	TO

ENTRANCE SCHEDULE

LOCATION	LT/RT	TYPE OF ENTRANCE	EXISTING SURFACE TYPE	PROPOSED WIDTH AT END OF APRON (17' MAX)	PROPOSED AREA	INCIDENTAL HOT-MIX ASPHALT SURFACING*	BITUMINOUS MATERIALS (PRIME COAT)*	REMARKS
STATION				FOOT	SQ FT	TON	POUND	
JACKSON COUNTY								
418+30	LT	PE	AGG					
JACKSON COUNTY TOTALS						0	0	
UNION COUNTY								
441+01	RT	PE	O&C	17	68	0.5	3.4	
441+04	LT	PE	AGG					
492+75	RT	CE	AGG					RUSTLE HILL WINERY
536+97	RT	PE	HMA	17	68	0.5	3.4	
626+90	LT	PE	AGG					
626+95	RT	PE	AGG					
796+18	RT	PE	AGG					
796+18	LT	PE	AGG					
819+10	LT	PE	AGG					
819+23	RT	PE	AGG					
UNION COUNTY TOTALS						1	7	
TOTALS						1	7	

* SEE SHOULDER, SIDEROAD AND MAINLINE SCHEDULES FOR ADDITIONAL PAVEMENT QUANTITIES

SIDEROAD SCHEDULE

LOCATION		LT/RT	EXISTING SURFACE TYPE	PROPOSED WIDTH AT END OF APRON	PROPOSED AREA	INCIDENTAL HOT-MIX ASPHALT SURFACING*	BITUMINOUS MATERIALS (PRIME COAT)*	HMA SURFACE REMOVAL - BUTT JOINT*	REMARKS
ROAD NAME	STATION			FOOT	SQ FT	TON	POUND	SQ YD	
JACKSON COUNTY									
MAKANDA RD	382+12	RT	HMA	80	1696	19.8	84.8	188.5	
MAKANDA RD	382+12	LT	HMA	79	1694	19.8	84.7	188.3	
JACKSON COUNTY TOTALS						40	170	377	
UNION COUNTY									
B R BOYD LN	481+99	RT	AGG	24	484	2.3	24.2		
CEDAR BLUFF LN	481+99	LT	AGG	24	467	2.2	23.4		
UNNAMED	492+75	LT	O&C	37	827	8.1	41.4		ACROSS FROM RUSTLE HILL WINERY
LIMESTONE SCHOOL RD	514+38	RT	HMA	39	848	9.9	42.4	94.3	
LIMESTONE SCHOOL RD	514+38	LT	HMA	41	881	10.3	44.1	97.9	
HAND LN	536+97	LT	O&C	22	509	5.9	25.5		
COBDEN SCHOOL RD	568+75	RT	HMA	48	1031	12.1	51.6	114.6	
BASS LN	568+75	LT	AGG	33	638	3.0	31.9		
BLUEBERRY HILL RD	597+35	RT	O&C	45	996	9.3	49.8		
DEPPER RD	597+35	LT	O&C	48	1087	9.9	54.4		
BELL HILL RD	661+74	RT	HMA	64	1284	15.0	64.2	142.7	
WATER VALLEY RD	661+74	LT	HMA	55	1247	14.6	62.4	138.6	
WING HILL RD	714+71	RT	HMA	85	1826	21.4	91.3	202.9	
WING HILL RD	714+71	LT	HMA	59	1234	14.4	61.7	137.2	
JOHN RICH SCHOOL RD	743+77	LT	O&C	42	910	8.7	45.5		
VINES RD	743+80	RT	O&C	39	865	8.3	43.3		
SPANISH BLUFF RD	772+06	RT	O&C	46	995	9.3	49.8		
SPANISH BLUFF RD	772+15	LT	O&C	44	924	8.8	46.2		
HALEY RD	846+37	LT	HMA	40	891	10.4	44.6	99.0	
OTTEN LN	846+39	RT	HMA	43	956	11.2	47.8	106.3	
SPANISH BLUFF RD	861+78	LT	O&C	47	1048	9.6	52.4		
LIME KILN RD	861+82	RT	O&C	45	1036	9.5	51.8		
TWIN SPRING LOOP	900+19	LT	HMA	45	1015	11.9	50.8	112.8	
ANNA QUARRY RD	900+23	RT	HMA	51	1088	9.9	54.4	120.9	
PEACH RIDGE RD	936+81	LT	PCC	12	275	3.3	13.8	30.6	
UNION COUNTY TOTALS						319	1508	2151	
TOTALS						359	1677	2528	

* SEE SHOULDER, ENTRANCE AND MAINLINE SCHEDULES FOR ADDITIONAL PAVEMENT QUANTITIES

SHOULDER SCHEDULE

LOCATION			HMA SHLD	BITUMINOUS MATERIALS (PRIME COAT) *	AGGREGATE WEDGE SHLD, TYPE B **	REMARKS
STA.	TO	STA.	TON	POUNDS	TON	
JACKSON COUNTY						
376+23	TO	376+48	3	10	1	BUTT JOINT
376+48	TO	387+84	71	454	58	TURN LANE SECTION
387+84	TO	395+86	50	321	41	
395+86	TO	397+44	16	103	4	WIDE SHLD RT
397+44	TO	401+22	53	340	0	WIDE SHLD RT<
401+22	TO	401+42	3	13	1	WIDE SHLD RT
401+42	TO	411+00	60	383	48	
411+00	=	410+00				
410+00	TO	427+70	111	708	90	
427+70	TO	438+18	106	681	27	WIDE SHLD RT
438+18	TO	441+00	18	113	14	
JACKSON COUNTY TOTALS			491	3126	283	

* SEE MAINLINE, SIDEROAD AND ENTRANCE SCHEDULES FOR ADDITIONAL PAVEMENT QUANTITIES

** ADDITIONAL QUANTITY HAS BEEN ADDED TO CORRECT LOW SHOULDER AREAS

SHOULDER SCHEDULE CONT.

LOCATION			HMA SHLD	BITUMINOUS MATERIALS (PRIME COAT) *	AGGREGATE WEDGE SHLD, TYPE B **	REMARKS
STA.	TO	STA.	TON	POUNDS	TON	
UNION COUNTY						
441+00	TO	442+57	10	63	8	
442+57	TO	443+20	7	41	2	WIDE SHLD LT
443+20	TO	449+95	95	608	0	WIDE SHLD RT<
449+95	TO	452+17	23	144	6	WIDE SHLD LT
452+17	=	452+98				
452+98	TO	455+32	24	152	6	WIDE SHLD LT
455+32	TO	464+62	58	372	47	
464+62	TO	464+74	2	8	0	WIDE SHLD RT
464+74	TO	473+90	129	824	0	WIDE SHLD RT<
473+90	TO	474+38	5	31	1	WIDE SHLD LT
474+38	TO	482+02	48	306	39	
482+02	TO	482+60	6	38	1	WIDE SHLD RT
482+60	TO	487+05	63	401	0	WIDE SHLD RT<
487+05	TO	487+78	8	47	2	WIDE SHLD RT
487+78	TO	502+81	94	601	76	
502+81	TO	507+30	46	292	11	WIDE SHLD LT
507+30	TO	521+19	87	556	70	
521+19	TO	524+42	33	210	8	WIDE SHLD RT
524+42	TO	528+30	55	349	0	WIDE SHLD RT<
528+30	TO	529+83	16	99	4	WIDE SHLD RT
529+83	TO	536+58	42	270	34	
536+58	=	536+34				
536+34	TO	539+92	23	143	18	
539+92	TO	542+27	24	153	6	WIDE SHLD LT
542+27	TO	551+56	131	836	0	WIDE SHLD RT<
551+56	TO	551+87	4	20	1	WIDE SHLD LT
551+87	TO	556+09	27	169	21	
556+09	TO	559+55	35	225	9	WIDE SHLD LT
559+55	TO	572+34	80	512	65	
572+34	TO	576+92	47	298	12	WIDE SHLD RT
576+92	TO	578+63	11	68	9	
578+63	TO	579+98	14	88	3	WIDE SHLD RT
579+98	TO	581+50	22	137	0	WIDE SHLD RT<
581+50	TO	581+75	4	16	1	TRANSITION TO STRUCTURE GAP STRUCTURE
581+75	TO	585+74				
585+74	TO	585+99	4	16	1	TRANSITION TO STRUCTURE
585+99	TO	586+87	13	79	0	WIDE SHLD RT<
586+87	TO	593+07	63	403	16	WIDE SHLD LT
593+07	TO	595+77	17	108	14	
595+77	=	595+81				
595+81	TO	606+69	68	435	55	
606+69	TO	607+67	10	64	2	WIDE SHLD LT
607+67	TO	611+35	52	331	0	WIDE SHLD RT<
UNION COUNTY SUBTOTALS (1)			1500	9513	547	

* SEE MAINLINE, SIDEROAD AND ENTRANCE SCHEDULES FOR ADDITIONAL PAVEMENT QUANTITIES

** ADDITIONAL QUANTITY HAS BEEN ADDED TO CORRECT LOW SHOULDER AREAS

FILE NAME =	USER NAME = maesbl	DESIGNED -	REVISED -	STATE OF ILLINOIS DEPARTMENT OF TRANSPORTATION	SHOULDER SCHEDULE	F.A.P. RTE.	SECTION	COUNTY	TOTAL SHEETS	SHEET NO.	
p:\11\084EBIDINTEG\illinois.gov\PI\DOT\Documents\DOT Offices\District 9\Projects\78491\Drawings\CAD\Sheets\78491.sht.dgn		CHECKED -	REVISED -			322	(10,10-1,11-1,12-1,13)	RS-3	*	18	12
Default		PLOT SCALE = 100.0000' / in.	DATE -			SCALE:	SHEET 1	OF 2 SHEETS	STA.	TO STA.	CONTRACT NO. 78491
		PLOT DATE = 10/14/2015	DATE -								

SHOULDER SCHEDULE CONT.

LOCATION			HMA SHLD	BITUMINOUS MATERIALS (PRIME COAT) *	AGGREGATE WEDGE SHLD, TYPE B **	REMARKS
STA.	TO	STA.	TON	POUNDS	TON	
UNION COUNTY CONT.						
611+35	TO	617+09	59	373	15	WIDE SHLD LT
617+09	TO	623+39	40	252	32	
623+39	=	623+40				
623+40	TO	636+78	84	535	68	
636+78	TO	637+00	3	14	1	WIDE SHLD RT
637+00	TO	638+06	15	95	0	WIDE SHLD RT<
638+06	=	638+05				
638+05	TO	646+85	124	792	0	WIDE SHLD RT<
646+85	TO	648+94	22	136	5	WIDE SHLD LT
648+94	TO	651+34	15	96	12	
651+34	TO	656+55	53	339	13	WIDE SHLD LT
656+55	TO	666+95	65	416	53	
666+95	TO	667+89	10	61	2	WIDE SHLD LT
667+89	TO	670+71	40	254	0	WIDE SHLD RT<
670+71	TO	673+38	27	174	7	WIDE SHLD LT
673+38	TO	685+68	77	492	62	
685+68	TO	687+32	17	107	4	WIDE SHLD RT
687+32	TO	690+90	51	322	0	WIDE SHLD RT<
690+90	=	690+71				
690+71	TO	694+74	57	363	0	WIDE SHLD RT<
694+74	TO	696+26	16	99	4	WIDE SHLD LT
696+26	TO	706+77	66	420	53	
706+77	TO	707+00	2	9	1	TURN LANE SECTION BEGINS
707+00	TO	707+97	10	63	2	WIDE SHLD RT
707+97	TO	711+10	44	282	0	WIDE SHLD RT<
711+10	TO	711+73	7	41	2	WIDE SHLD RT
711+73	TO	715+31	23	143	18	
715+31	TO	719+86	47	296	12	WIDE SHLD LT
719+86	TO	722+07	14	88	11	TURN LANE SECTION ENDS
722+07	TO	745+04	143	919	116	
745+04	TO	746+44	15	91	4	WIDE SHLD RT
746+44	TO	751+83	76	485	0	WIDE SHLD RT<
751+83	TO	751+85	1	1	0	WIDE SHLD LT
751+85	TO	768+89	107	682	86	
768+89	=	768+96				
768+96	TO	772+23	21	131	17	
772+23	TO	775+23	31	195	8	WIDE SHLD RT
775+23	TO	778+98	24	150	19	
778+98	TO	784+03	52	328	13	WIDE SHLD RT
784+03	TO	799+21	95	607	77	
799+21	TO	799+89	7	44	2	WIDE SHLD RT
799+89	TO	800+59	10	63	0	WIDE SHLD RT<
800+59	TO	800+84	6	23	0	TRANSITION TO STRUCTURE
UNION COUNTY SUBTOTALS (2)			1576	9981	717	

* SEE MAINLINE, SIDEROAD AND ENTRANCE SCHEDULES FOR ADDITIONAL PAVEMENT QUANTITIES
 ** ADDITIONAL QUANTITY HAS BEEN ADDED TO CORRECT LOW SHOULDER AREAS

SHOULDER SCHEDULE CONT.

LOCATION			HMA SHLD	BITUMINOUS MATERIALS (PRIME COAT) *	AGGREGATE WEDGE SHLD, TYPE B **	REMARKS
STA.	TO	STA.	TON	POUNDS	TON	
UNION COUNTY CONT.						
800+84	TO	802+36	0	0	0	GAP STRUCTURE
802+36	TO	802+61	6	23	0	TRANSITION TO STRUCTURE
802+61	TO	803+09	7	43	0	WIDE SHLD RT<
803+09	TO	803+60	6	33	1	WIDE SHLD LT
803+60	TO	830+24	166	1066	135	
830+24	TO	830+49	3	16	1	WIDE SHLD RT
830+49	TO	834+15	52	329	0	WIDE SHLD RT<
834+15	TO	835+64	16	97	4	WIDE SHLD LT
835+64	TO	837+54	12	76	10	
837+54	TO	839+24	18	111	4	WIDE SHLD LT
839+24	TO	845+82	93	592	0	WIDE SHLD RT<
845+82	TO	861+93	101	644	82	
861+93	TO	863+56	17	106	4	WIDE SHLD LT
863+56	TO	866+78	46	290	0	WIDE SHLD RT<
866+78	TO	867+63	9	55	2	WIDE SHLD RT
867+63	TO	880+43	80	512	65	
880+43	TO	881+31	9	57	2	WIDE SHLD RT
881+31	TO	892+14	152	975	0	WIDE SHLD RT<
892+14	TO	893+40	13	82	3	WIDE SHLD LT
893+40	TO	910+68	108	691	87	
910+68	TO	915+86	53	337	13	WIDE SHLD RT
915+86	TO	923+05	45	288	36	
923+05	TO	923+92	9	57	2	WIDE SHLD RT
923+92	TO	927+31	48	305	0	WIDE SHLD RT<
927+31	=	927+36				
927+36	TO	927+88	8	47	0	WIDE SHLD RT<
927+88	TO	928+17	3	19	1	WIDE SHLD LT
928+17	TO	934+33	39	246	31	
934+33	TO	939+45	32	205	26	
939+45	TO	939+64	2	12	0	WIDE SHLD RT
939+64	TO	939+89	5	19	1	TRANSITION TO INLAY
939+89	TO	949+03	57	439	46	1 1/2" INLAY, MILL EOS - EOS
UNION COUNTY SUBTOTALS (3)			1215	7771	557	
UNION COUNTY SUBTOTALS (1)			1500	9513	547	
UNION COUNTY SUBTOTALS (2)			1576	9981	717	
UNION COUNTY TOTALS			4291	27264	1821	
JACKSON COUNTY TOTALS			491	3126	283	
PROJECT TOTALS			4782	30391	2104	

* SEE MAINLINE, SIDEROAD AND ENTRANCE SCHEDULES FOR ADDITIONAL PAVEMENT QUANTITIES
 ** ADDITIONAL QUANTITY HAS BEEN ADDED TO CORRECT LOW SHOULDER AREAS

PAVEMENT MARKING SCHEDULE

LOCATION			MODIFIED URETHANE PVMT. MARK., LINE 4"			MODIFIED URETHANE PVMT. MARK., LINE 24"	MODIFIED URETHANE PVMT. MARK., LETTERS AND SYMBOLS	SHORT TERM PAVEMENT MARKING	TEMPORARY PAVEMENT MARKINGS, LINE 4"	TEMPORARY PAVEMENT MARKINGS, LINE 24"	TEMPORARY PAVEMENT MARKINGS LETTERS & SYMBOLS	RAISED REFLECTIVE PAVEMENT MARKER REMOVAL	RAISED REFLECTIVE PAVEMENT MARKERS	WORK ZONE PAVEMENT MARKING REMOVAL	REMARKS
			WHITE SOLID	YELLOW SOLID	YELLOW DASHED	WHITE SOLID									
STA.	TO	STA.	FOOT	FOOT	FOOT	FOOT	SQ FT	FOOT	FOOT	FOOT	SQ FT	EACH	EACH	FOOT	
JACKSON COUNTY															
376+23.00	TO	382+12.00	1168	1150			36	177	2318		36	7	8	2531	TURN LANE SECTION
382+12.00	TO	388+42.00	1290	1260			36	189	2550		36	8	9	2775	TURN LANE SECTION
388+42.00	TO	411+00.00	4516		565			677	5081			28	29	5758	
411+00.00	=	410+00.00	STATION EQUATION												
410+00.00	TO	441+00.00	6200		775			930	6975			39	40	7905	
JACKSON COUNTY TOTALS			13174	2410	1340	0	73	1973	16924	0	73	82	86	18969	
			16924												

PAVEMENT MARKING SCHEDULE

LOCATION			MODIFIED URETHANE PVMT. MARK., LINE 4"			MODIFIED URETHANE PVMT. MARK., LINE 24"	MODIFIED URETHANE PVMT. MARK., LETTERS AND SYMBOLS	SHORT TERM PAVEMENT MARKING	TEMPORARY PAVEMENT MARKINGS, LINE 4"	TEMPORARY PAVEMENT MARKINGS, LINE 24"	TEMPORARY PAVEMENT MARKINGS LETTERS & SYMBOLS	RAISED REFLECTIVE PAVEMENT MARKER REMOVAL	RAISED REFLECTIVE PAVEMENT MARKERS	WORK ZONE PAVEMENT MARKING REMOVAL	REMARKS
			WHITE SOLID	YELLOW SOLID	YELLOW DASHED	WHITE SOLID									
STA.	TO	STA.	FOOT	FOOT	FOOT	FOOT	SQ FT	FOOT	FOOT	FOOT	SQ FT	EACH	EACH	FOOT	
UNION COUNTY															
441+00.00	TO	452+17.00	2234		279			335	2513			14	15	2848	
452+17.00	=	452+98.00	STATION EQUATION												
452+98.00	TO	536+58.00	16720		2090			2508	18810			105	106	21318	
536+58.00	=	536+34.00	STATION EQUATION												
536+34.00	TO	581+75.00	9082		1135			1362	10217			57	58	11580	
581+75.00	TO	585+74.00	GAP SN 091-0073												
585+74.00	TO	595+77.00	2006		251			301	2257			13	14	2558	
595+77.00	=	595+81.00	STATION EQUATION												
595+81.00	TO	623+39.00	5516		690			827	6206			34	35	7033	
623+39.00	=	623+40.00	STATION EQUATION												
623+40.00	TO	638+06.00	2932		367			440	3299			18	19	3738	
638+06.00	=	638+05.00	STATION EQUATION												
638+05.00	TO	677+86.00	7962		995			1194	8957			50	51	10152	
677+86.00	TO	682+59.00	946	473	118			142	1537			6	7	1679	NO PASSING RT
682+59.00	TO	690+90.00	1662	1662				249	3324			10	11	3573	NO PASSING
690+90.00	=	690+71.00	STATION EQUATION												
690+71.00	TO	692+57.00	372	372				56	744			2	3	800	NO PASSING
692+57.00	TO	696+23.00	732	366	92			110	1190			5	6	1299	NO PASSING LT
696+23.00	TO	706+74.00	2102		263			315	2365			13	14	2680	
706+74.00	TO	714+71.00	1583	1516			36	239	3099		36	10	11	3375	TURN LANE SECTION
714+71.00	TO	722+72.00	1647	1582			36	240	3229		36	10	11	3506	TURN LANE SECTION
722+72.00	TO	751+86.00	5828		729			874	6557			36	37	7431	
751+86.00	TO	764+84.00	2596	1298	325			389	4219			16	17	4608	NO PASSING RT
764+84.00	TO	768+89.00	810	810				122	1620			5	6	1742	NO PASSING
768+89.00	=	768+96.00	STATION EQUATION												
768+96.00	TO	778+98.00	2004	2004				301	4008			13	14	4309	NO PASSING
778+98.00	TO	790+56.00	2316	1158	290			347	3764			14	15	4111	NO PASSING LT
790+56.00	TO	800+84.00	2056		257			308	2313			13	14	2621	
800+84.00	TO	802+36.00	GAP SN 091-0022												
802+36.00	TO	809+00.00	1328		166			199	1494			8	9	1693	
809+00.00	TO	818+28.00	1856	928	232			278	3016			12	13	3294	NO PASSING RT
818+28.00	TO	824+33.00	1210	1210				182	2420			8	9	2602	NO PASSING
824+33.00	TO	835+64.00	2262	1131	283			339	3676			14	15	4015	NO PASSING LT
835+64.00	TO	894+30.00	11732		1467			1760	13199			73	74	14958	
894+30.00	TO	900+19.00	1080	1180				177	2260			7	8	2437	TURN LANE SECTION
900+19.00	TO	908+33.00	1711	1680			36	244	3391		36	10	11	3672	TURN LANE SECTION
908+33.00	TO	927+31.00	3796		475			569	4271			24	25	4840	
927+31.00	=	927+36.00	STATION EQUATION												
927+36.00	TO	939+84.00	2496		312			374	2808			16	17	3182	
939+84.00	TO	949+03.00	2140	919		70	36	276	3059	70	36	11	12	3441	TURN LANE SECTION
UNION COUNTY TOTALS			100717	18289	10562	70	146	15060	129818	70	146	628	658	145094	
			129568												
TOTALS			113891	20699	11901	70	219	17033	146742	70	219	710	744	164063	
			146492												

BUTT JOINT AND STRUCTURE TRANSITION DETAILS

TO BE USED:
NORTH END OF JOB BUTT JOINT
STA. 376+23 TO STA. 376+48

SN 091-0073 TRANSITIONS
STA. 581+50 TO STA. 581+75
STA. 585+74 TO STA. 585+99

SN 091-0022 TRANSITIONS
STA. 800+59 TO STA. 800+84
STA. 802+36 TO STA. 802+61

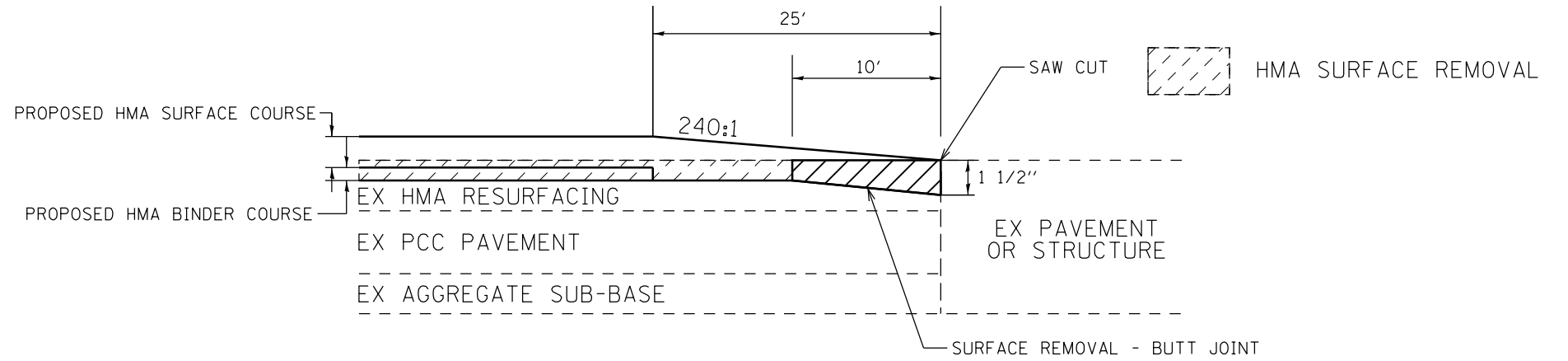

INLAY TRANSITION DETAILS

TO BE USED:
TRANSITION TO INLAY
STA. 939+64 TO STA. 939+89

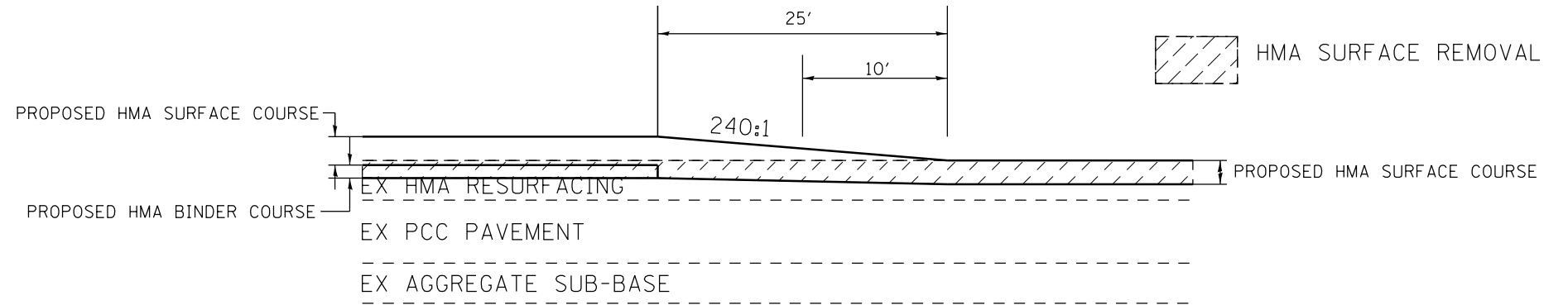

FILE NAME =	USER NAME = maesbl	DESIGNED -	REVISED -	STATE OF ILLINOIS DEPARTMENT OF TRANSPORTATION	DETAILS: BUTT JOINT AND STRUCTURE TRANSITIONS, INLAY TRANSITION	F.A.P. RTE.	SECTION	COUNTY	TOTAL SHEETS	SHEET NO.	
p:\11\084EBIDINTEG.illinois.gov\PIWIDOT\Documents\DOT Offices\District 9\Projects\78491\Drawings\CAD\Sheets\78491.sht.dgn						322	(10,10-1,11-1,12-1,13)	RS-3	•	18	16
Default	PLOT SCALE = 100.0000' / in.	CHECKED -	REVISED -			CONTRACT NO. 78491					
	PLOT DATE = 10/14/2015	DATE -	REVISED -			ILLINOIS FED. AID PROJECT					

SIDEROAD AND ENTRANCE DETAILS

EX. HMA OR PCC SIDEROADS WITH BUTT JOINT

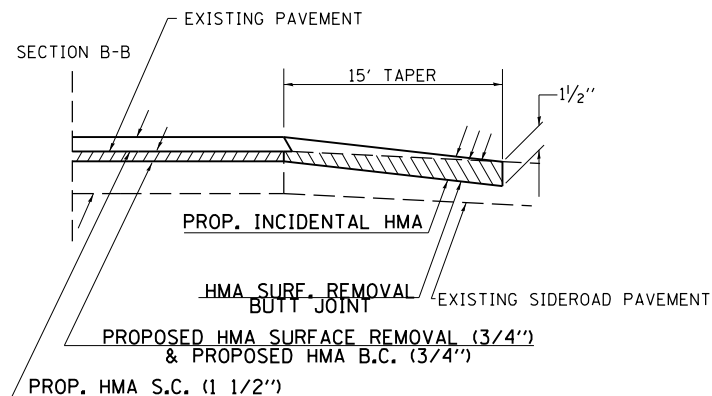

HMA, PCC, OR OIL & CHIP PRIVATE OR COMMERCIAL ENTRANCE (HMA SHLD.)

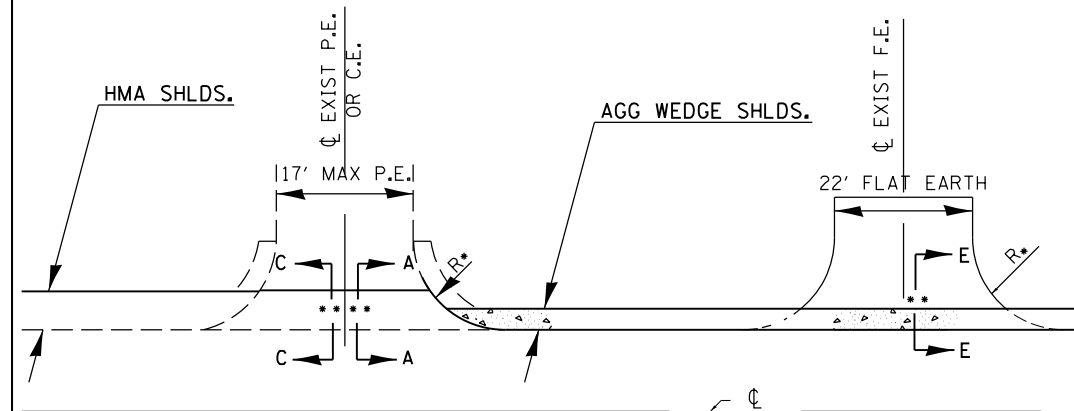
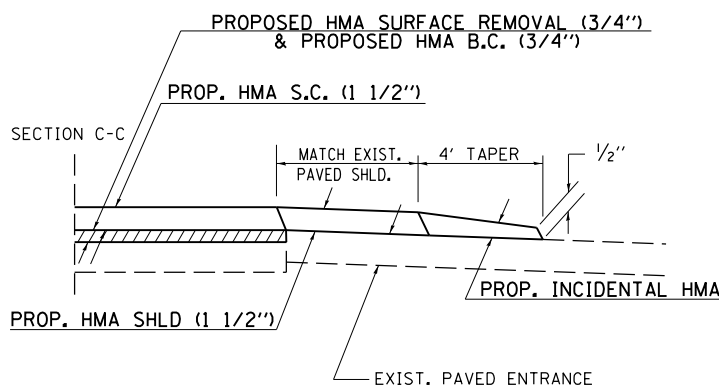

EX. OIL & CHIP SIDEROAD

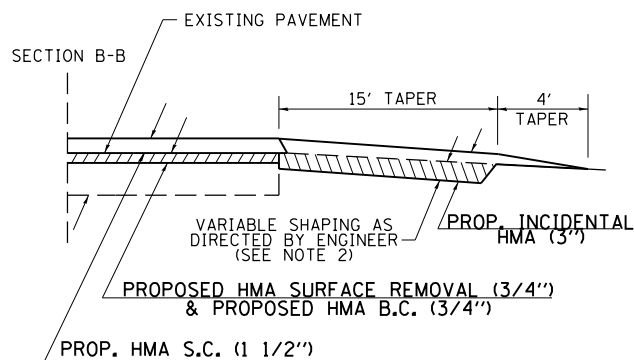

AGG. PRIVATE OR COMMERCIAL ENTRANCE OR AGG. OR EARTH FIELD ENTRANCE (HMA SHLD.)

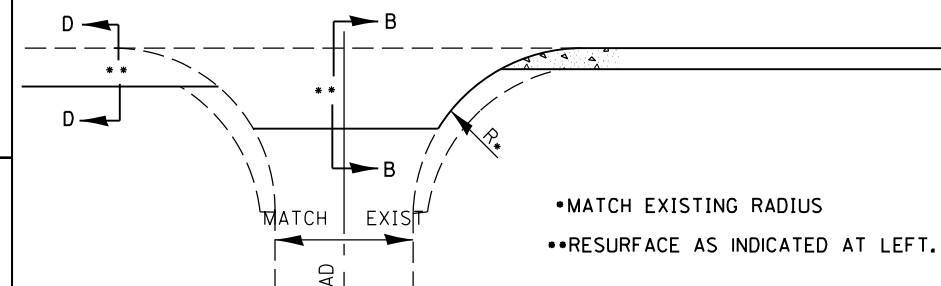
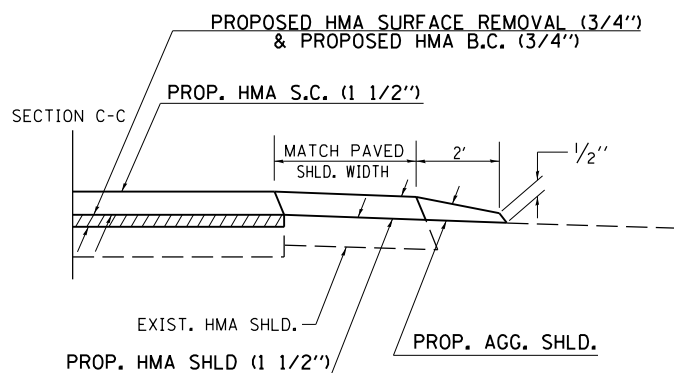

ENTRANCE SCHEDULE

TYPE	NUMBER OF ENTRANCES
P.E.	10
C.E.	1

EX. AGGREGATE SIDEROAD

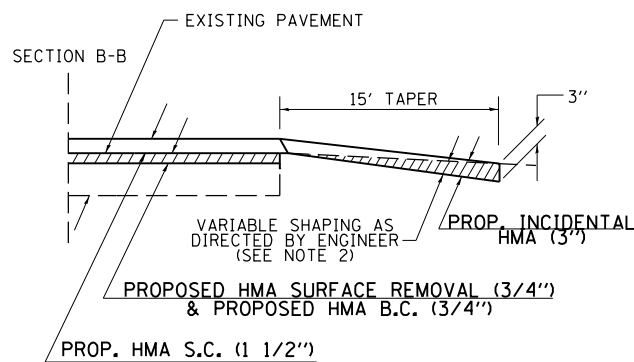

PAVED SHOULDER RESURFACING

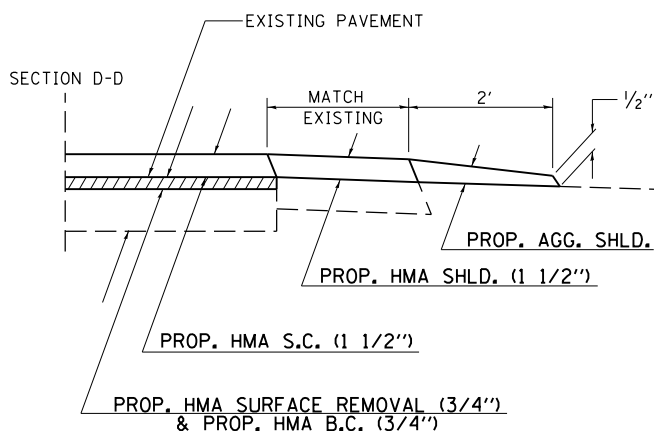

NOTES

- IF EXISTING SUBBASE IS INADEQUATE, AS DETERMINED BY THE ENGINEER, THE SIDE ROADS SHALL BE CORED OUT AND AGGREGATE SUBBASE, TYPE B SHALL BE PLACED FOR BASE. THE COST OF CORING OUT THE SIDE ROAD AND ANY AGGREGATE BASE COURSE SHALL BE PAID FOR AS SPECIFIED IN ART. 109.04 OF THE STANDARD SPECIFICATIONS FOR ROAD AND BRIDGE CONSTRUCTION. IF EXISTING SUBBASE IS DETERMINED TO BE ADEQUATE, THE PREPARATION OF THE BASE SHALL BE CONSTRUCTED ACCORDING TO ARTICLE 406.09.
- VARIABLE SHAPING IS INCLUDED IN THE COST OF INCIDENTAL HOT-MIX ASPHALT SURFACE.

FILE NAME =	USER NAME = maesbl	DESIGNED -	REVISED -
p:\11\084EBIDINTEG.illinois.gov\PIWIDOT\Documents\DOT Offices\District 9\Projects\78491\Drawings\CADsheets\78491.sht.dgn		CHECKED -	REVISED -
Default	PLOT DATE = 10/14/2015	DATE -	REVISED -

**STATE OF ILLINOIS
DEPARTMENT OF TRANSPORTATION**

DETAILS: SIDEROAD AND ENTRANCES

SCALE: SHEET OF SHEETS STA. TO STA.

F.A.P. RTE.	SECTION	COUNTY	TOTAL SHEETS	SHEET NO.
322	(10,10-1,11-1,12-1,13) RS-3	*	18	17
CONTRACT NO. 78491				

ILLINOIS FED. AID PROJECT

* JACKSON/UNION

ILLINOIS STANDARD

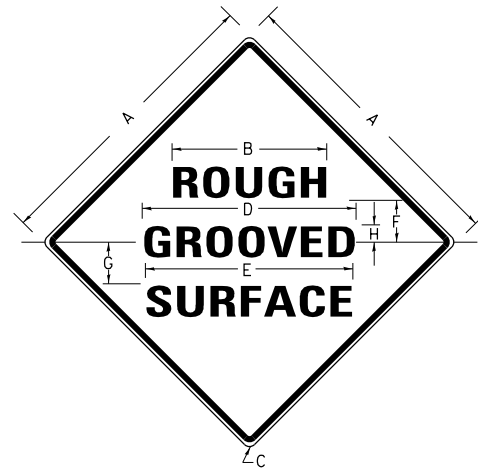

COLORS:

LEGEND AND BORDER- BLACK NON-REFLECTORIZED
BACKGROUND- ORANGE REFLECTORIZED

SIGN SIZE	DIMENSIONS							
	A	B	C	D	E	F	G	H
48X48	48.0	24.1	3.0	34.0	33.0	6.0	13.0	3.5

SIGN SIZE	SERIES LINES			MAR-GIN	BOR-DER	BLANK STD.
	1	2	3			
48X48	7C	7C	7C	0.8	1.2	B4-48D

ALL DIMENSIONS IN INCHES

NOTES:

PRIOR TO ALLOWING TRAFFIC ON ANY PORTION OF THE ROADWAY THAT HAS BEEN COLDMILLED, THE CONTRACTOR SHALL HAVE ERECTED "ROUGH GROOVED SURFACE" SIGNS THAT CONFORM TO THE ABOVE DETAILS. A MINIMUM OF ONE SIGN AT EACH END OF THE IMPROVEMENT WILL BE REQUIRED. THE CONTRACTOR SHALL MAINTAIN THE "ROUGH GROOVED SURFACE" SIGNS UNTIL THE COLDMILLED SURFACE IS COVERED WITH LEVELING BINDER OR SURFACE COURSE.

IF AT ANY TIME THE SIGNS ARE IN PLACE BUT NOT APPLICABLE, THEY SHALL BE TURNED FROM THE VIEW OF MOTORISTS OR COVERED AS DIRECTED BY THE ENGINEER.

THE COST OF FURNISHING, ERECTING, MAINTAINING, AND REMOVING THE REQUIRED SIGNS SHALL BE INCLUDED IN THE CONTRACT.

STD. 9-39

REVISIONS	
REDRAWN	2-15-89
REVISED	4-6-93
REVISED	3-27-08
REVIEWED	5-17-13

UNEVEN LANES SIGN

W8-11 (48" x 48")

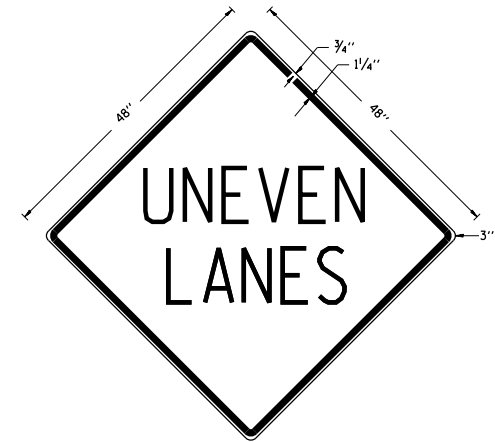

COLORS:

LEGEND AND BORDER - BLACK NON-REFLECTORIZED
BACKGROUND - ORANGE REFLECTORIZED

NOTE: PRIOR TO ALLOWING TRAFFIC ON ANY PORTION OF THE ROADWAY THAT HAS BEEN COLDMILLED OR BEFORE RESURFACING OPERATIONS BEGIN, THE CONTRACTOR SHALL HAVE ERECTED "UNEVEN PAVEMENT" SIGNS THAT CONFORM TO THE ABOVE DETAILS. A MINIMUM OF ONE SIGN AT EACH END OF THE IMPROVEMENT WILL BE REQUIRED. THE CONTRACTOR SHALL MAINTAIN THE "UNEVEN PAVEMENT" SIGNS UNTIL THE RESURFACING OPERATIONS ARE COMPLETED.

IF AT ANY TIME THE SIGNS ARE IN PLACE BUT NOT APPLICABLE, THEY SHALL BE TURNED FROM THE VIEW OF MOTORISTS OR COVERED AS DIRECTED BY THE ENGINEER.

THE COST OF FURNISHING, ERECTING, MAINTAINING, AND REMOVING THE REQUIRED SIGNS SHALL BE INCLUDED IN THE CONTRACT.

STD. 9-41

REVISIONS	
DRAWN	2-15-89
REVISED	4-06-93
REDESIGNED	7-23-04
RESIZED	5-08-08
REVIEWED	5-17-13

FILE NAME =	USER NAME = maesbl	DESIGNED -	REVISED -
p:\11\084EBIDINTEG.illinois.gov\PIWIDT\Documents\DOT Offices\District 9\Projects\78491\Drawings\CAD\Sheets\78491.sht.dgn		DRAWN -	REVISED -
Default	PLOT SCALE = 100.0000' / in.	CHECKED -	REVISED -
	PLOT DATE = 10/14/2015	DATE -	REVISED -

**STATE OF ILLINOIS
DEPARTMENT OF TRANSPORTATION**

**DETAILS: ROUGH GROOVED SURFACE
AND UNEVEN LANES**

SCALE: SHEET OF SHEETS STA. TO STA.

F.A.P. RTE.	SECTION	COUNTY	TOTAL SHEETS	SHEET NO.
322	(10,10-1,11-1,12-1,13) RS-3	*	18	18
				CONTRACT NO. 78491
ILLINOIS FED. AID PROJECT				