

STATE OF ILLINOIS
DEPARTMENT OF TRANSPORTATION

F.A.P. RTE.	SECTION	COUNTY	TOTAL SHEETS	SHEET NO.
328A	(7,8,9,10)RS-2	CLAY	27	1
		ILLINOIS	CONTRACT NO. 74906	

D-97-023-19

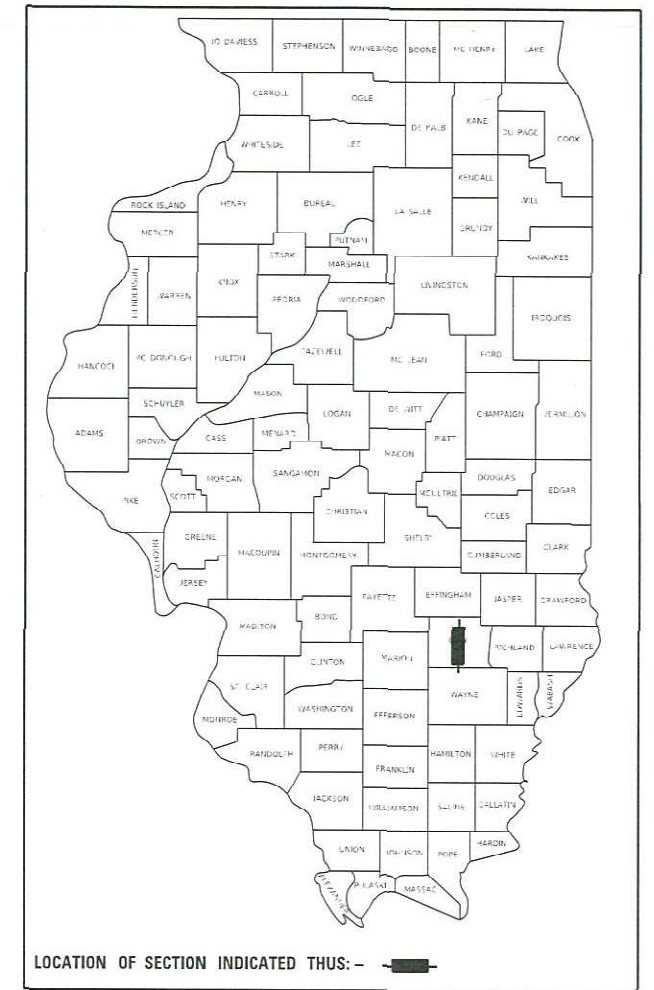

PROPOSED HIGHWAY PLANS

FAP ROUTE 328A (US 45)
SECTION (7,8,9,10)RS-2
PROJECT STP-HD1T(383)
DESIGNED OVERLAY
CLAY COUNTY

C-97-035-19

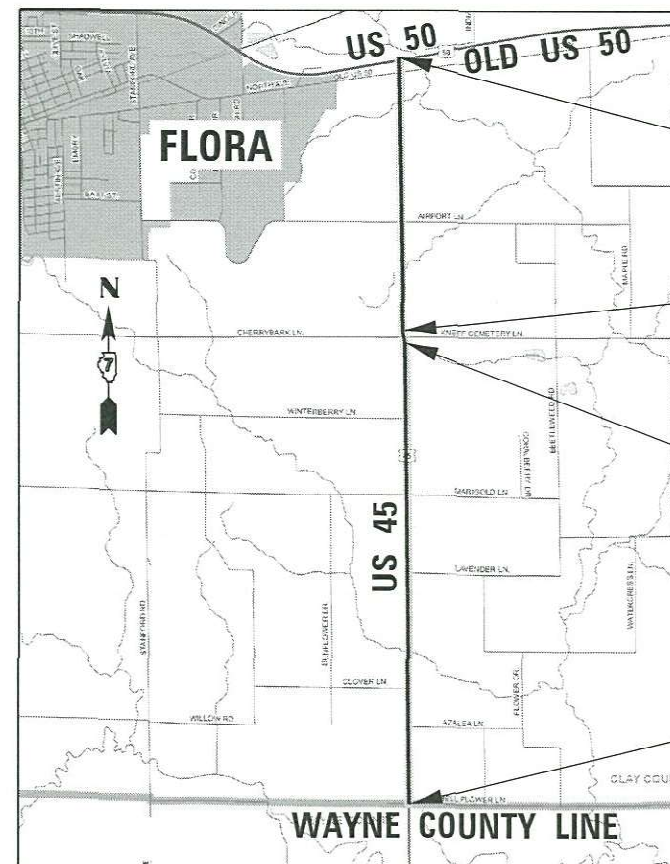

END PROJECT
STA. 1174 + 08.3

STATION EQUATION
STA. 1083 + 15.70 BK=
STA. 1083 + 16.90 AH

STATION EQUATION
STA. 1077 + 18.60 BK=
STA. 1077 + 19.80 AH

BEGIN PROJECT
STA. 915 + 52.5

FOR INDEX OF SHEETS, SEE SHEET NO. 2

ADT = 2350 (2019)
16.6% TRUCKS

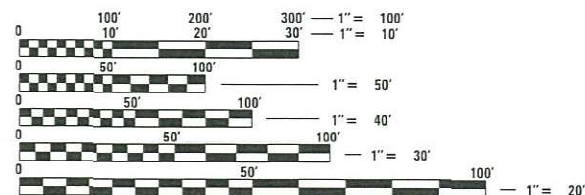

FULL SIZE PLANS HAVE BEEN PREPARED USING STANDARD ENGINEERING SCALES. REDUCED SIZED PLANS WILL NOT CONFORM TO STANDARD SCALES. IN MAKING MEASUREMENTS ON REDUCED PLANS, THE ABOVE SCALES MAY BE USED.

J.U.L.I.E.
JOINT UTILITY LOCATION INFORMATION FOR EXCAVATORS
1-800-892-0123
OR 811

PROJECT ENGINEER: DEBRA BARRETT
PROJECT MANAGER: LEAH HILLE

CONTRACT NO. 74906

GROSS LENGTH = 25854 FT. = 4.90 MILE
NET LENGTH = 25689 FT. = 4.87 MILE

STATE OF ILLINOIS
DEPARTMENT OF TRANSPORTATION

SUBMITTED October 27, 2020
Jeffrey P. Myralski
REGIONAL ENGINEER

December 4, 2020
Scott A. Elk
ENGINEER OF DESIGN AND ENVIRONMENT

December 4, 2020
James J. Gu
DIRECTOR OF HIGHWAYS PROJECT IMPLEMENTATION

PRINTED BY THE AUTHORITY
OF THE STATE OF ILLINOIS

GENERAL NOTES

THIS PROJECT IS LOCATED ON FAP ROUTE 328A (US 45) IN CLAY COUNTY FROM US 50 TO WAYNE COUNTY LINE. THE WORK INCLUDED IN SECTION (7,8,9,10)RS-2 CONSISTS OF MILLING, HOT-MIX ASPHALT RESURFACING, PAVEMENT MARKING, AND ANY OTHER WORK NECESSARY TO COMPLETE THIS SECTION.

MILLED PAVEMENT SHALL BE RESURFACED WITH BINDER WITHIN 5 CALENDAR DAYS.

THE RESIDENT ENGINEER SHALL BE THE SOLE JUDGE CONCERNING THE CURING TIME FOR THE VARIOUS HOT-MIX ASPHALT LIFTS.

WHEN APPLYING SHORT TERM PAVEMENT MARKINGS, TEMPORARY TAPE SHALL BE USED ON THE SURFACE AND PAINT SHALL BE USED ON THE MILLED AND BINDER SURFACES.

THE MATERIAL USED FOR AGGREGATE WEDGE SHOULDERS, TYPE B SHALL BE CRUSHED STONE, CRUSHED CONCRETE OR RAP. THE MATERIAL USED FOR AGGREGATE SURFACE COURSE, TYPE B SHALL BE CRUSHED STONE OR CRUSHED CONCRETE.

APPLICATION RATES

THE FOLLOWING APPLICATION RATES WERE USED IN CALCULATING PLAN QUANTITIES AND HAVE BEEN INCLUDED FOR REFERENCE:

AGGREGATE SURFACE COURSE AND SHOULDER	2.05 TON/CU YD
BITUMINOUS MATERIALS (TACK COAT)	0.5 LB/SQ FT (ON MILLED SURFACES) 0.025 LB/SQ FT (ON HMA LIFTS)
HOT-MIX ASPHALT BINDERS AND SURFACES	112 LB/SQ YD/INCH

MIXTURE REQUIREMENTS

THE FOLLOWING MIXTURE REQUIREMENTS ARE APPLICABLE TO THIS PROJECT:

APPLICATION	AC/PG	DESIGN AIR VOIDS	MIXTURE COMPOSITION	FRICTION AGGREGATE	QUALITY MANAGEMENT
HMA SURFACE COURSE, MIX "C", N70 (2")	PG 64-22	4.0% @ N=70	IL - 9.5	MIXTURE C	PFP
HMA BINDER COURSE, IL-9.5FG, N70, (1 3/4")	PG 64-22	4.0% @ N=70	IL - 9.5FG	N/A	QCP
INCIDENTAL HMA SURFACING	PG 64-22	4.0% @ N=70	IL - 9.5	MIXTURE C	QC/QA
CLASS "D" PAVEMENT PATCHING	PG 64-22	4.0% @ N=70	IL - 19.0	N/A	QC/QA

INDEX OF SHEETS

SHEET NO.	ITEM
1	COVER SHEET
2	INDEX OF SHEETS, LIST OF STANDARDS, AND GENERAL NOTES
3-4	SUMMARY OF QUANTITIES
5-6	TYPICAL SECTIONS
7-8	SCHEDULE OF QUANTITIES
9-18	PLAN SHEETS
19-20	PAVEMENT MARKING DETAILS
21-27	DISTRICT 7 DETAILS

THE FOLLOWING STANDARDS ARE A PART OF THESE PLANS AND ARE INCLUDED AFTER SHEET NO. 27:

STANDARD NO.	DESCRIPTION
000001-08	STANDARD SYMBOLS, ABBREVIATIONS AND PATTERNS
001001-02	AREAS OF REINFORCEMENT BARS
001006	DECIMAL OF AN INCH AND OF A FOOT
406201-01	MAILBOX TURNOUT
442201-03	CLASS C AND D PATCHES
482011-03	HMA SHOULDER STRIPS/SHOULDERS WITH RESURFACING OR WIDENING AND RESURFACING PROJECTS
606301-04	PC CONCRETE ISLANDS AND MEDIANS
606306-04	CORRUGATED PC CONCRETE MEDIANS
667101-02	PERMANENT SURVEY MARKERS
701006-05	OFF-ROAD OPERATIONS, 2L, 2W, 15' TO 24' FROM PAVEMENT EDGE
701201-05	LANE CLOSURE, 2L, 2W, DAY ONLY, FOR SPEEDS ≥ 45 MPH
701301-04	LANE CLOSURE, 2L, 2W, SHORT TIME OPERATIONS
701306-04	LANE CLOSURE, 2L, 2W, SLOW MOVING OPERATIONS DAY ONLY, FOR SPEEDS ≥ 45 MPH
701311-03	LANE CLOSURE, 2L, 2W, MOVING OPERATIONS - DAY ONLY
701427-05	LANE CLOSURE, MULTILANE, INTERMITTENT OR MOVING OPERATION, FOR SPEEDS ≤ 40 MPH
701901-08	TRAFFIC CONTROL DEVICES
720006-04	SIGN PANEL ERECTION DETAILS
780001-05	TYPICAL PAVEMENT MARKINGS
781001-04	TYPICAL APPLICATIONS RAISED REFLECTIVE PAVEMENT MARKERS

MODEL: Default
 FILE: \\blm1c1-pub\pubroom\dat\illinois.gov\PIWDOT\Documents\DOT_Offices\District_7\Projects\74906\CADD\data\CAD\sheets\74906-sht-genote.dgn

USER NAME = steffemk	DESIGNED - LMH	REVISED -
	DRAWN - LMH	REVISED -
PLOT SCALE = 100.0000 ' / in.	CHECKED -	REVISED -
PLOT DATE = 10/27/2020	DATE - \$DATE\$	REVISED -

**STATE OF ILLINOIS
DEPARTMENT OF TRANSPORTATION**

**INDEX OF SHEETS AND
GENERAL NOTES**

SCALE: NO SCALE SHEET OF SHEETS STA. TO STA.

F.A.P. RTE.	SECTION	COUNTY	TOTAL SHEETS	SHEET NO.
328A	(7,8,9,10)RS-2	CLAY	27	2
CONTRACT NO. 74906			ILLINOIS FED. AID PROJECT	

SUMMARY OF QUANTITIES			TOTAL QUANTITIES	CONSTRUCTION TYPE CODE		
CODE NO	ITEM	UNIT		0005 80% FEDERAL 20% STATE		
40200800	AGGREGATE SURFACE COURSE, TYPE B	TON	193	193		
40600290	BITUMINOUS MATERIALS (TACK COAT)	POUND	50704	50704		
40600982	HOT-MIX ASPHALT SURFACE REMOVAL - BUTT JOINT	SO YD	360	360		
40600990	TEMPORARY RAMP	SO YD	1327	1327		
40602970	HOT-MIX ASPHALT BINDER COURSE, IL-9.5FG, N70	TON	7362	7362		
40604052	HOT-MIX ASPHALT SURFACE COURSE, IL-9.5, MIX "C", N70	TON	8414	8414		
40800050	INCIDENTAL HOT-MIX ASPHALT SURFACING	TON	124	124		
44000100	PAVEMENT REMOVAL	SO YD	201	201		
44000155	HOT-MIX ASPHALT SURFACE REMOVAL, 1 1/2"	SO YD	63076	63076		
44000164	HOT-MIX ASPHALT SURFACE REMOVAL, 3 3/4"	SO YD	12042	12042		
44000500	COMBINATION CURB AND GUTTER REMOVAL	FOOT	102	102		
44201798	CLASS D PATCHES, TYPE I, 13 INCH	SO YD	18.4	18.4		
44201803	CLASS D PATCHES, TYPE II, 13 INCH	SO YD	109.8	109.8		
44201807	CLASS D PATCHES, TYPE III, 13 INCH	SO YD	95.3	95.3		

SUMMARY OF QUANTITIES			TOTAL QUANTITIES	CONSTRUCTION TYPE CODE		
CODE NO	ITEM	UNIT		0005 80% FEDERAL 20% STATE		
44201809	CLASS D PATCHES, TYPE IV, 13 INCH	SO YD	26.7	26.7		
48102100	AGGREGATE WEDGE SHOULDER, TYPE B	TON	1327	1327		
48203012	HOT-MIX ASPHALT SHOULDERS, 3 3/4"	SO YD	4983	4983		
60618390	CONCRETE MEDIAN SURFACE, CORRUGATED	SO FT	1806	1806		
60619200	CONCRETE MEDIAN, TYPE SB-6.06	SO FT	67	67		
60622400	CONCRETE MEDIAN, TYPE SM-6.06	SO FT	153	153		
66700205	PERMANENT SURVEY MARKERS, TYPE I	EACH	8	8		
67000400	ENGINEER'S FIELD OFFICE, TYPE A	CAL MO	3	3		
67000600	ENGINEER'S FIELD LABORATORY	CAL MO	3	3		
67100100	MOBILIZATION	L SUM	1	1		
70100450	TRAFFIC CONTROL AND PROTECTION, STANDARD	L SUM	1	1		
	701201					
70100460	TRAFFIC CONTROL AND PROTECTION, STANDARD	L SUM	1	1		
	701306					
70107025	CHANGEABLE MESSAGE SIGN	CAL DA	28	28		

MODEL: Default
 FILE: \\s:\p\pub\baronm.d\at\links\goc\p\WIDOT\Documents\DOT_Offices\Default_7\Projects\74906\CADD\Drawings\DOT\74906-SHS-500.dgn

USER NAME = steffenmk	DESIGNED - LMH	REVISED -
	DRAWN - LMH	REVISED -
PLOT SCALE = 100.0000' / in.	CHECKED -	REVISED -
PLOT DATE = 10/27/2020	DATE - \$DATE\$	REVISED -

**STATE OF ILLINOIS
DEPARTMENT OF TRANSPORTATION**

SUMMARY OF QUANTITIES

SCALE: NO SCALE SHEET OF SHEETS STA. TO STA.

F.A.P. RTE.	SECTION	COUNTY	TOTAL SHEETS	SHEET NO.
328A	(7,8,9,10)RS-2	CLAY	27	3
			CONTRACT NO. 74906	
		ILLINOIS	FED. AID PROJECT	

PROPOSED TYPICAL SECTION

STA. 915+52.5 TO STA. 1077+18.6
 STATION EQUATION: 1077+18.60 BK = 1077+19.80 AH
 STA. 1077+19.8 TO STA. 1083+15.7
 STATION EQUATION: 1083+15.70 BK = 1083+16.90 AH
 STA. 1083+16.9 TO 1153+73.1

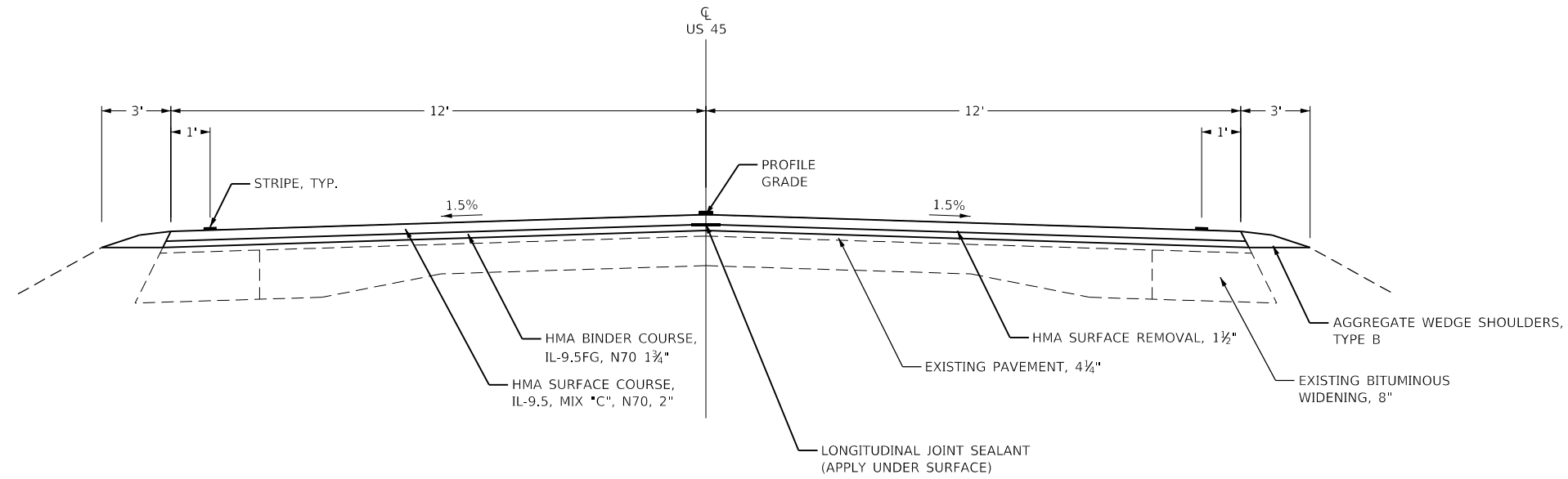

PROPOSED TYPICAL SECTION

STA. 1153+73.1 TO STA. 1174+08.3

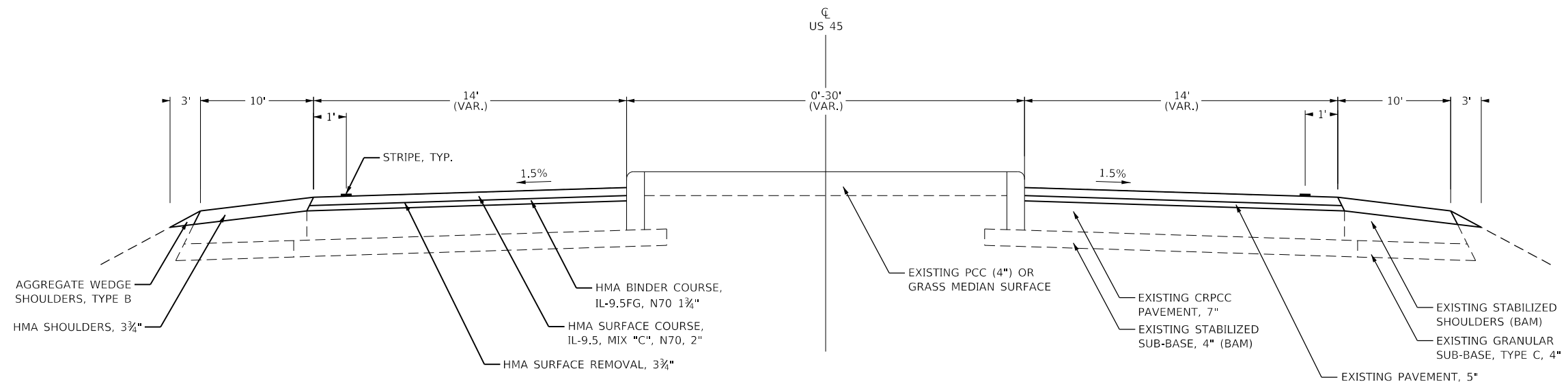

MODEL: Default
 FILE: \\nas01c.psu.edu\pub\baronm.d\at\illinois.gov\PI\DOT\Documents\DOT_Offices\District_7\Projects\74906\CADD\Drawings\74906-sht-typlsec1.dgn

USER NAME = steffemk	DESIGNED - LMH	REVISED -
	DRAWN - LMH	REVISED -
PLOT SCALE = 100.0000' / in.	CHECKED -	REVISED -
PLOT DATE = 10/27/2020	DATE - \$DATE\$	REVISED -

**STATE OF ILLINOIS
 DEPARTMENT OF TRANSPORTATION**

TYPICAL SECTIONS	
SCALE: NO SCALE	SHEET OF SHEETS STA. TO STA.

F.A.P. RTE.	SECTION	COUNTY	TOTAL SHEETS	SHEET NO.
328A	(7,8,9,10)RS-2	CLAY	27	5
CONTRACT NO. 74906				
ILLINOIS FED. AID PROJECT				

PROPOSED TYPICAL SECTION
 STA. 1047+98.0 TO STA. 1053+93.3

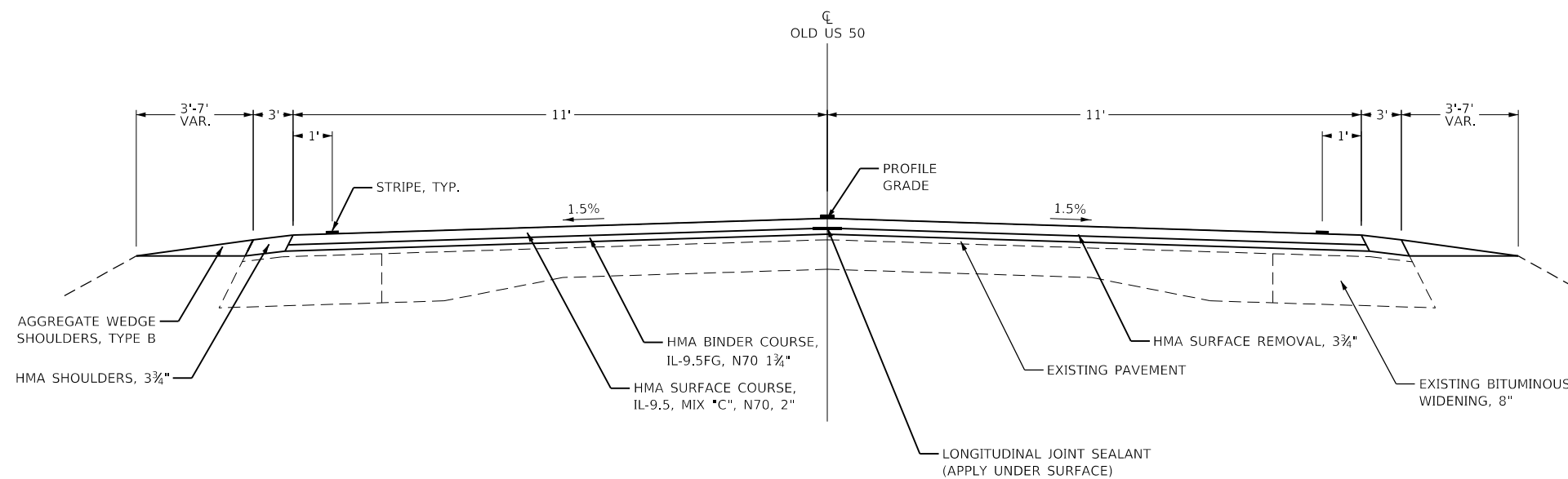

MODEL: Default
 FILE: Model: Proj\pub\room.dwg
 I:\projects\74906\CADD\Drawings\DOT_Offices\Drawings\74906-shct\typical.dgn

USER NAME = steffenmk	DESIGNED - LMH	REVISED -
	DRAWN - LMH	REVISED -
PLOT SCALE = 100.0000' / in.	CHECKED -	REVISED -
PLOT DATE = 10/27/2020	DATE - \$DATE\$	REVISED -

**STATE OF ILLINOIS
 DEPARTMENT OF TRANSPORTATION**

TYPICAL SECTIONS	
SCALE: NO SCALE	SHEET OF SHEETS STA. TO STA.

F.A.P. RTE.	SECTION	COUNTY	TOTAL SHEETS	SHEET NO.
328A	(7,8,9,10)RS-2	CLAY	27	6
CONTRACT NO. 74906				
ILLINOIS FED. AID PROJECT				

PERMANENT SURVEY MARKERS			66700205 PERMANENT SURVEY MARKERS, TYPE I		Z0049799 PROTECTING OR RESETTING SURVEY MARKERS		Z0070202 SURVEY MARKER VAULT	
POINT #	NORTHING	EASTING	EACH	EACH	EACH			
214	731117.525	954297.423	1	1	-			
213	730660.224	954296.151	1	1	-			
212	730532.162	954295.798	1	1	-			
215	729469.773	954293.004	-	1	1			
211	729032.120	954291.718	1	1	-			
210	727695.231	954288.099	1	1	-			
206	726777.332	954282.711	-	1	1			
205	721400.440	954250.254	-	1	1			
204	721398.859	954351.314	-	1	1			
203	715893.076	954343.505	-	1	1			
202	713174.788	954310.628	-	1	1			
209	712224.737	954297.567	1	1	-			
208	710955.087	954278.072	1	1	-			
216	710487.673	954275.088	-	1	-			
207	708914.162	954253.456	1	1	-			
201	707841.212	954243.731	-	1	1			
200	705194.800	954212.338	-	1	1			
TOTALS:			8	17	8			

MEDIAN & ISLAND SCHEDULE		44000100 PAVEMENT REMOVAL	60618390 CONCRETE MEDIAN SURFACE, CORRUGATED	X4403300 CONCRETE MEDIAN REMOVAL	44000500 COMBINATION CURB & GUTTER REMOVAL	60619200 CONCRETE MEDIAN, 5B-6.06	60622400 CONCRETE MEDIAN, SM-6.06
STATION	STATION	SQ YD	SQ FT	SQ FT	FOOT	SQ FT	SQ FT
1158+60.6	1162+05.8	201.0	1806.0	-	-	-	-
1160+18.1	1160+24.1	-	-	13.7	15.3	28.0	-
1169+84.3	1169+90.3	-	-	22.4	16.3	38.1	-
1170+31.7	1170+36.7	-	-	38.8	19.6	-	58.1
1173+94.9	1174+00.9	-	-	19.1	15.7	-	34.2
1173+94.9		-	-	9.1	11.4	-	19.6
1174+10.4		-	-	10.2	12.0	-	21.3
1174+12.7		-	-	8.7	11.2	-	19.0
TOTALS:		201.0	1806.0	122.0	102.0	67.0	153.0

MODEL: Default
FILE: h:\mhc\p\pub\haronom.dwg
C:\Users\stevf\Documents\DOT_Offices\Illin\74906\CADD\data\CAD\sheet\74906-shs-schedule.dgn

USER NAME = steffemk	DESIGNED - LMH	REVISED -
	DRAWN - LMH	REVISED -
PLOT SCALE = 100.0000 ' / in.	CHECKED -	REVISED -
PLOT DATE = 10/27/2020	DATE - \$DATE\$	REVISED -

**STATE OF ILLINOIS
DEPARTMENT OF TRANSPORTATION**

SCHEDULE OF QUANTITIES

SCALE: NO SCALE SHEET OF SHEETS STA. TO STA.

F.A.P. RTE.	SECTION	COUNTY	TOTAL SHEETS	SHEET NO.
328A	(7,8,9,10)RS-2	CLAY	27	8
CONTRACT NO. 74906			ILLINOIS FED. AID PROJECT	

MODEL: Default
 FILE: h:\m\p_328a\planroom\dat\illinois\p\WIDDOT\Documents\DOT_Offices\Illin\74906\CADD\DATA\CADD\sheet\74906-sch-plan.dgn

MATCHLINE STA. 939 + 51.0

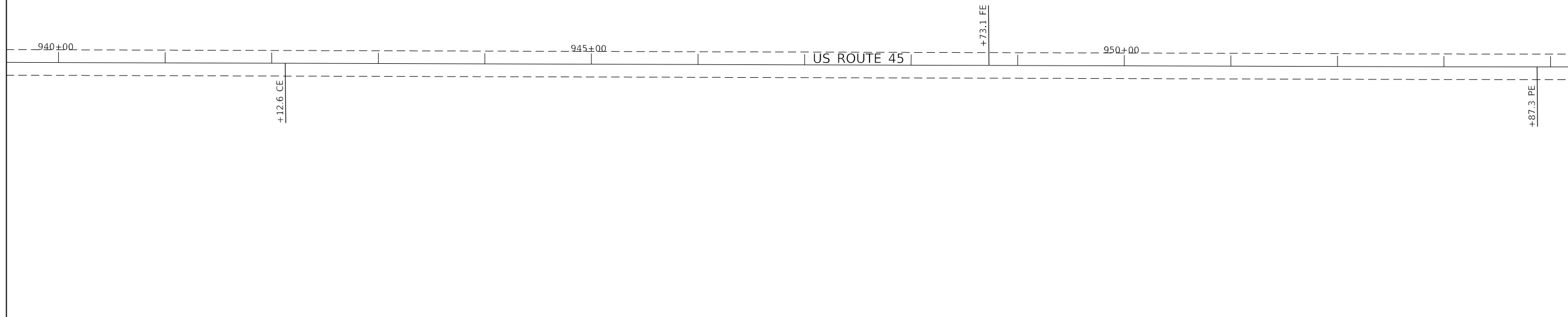

MATCHLINE STA. 954 + 26.0

MATCHLINE STA. 954 + 26.0

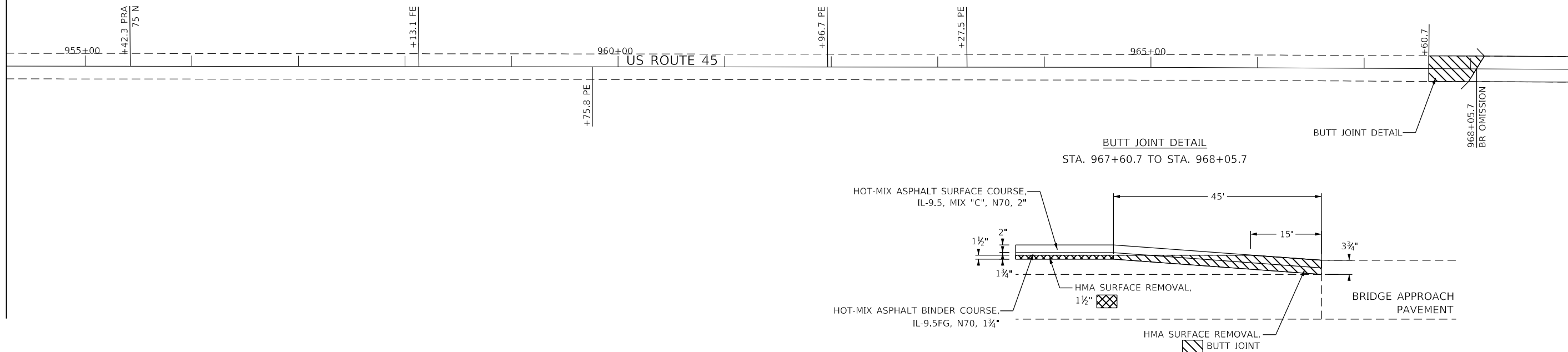

MATCHLINE STA. 969 + 01.0

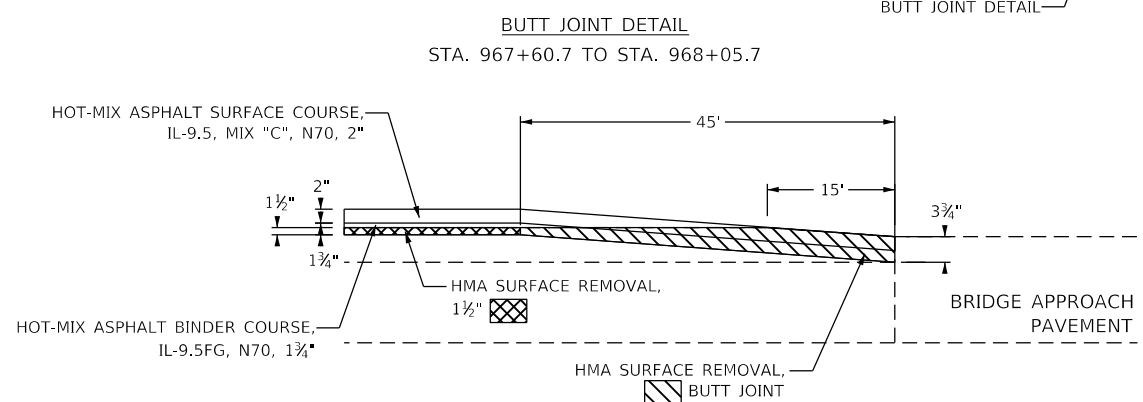

USER NAME = steffenmk	DESIGNED - LMH	REVISED -
DRAWN - LMH	REVISIONS	
PLOT SCALE = 100.0000 ' / in.	CHECKED -	REVISED -
PLOT DATE = 10/27/2020	DATE - 10/27/2020	REVISED -

**STATE OF ILLINOIS
 DEPARTMENT OF TRANSPORTATION**

PLAN SHEETS			
SCALE: 100.0000 ' / in	SHEET	OF SHEETS	STA. TO STA.

F.A.P. RTE.	SECTION	COUNTY	TOTAL SHEETS	SHEET NO.
328A	(7,8,9,10)RS-2	CLAY	27	10
CONTRACT NO. 74906				
ILLINOIS FED. AID PROJECT				

MODEL: Default
 FILE: hma15c_pavuplanroom.dwg
 PROJECT: 74906\CADD\Drawings\DOT_Offices\Drawings\74906\Drawings\74906-51c-plan.dwg

MATCHLINE STA. 954 + 26.0

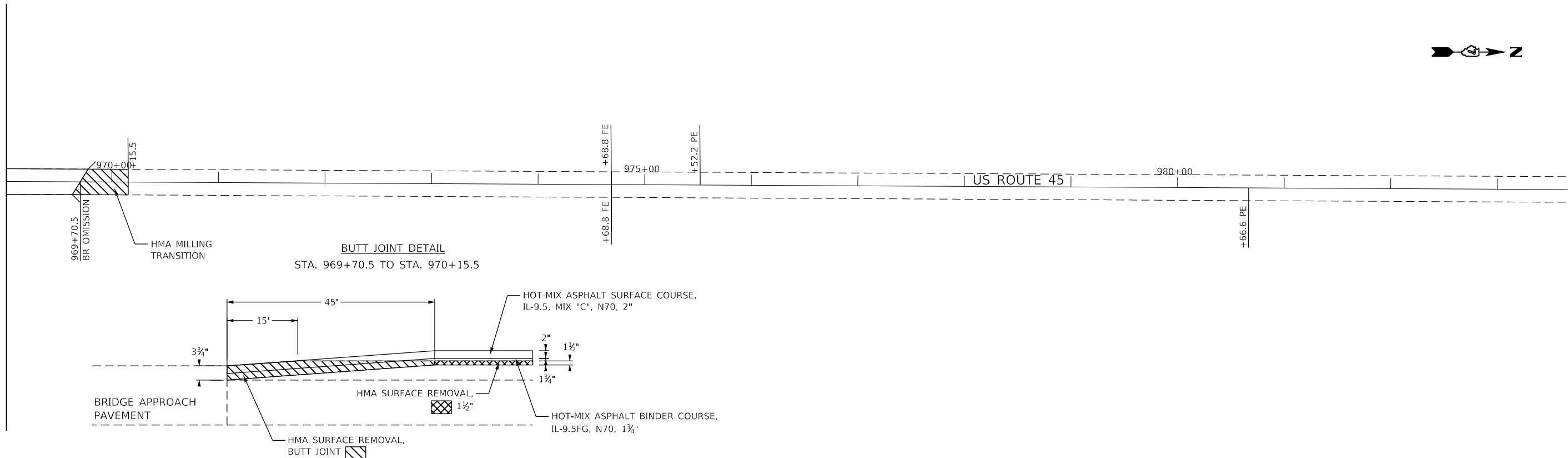

MATCHLINE STA. 983 + 76.3

MATCHLINE STA. 983 + 76.3

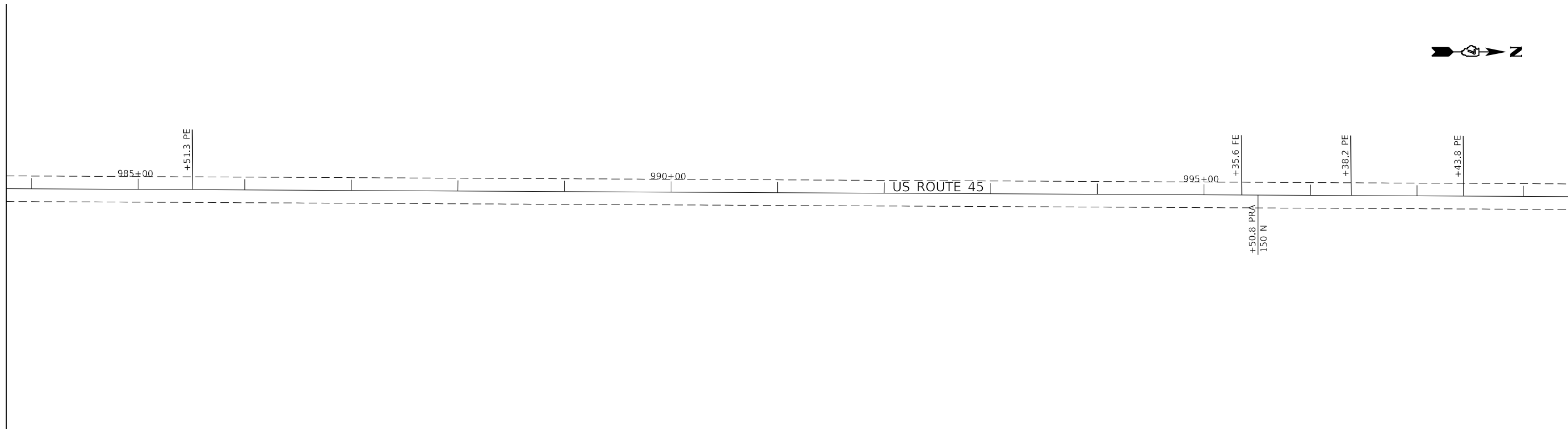

MATCHLINE STA. 995 + 51.6

USER NAME = steffemk	DESIGNED - LMH	REVISED -
	DRAWN - LMH	REVISED -
PLOT SCALE = 100.0000 ' / in.	CHECKED -	REVISED -
PLOT DATE = 10/27/2020	DATE - 10/27/2020	REVISED -

**STATE OF ILLINOIS
 DEPARTMENT OF TRANSPORTATION**

PLAN SHEETS
 SCALE: 100.0000 ' / SHEET OF SHEETS STA. TO STA.

F.A.P. RTE.	SECTION	COUNTY	TOTAL SHEETS	SHEET NO.
328A	(7,8,9,10)RS-2	CLAY	27	11
CONTRACT NO. 74906				
ILLINOIS FED. AID PROJECT				

MODEL: Default
 FILE: h:\mhc\p\pub\harcam.dwg
 PROJECT: 74906\CADD\DATA\Drawings\DOT_Offices\Drawings\74906-std\plan.dgn

MATCHLINE STA. 995 + 51.6

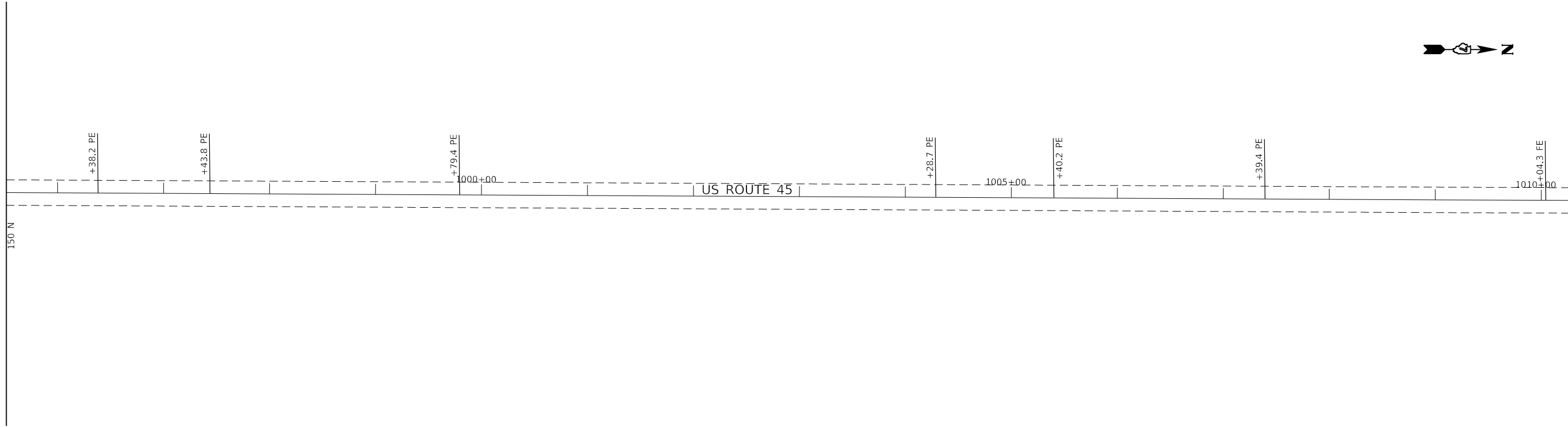

MATCHLINE STA. 1010 + 26.6

MATCHLINE STA. 1010 + 26.6

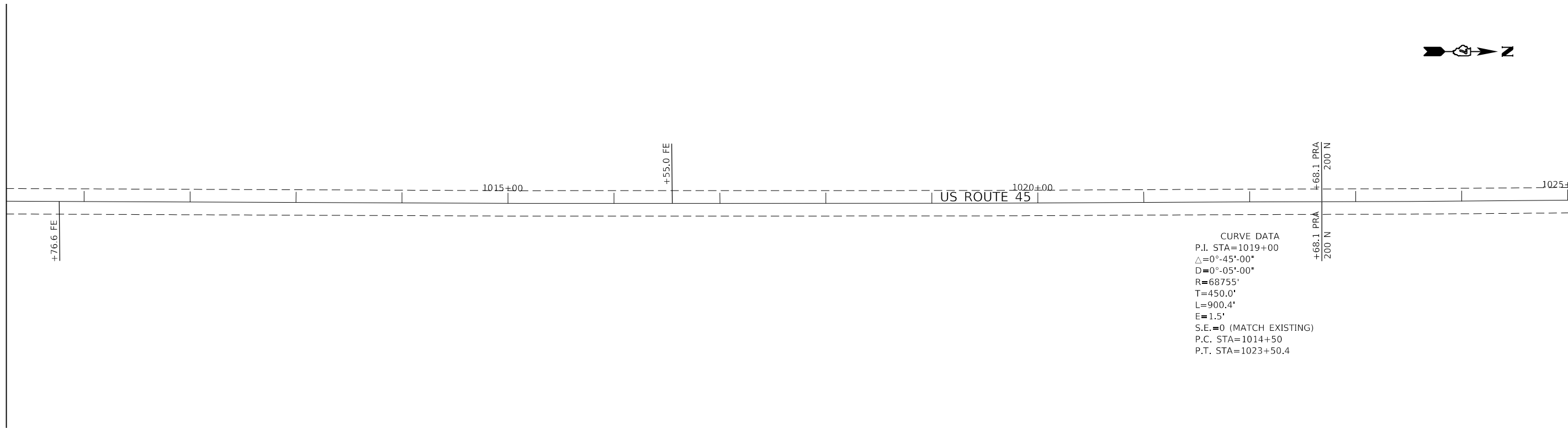

MATCHLINE STA. 1025 + 01.6

CURVE DATA
 P.I. STA=1019+00
 $\Delta=0^{\circ}-45'-00''$
 $D=0^{\circ}-05'-00''$
 $R=68755'$
 $T=450.0'$
 $L=900.4'$
 $E=1.5'$
 S.E.=0 (MATCH EXISTING)
 P.C. STA=1014+50
 P.T. STA=1023+50.4

USER NAME = steffenmk	DESIGNED - LMH	REVISED -
	DRAWN - LMH	REVISED -
PLOT SCALE = 100.0000 ' / in.	CHECKED -	REVISED -
PLOT DATE = 10/27/2020	DATE - 10/27/2020	REVISED -

STATE OF ILLINOIS
 DEPARTMENT OF TRANSPORTATION

PLAN SHEETS

SCALE: 100.0000 ' / 1" SHEET OF SHEETS STA. TO STA.

F.A.P. RTE.	SECTION	COUNTY	TOTAL SHEETS	SHEET NO.
328A	(7,8,9,10)RS-2	CLAY	27	12
CONTRACT NO. 74906				
ILLINOIS FED. AID PROJECT				

MODEL: Default
 FILE: h:\mhc\p\pub\harcam.dwg
 PROJECT: 74906\CAAD\Drawings\DOT_Offices\Drawings\74906-std\plan.dgn

MATCHLINE STA. 1025 + 01.6

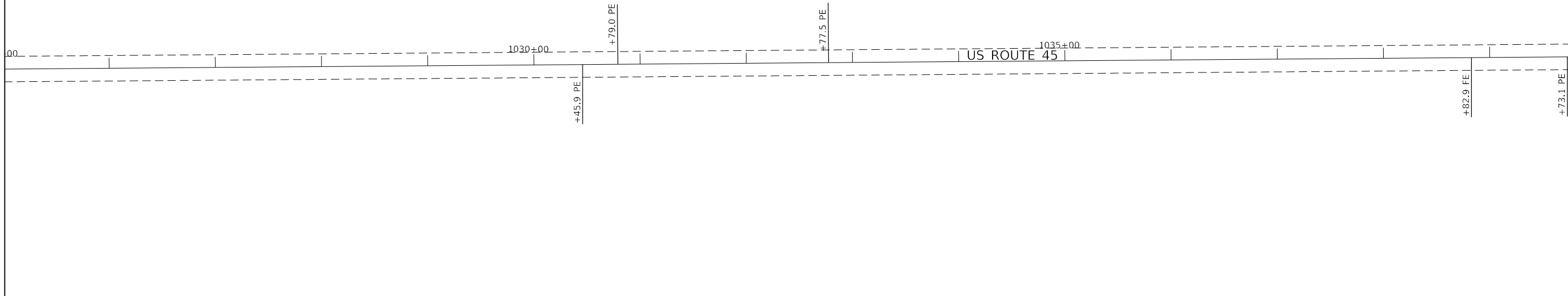

MATCHLINE STA. 1039 + 76.6

MATCHLINE STA. 1039 + 76.6

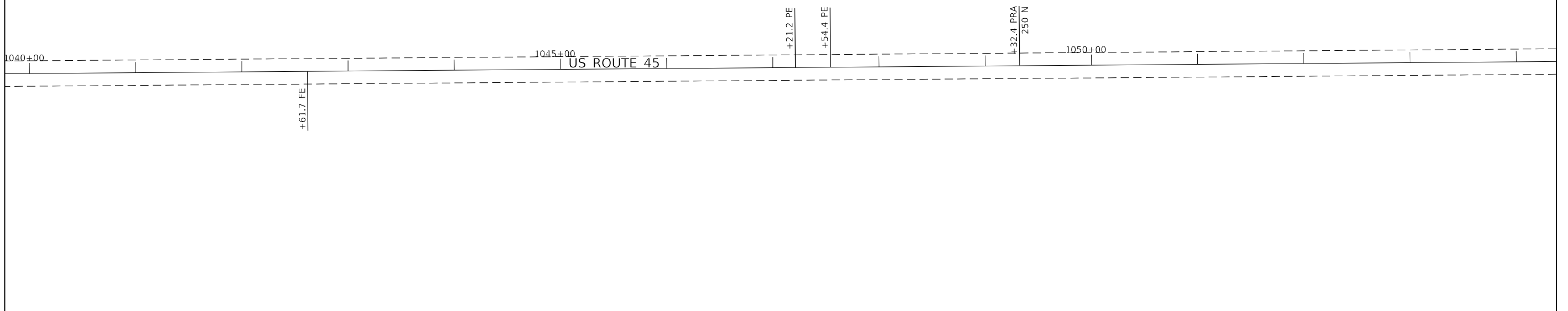

MATCHLINE STA. 1054 + 38.7

USER NAME = steffenmk	DESIGNED - LMH	REVISED -
	DRAWN - LMH	REVISED -
PLOT SCALE = 100.0000 ' / in.	CHECKED -	REVISED -
PLOT DATE = 10/27/2020	DATE - 10/27/2020	REVISED -

**STATE OF ILLINOIS
 DEPARTMENT OF TRANSPORTATION**

PLAN SHEETS

SCALE: 100.0000 ' / in SHEET OF SHEETS STA. TO STA.

F.A.P. RTE.	SECTION	COUNTY	TOTAL SHEETS	SHEET NO.
328A	(7,8,9,10)RS-2	CLAY	27	13
CONTRACT NO. 74906			ILLINOIS FED. AID PROJECT	

MODEL: Default
 FILE: h:\m165_p\pub\planroom.dwg
 PROJECT: 74906\CADD\DATA\CADD\sheet\0774906-sht-clay.dgn

MATCHLINE STA. 1054 + 37.8

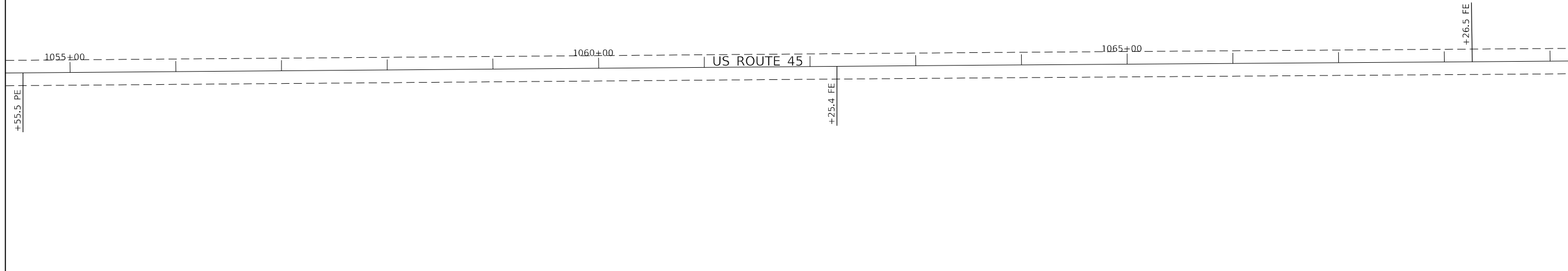

MATCHLINE STA. 1069 + 26.6

MATCHLINE STA. 1054 + 51.6

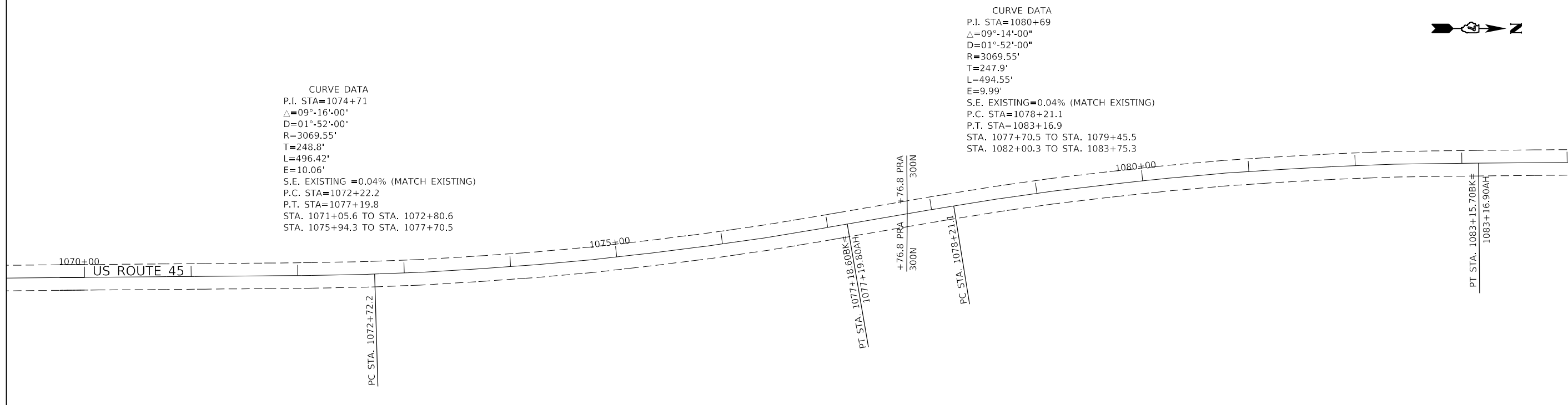

CURVE DATA
 P.I. STA=1074+71
 $\Delta=09^{\circ}16'00''$
 $D=01^{\circ}52'00''$
 $R=3069.55'$
 $T=248.8'$
 $L=496.42'$
 $E=10.06'$
 S.E. EXISTING =0.04% (MATCH EXISTING)
 P.C. STA=1072+22.2
 P.T. STA=1077+19.8
 STA. 1071+05.6 TO STA. 1072+80.6
 STA. 1075+94.3 TO STA. 1077+70.5

CURVE DATA
 P.I. STA=1080+69
 $\Delta=09^{\circ}14'00''$
 $D=01^{\circ}52'00''$
 $R=3069.55'$
 $T=247.9'$
 $L=494.55'$
 $E=9.99'$
 S.E. EXISTING=0.04% (MATCH EXISTING)
 P.C. STA=1078+21.1
 P.T. STA=1083+16.9
 STA. 1077+70.5 TO STA. 1079+45.5
 STA. 1082+00.3 TO STA. 1083+75.3

MATCHLINE STA. 1084 + 10.5

USER NAME = steffenmk	DESIGNED - LMH	REVISED -
PLOT SCALE = 100.0000 ' / in.	DRAWN - LMH	REVISED -
PLOT DATE = 10/27/2020	CHECKED -	REVISED -
	DATE - 10/27/2020	REVISED -

STATE OF ILLINOIS
 DEPARTMENT OF TRANSPORTATION

PLAN SHEETS

SCALE: 100.0000 ' / in SHEET OF SHEETS STA. TO STA.

F.A.P. RTE.	SECTION	COUNTY	TOTAL SHEETS	SHEET NO.
328A	(7,8,9,10)RS-2	CLAY	27	14
CONTRACT NO. 74906			ILLINOIS FED. AID PROJECT	

MODEL: Default
 FILE: h:\m156_p10\pub\room.mxd; illinois.gov; RWIDOT\Documents\DOT_Offices\District 7\Projects\74906\CADD\data\CADD\sheet\1074906-shc-plan.dgn

MATCHLINE STA. 1084 + 10.5

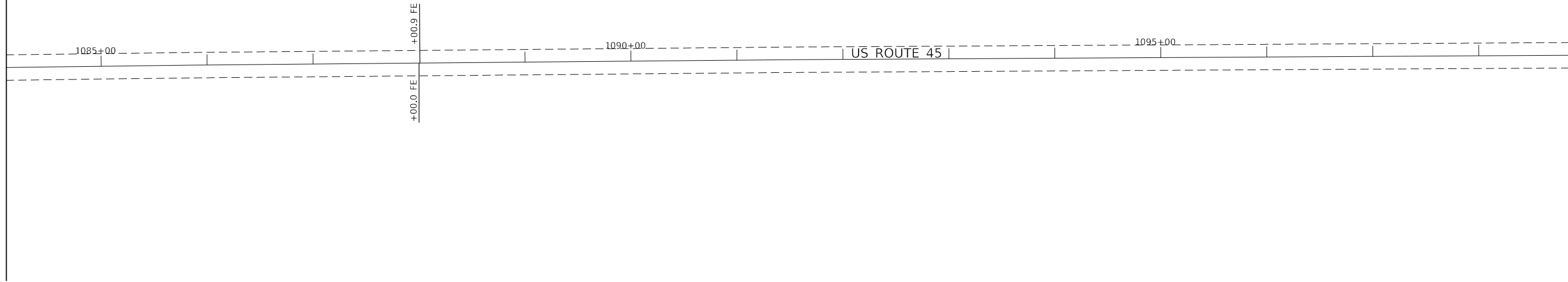

MATCHLINE STA. 1098 + 85.5

MATCHLINE STA. 1098 + 85.5

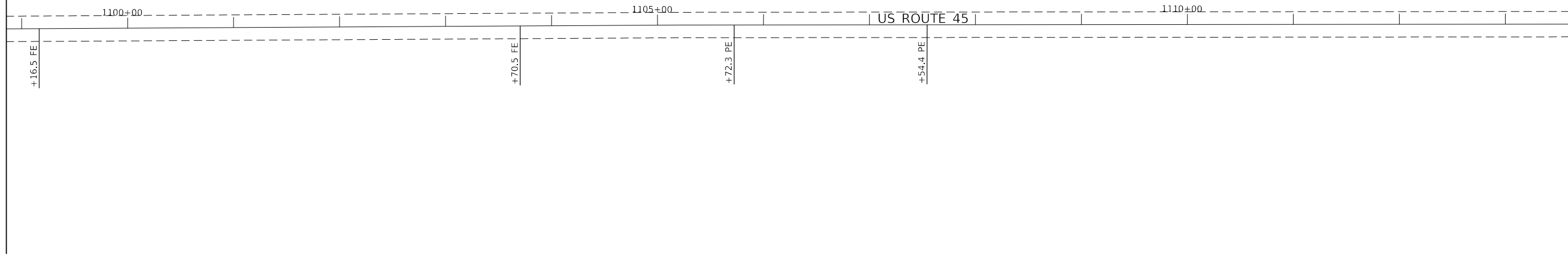

MATCHLINE STA. 1113 + 60.5

USER NAME = steffenmk	DESIGNED - LMH	REVISED -
	DRAWN - LMH	REVISED -
PLOT SCALE = 100.0000 ' / in.	CHECKED -	REVISED -
PLOT DATE = 10/27/2020	DATE - 10/27/2020	REVISED -

**STATE OF ILLINOIS
 DEPARTMENT OF TRANSPORTATION**

PLAN SHEETS

SCALE: 100.0000 ' / in SHEET OF SHEETS STA. TO STA.

F.A.P. RTE.	SECTION	COUNTY	TOTAL SHEETS	SHEET NO.
328A	(7,8,9,10)RS-2	CLAY	27	15
CONTRACT NO. 74906			ILLINOIS FED. AID PROJECT	

MODEL: Default
 FILE: h:\mhc\p\pub\haronom.dwg
 PROJECT: 74906\CADD\DATA\CAD\Drawings\DOT\Office\Drawings\74906\Sheet\1128+35.5.dgn

MATCHLINE STA. 1113 + 60.5

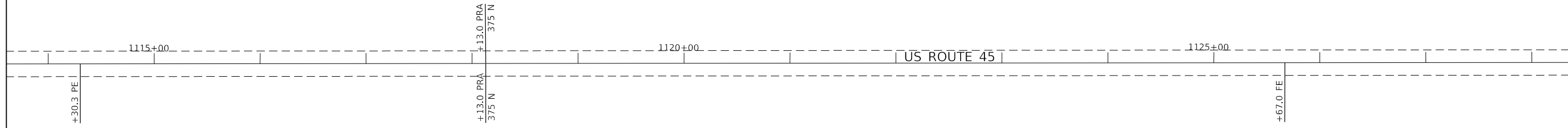

MATCHLINE STA. 1128 + 35.5

MATCHLINE STA. 1128 + 35.5

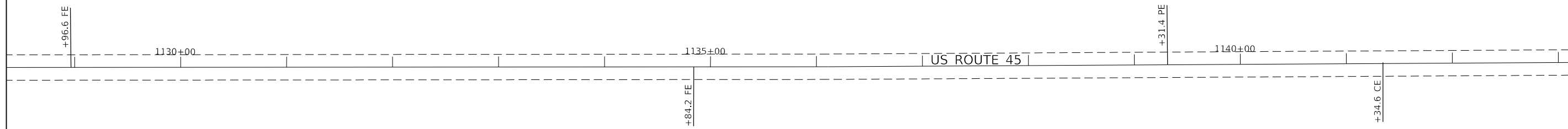

MATCHLINE STA. 1143 + 10.5

USER NAME = steffemk	DESIGNED - LMH	REVISED -
	DRAWN - LMH	REVISED -
PLOT SCALE = 100.0000 ' / in.	CHECKED -	REVISED -
PLOT DATE = 10/27/2020	DATE - 10/27/2020	REVISED -

**STATE OF ILLINOIS
 DEPARTMENT OF TRANSPORTATION**

PLAN SHEETS

SCALE: 100.0000 ' / 1" SHEET OF SHEETS STA. TO STA.

F.A.P. RTE.	SECTION	COUNTY	TOTAL SHEETS	SHEET NO.
328A	(7,8,9,10)RS-2	CLAY	27	16
CONTRACT NO. 74906			ILLINOIS FED. AID PROJECT	

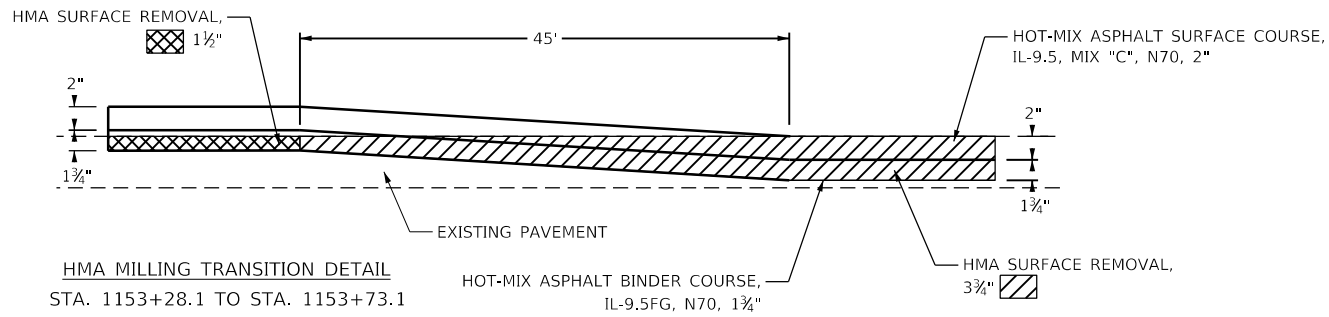

MATCHLINE STA. 1143 + 10.5

MATCHLINE STA. 1157 + 85.5

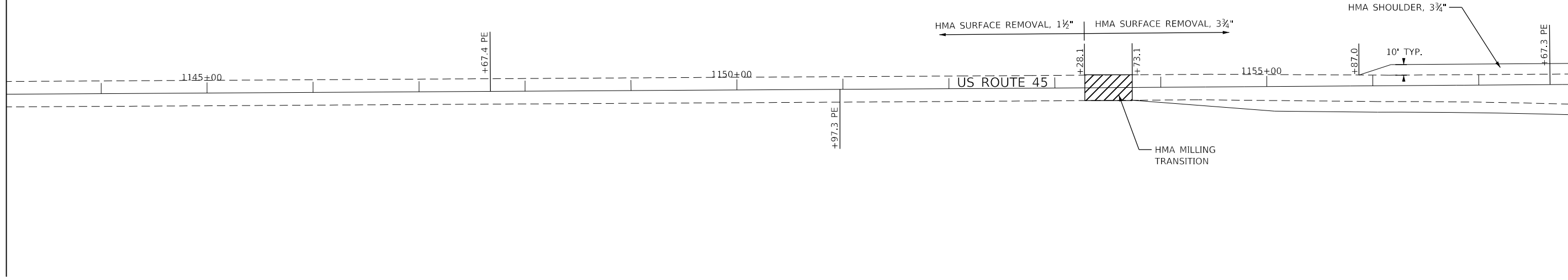

MATCHLINE STA. 1143 + 10.5

MATCHLINE STA. 1169 + 00.0

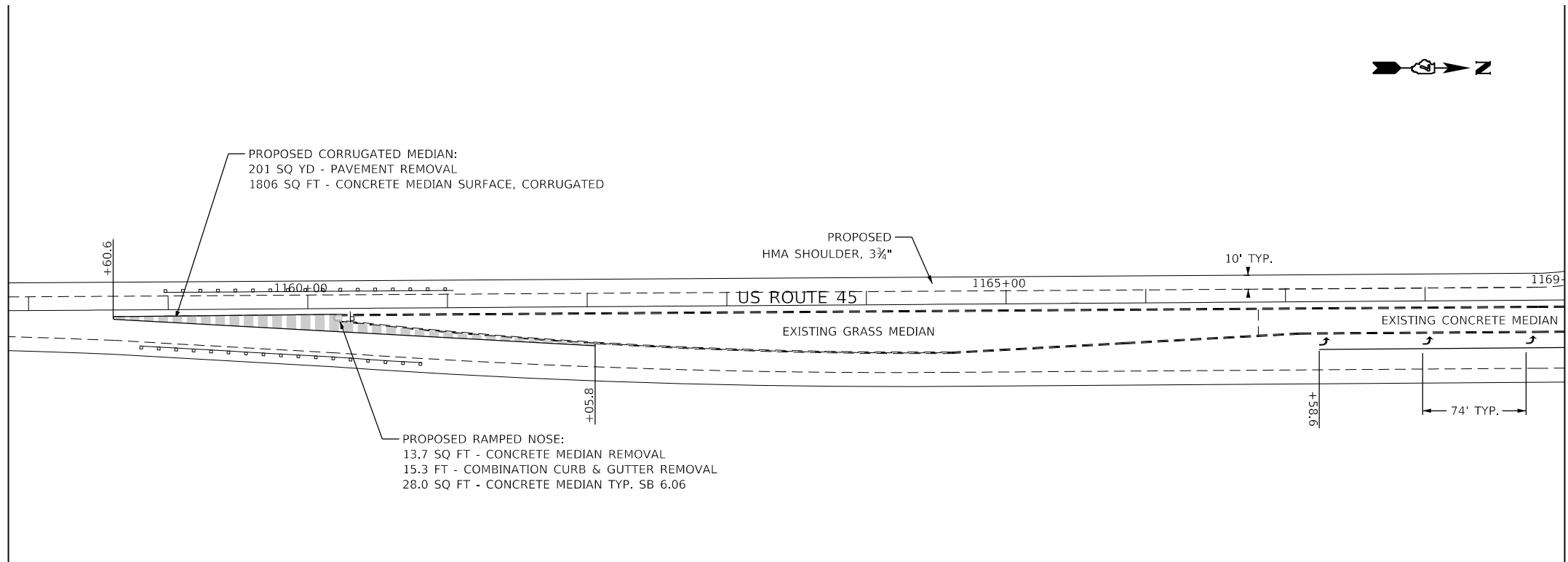

MODEL: Default
FILE: hma_milling_transition.dwg
PROJECT: 74906\CADD\DATA\CAD\Drawings\74906-shc-plan.dwg

USER NAME = steffenmk	DESIGNED - LMH	REVISED -
DRAWN - LMH	REVISIONS -	
PLOT SCALE = 100.0000 ' / in.	CHECKED -	REVISED -
PLOT DATE = 10/27/2020	DATE - 10/27/2020	REVISED -

STATE OF ILLINOIS
DEPARTMENT OF TRANSPORTATION

PLAN SHEETS

SCALE: 100.0000 ' / in SHEET OF SHEETS STA. TO STA.

F.A.P. RTE.	SECTION	COUNTY	TOTAL SHEETS	SHEET NO.
328A	(7,8,9,10)RS-2	CLAY	27	17
CONTRACT NO. 74906			ILLINOIS FED. AID PROJECT	



MATCHLINE STA. 1169 + 00.0

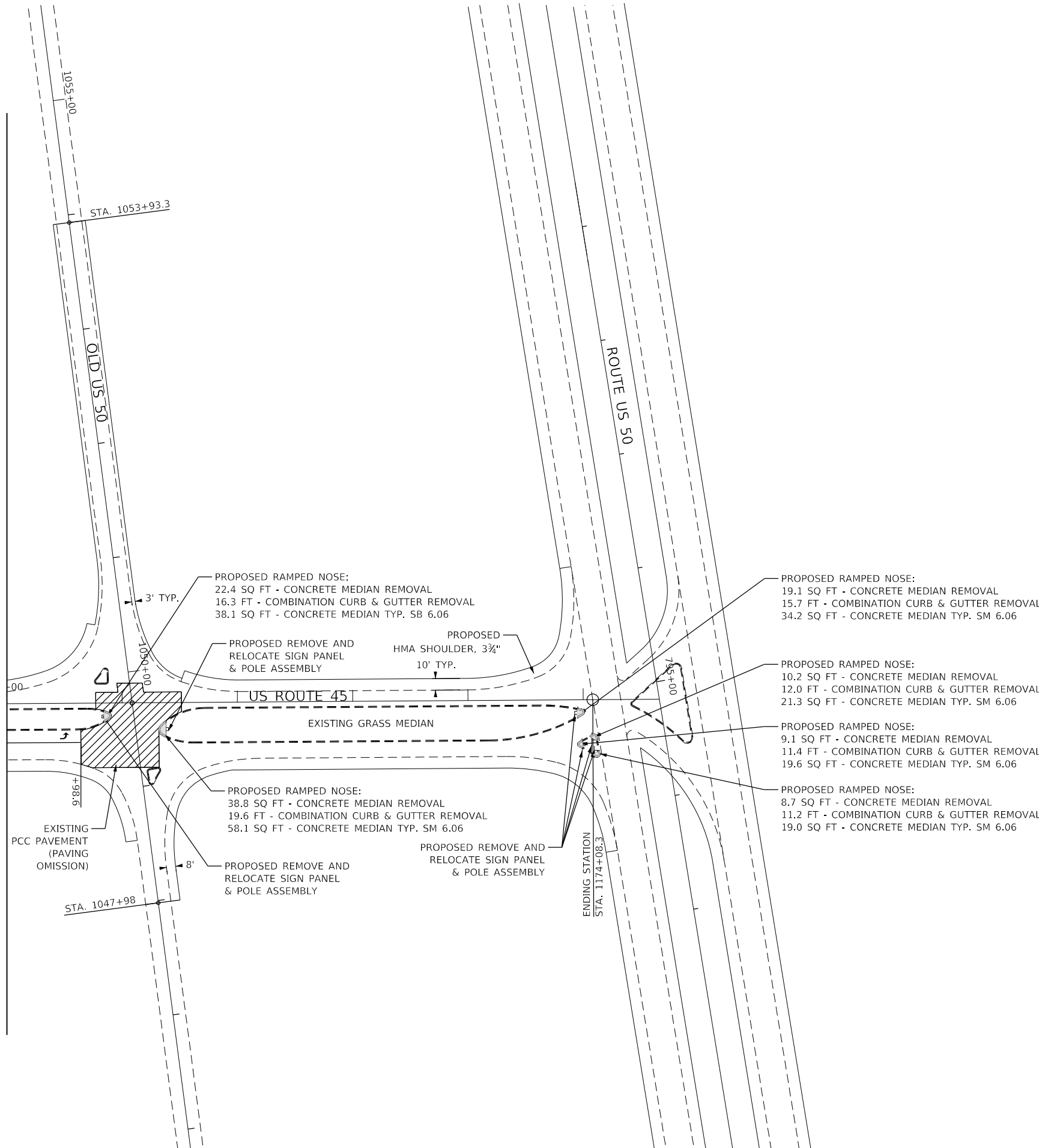

MODEL: Default
FILE: h:\m\c\p\pub\harcourm.dwg
PROJECT: 74906\CADD\DATA\CADD\Drawings\DOT_Offices\Drawings\74906-51c-plan.dwg

USER NAME = steffnmk	DESIGNED - LMH	REVISED -
	DRAWN - LMH	REVISED -
PLOT SCALE = 100.0000' / in.	CHECKED -	REVISED -
PLOT DATE = 10/27/2020	DATE - 10/27/2020	REVISED -

**STATE OF ILLINOIS
DEPARTMENT OF TRANSPORTATION**











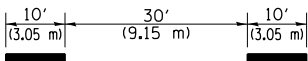

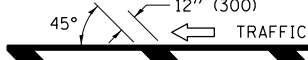
PLAN SHEETS

SCALE: 100.0000' / 1" SHEET OF SHEETS STA. TO STA.

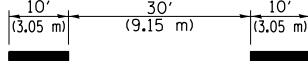
F.A.P. RTE.	SECTION	COUNTY	TOTAL SHEETS	SHEET NO.
328A	(7,8,9,10)RS-2	CLAY	27	18
CONTRACT NO. 74906				
ILLINOIS FED. AID PROJECT				



THERMOPLASTIC PAVEMENT MARKING LEGEND

- 1 4" (100) SKIP-DASH (YELLOW) 
 - 2 4" (100) SOLID (YELLOW) 
 - 3 12" (300) DIAGONAL (YELLOW) 
 - 4 4" (100) DOUBLE YELLOW (NARROW) 
 - 5 12" (300) SOLID WHITE 
 - 6 8" (100) SOLID YELLOW 
 - 7 6" (150) SKIP-DASH (WHITE) 
 - 8 4" (100) SOLID (WHITE) 
 - 9 12" (300) DIAGONAL (WHITE) 
 - 10 6" (150) SOLID (WHITE) 
 - 11 24" (600) STOP BAR (WHITE) 
 - 12 8" (200) SOLID (WHITE) 
 - 13 4" (100) PARKING WHITE 
- NOT TO SCALE

MATCHLINE STA. 1166 + 48.6

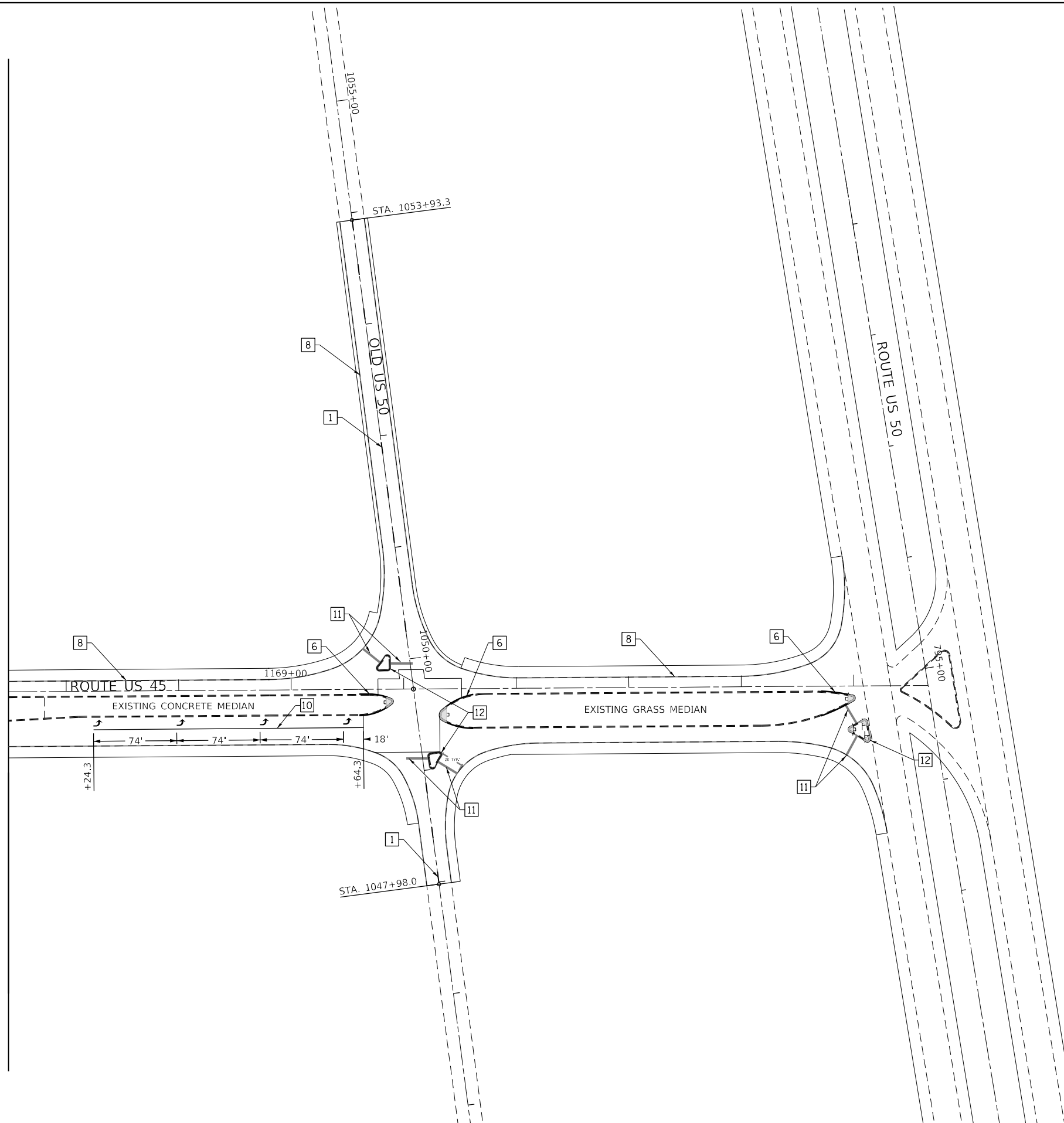

MODEL: Default
FILE: h:\mfc_p\pub\harcourt\illinois.gov\RWIDOT\Documents\DOT_Offices\Illin\74906\CADD\Drawings\74906-sht-001.dgn

USER NAME = steffenmk	DESIGNED - LMH	REVISED -
DRAWN - LMH	REVISIONS -	
PLOT SCALE = 100.0000' / in.	CHECKED -	REVISED -
PLOT DATE = 10/27/2020	DATE - 10/27/2020	REVISED -

**STATE OF ILLINOIS
DEPARTMENT OF TRANSPORTATION**

**PAVEMENT MARKING DETAIL (THERMOPLASTIC)
US 50 AND OLD US 50 INTERSECTIONS**

SCALE: 100.0000' / 1" SHEET OF SHEETS STA. TO STA.

F.A.P. RTE.	SECTION	COUNTY	TOTAL SHEETS	SHEET NO.
328A	(7,8,9,10)RS-2	CLAY	27	19
CONTRACT NO. 74906				
ILLINOIS FED. AID PROJECT				

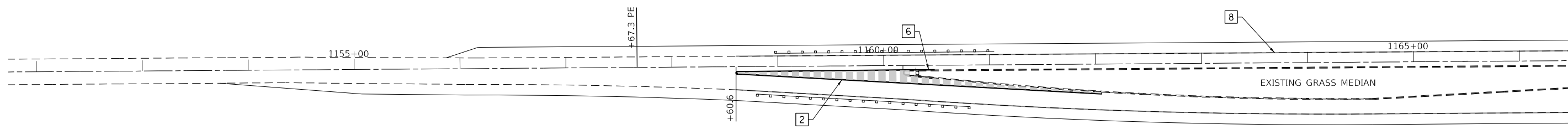

THERMOPLASTIC PAVEMENT MARKING LEGEND

- 1 4" (100) SKIP-DASH (YELLOW)
- 2 4" (100) SOLID (YELLOW)
- 3 12" (300) DIAGONAL (YELLOW)
- 4 4" (100) DOUBLE YELLOW (NARROW)
- 5 12" (300) SOLID WHITE
- 6 8" (100) SOLID YELLOW
- 7 6" (150) SKIP-DASH (WHITE)
- 8 4" (100) SOLID (WHITE)
- 9 12" (300) DIAGONAL (WHITE)
- 10 6" (150) SOLID (WHITE)
- 11 24" (600) STOP BAR (WHITE)
- 12 8" (200) SOLID (WHITE)
- 13 4" (100) PARKING WHITE

NOT TO SCALE

MODEL: Default
FILE NAME: p:\w\l\m\room\dm\illinois.gov\PIV\DOT\Documents\IDOT - Offices\B\B\refc - 7\Project\174906\CAD\CAD\Sheet\174906-sht-cpmk.dgn

USER NAME = steffenmk	DESIGNED - LMH	REVISED -
DRAWN - LMH	CHECKED -	REVISED -
PLOT SCALE = 100,0000 ' / in.	DATE - 10/27/2020	REVISED -
PLOT DATE = 10/27/2020		

**STATE OF ILLINOIS
DEPARTMENT OF TRANSPORTATION**

**PAVEMENT MARKING DETAIL (THERMOPLASTIC)
US 50 AND OLD US 50 INTERSECTIONS**

SCALE: 100,0000 ' / SHEET OF SHEETS STA. TO STA.

F.A.P. RTE.	SECTION	COUNTY	TOTAL SHEETS	SHEET NO.
328A	(7,8,9,10)RS-2	CLAY	27	20
CONTRACT NO. 74906			ILLINOIS FED. AID PROJECT	

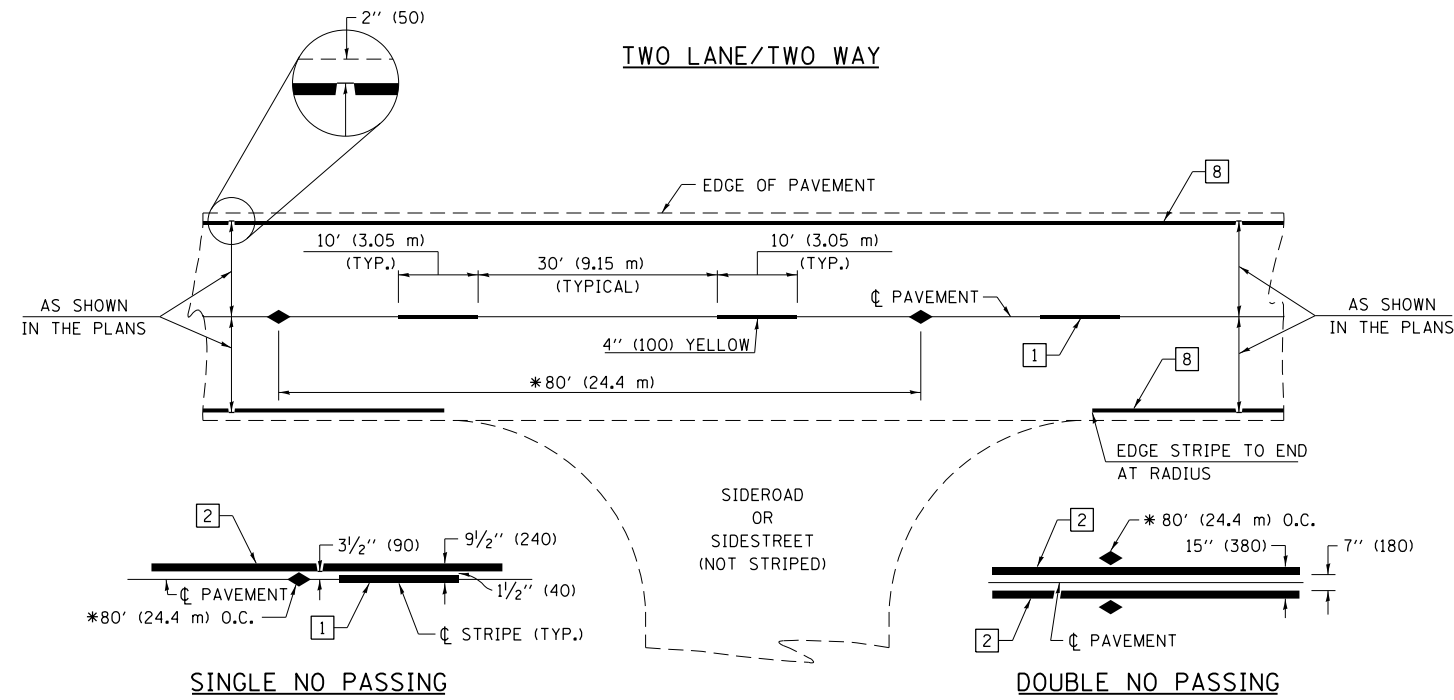

* REDUCE TO 40' (12.2 m) O.C. ON CURVES WITH POSTED OR ADVISORY SPEEDS OF 45 mph (70 km/h) OR LESS.

PAVEMENT MARKING LEGEND

- 1 4" (100) SKIP-DASH (YELLOW)
 - 2 4" (100) SOLID (YELLOW)
 - 3 12" (300) DIAGONAL (YELLOW)
 - 4 4" (100) DOUBLE YELLOW (NARROW)
 - 5 12" (300) SOLID WHITE
 - 6 RESERVED
 - 7 6" (150) SKIP-DASH (WHITE)
 - 8 4" (100) SOLID (WHITE)
 - 9 12" (300) DIAGONAL (WHITE)
 - 10 6" (150) SOLID (WHITE)
 - 11 24" (600) STOP BAR (WHITE)
 - 12 8" (200) SOLID (WHITE)
 - 13 4" (100) PARKING WHITE
-

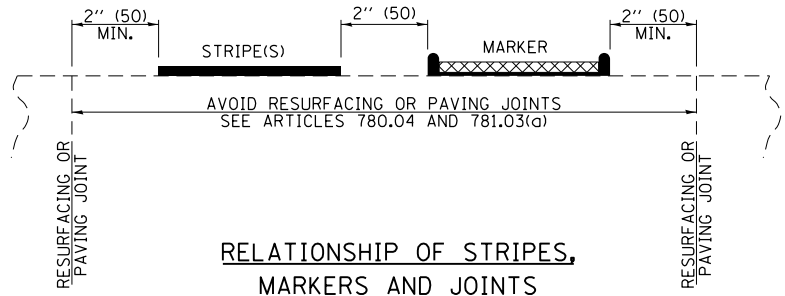

TYPICAL PAVEMENT MARKERS LEGEND

- ◆ TWO-WAY AMBER MARKER
- ▶ ONE-WAY AMBER MARKER
- ▷ ONE-WAY CRYSTAL MARKER

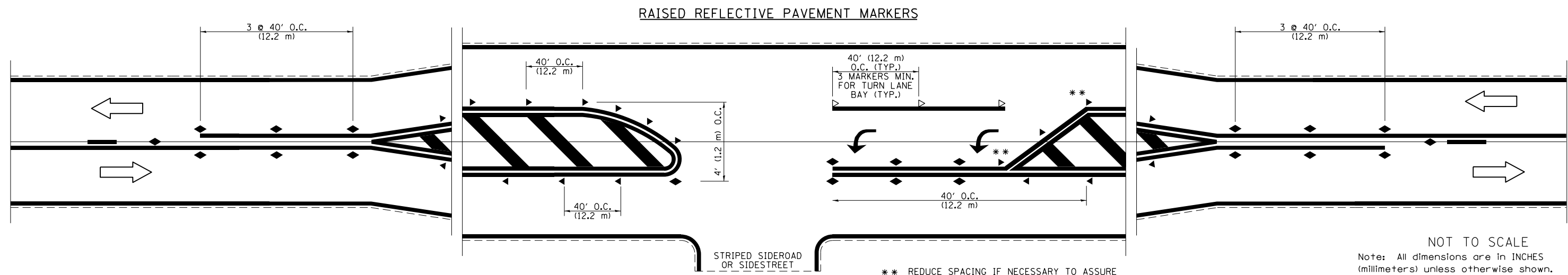

NOT TO SCALE
Note: All dimensions are in INCHES (millimeters) unless otherwise shown.

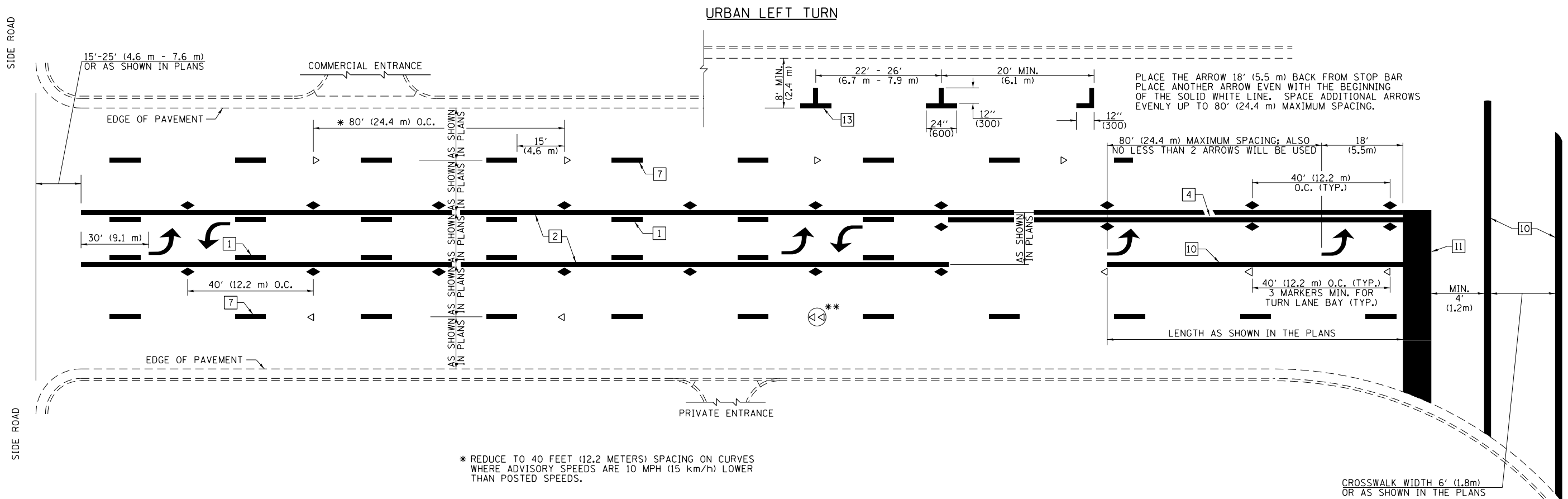

* REDUCE TO 40 FEET (12.2 METERS) SPACING ON CURVES WHERE ADVISORY SPEEDS ARE 10 MPH (15 km/h) LOWER THAN POSTED SPEEDS.

** DOUBLE LANE LINE MARKERS SHALL BE SPECIFIED AND SPACED AS SHOWN IN HIGHWAY STANDARD 781001 FOR MULTI-LANE DIVIDED AND UNDIVIDED HIGHWAYS.

PAVEMENT MARKING LEGEND

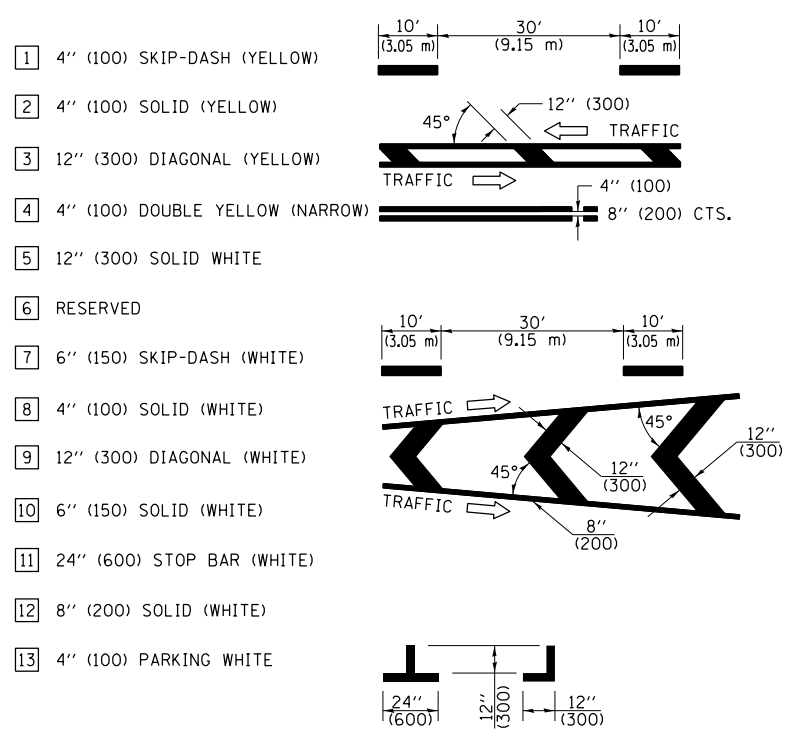

GENERAL NOTES

- TURN ARROW PAIRS SHALL BE PLACED AT 250' (75 m) INTERVALS AND SHALL BE EVENLY SPACED BETWEEN BOTH ENDS OF THE BIDIRECTIONAL LEFT TURN LANE. USE A MINIMUM OF TWO PAIRS PER BLOCK.
- THE SOLID YELLOW PAVEMENT MARKINGS [2] SHOULD GENERALLY START OR END NEAR THE RADIUS POINT OF EACH STREET RETURN EXCEPT WHERE ONE OR BOTH ENDS WOULD INCLUDE STOP BARS.
- THE SKIP-DASH PAVEMENT MARKINGS [1] OR [7] SHOULD BE CENTERED BETWEEN BOTH ENDS OF EACH CITY BLOCK AND SHALL BE PLACED SO THEY LINE UP ACROSS FROM EACH OTHER.
- USE LARGE ARROW SIZE FOR BOTH RURAL AND URBAN LOCATIONS. (SEE LAST PAGE OF SECTION 780x FOR SYMBOLS TABLE)
- LANE LINE EXTENSIONS SHALL BE THE SAME COLOR AND WIDTH AS THE LANE LINE BEING EXTENDED.

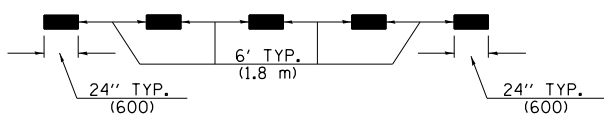

LANE LINE EXTENSIONS

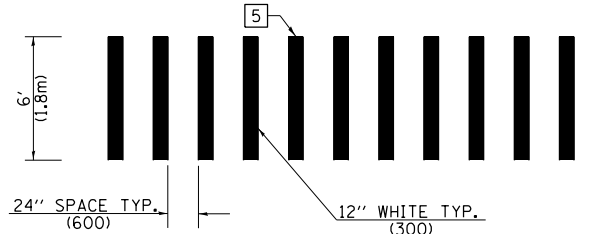

CROSSWALK DETAIL (DECATUR CITY LIMITS ONLY)

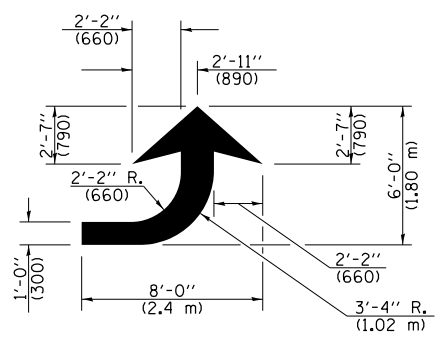

LEFT ARROW

REVERSE FOR RIGHT ARROW
AREA = 15.6 SQ. FT. (1.47 m²)
(WHITE)

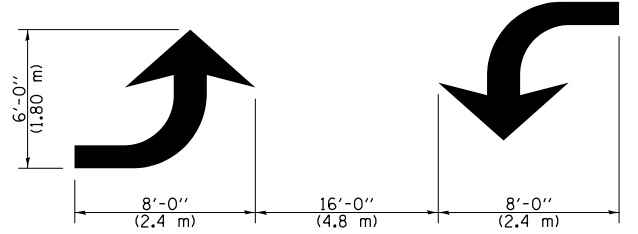

TYPICAL DOUBLE TURN ARROWS (WHITE)

NOT TO SCALE

Note: All dimensions are in INCHES (millimeters) unless otherwise shown.

DISTRICT 7 DETAIL NO. 7800001

FILE NAME =	USER NAME = steffenmk	DESIGNED -	REVISED -
pw:\planroom.dot.illinois.gov\PWIDOT\Documents\IDOT Offices\District 7\Projects\74906\DRAWN\CADsheets\0774906-shd-details.dwg		REVISOR -	REVISED -
	PLOT SCALE = 100.0000' / in.	CHECKED -	REVISED -
	PLOT DATE = 10/27/2020	DATE -	REVISED -

**STATE OF ILLINOIS
DEPARTMENT OF TRANSPORTATION**

**PAVEMENT MARKING AND RAISED REFLECTIVE PAVEMENT MARKERS
(RURAL & URBAN APPLICATIONS)**

SCALE: NO SCALE SHEET NO. 2 OF 4 SHEETS STA. TO STA.

F.A.P. RTE.	SECTION	COUNTY	TOTAL SHEETS	SHEET NO.
328A	(7,8,9,10)R5-2	CLAY	27	22
CONTRACT NO. 74906			ILLINOIS FED. AID PROJECT	

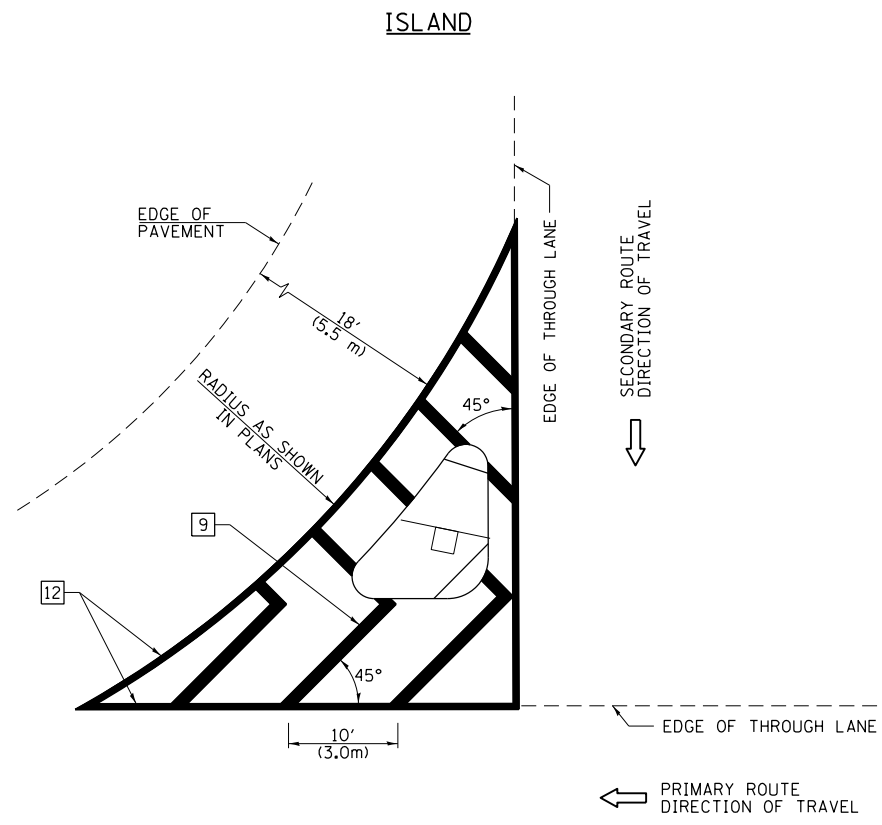

GENERAL NOTES

1. RAISED AND CORRUGATED MEDIANS SHALL BE OUTLINED WITH [2] IF PRESENT.
2. SOME OF THE INFORMATION INCLUDED WITH THIS DETAIL MAY NOT BE APPLICABLE TO THIS IMPROVEMENT.
3. PAVEMENT MARKINGS ARE TO BE EXTENDED THROUGH OMISSIONS WHEN APPLICABLE.
4. FINAL PAVEMENT MARKINGS SHALL BE IN PLACE PRIOR TO PLACING ANY RAISED REFLECTIVE PAVEMENT MARKERS.
5. THE FOLLOWING CRITERIA SHALL BE USED FOR SELECTING THE DIAGONAL PAVEMENT MARKING SPACING:

< 30 MPH (< 50 km/h)	15' (4.5 m)
30-45 MPH (50-75 km/h)	20' (6.0 m)
> 45 MPH (> 75 km/h)	30' (9.0 m)

PAVEMENT MARKING LEGEND

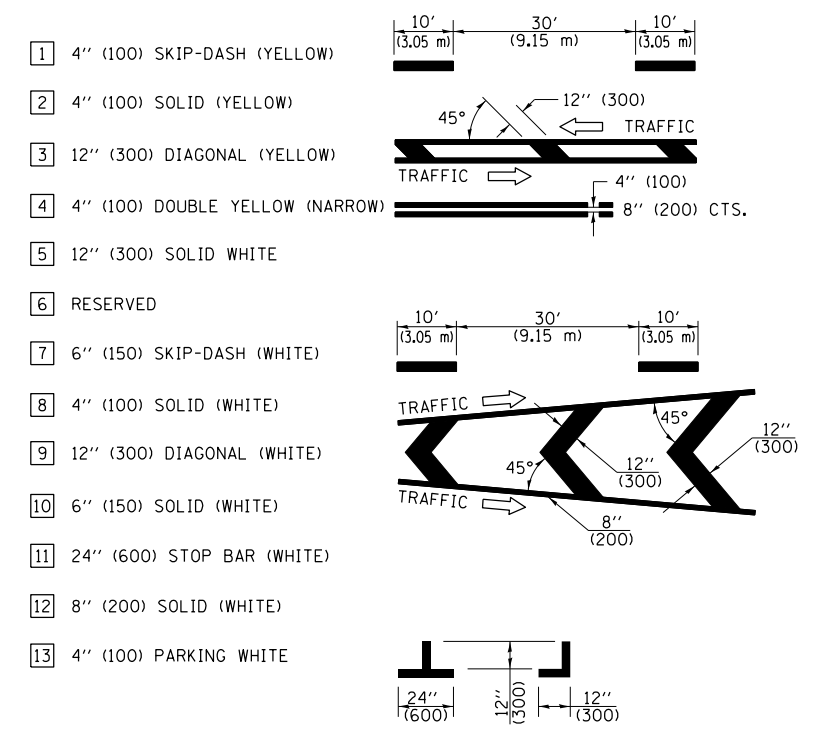

RURAL LEFT TURN STRIPING

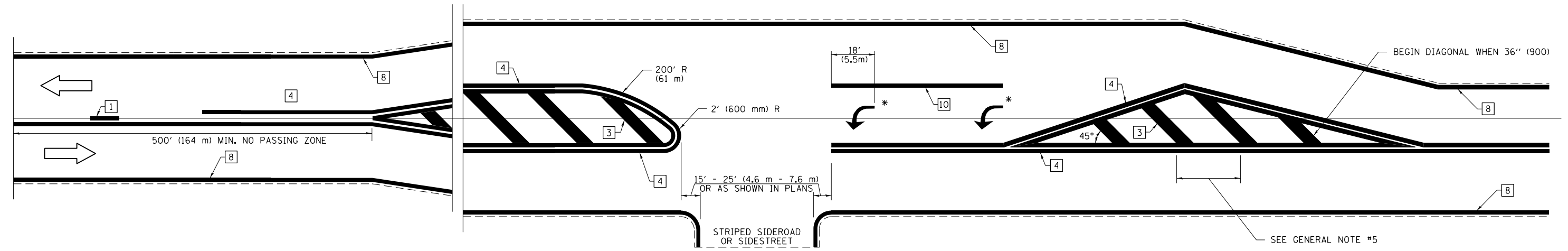

* PLACE AN ARROW 18' (5.5 m) BACK FROM STOP BAR. PLACE ANOTHER ARROW EVEN WITH THE BEGINNING OF THE SOLID WHITE LINE. SPACE ADDITIONAL ARROWS EVENLY UP TO 80' (24.4 m) MAXIMUM SPACING. USE MINIMUM OF 2 ARROWS.

NOT TO SCALE
 Note: All dimensions are in INCHES (millimeters) unless otherwise shown.

DISTRICT 7 DETAIL NO. 7800001

FILE NAME =	USER NAME = steffenmk	DESIGNED -	REVISED -
pw:\planroom.dot.illinois.gov\PIDOT\Documents\IDOT Offices\District 7\Projects\74906\DRAWN\CADsheets\0774906-shd-details.dgn		REVISIONS	REVISED -
	PLOT SCALE = 100.0000' / in.	CHECKED -	REVISED -
	PLOT DATE = 10/27/2020	DATE -	REVISED -

**STATE OF ILLINOIS
 DEPARTMENT OF TRANSPORTATION**

PAVEMENT MARKING AND RAISED REFLECTIVE PAVEMENT MARKERS (RURAL & URBAN APPLICATIONS)			
SCALE: NO SCALE	SHEET NO. 3 OF 4 SHEETS	STA.	TO STA.

F.A.P. RTE.	SECTION	COUNTY	TOTAL SHEETS	SHEET NO.
328A	(7,8,9,10)RS-2	CLAY	27	23
CONTRACT NO. 74906			ILLINOIS FED. AID PROJECT	

PAVEMENT MARKINGS AT RAILROAD-HIGHWAY GRADE CROSSING

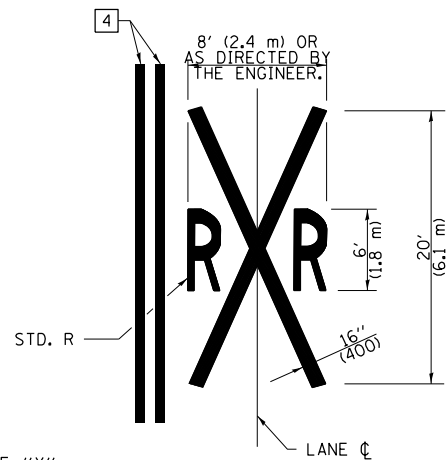
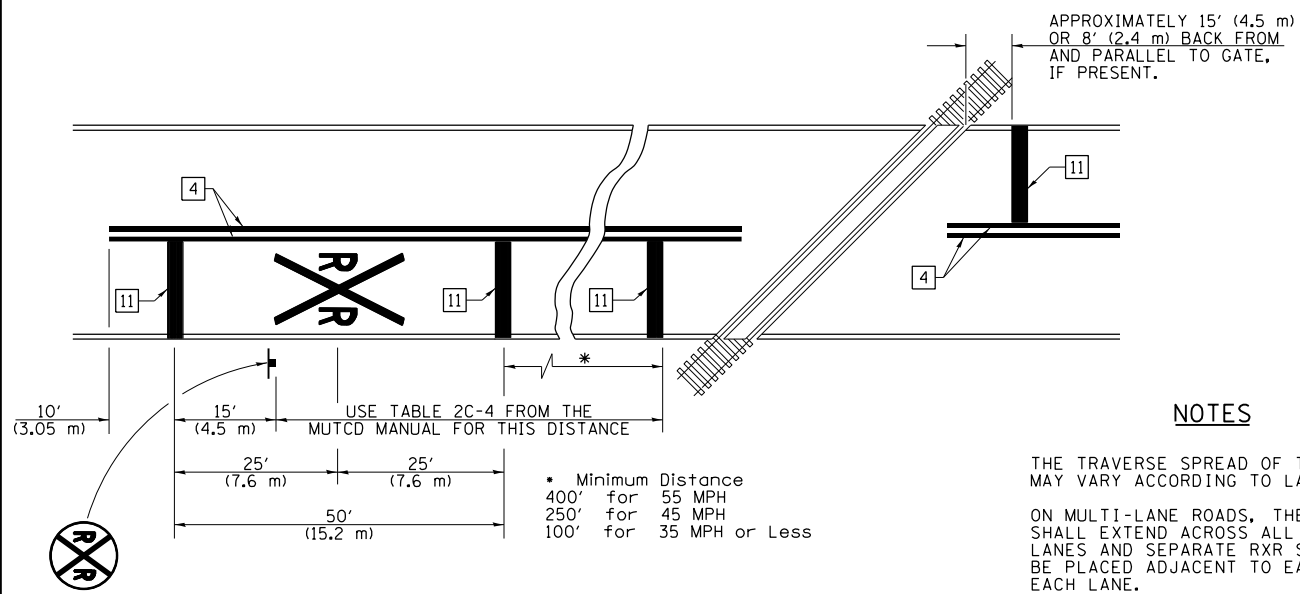

NOTES

APPROXIMATELY 15' (4.5 m) OR 8' (2.4 m) BACK FROM AND PARALLEL TO GATE, IF PRESENT.

THE TRAVERSE SPREAD OF THE "X" MAY VARY ACCORDING TO LANE WIDTH.

ON MULTI-LANE ROADS, THE STOP LINES SHALL EXTEND ACROSS ALL APPROACH LANES AND SEPARATE RXR SYMBOLS SHALL BE PLACED ADJACENT TO EACH OTHER IN EACH LANE.

WHEN THE PAVEMENT MARKING SYMBOL IS USED, A PORTION OF THE SYMBOL SHOULD BE LOCATED DIRECTLY ADJACENT TO THE ADVANCE WARNING SIGN (W10-1) AS PLACED BY TABLE II-1, CONDITION B OF THE MUTCD.

PAVEMENT MARKING LEGEND

- 1 4" (100) SKIP-DASH (YELLOW)
- 2 4" (100) SOLID (YELLOW)
- 3 12" (300) DIAGONAL (YELLOW)
- 4 4" (100) DOUBLE YELLOW (NARROW)
- 5 12" (300) SOLID WHITE
- 6 RESERVED
- 7 6" (150) SKIP-DASH (WHITE)
- 8 4" (100) SOLID (WHITE)
- 9 12" (300) DIAGONAL (WHITE)
- 10 6" (150) SOLID (WHITE)
- 11 24" (600) STOP BAR (WHITE)
- 12 8" (200) SOLID (WHITE)
- 13 4" (100) PARKING WHITE

RAILROAD CROSSING WITH INTERCONNECT ONLY

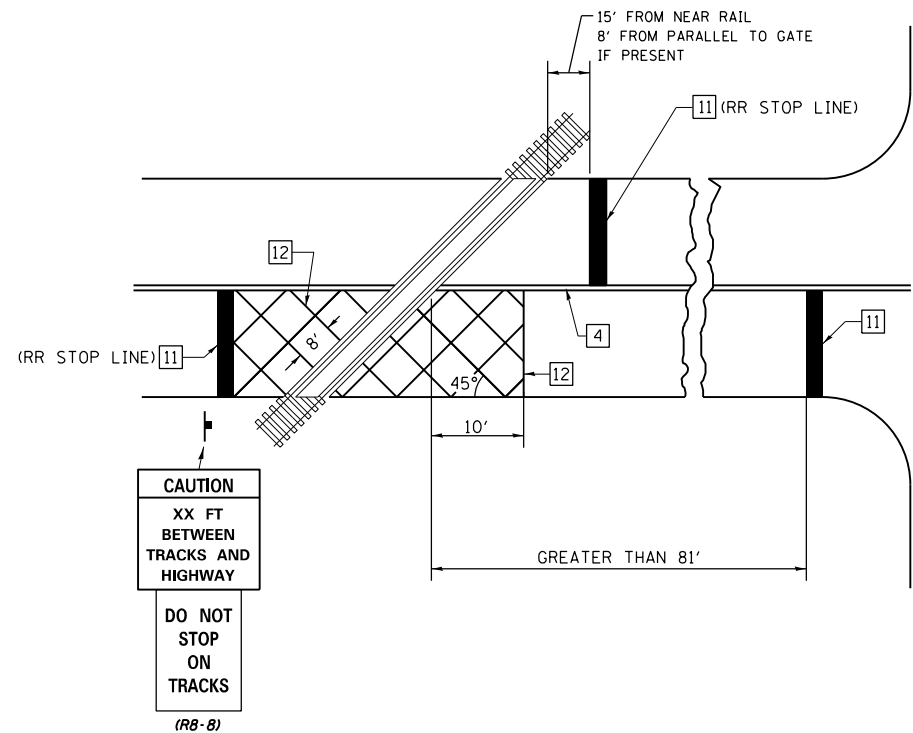

RAILROAD CROSSING WITH INTERCONNECT AND PRE-SIGNALS

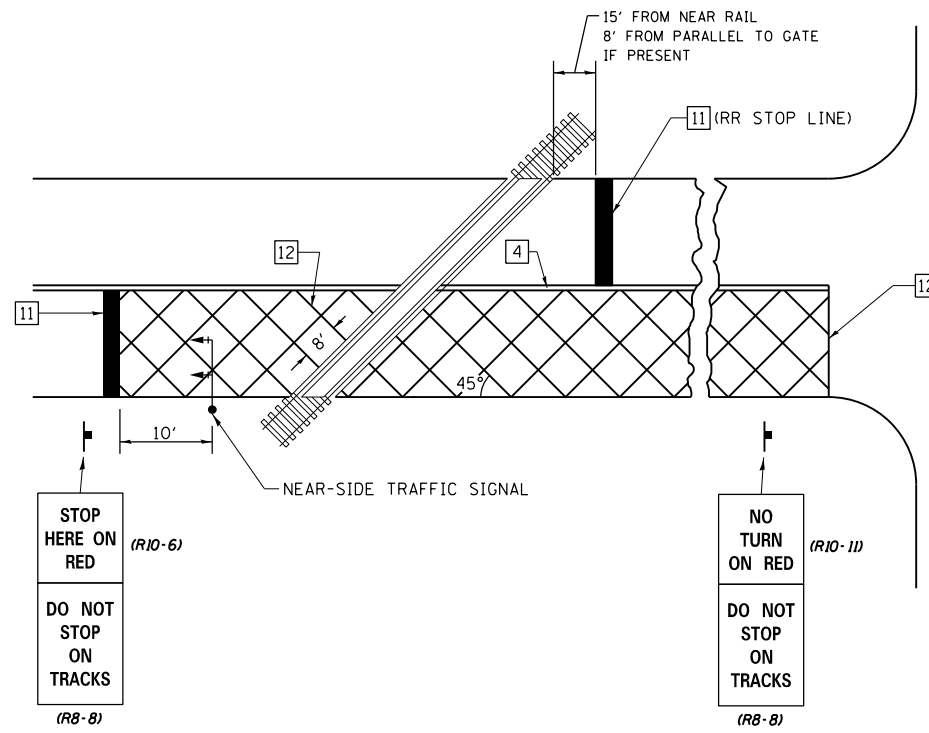

GENERAL NOTES

- SUPPLEMENTAL PAVEMENT MARKINGS TO BE INSTALLED ONLY ON APPROACHES TO INTERSECTIONS CONTROLLED BY TRAFFIC SIGNALS WHICH ARE INTERCONNECTED WITH THE RAILROAD WARNING SIGNALS.
- EXTEND PAVEMENT MARKINGS TO THE INTERSECTION ONLY WHERE NEAR-SIDE TRAFFIC SIGNALS ARE USED.

SUPPLEMENTAL PAVEMENT MARKING TREATMENT FOR RAILROAD-HIGHWAY GRADE CROSSING

NOT TO SCALE

Note: All dimensions are in INCHES (millimeters) unless otherwise shown.

DISTRICT 7 DETAIL NO. 7800001

FILE NAME =	USER NAME = steffenmk	DESIGNED -	REVISED -	STATE OF ILLINOIS DEPARTMENT OF TRANSPORTATION	PAVEMENT MARKING AND RAISED REFLECTIVE PAVEMENT MARKERS (RURAL & URBAN APPLICATIONS)	F.A.P. RTE.	SECTION	COUNTY	TOTAL SHEETS	SHEET NO.
pw:\planroom.dot.illinois.gov\PIWIDOT\Documents\IDOT Offices\District 7\Projects\74906\DRAWN\CADsheets\0774906-shd-details.dgn		CHECKED -	REVISED -			328A	(7,8,9,10)RS-2	CLAY	27	24
		DATE -	REVISED -			CONTRACT NO. 74906				
						ILLINOIS FED. AID PROJECT				

TYPICAL PLACEMENT OF PRISMATIC CURB REFLECTORS

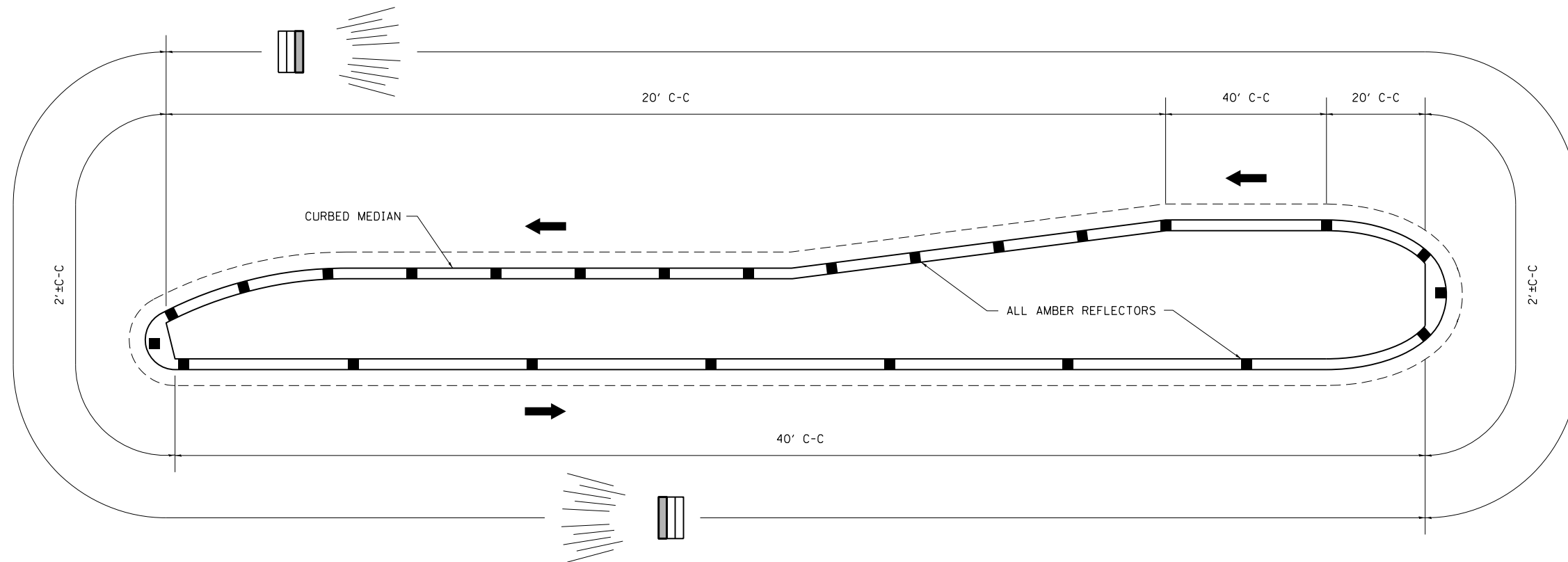

1. PRISMATIC REFLECTORS SHALL BE MONO-DIRECTIONAL AND POSITIONED SO THAT THE REFLECTIVE FACE IS FACING THE APPROACHING TRAFFIC.
2. PRISMATIC REFLECTORS SHALL BE SECURED IN PLACE WITH AN EPOXY ADHESIVE.
3. PRISMATIC REFLECTORS SHALL BE EITHER AMBER OR CRYSTAL IN COLOR.
4. REFER TO SCHEDULES FOR PRISMATIC REFLECTOR QUANTITIES.
5. USE A MINIMUM OF 3 REFLECTORS ON ISLAND NOSES.

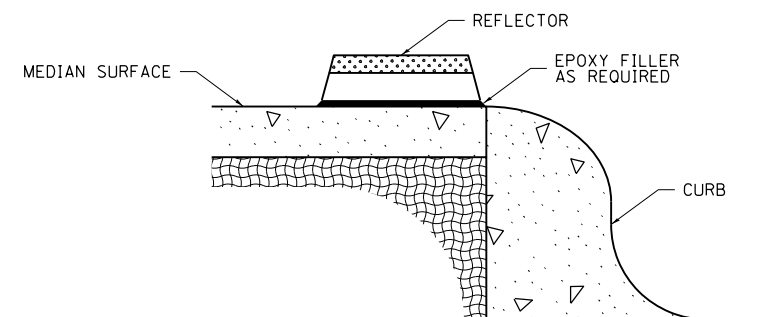
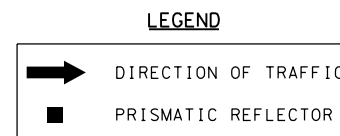
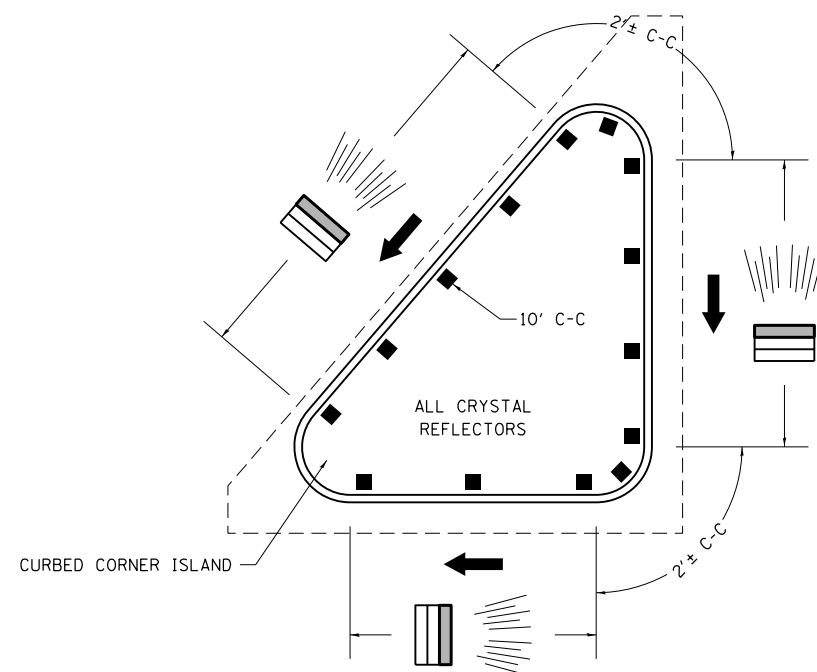

SECTION VIEW

NOT TO SCALE

DISTRICT 7 DETAIL NO. 78200300

FILE NAME =	USER NAME = steffenmk	DESIGNED -	REVISED -
p:\planroom.dot\illinois.gov\PWIDOT\Documents\IDOT Offices\District 7\Projects\74906\DRAWING\CADsheets\0774906-shr-details.dgn		CHECKED -	REVISED -
	PLOT SCALE = 100.0000' / 1in.	DATE -	REVISED -
	PLOT DATE = 10/27/2020		

STATE OF ILLINOIS
DEPARTMENT OF TRANSPORTATION

PRISMATIC CURB REFLECTOR

SCALE: NO SCALE SHEET NO. OF SHEETS STA. TO STA.

F.A.P. RTE.	SECTION	COUNTY	TOTAL SHEETS	SHEET NO.
328A	(7,8,9,10)RS-2	CLAY	27	25
FED. ROAD DIST. NO. ILLINOIS FED. AID PROJECT			CONTRACT NO. 74906	

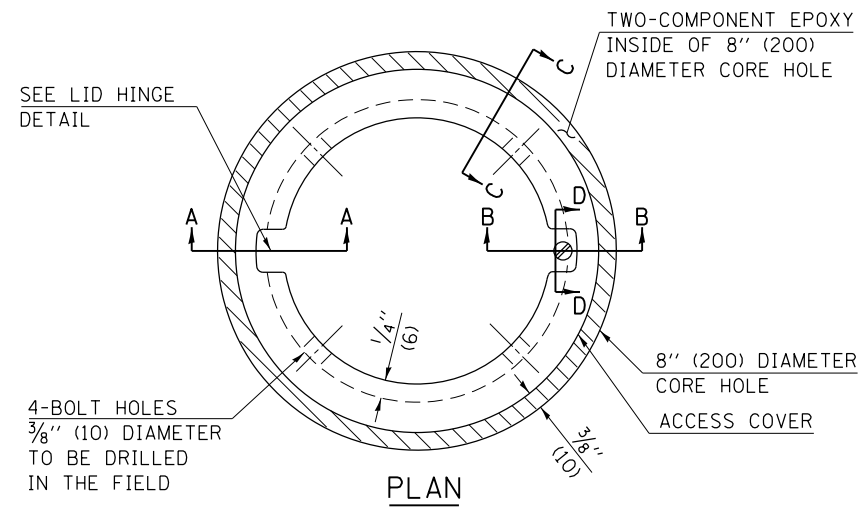

- LEGEND**
- ALUMINUM CASTING
 - 5" (125) OR 6" (150) P.V.C. PIPE
 - TWO-COMPONENT EPOXY
- T = THICKNESS OF PAVEMENT STRUCTURE
- H = THE THICKNESS OF THE SUB-BASE GRANULAR + 1" (25)

BILL OF MATERIAL	
ALUMINUM CASTING OF THE DIMENSIONS AND SPECIFICATIONS SHOWN OR OTHER SUBJECT TO ENGINEER'S APPROVAL OF SHOP DRAWINGS,	
4 EACH - 5/16" X 2" (M8 X 50) BOLTS WITH NUTS, EPOXY,	
5" OR 6" (125 mm OR 150 mm) DIAMETER P.V.C. PIPE, SCHEDULE 40 (WHEN REQUIRED).	

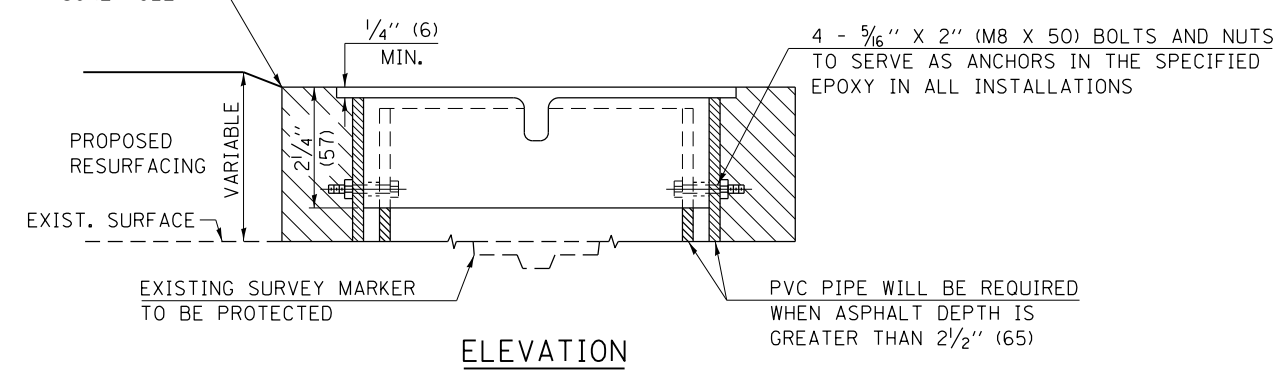
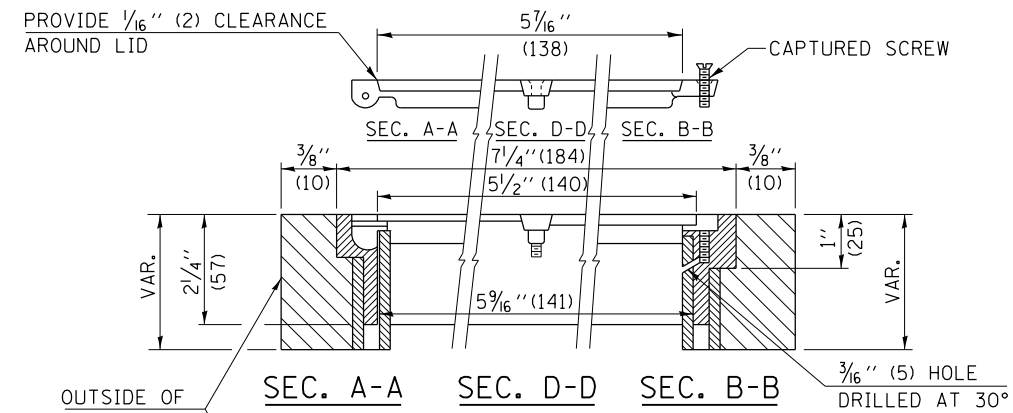
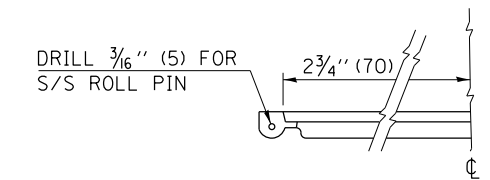
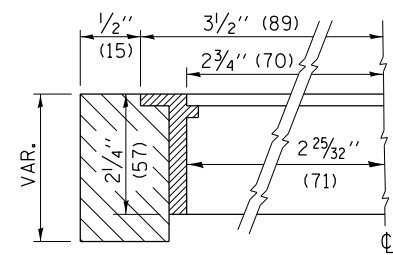

EXISTING SURVEY MARKER

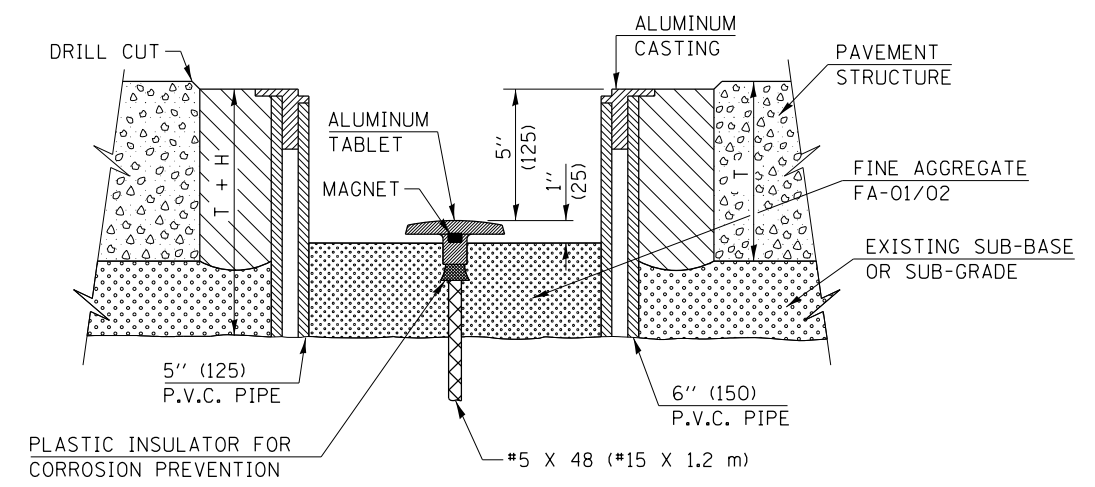

PROPOSED SURVEY MARKER

NOT TO SCALE

Note: All dimensions are in INCHES (millimeters) unless otherwise shown.

FILE NAME =	USER NAME = steffennk	DESIGNED -	REVISED - MAD 6-11
pw:\planroom.dot.illinois.gov\PIDOT\Documents\IDOT Offices\District 7\Projects\74906\DRAWING\CADsheets\0774906-shr-details.dgn		CHECKED -	REVISED -
		PLOT SCALE = 100.0000' / 1in.	REVISOR -
		PLOT DATE = 10/27/2020	DATE -

STATE OF ILLINOIS
DEPARTMENT OF TRANSPORTATION

SURVEY MARKER VAULT			
SCALE:	SHEET NO.	OF SHEETS	STA. TO STA.
NO SCALE			

DISTRICT 7 DETAIL NO. Z0070202				
F.A.P. RTE.	SECTION	COUNTY	TOTAL SHEETS	SHEET NO.
328A	(7,8,9,10)RS-2	CLAY	27	26
FED. ROAD DIST. NO.			ILLINOIS FED. AID PROJECT	
			CONTRACT NO. 74906	

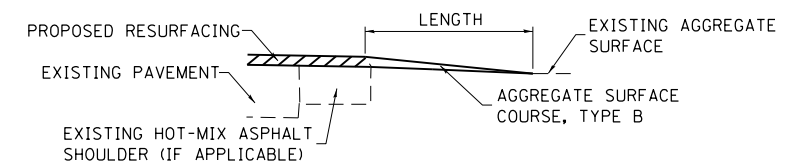
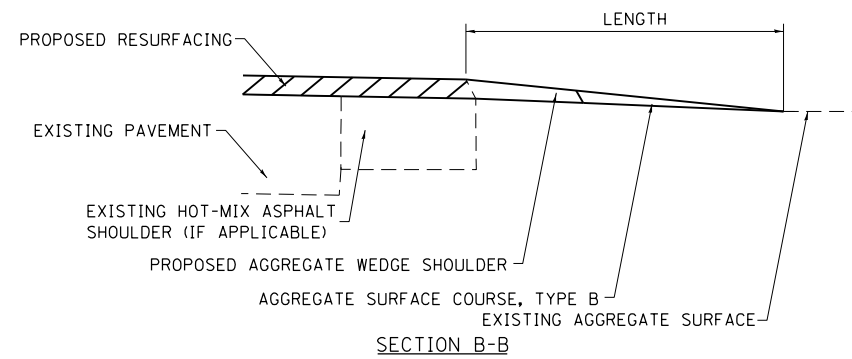
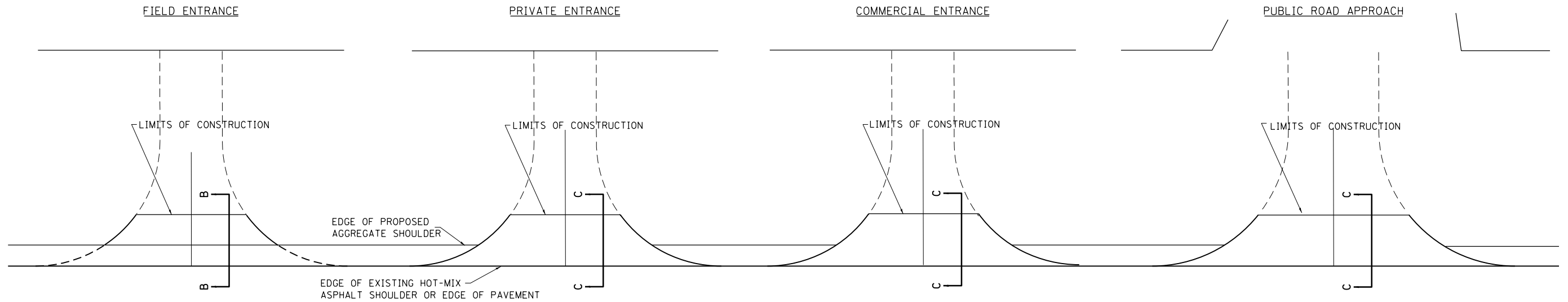

SECTION C-C

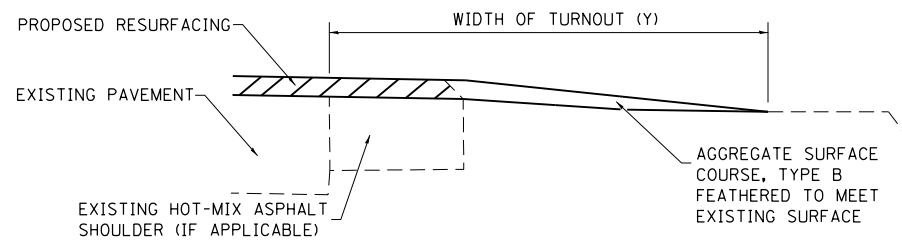

TYPICAL SECTION AT MAILBOX TURNOUT

NOTE: SEE STANDARD 406201 FOR MAILBOX TURNOUT DETAILS

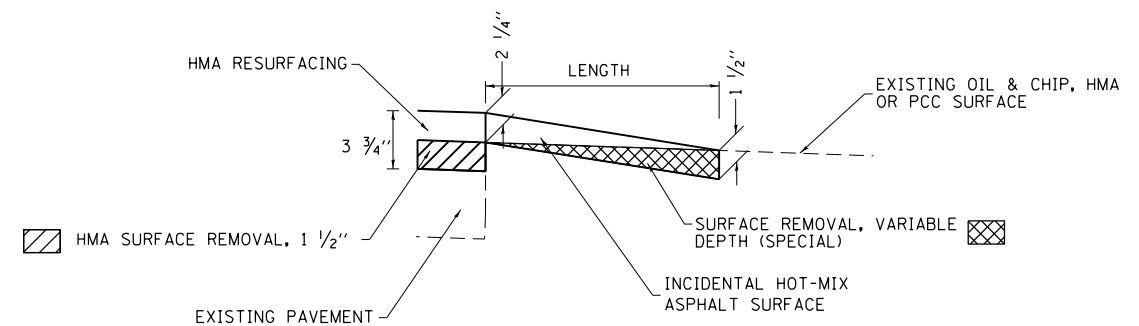

SECTION C-C

NOTES

LENGTH = 10' UNLESS OTHERWISE NOTED ON PLANS

IF THERE IS NOT EXISTING HOT-MIX ASPHALT SHOULDER THEN THE ENTRANCE TAPER STARTS AT THE EDGE OF EXISTING PAVEMENT.

MODEL: Default
FILE: Mailbox_Turnout.dwg
PROJECT: 74906-CD-Data-CAD-Drawings-10774906-shd-drawings.dwg

USER NAME = steffenmk	DESIGNED -	REVISED -
	DRAWN -	REVISED -
PLOT SCALE = 100.0000' / in.	CHECKED -	REVISED -
PLOT DATE = 10/27/2020	DATE -	REVISED -

STATE OF ILLINOIS
DEPARTMENT OF TRANSPORTATION

RURAL ENTRANCE AND MAILBOX TURNOUT DETAILS
WITH SHOULDERS

SCALE: NO SCALE SHEET OF SHEETS STA. TO STA.

F.A.P. RTE.	SECTION	COUNTY	TOTAL SHEETS	SHEET NO.
328A	(7,8,9,10)RS-2	CLAY	27	27
CONTRACT NO. 74906			ILLINOIS FED. AID PROJECT	