

STATE OF ILLINOIS  
DEPARTMENT OF TRANSPORTATION

F.A.P. RTE.	SECTION	COUNTY	TOTAL SHEETS	SHEET NO.
338	2020-122-1	WILL	22	1
		ILLINOIS	CONTRACT NO. 62M00	

FOR INDEX OF SHEETS, SEE SHEET NO. 2

THIS PROJECT IS LOCATED IN THE VILLAGE OF PLAINFIELD AND CITY NAPERVILLE

PROPOSED  
HIGHWAY PLANS

FAP ROUTE 338: IL 59  
DUPAGE CO LINE TO N OF PHEASANT CHASE DR  
SECTION: 2020-122-1

CRACK AND JOINT SEALING  
WILL COUNTY  
C-91-320-20

TRAFFIC DATA:

IL 59:  
ADT (2019) = 49300  
SPEED LIMIT = 45 MPH

PROJECT ENDS  
STA 352 + 71

PROJECT BEGINS  
STA 15 + 05

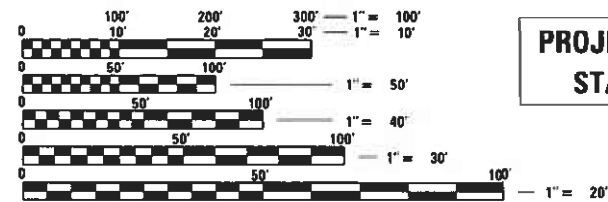

FULL SIZE PLANS HAVE BEEN PREPARED USING STANDARD ENGINEERING SCALES. REDUCED SIZED PLANS WILL NOT CONFORM TO STANDARD SCALES. IN MAKING MEASUREMENTS ON REDUCED PLANS, THE ABOVE SCALES MAY BE USED.

J.U.L.I.E.  
JOINT UTILITY LOCATION INFORMATION FOR EXCAVATION  
1-800-892-0123  
OR 811

PROJECT ENGINEER: VESELIN VELICHKOV (847) 705-4432  
PROJECT MANAGER: FAWAD AQUEEL (847) 705-4247

CONTRACT NO. 62M00

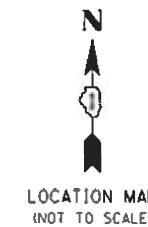
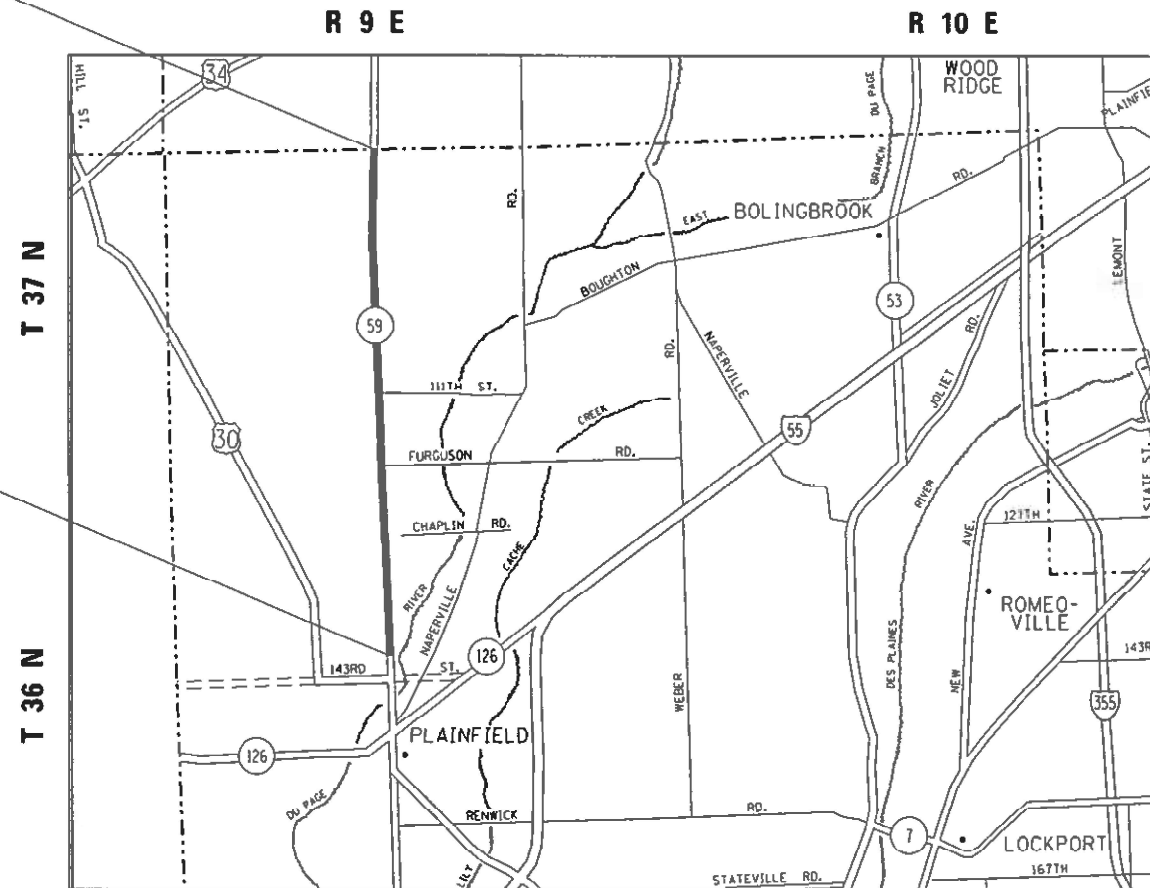

LOCATION OF SECTION INDICATED THUS: - [Symbol] -

D-91-522-20

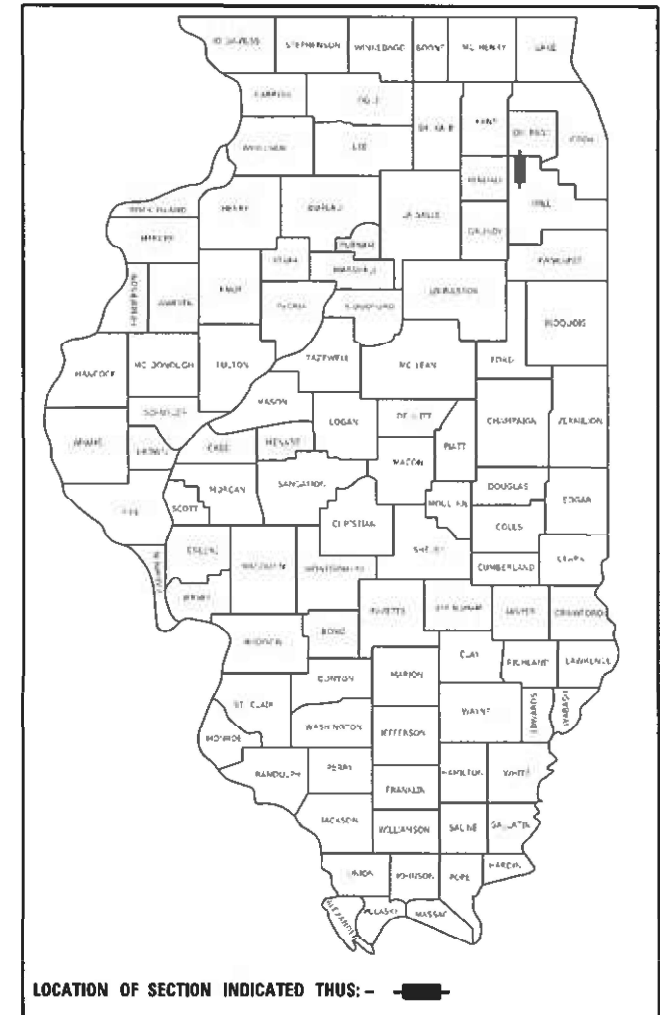

STATE OF ILLINOIS  
DEPARTMENT OF TRANSPORTATION

SUBMITTED July 28 2020  
Andy J. Drury REGIONAL ENGINEER

October 2, 2020  
Scott A. Clark  
ENGINEER OF DESIGN AND ENVIRONMENT

October 2, 2020  
James J. Gu  
DIRECTOR OF HIGHWAYS PROJECT IMPLEMENTATION

PRINTED BY THE AUTHORITY  
OF THE STATE OF ILLINOIS





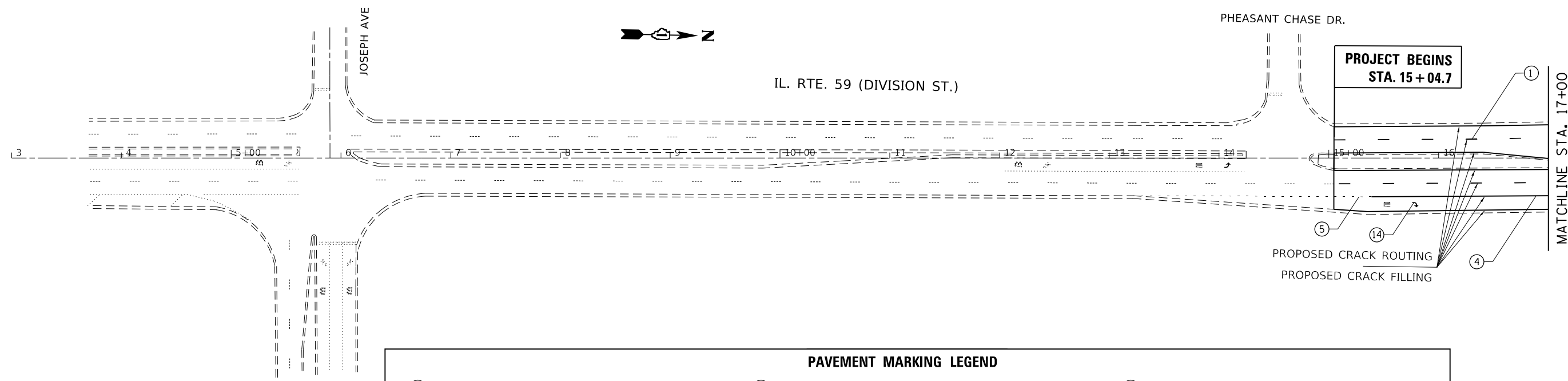

**PAVEMENT MARKING LEGEND**

① PROP. MODIFIED URETHANE PAVEMENT MARKING LINE, 4" SKIP DASH WHITE LANE LINE @ 30' SKIP & 10' DASH	⑥ PROP. MODIFIED URETHANE PAVEMENT MARKING LINE, 6" SOLID WHITE CROSSWALK LINE, 2 @ 6' C-C	⑪ PROP. MODIFIED URETHANE PAVEMENT MARKING LINE, 12" DIAGONAL SOLID YELLOW LINE @ 75' SPACING OR 5 MIN.
② PROP. MODIFIED URETHANE PAVEMENT MARKING LINE, 4" SOLID WHITE LINE	⑦ PROP. MODIFIED URETHANE PAVEMENT MARKING LINE, 8" SOLID WHITE GORE MARKING AND CHANNELIZING LINES	⑫ PROP. MODIFIED URETHANE PAVEMENT MARKING LINE, 12" DIAGONAL SOLID WHITE LINE @ 75' SPACING OR 5 MIN.
③ PROP. MODIFIED URETHANE PAVEMENT MARKING LINE, 4" DOUBLE SOLID YELLOW LINE, 2 @ 11" C-C	⑧ PROP. MODIFIED URETHANE PAVEMENT MARKING LINE, 12" SOLID WHITE GORE MARKINGS @ 45 DEG.	⑬ PROP. MODIFIED URETHANE PAVEMENT MARKING LETTERS & SYMBOLS, SOLID WHITE
④ PROP. MODIFIED URETHANE PAVEMENT MARKING LINE, 6" SOLID WHITE TURN LANE	⑨ PROP. MODIFIED URETHANE PAVEMENT MARKING LINE, 12" SOLID WHITE LONGITUDINAL BAR @ 90°, 2' SPACING	⑭ PROP. MODIFIED URETHANE PAVEMENT MARKING LINE, 24" SOLID WHITE STOP BAR
⑤ PROP. MODIFIED URETHANE PAVEMENT MARKING LINE, 6" SKIP DASH WHITE TURN LANE @ 6' SKIP & 2' DASH	⑩ PROP. MODIFIED URETHANE PAVEMENT MARKING LINE, 12" SOLID WHITE LONGITUDINAL BAR @ 45°, 2' SPACING	⑮ PROP. MODIFIED URETHANE PAVEMENT MARKING LINE, 6" SOLID WHITE GORE MARKING AND CHANNELIZING LINES

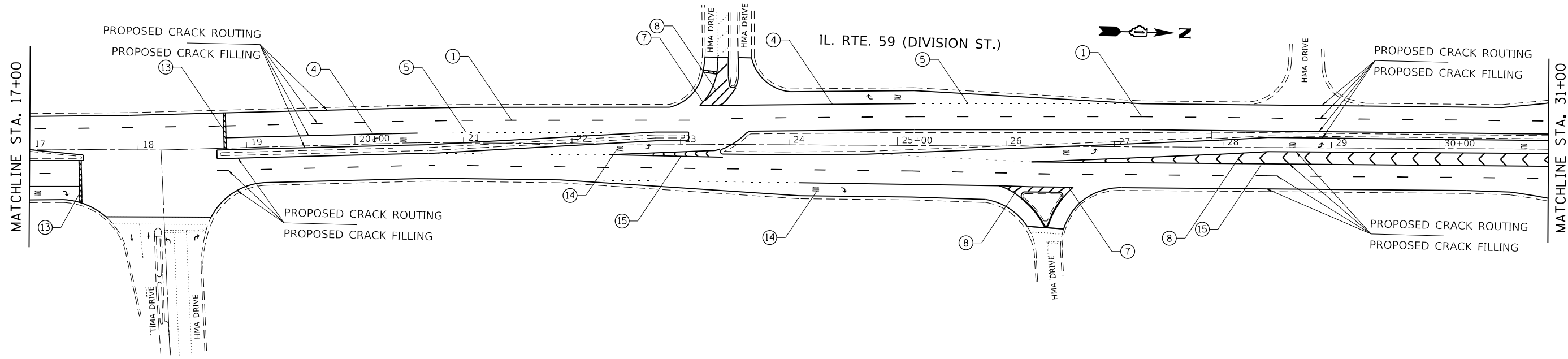

MODEL: Default  
 FILE: \\blm1c:\pub\baronm.dwg  
 PROJECT: \\blm1c:\pub\baronm.dwg  
 PLOT DATE: 8/14/2020

USER NAME = elkhatibaj	DESIGNED -	REVISED -
PLOT SCALE = 100,0000' / in.	DRAWN -	REVISED -
PLOT DATE = 8/14/2020	CHECKED -	REVISED -
	DATE -	REVISED -

**STATE OF ILLINOIS  
DEPARTMENT OF TRANSPORTATION**

<b>IL 59 (DUPAGE CO LINE TO N OF PHEASANT CHASE DR) PROPOSED ROADWAY AND PAVEMENT MARKING PLANS</b>			
SCALE: 1"=50'	SHEET	OF SHEETS	STA. 13+21.7 TO STA. 31+00

F.A.P. RTE. 338	SECTION 2020-122-I	COUNTY WILL	TOTAL SHEETS 22	SHEET NO. 4
CONTRACT NO. 62M00			ILLINOIS FED. AID PROJECT	

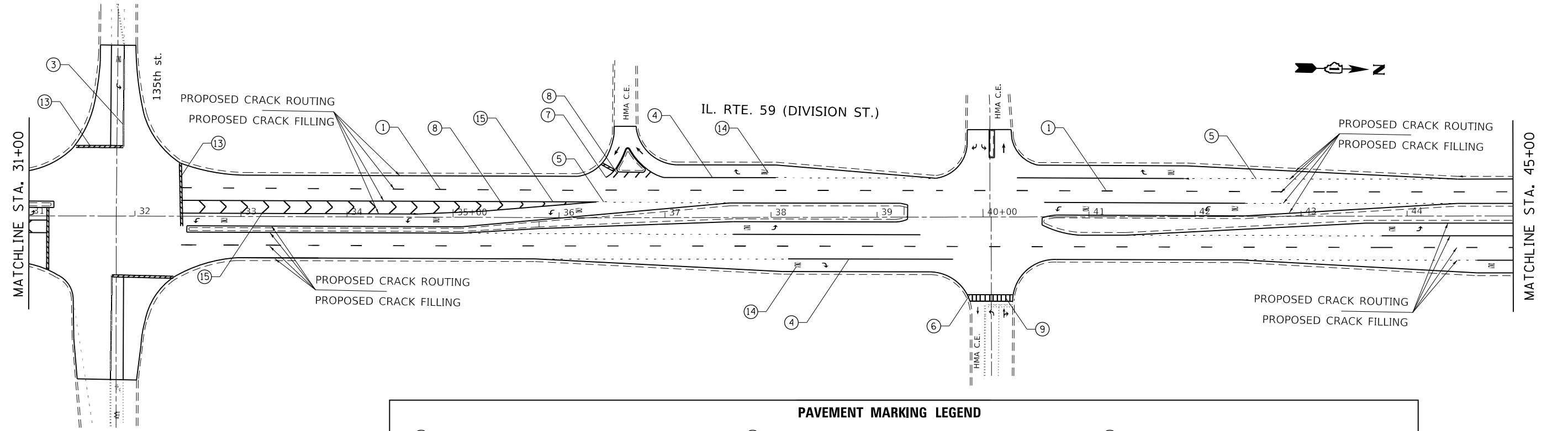

**PAVEMENT MARKING LEGEND**

<p>① PROP. MODIFIED URETHANE PAVEMENT MARKING LINE, 4" SKIP DASH WHITE LANE LINE @ 30' SKIP &amp; 10' DASH</p> <p>② PROP. MODIFIED URETHANE PAVEMENT MARKING LINE, 4" SOLID WHITE LINE</p> <p>③ PROP. MODIFIED URETHANE PAVEMENT MARKING LINE, 4" DOUBLE SOLID YELLOW LINE, 2 @ 11" C-C</p> <p>④ PROP. MODIFIED URETHANE PAVEMENT MARKING LINE, 6" SOLID WHITE TURN LANE</p> <p>⑤ PROP. MODIFIED URETHANE PAVEMENT MARKING LINE, 6" SKIP DASH WHITE TURN LANE @ 6' SKIP &amp; 2' DASH</p>	<p>⑥ PROP. MODIFIED URETHANE PAVEMENT MARKING LINE, 6" SOLID WHITE CROSSWALK LINE, 2 @ 6' C-C</p> <p>⑦ PROP. MODIFIED URETHANE PAVEMENT MARKING LINE, 8" SOLID WHITE GORE MARKING AND CHANNELIZING LINES</p> <p>⑧ PROP. MODIFIED URETHANE PAVEMENT MARKING LINE, 12" SOLID WHITE GORE MARKINGS @ 45 DEG.</p> <p>⑨ PROP. MODIFIED URETHANE PAVEMENT MARKING LINE, 12" SOLID WHITE LONGITUDINAL BAR @ 90°, 2' SPACING</p> <p>⑩ PROP. MODIFIED URETHANE PAVEMENT MARKING LINE, 12" SOLID WHITE LONGITUDINAL BAR @ 45°, 2' SPACING</p>	<p>⑪ PROP. MODIFIED URETHANE PAVEMENT MARKING LINE, 12" DIAGONAL SOLID YELLOW LINE @ 75' SPACING OR 5 MIN.</p> <p>⑫ PROP. MODIFIED URETHANE PAVEMENT MARKING LINE, 12" DIAGONAL SOLID WHITE LINE @ 75' SPACING OR 5 MIN.</p> <p>⑬ PROP. MODIFIED URETHANE PAVEMENT MARKING LETTERS &amp; SYMBOLS, SOLID WHITE</p> <p>⑭ PROP. MODIFIED URETHANE PAVEMENT MARKING LINE, 24" SOLID WHITE STOP BAR</p> <p>⑮ PROP. MODIFIED URETHANE PAVEMENT MARKING LINE, 6" SOLID WHITE GORE MARKING AND CHANNELIZING LINES</p>
---	--	---

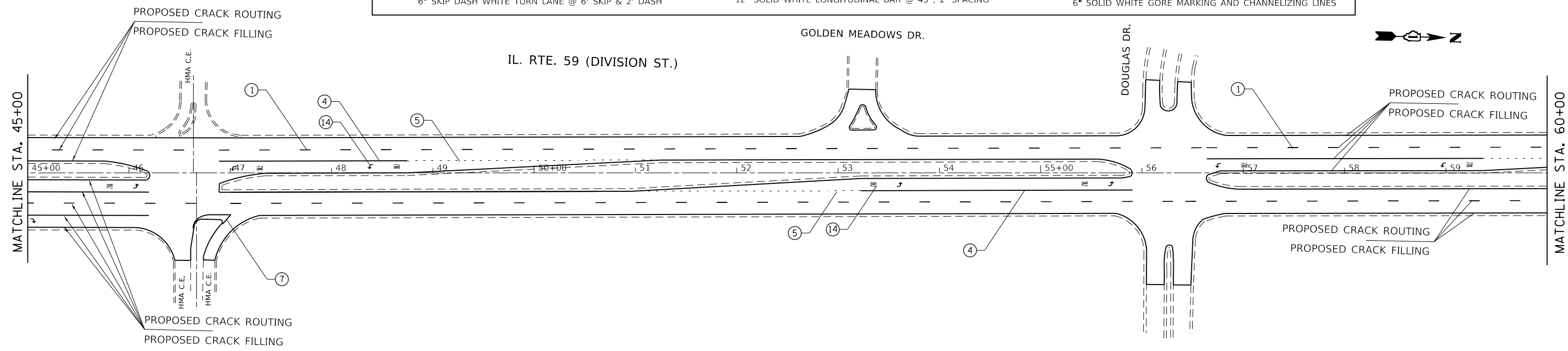

MODEL: Default  
 FILE: \\blm\c:\pub\blm\room\dat\illinois\pwr\WIDOT\Documents\DOT\_Offices\blm\1\Projects\152220\CaddData\Design\152220-01c-pblm.dgn

USER NAME = elkhatibaj	DESIGNED -	REVISED -
	DRAWN -	REVISED -
PLOT SCALE = 100,0000 ' / in.	CHECKED -	REVISED -
PLOT DATE = 8/14/2020	DATE -	REVISED -

**STATE OF ILLINOIS  
DEPARTMENT OF TRANSPORTATION**

<b>IL 59 (DUPAGE CO LINE TO N OF PHEASANT CHASE DR) PROPOSED ROADWAY AND PAVEMENT MARKING PLANS</b>	
SCALE: 1"=50'	SHEET OF SHEETS STA. 31+00 TO STA. 60+00

F.A.P. RTE. 338	SECTION 2020-122-1	COUNTY WILL	TOTAL SHEETS 22	SHEET NO. 5
CONTRACT NO. 62M00				
ILLINOIS FED. AID PROJECT				





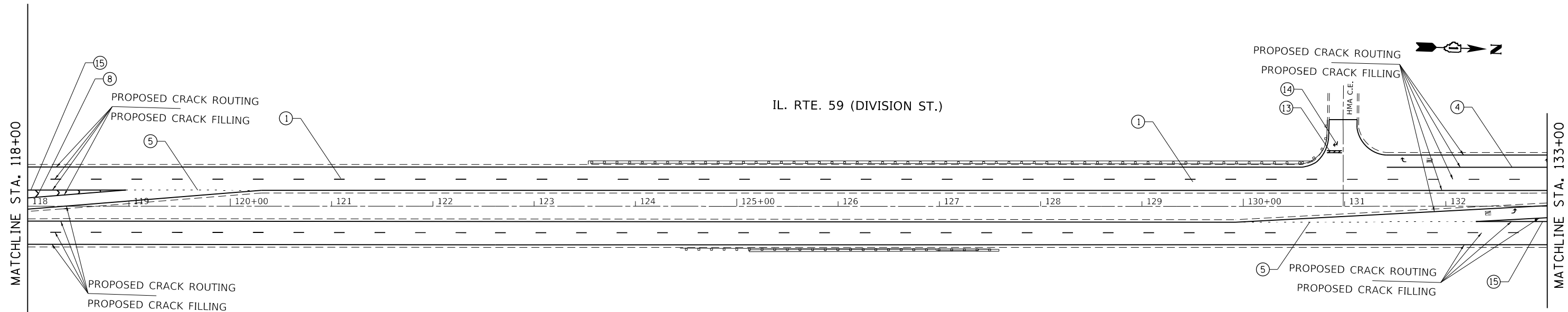

**PAVEMENT MARKING LEGEND**

<p>① PROP. MODIFIED URETHANE PAVEMENT MARKING LINE, 4" SKIP DASH WHITE LINE @ 30' SKIP &amp; 10' DASH</p> <p>② PROP. MODIFIED URETHANE PAVEMENT MARKING LINE, 4" SOLID WHITE LINE</p> <p>③ PROP. MODIFIED URETHANE PAVEMENT MARKING LINE, 4" DOUBLE SOLID YELLOW LINE, 2 @ 11" C-C</p> <p>④ PROP. MODIFIED URETHANE PAVEMENT MARKING LINE, 6" SOLID WHITE TURN LANE</p> <p>⑤ PROP. MODIFIED URETHANE PAVEMENT MARKING LINE, 6" SKIP DASH WHITE TURN LANE @ 6' SKIP &amp; 2' DASH</p>	<p>⑥ PROP. MODIFIED URETHANE PAVEMENT MARKING LINE, 6" SOLID WHITE CROSSWALK LINE, 2 @ 6' C-C</p> <p>⑦ PROP. MODIFIED URETHANE PAVEMENT MARKING LINE, 8" SOLID WHITE GORE MARKING AND CHANNELIZING LINES</p> <p>⑧ PROP. MODIFIED URETHANE PAVEMENT MARKING LINE, 12" SOLID WHITE GORE MARKINGS @ 45 DEG.</p> <p>⑨ PROP. MODIFIED URETHANE PAVEMENT MARKING LINE, 12" SOLID WHITE LONGITUDINAL BAR @ 90°, 2' SPACING</p> <p>⑩ PROP. MODIFIED URETHANE PAVEMENT MARKING LINE, 12" SOLID WHITE LONGITUDINAL BAR @ 45°, 2' SPACING</p>	<p>⑪ PROP. MODIFIED URETHANE PAVEMENT MARKING LINE, 12" DIAGONAL SOLID YELLOW LINE @ 75° SPACING OR 5 MIN.</p> <p>⑫ PROP. MODIFIED URETHANE PAVEMENT MARKING LINE, 12" DIAGONAL SOLID WHITE LINE @ 75° SPACING OR 5 MIN.</p> <p>⑬ PROP. MODIFIED URETHANE PAVEMENT MARKING LETTERS &amp; SYMBOLS, SOLID WHITE</p> <p>⑭ PROP. MODIFIED URETHANE PAVEMENT MARKING LINE, 24" SOLID WHITE STOP BAR</p> <p>⑮ PROP. MODIFIED URETHANE PAVEMENT MARKING LINE, 6" SOLID WHITE GORE MARKING AND CHANNELIZING LINES</p>
--	--	---

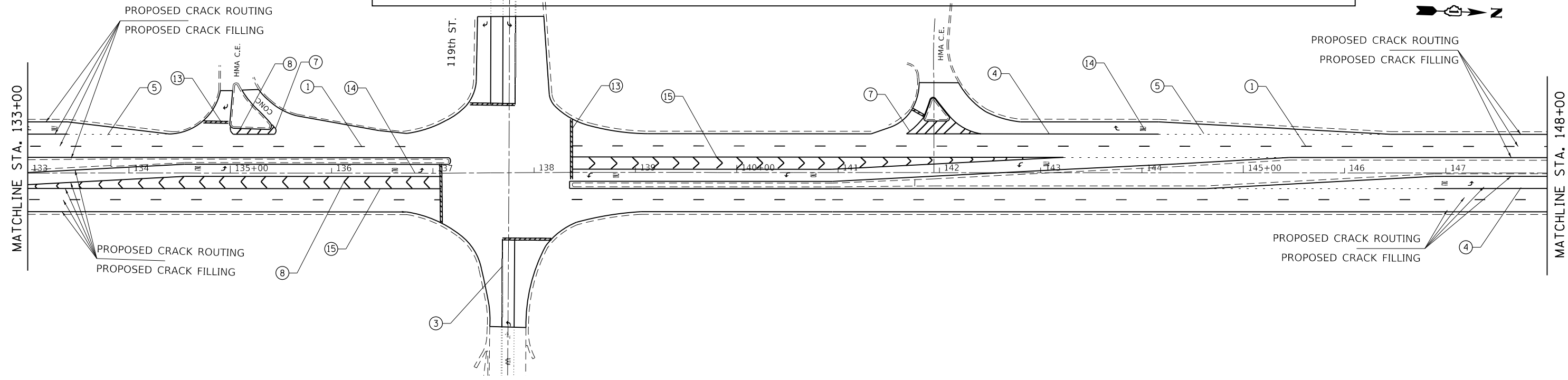

MODEL: Default  
 FILE: \\blm\c:\pub\baronm\dat\illinois\pwr\WIDOT\Documents\DOT\_Offices\Illinet\1\Projects\152720\CADD\Drawings\Design\152720-01c-pav.mxd

USER NAME = elkhatibaj	DESIGNED -	REVISED -
PLOT SCALE = 100,0000' / in.	DRAWN -	REVISED -
PLOT DATE = 8/14/2020	CHECKED -	REVISED -
	DATE -	REVISED -

**STATE OF ILLINOIS  
DEPARTMENT OF TRANSPORTATION**

<b>IL 59 (DUPAGE CO LINE TO N OF PHEASANT CHASE DR) PROPOSED ROADWAY AND PAVEMENT MARKING PLANS</b>	
SCALE: 1"=50'	SHEET OF SHEETS STA. 118+00 TO STA. 148+00

F.A.P. RTE. 338	SECTION 2020-122-I	COUNTY WILL	TOTAL SHEETS 22	SHEET NO. 8
CONTRACT NO. 62M00				
ILLINOIS FED. AID PROJECT				



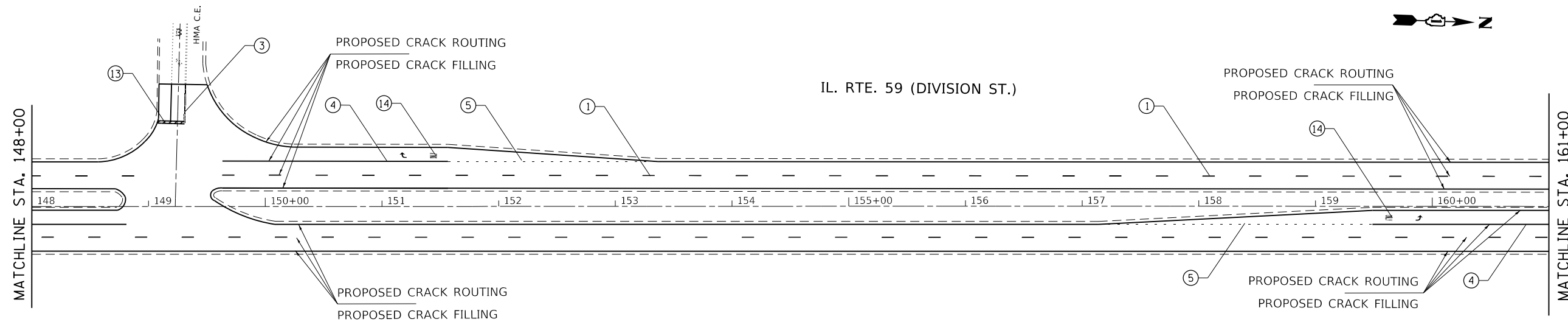

**PAVEMENT MARKING LEGEND**

<p>① PROP. MODIFIED URETHANE PAVEMENT MARKING LINE, 4" SKIP DASH WHITE LANE LINE @ 30' SKIP &amp; 10' DASH</p> <p>② PROP. MODIFIED URETHANE PAVEMENT MARKING LINE, 4" SOLID WHITE LINE</p> <p>③ PROP. MODIFIED URETHANE PAVEMENT MARKING LINE, 4" DOUBLE SOLID YELLOW LINE, 2 @ 11" C-C</p> <p>④ PROP. MODIFIED URETHANE PAVEMENT MARKING LINE, 6" SOLID WHITE TURN LANE</p> <p>⑤ PROP. MODIFIED URETHANE PAVEMENT MARKING LINE, 6" SKIP DASH WHITE TURN LANE @ 6' SKIP &amp; 2' DASH</p>	<p>⑥ PROP. MODIFIED URETHANE PAVEMENT MARKING LINE, 6" SOLID WHITE CROSSWALK LINE, 2 @ 6' C-C</p> <p>⑦ PROP. MODIFIED URETHANE PAVEMENT MARKING LINE, 8" SOLID WHITE GORE MARKING AND CHANNELIZING LINES</p> <p>⑧ PROP. MODIFIED URETHANE PAVEMENT MARKING LINE, 12" SOLID WHITE GORE MARKINGS @ 45 DEG.</p> <p>⑨ PROP. MODIFIED URETHANE PAVEMENT MARKING LINE, 12" SOLID WHITE LONGITUDINAL BAR @ 90°, 2' SPACING</p> <p>⑩ PROP. MODIFIED URETHANE PAVEMENT MARKING LINE, 12" SOLID WHITE LONGITUDINAL BAR @ 45°, 2' SPACING</p>	<p>⑪ PROP. MODIFIED URETHANE PAVEMENT MARKING LINE, 12" DIAGONAL SOLID YELLOW LINE @ 75' SPACING OR 5 MIN.</p> <p>⑫ PROP. MODIFIED URETHANE PAVEMENT MARKING LINE, 12" DIAGONAL SOLID WHITE LINE @ 75' SPACING OR 5 MIN.</p> <p>⑬ PROP. MODIFIED URETHANE PAVEMENT MARKING LETTERS &amp; SYMBOLS, SOLID WHITE</p> <p>⑭ PROP. MODIFIED URETHANE PAVEMENT MARKING LINE, 24" SOLID WHITE STOP BAR</p> <p>⑮ PROP. MODIFIED URETHANE PAVEMENT MARKING LINE, 6" SOLID WHITE GORE MARKING AND CHANNELIZING LINES</p>
---	--	---

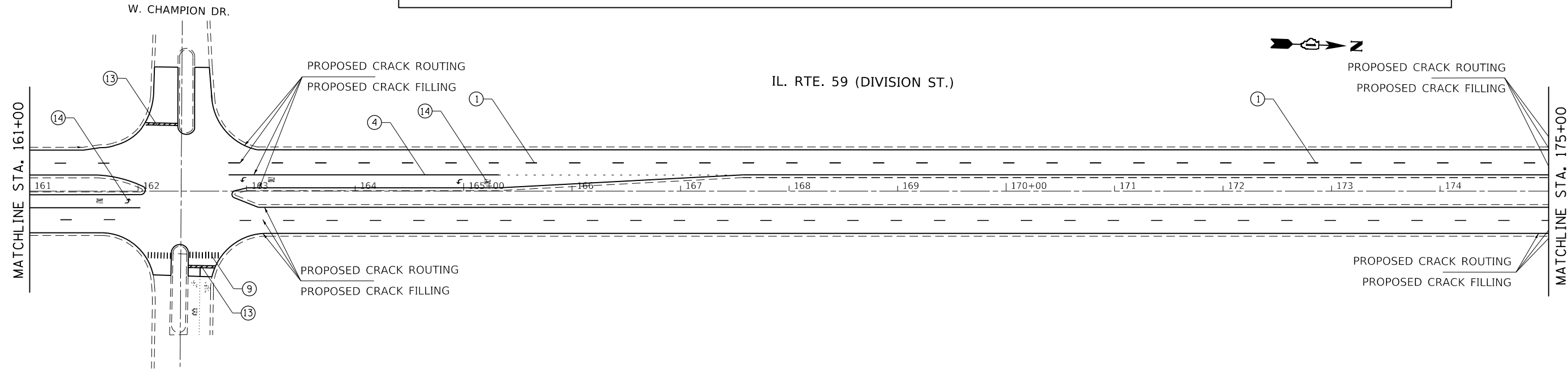

MODEL: Default  
 FILE: h:\a\c\p\pub\h\room\dat\illinois.gov\p\w\dot\Documents\DOT\_Offices\Illin\dot\1\Projects\152220\Cadd\Drawn\Design\152220-01-01-01.dgn

USER NAME = elkhatabaj	DESIGNED -	REVISED -
PLOT SCALE = 100,0000' / in.	DRAWN -	REVISED -
PLOT DATE = 8/14/2020	CHECKED -	REVISED -
	DATE -	REVISED -

**STATE OF ILLINOIS  
DEPARTMENT OF TRANSPORTATION**

<b>IL 59 (DUPAGE CO LINE TO N OF PHEASANT CHASE DR) PROPOSED ROADWAY AND PAVEMENT MARKING PLANS</b>			
SCALE: 1"=50'	SHEET	OF	SHEETS
	STA. 148+00	TO	STA. 175+00

F.A.P. RTE.	SECTION	COUNTY	TOTAL SHEETS	SHEET NO.
338	2020-122-I	WILL	22	9
CONTRACT NO. 62M00				
ILLINOIS FED. AID PROJECT				



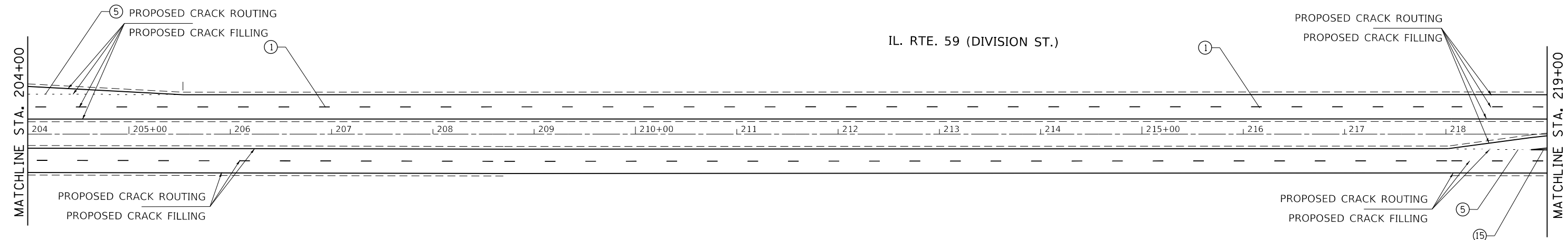

**PAVEMENT MARKING LEGEND**

<p>① PROP. MODIFIED URETHANE PAVEMENT MARKING LINE, 4" SKIP DASH WHITE LANE LINE @ 30' SKIP &amp; 10' DASH</p> <p>② PROP. MODIFIED URETHANE PAVEMENT MARKING LINE, 4" SOLID WHITE LINE</p> <p>③ PROP. MODIFIED URETHANE PAVEMENT MARKING LINE, 4" DOUBLE SOLID YELLOW LINE, 2 @ 11" C-C</p> <p>④ PROP. MODIFIED URETHANE PAVEMENT MARKING LINE, 6" SOLID WHITE TURN LANE</p> <p>⑤ PROP. MODIFIED URETHANE PAVEMENT MARKING LINE, 6" SKIP DASH WHITE TURN LANE @ 6' SKIP &amp; 2' DASH</p>	<p>⑥ PROP. MODIFIED URETHANE PAVEMENT MARKING LINE, 6" SOLID WHITE CROSSWALK LINE, 2 @ 6' C-C</p> <p>⑦ PROP. MODIFIED URETHANE PAVEMENT MARKING LINE, 8" SOLID WHITE GORE MARKING AND CHANNELIZING LINES</p> <p>⑧ PROP. MODIFIED URETHANE PAVEMENT MARKING LINE, 12" SOLID WHITE GORE MARKINGS @ 45 DEG.</p> <p>⑨ PROP. MODIFIED URETHANE PAVEMENT MARKING LINE, 12" SOLID WHITE LONGITUDINAL BAR @ 90°, 2' SPACING</p> <p>⑩ PROP. MODIFIED URETHANE PAVEMENT MARKING LINE, 12" SOLID WHITE LONGITUDINAL BAR @ 45°, 2' SPACING</p>	<p>⑪ PROP. MODIFIED URETHANE PAVEMENT MARKING LINE, 12" DIAGONAL SOLID YELLOW LINE @ 75' SPACING OR 5 MIN.</p> <p>⑫ PROP. MODIFIED URETHANE PAVEMENT MARKING LINE, 12" DIAGONAL SOLID WHITE LINE @ 75' SPACING OR 5 MIN.</p> <p>⑬ PROP. MODIFIED URETHANE PAVEMENT MARKING LETTERS &amp; SYMBOLS, SOLID WHITE</p> <p>⑭ PROP. MODIFIED URETHANE PAVEMENT MARKING LINE, 24" SOLID WHITE STOP BAR</p> <p>⑮ PROP. MODIFIED URETHANE PAVEMENT MARKING LINE, 6" SOLID WHITE GORE MARKING AND CHANNELIZING LINES</p>
---	--	---

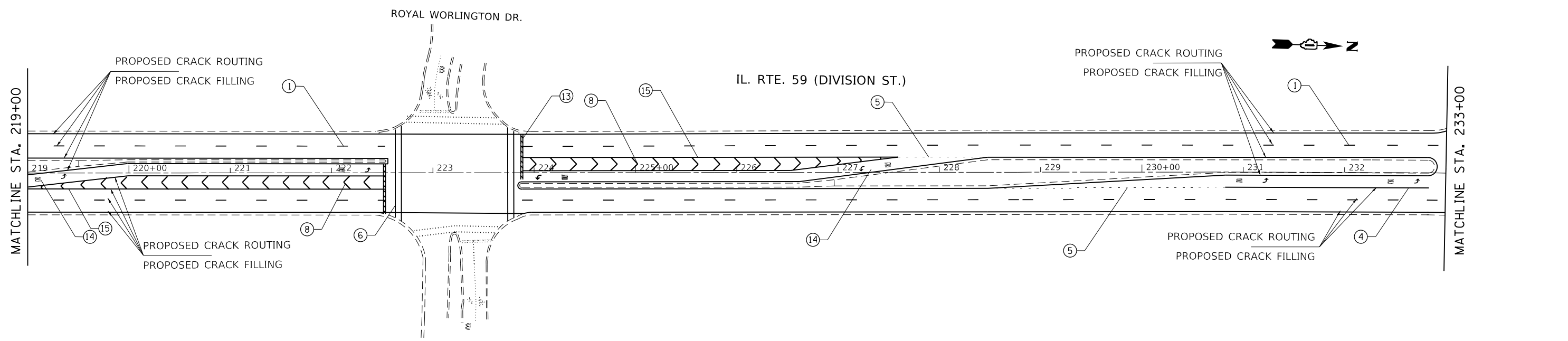

MODEL: Default  
 FILE: \\harc...  
 PROJECT: 152220\CaddData\Design\152220-01-01-01.dgn

USER NAME = elkhatibaj	DESIGNED -	REVISED -
PLOT SCALE = 100,0000' / in.	DRAWN -	REVISED -
PLOT DATE = 8/14/2020	CHECKED -	REVISED -
	DATE -	REVISED -

**STATE OF ILLINOIS**  
**DEPARTMENT OF TRANSPORTATION**

**IL 59 (DUPAGE CO LINE TO N OF PHEASANT CHASE DR)**  
**PROPOSED ROADWAY AND PAVEMENT MARKING PLANS**

SCALE: 1"=50'    SHEET    OF    SHEETS    STA. 204+00    TO STA. 233+00

F.A.P. RTE.	SECTION	COUNTY	TOTAL SHEETS	SHEET NO.
338	2020-122-I	WILL	22	11
CONTRACT NO. 62M00				
ILLINOIS FED. AID PROJECT				









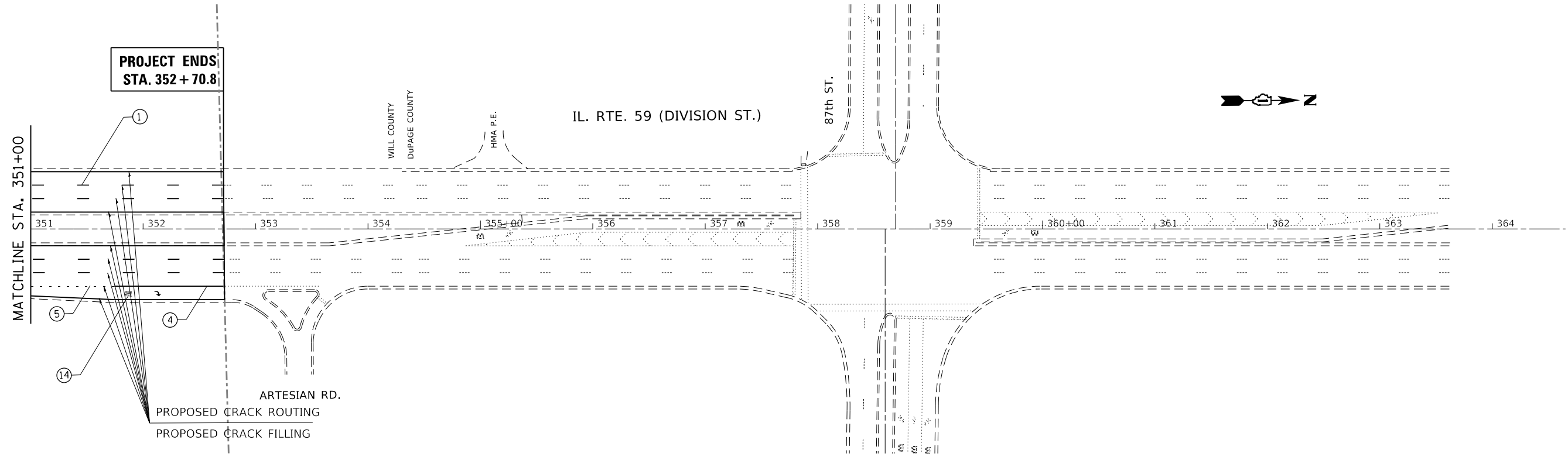

PAVEMENT MARKING LEGEND			
①	PROP. MODIFIED URETHANE PAVEMENT MARKING LINE, 4" SKIP DASH WHITE LANE LINE @ 30' SKIP & 10' DASH	⑪	PROP. MODIFIED URETHANE PAVEMENT MARKING LINE, 12" DIAGONAL SOLID YELLOW LINE @ 75' SPACING OR 5 MIN.
②	PROP. MODIFIED URETHANE PAVEMENT MARKING LINE, 4" SOLID WHITE LINE	⑫	PROP. MODIFIED URETHANE PAVEMENT MARKING LINE, 12" DIAGONAL SOLID WHITE LINE @ 75' SPACING OR 5 MIN.
③	PROP. MODIFIED URETHANE PAVEMENT MARKING LINE, 4" DOUBLE SOLID YELLOW LINE, 2 @ 11" C-C	⑬	PROP. MODIFIED URETHANE PAVEMENT MARKING LETTERS & SYMBOLS, SOLID WHITE
④	PROP. MODIFIED URETHANE PAVEMENT MARKING LINE, 6" SOLID WHITE TURN LANE	⑭	PROP. MODIFIED URETHANE PAVEMENT MARKING LINE, 24" SOLID WHITE STOP BAR
⑤	PROP. MODIFIED URETHANE PAVEMENT MARKING LINE, 6" SKIP DASH WHITE TURN LANE @ 6' SKIP & 2' DASH	⑮	PROP. MODIFIED URETHANE PAVEMENT MARKING LINE, 6" SOLID WHITE GORE MARKING AND CHANNELIZING LINES
⑥	PROP. MODIFIED URETHANE PAVEMENT MARKING LINE, 6" SOLID WHITE CROSSWALK LINE, 2 @ 6' C-C		
⑦	PROP. MODIFIED URETHANE PAVEMENT MARKING LINE, 8" SOLID WHITE GORE MARKING AND CHANNELIZING LINES		
⑧	PROP. MODIFIED URETHANE PAVEMENT MARKING LINE, 12" SOLID WHITE GORE MARKINGS @ 45 DEG.		
⑨	PROP. MODIFIED URETHANE PAVEMENT MARKING LINE, 12" SOLID WHITE LONGITUDINAL BAR @ 90°, 2' SPACING		
⑩	PROP. MODIFIED URETHANE PAVEMENT MARKING LINE, 12" SOLID WHITE LONGITUDINAL BAR @ 45°, 2' SPACING		

MODEL: Default  
 FILE: \\nlsdot-pub\pubroom\dat\illinois.gov\PWIDOT\Documents\DOT\_Offices\District\_1\Projects\152220\CaddData\Design\152220-ct-pub-bk.dgn

USER NAME = elkhatabaj	DESIGNED -	REVISED -
	DRAWN -	REVISED -
PLOT SCALE = 100,0000' / in.	CHECKED -	REVISED -
PLOT DATE = 8/14/2020	DATE -	REVISED -

**STATE OF ILLINOIS**  
**DEPARTMENT OF TRANSPORTATION**

<b>IL 59 (DUPAGE CO LINE TO N OF PHEASANT CHASE DR)</b> <b>PROPOSED ROADWAY AND PAVEMENT MARKING PLANS</b>			
SCALE: 1"=50'	SHEET	OF	SHEETS
	STA. 351+00		TO STA. 354+30.1

F.A.P. RTE.	SECTION	COUNTY	TOTAL SHEETS	SHEET NO.
338	2020-122-1	WILL	22	16
CONTRACT NO. 62M00				
ILLINOIS FED. AID PROJECT				



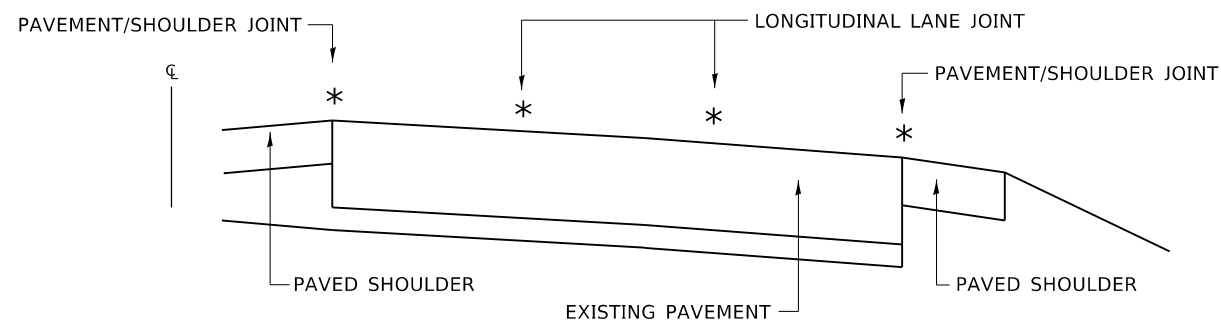

**MULTI-LANE DIVIDED PAVEMENT**

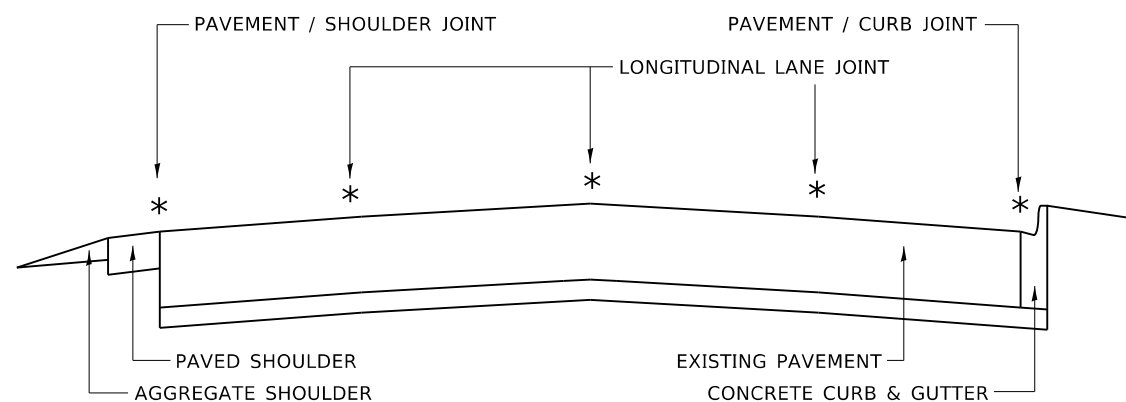

**MULTI-LANE UNDIVIDED PAVEMENT**

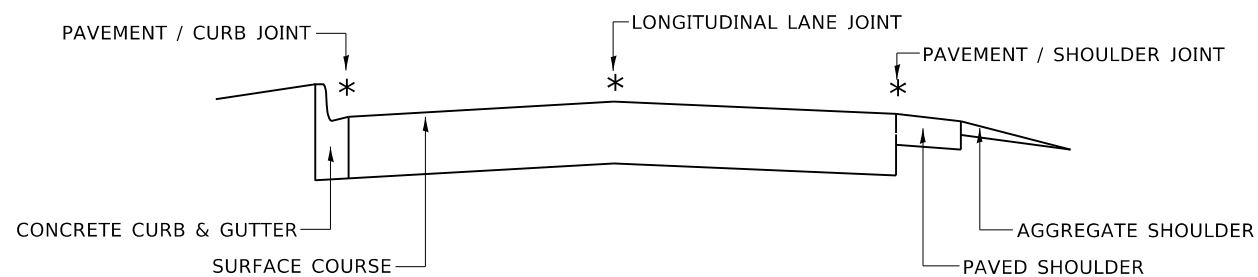

**TWO-LANE PAVEMENT**

\* PROPOSED LONGITUDINAL CRACK ROUTING (PAVEMENT) & CRACK FILLING LOCATIONS

**GENERAL EXISTING TYPICAL SECTIONS  
(APPLIES TO HMA AND PCC PAVEMENTS)**

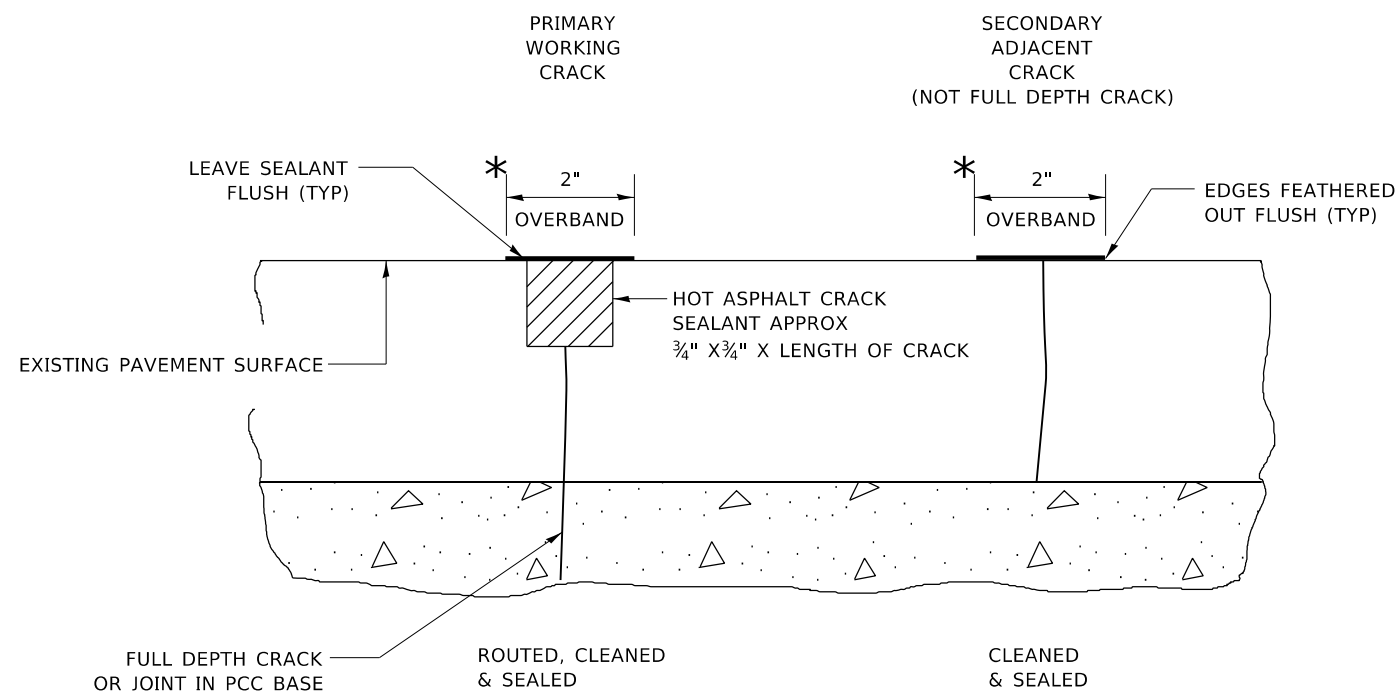

\* IN ALL LOCATIONS WHERE THE LONGITUDINAL CRACK CONFLICTS WITH EXISTING PAVEMENT MARKINGS (EITHER EDGE LINE OR LANE LINE) THE CRACK SHALL BE ROUTED & THE RESULTING RESERVOIR FILLED WITH SEALANT. ALL DAMAGES TO EXISTING RAISED REFLECTIVE PAVEMENT MARKERS SHALL BE REPLACED AT THE EXPENSE OF THE CONTRACTOR. ALL EXISTING PAVEMENT MARKINGS WITHIN THE PROJECT LIMITS SHALL BE RESTORED WITH MODIFIED URETHANE PAVEMENT MARKINGS.

**LONGITUDINAL JOINT**

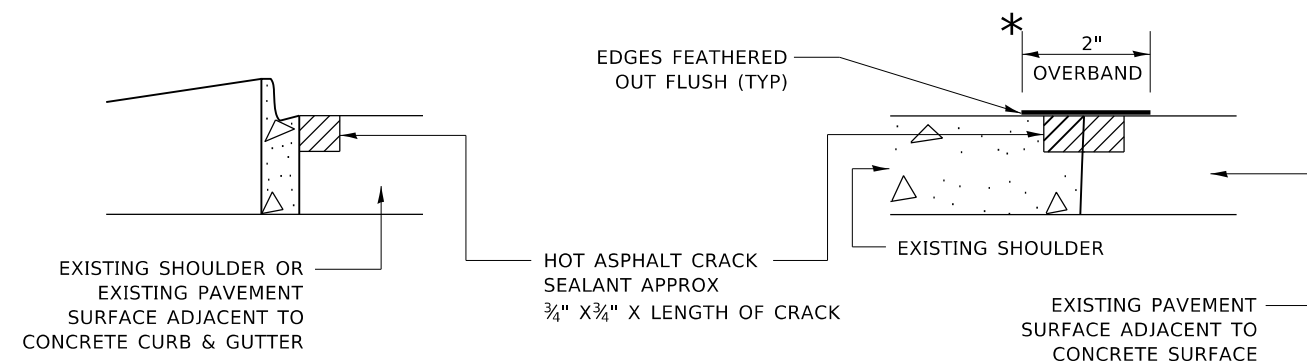

**CRACK & JOINT SEALING DETAIL**

MODEL: Default  
FILE: h:\mhc\p\dupage\room\dat\illinois\pcc\p\w\dot\Documents\DOT\_Offices\Drawings\1\Projects\IL59\2020-122-1\CADD\Drawings\CAD\sheet33d11.dwg

USER NAME = leysa	DESIGNED - F. Aqueel / A. Midy	REVISED -
PLOT SCALE = 100,0000' / in.	CHECKED -	REVISED -
PLOT DATE = 10/7/2020	DATE - 10/08/2020	REVISED -

**STATE OF ILLINOIS  
DEPARTMENT OF TRANSPORTATION**

**CRACK & JOINT SEALING DETAIL (PD-11)  
IL 59 (DUPAGE CO LINE TO N OF PHEASANT CHASE DRIVE)**

SCALE: SHEET OF SHEETS STA. TO STA.

F.A.P. RTE.	SECTION	COUNTY	TOTAL SHEETS	SHEET NO.
338	2020-122-1	WILL	22	17
CONTRACT NO. 62M00				
ILLINOIS FED. AID PROJECT				



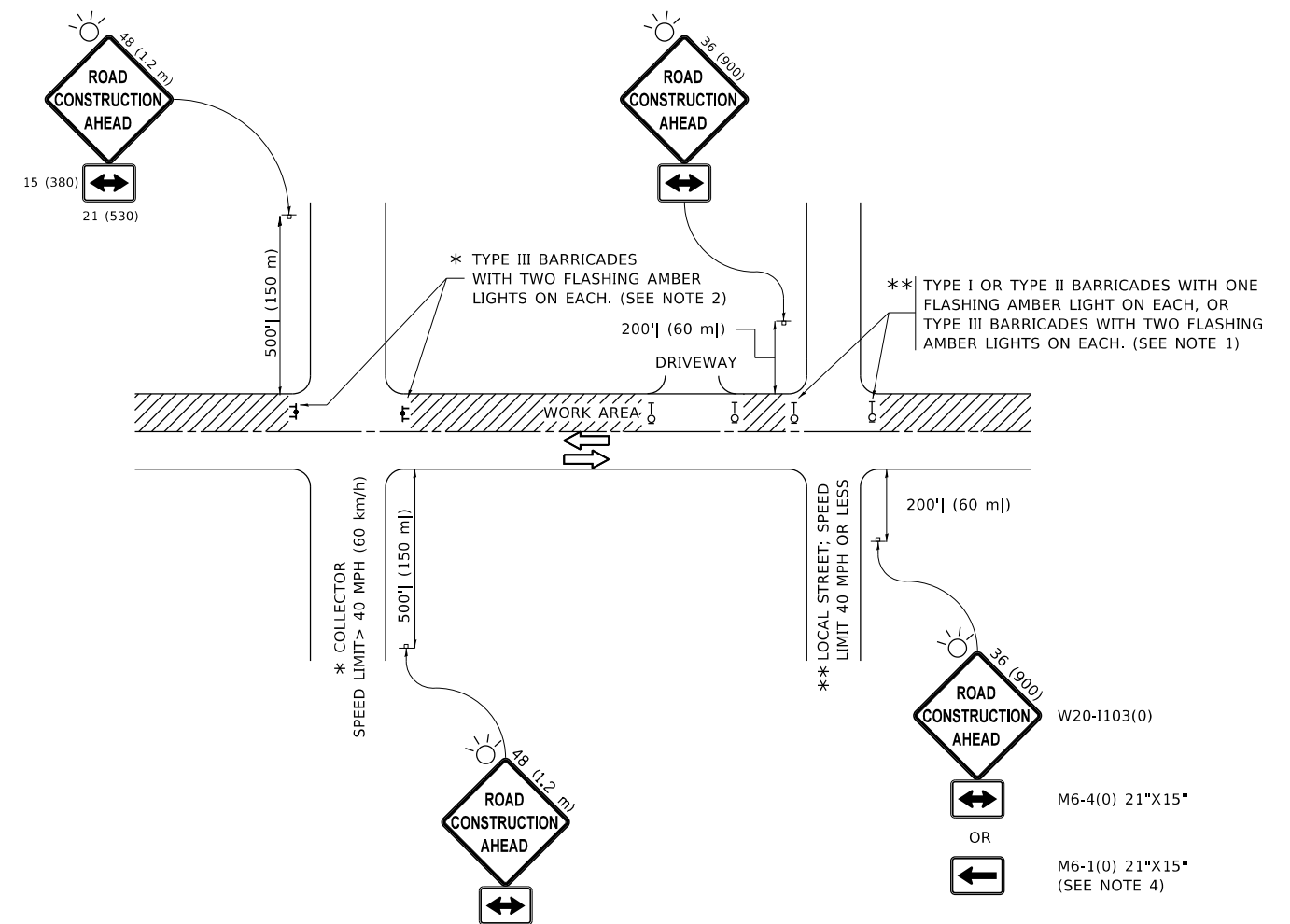

**NOTES:**

1. SIDE ROAD WITH A SPEED LIMIT OF 40 MPH (60 km/h) OR LESS AS SHOWN ON THE DRAWING AND AS DIRECTED BY THE ENGINEER:
  - a) ONE "ROAD CONSTRUCTION AHEAD" SIGN 36 x 36 (900x900) WITH A FLASHER MOUNTED ON IT APPROXIMATELY 200' (60 m) IN ADVANCE OF THE MAIN ROUTE.
  - b) THE CLOSED PORTION OF THE MAIN ROUTE SHALL BE PROTECTED BY BLOCKING WITH TYPE I, TYPE II OR TYPE III BARRICADES, 1/3 OF THE CROSS SECTION OF THE CLOSED PORTION.
2. SIDE ROAD WITH A SPEED LIMIT GREATER THAN 40 MPH (60 km/h) AS SHOWN ON THE DRAWING AND AS DIRECTED BY THE ENGINEER:
  - a) ONE "ROAD CONSTRUCTION AHEAD" SIGN 48 x 48 (1.2 m x 1.2 m) WITH A FLASHER MOUNTED ON IT APPROXIMATELY 500' (150 m) IN ADVANCE OF THE MAIN ROUTE.
  - b) BLOCKING WITH TYPE III BARRICADES, 1/2 OF THE CROSS SECTION OF THE CLOSED PORTION.
3. CONES MAY BE SUBSTITUTED FOR BARRICADES OR DRUMS AT HALF THE SPACING DURING DAY OPERATIONS. CONES SHALL BE A MINIMUM OF 28 (710) IN HEIGHT.
4. SIGNING AND THE WORK ZONE, A SINGLE HEADED ARROW (M6-1) SHALL BE USED IN LIEU OF THE DOUBLE HEADED ARROW (M6-4).
5. WHEN WORK IS BEING PERFORMED ON A SIDE ROAD OR DRIVEWAY, FOLLOW THE APPLICABLE STANDARD(S). THE DIRECTIONAL ARROW (M6-1 OR M6-4) SHALL BE COVERED OR REMOVED WHEN NO LONGER CONSISTENT WITH THE TRAFFIC CONTROL SET-UP.
6. ADVANCE WARNING SIGNS ARE TO BE OMITTED ON DRIVEWAYS UNLESS OTHERWISE SPECIFIED IN THE PLANS OR BY THE ENGINEER.
7. THE TRAFFIC CONTROL AND PROTECTION FOR SIDE ROADS, INTERSECTIONS, AND DRIVEWAYS SHALL BE INCLUDED IN THE COST OF SPECIFIED TRAFFIC CONTROL STANDARDS OR ITEMS.

All dimensions are in inches (millimeters) unless otherwise shown.

MODEL: Default  
 FILE: \\nashville-prod\planroom\dat\illinois.gov\PWIDOT\Documents\DOT\_Offices\Director\_1\Projects\152720\CADD\Drawings\Design\DESIGN.dgn

USER NAME = elkhatibaj	DESIGNED - L.H.A.	REVISED - A. HOUSEH 10-15-96
	DRAWN -	REVISED - T. RAMMACHER 01-06-00
PLOT SCALE = 100.0000' / in.	CHECKED -	REVISED - A. SCHUETZE 07-01-13
PLOT DATE = 8/14/2020	DATE - 06-89	REVISED - A. SCHUETZE 09-15-16

**STATE OF ILLINOIS  
DEPARTMENT OF TRANSPORTATION**

**TRAFFIC CONTROL AND PROTECTION FOR  
SIDE ROADS, INTERSECTIONS, AND DRIVEWAYS**

SCALE: NONE SHEET 1 OF 1 SHEETS STA. TO STA.

F.A.P. RTE.	SECTION	COUNTY	TOTAL SHEETS	SHEET NO.
338	2020-122-I	WILL	22	19
<b>TC-10</b>			CONTRACT NO. 62M00	
ILLINOIS FED. AID PROJECT				





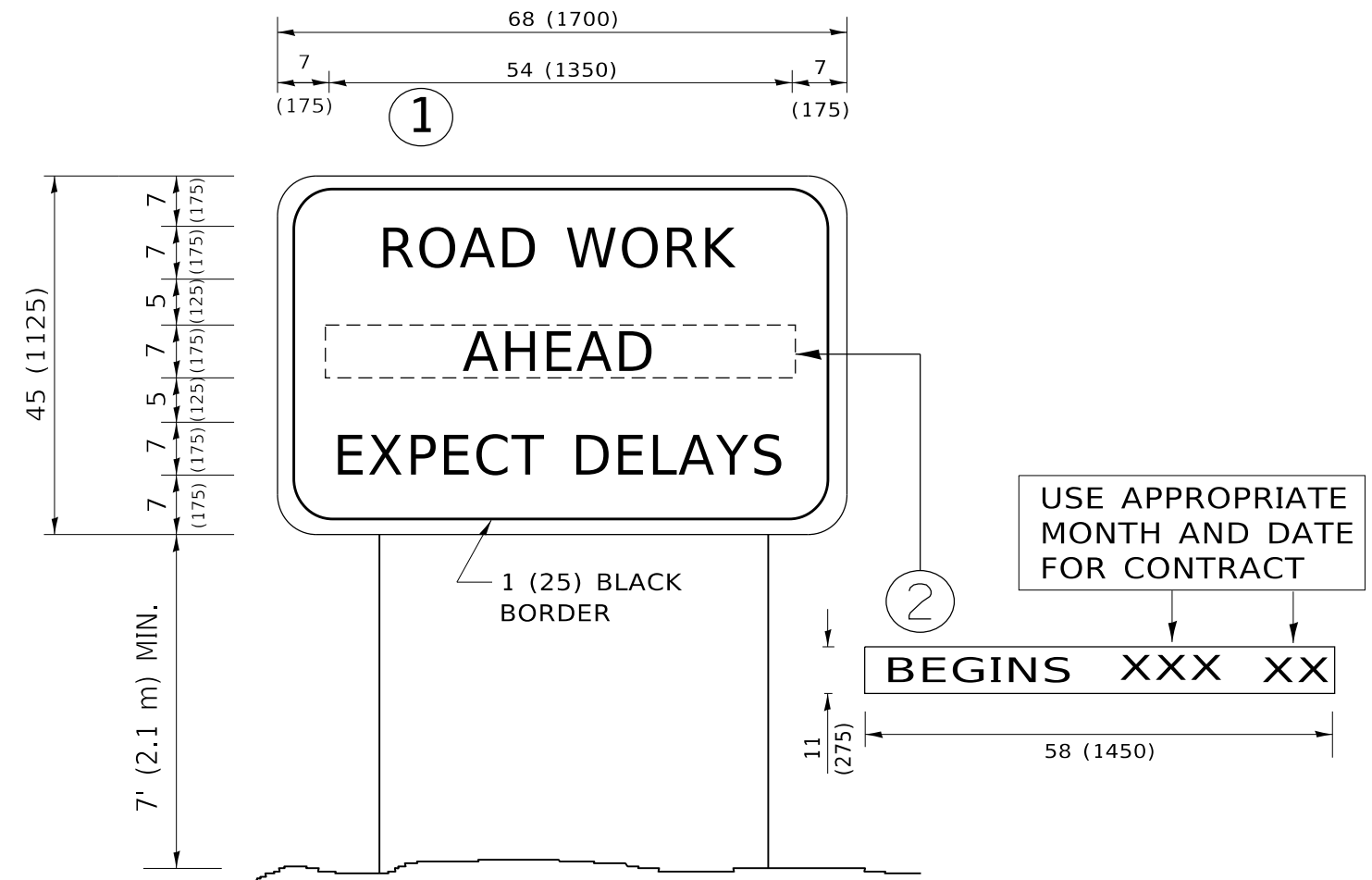

**NOTES:**

1. USE BLACK LETTERING ON ORANGE BACKGROUND.
2. ERECT SIGNS IN ADVANCE OF THE LOCATION FOR THE "ROAD CONSTRUCTION AHEAD" SIGN AT LOCATIONS AS DIRECTED BY THE ENGINEER.
3. ERECT SIGN ① WITH INSTALLED PANEL ② ONE WEEK PRIOR TO THE START OF CONSTRUCTION.
4. REMOVE PANEL ② SOON AFTER THE START OF CONSTRUCTION.
5. SEE SPECIAL PROVISION FOR "TEMPORARY INFORMATION SIGNING" FOR ADDITIONAL INFORMATION.
6. ONE SIGN ASSEMBLY EQUALS 25.70 SQ. FT. (2.3 SQ. M.)
7. SHALL BE PAID FOR AS TEMPORARY INFORMATION SIGNING.

ALL DIMENSIONS ARE IN INCHES (MILLIMETERS) UNLESS OTHERWISE SHOWN.

MODEL: Default  
 FILE: \\harris-pc\pub\harris\mtda\illinois.gov\PWIDOT\Documents\DOT\_Offices\Dir\etec\_1\Projects\152720\CADD\Drawings\Design\DRS4.dgn

USER NAME = elkhatabaj	DESIGNED -	REVISED - R. MIRS 09-15-97
	DRAWN -	REVISED - R. MIRS 12-11-97
PLOT SCALE = 100.0000 ' / in.	CHECKED -	REVISED - T. RAMMACHER 02-02-99
PLOT DATE = 8/14/2020	DATE -	REVISED - C. JUCIUS 01-31-07

**STATE OF ILLINOIS  
DEPARTMENT OF TRANSPORTATION**

**ARTERIAL ROAD  
INFORMATION SIGN**

SCALE: NONE SHEET 1 OF 1 SHEETS STA. TO STA.

F.A.P. RTE.	SECTION	COUNTY	TOTAL SHEETS	SHEET NO.
338	2020-122-I	WILL	22	22
<b>TC-22</b>			CONTRACT NO. 62M00	
ILLINOIS FED. AID PROJECT				