

F.A.I.	SECTION	COUNTY	TOTAL SHEETS	SHEET NO.
94/90	2005-0331	COOK	37	13
STA.		TO STA.		
FED. ROAD DIST. NO.		ILLINOIS	FED. AID PROJECT	
60A04				

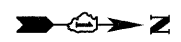

LEGEND:  
 LINEAR REMOVALS

EXISTING CONDITIONS AND REMOVAL  
 PROPOSED IMPROVEMENTS

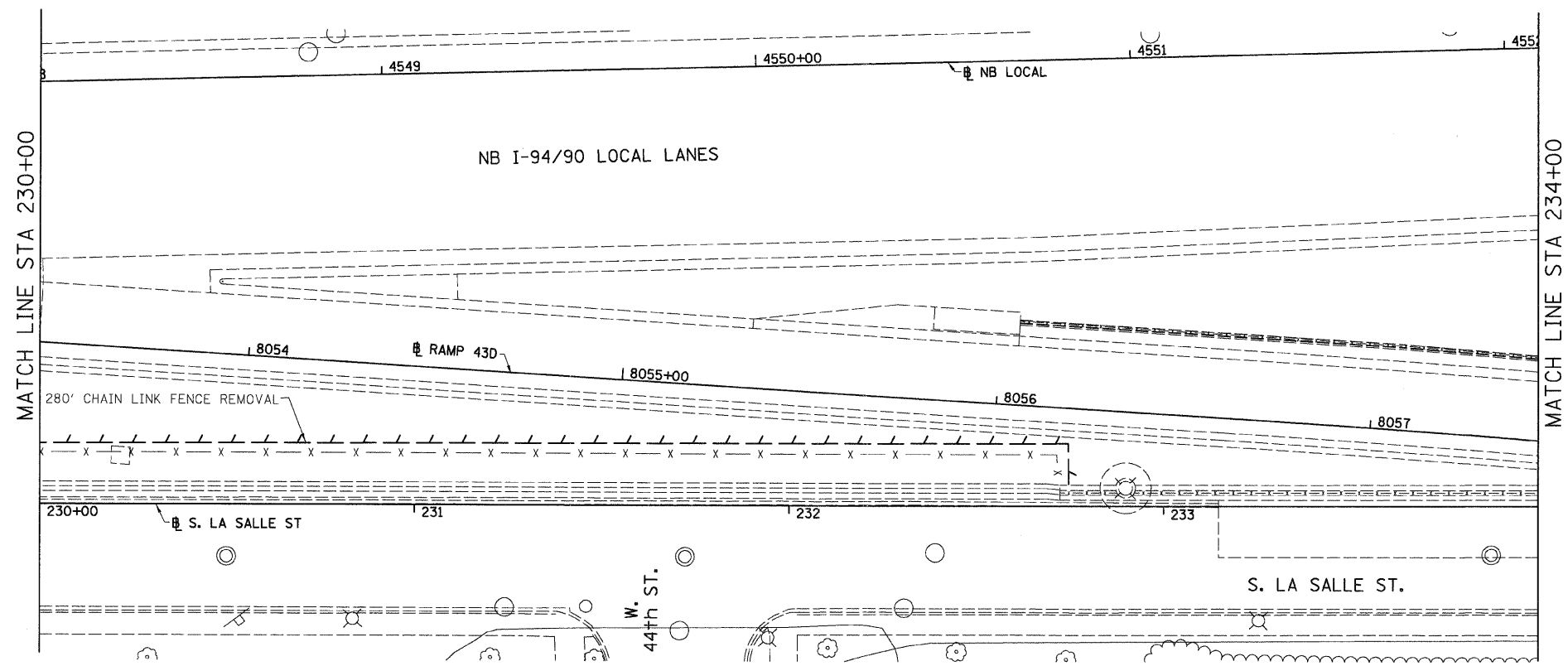
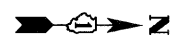
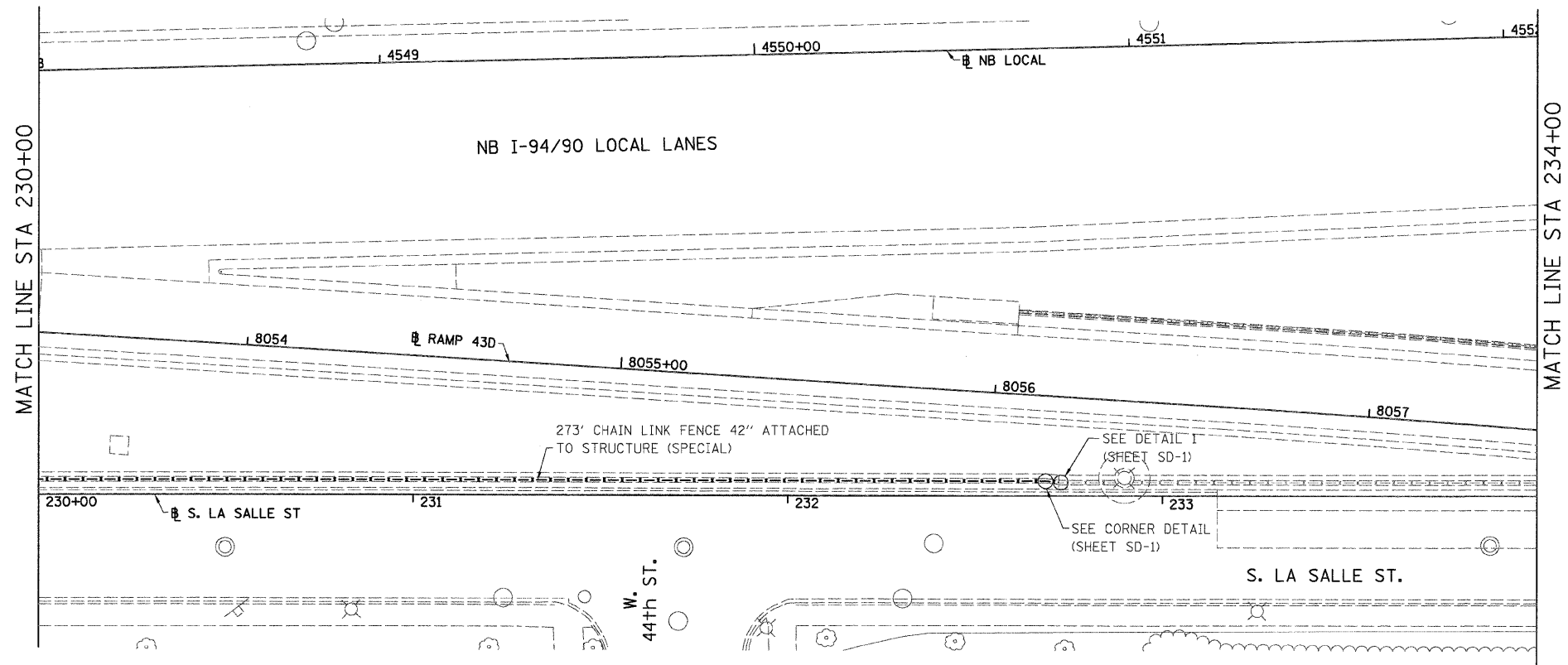

NOTES:  
 1. SEE DETAIL FOR CHAIN LINK FENCE, 42" ATTACHED TO STRUCTURE (SPECIAL).

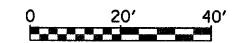

REVISIONS	NAME	DATE
1	REVISED	11/5/08

ILLINOIS DEPARTMENT OF TRANSPORTATION  
 F.A.I. 94/90 (DAN RYAN EXPRESSWAY)  
 NORTHBOUND FENCE AND GATES (47TH ST TO 31ST ST)  
**EXISTING AND PROPOSED  
 FENCE PLANS**  
 SCALE: DATE: 10/23/08  
 DRAWN BY: JDC  
 CHECKED BY: DDM

BOWMAN, BARRETT & ASSOCIATES INC.  
 CONSULTING ENGINEERS  
 Chicago, Illinois  
 312.228.0100  
 www.bbainc.com

11/5/2008 5:17:16 PM