

STATE OF ILLINOIS
DEPARTMENT OF TRANSPORTATION

ROUTE NO.	SECTION	COUNTY	TOTAL SHEETS	SHEET NO.
F.A.P. 389	2424.2 B-1	COOK	23	20
FED. ROAD DIST. NO. 7	ILLINOIS	FED. AID PROJECT-		

Contract No. 60E11

REVISIONS
Relocation of Light poles G.M.A. 3-9-52
Fence added to the Contract G.M.A. 5-13-52
Light pole supports changed to the Contract only G.M.A. 5-13-52

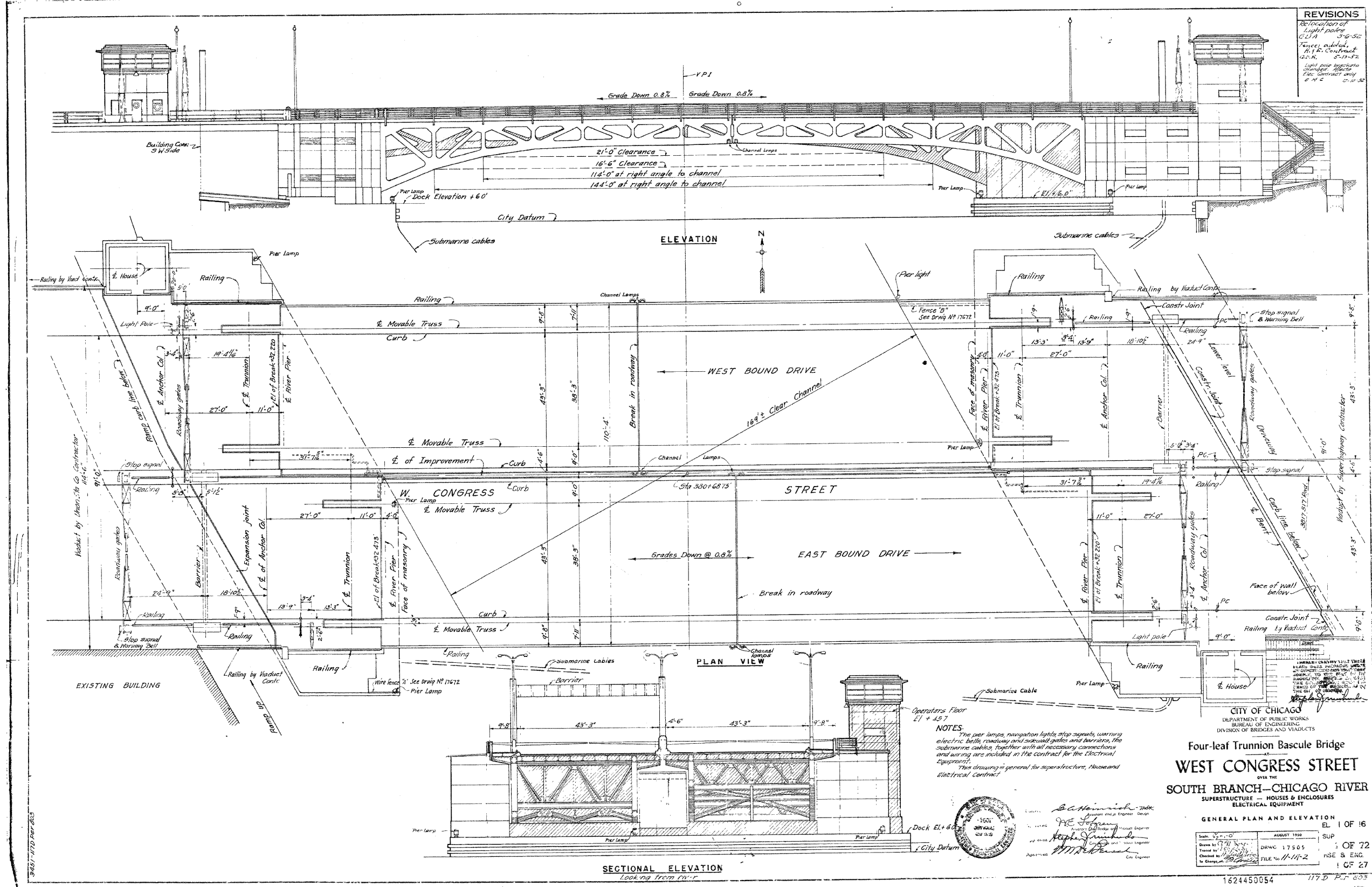

NOTES:
The per lamps, navigation lights, stop signals, warning electric bells, roadway and sidewalk gates and barriers, the submarine cables, together with all necessary connections and wiring are included in the contract for the Electrical Equipment.
This drawing is general for superstructure, Houses and Electrical Contract.

CITY OF CHICAGO
DEPARTMENT OF PUBLIC WORKS
BUREAU OF ENGINEERING
DIVISION OF BRIDGES AND VIADUCTS

Four-leaf Trunnion Bascule Bridge
AT
WEST CONGRESS STREET
OVER THE
SOUTH BRANCH—CHICAGO RIVER
SUPERSTRUCTURE—HOUSES & ENCLOSURES
ELECTRICAL EQUIPMENT

Scale: 1/4" = 1'-0"	DATE: AUGUST 1950
Drawn by: [Signature]	DRWC 17505
Checked by: [Signature]	FILE No. 11-147-2
Approved: [Signature]	

1624450054 117-D P.C. 803

FOR INFORMATION ONLY

G:\18943ADolphin\Cadd\162445-80E\1-013-EX1.dgn
15-OCT-2008 12:28