

F.A.P. RTE.	SECTION	COUNTY	TOTAL SHEETS	SHEET NO.
876	9Y-RS-7	WILL	100	27
STA. 1+100		TO STA. 1+475		
FED. ROAD DIST. NO. 1		ILLINOIS FED. AID PROJECT		

CONTRACT NO. 60E52

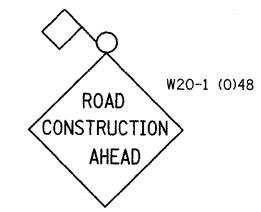
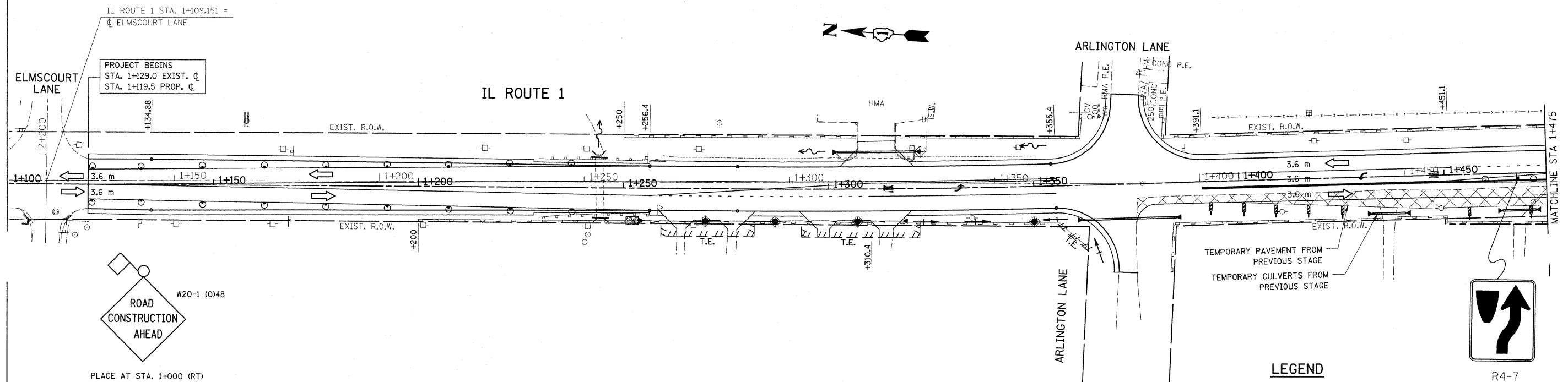

PLACE AT STA. 1+000 (RT)  
(ON ILLINOIS ROUTE 1)

TEMPORARY PAVEMENT FROM PREVIOUS STAGE  
TEMPORARY CULVERTS FROM PREVIOUS STAGE

R4-7

**LEGEND**

- PAVEMENT TO BE CONSTRUCTED
- WORK ZONE
- TEMPORARY PAVEMENT
- TRAFFIC FLOW
- DRUM OR TYPE II BARRICADE WITH STEADY BURN MONODIRECTIONAL LIGHTS @ 15m CTR'S., (8m CTR'S. IN TAPERS AND ON CURVES)
- SIGN
- TYPE III BARRICADE WITH FLASHING LIGHTS
- VERTICAL SIGN PANELS ON POSTS

REVISIONS		ILLINOIS DEPARTMENT OF TRANSPORTATION SUGGESTED MAINTENANCE OF TRAFFIC IL. 1 STAGE II
NAME	DATE	
		SCALE 1:500 DATE 1/2/2009 DRAWN BY CHECKED BY