

F.A.P. RTE.	SECTION	COUNTY	TOTAL SHEETS	SHEET NO.
876	9Y-RS-7	WILL	100	44
STA. 1+119.5		TO STA. 1+475		
FED. ROAD DIST. NO. 1		ILLINOIS FED. AID PROJECT		
CONTRACT #60E52				

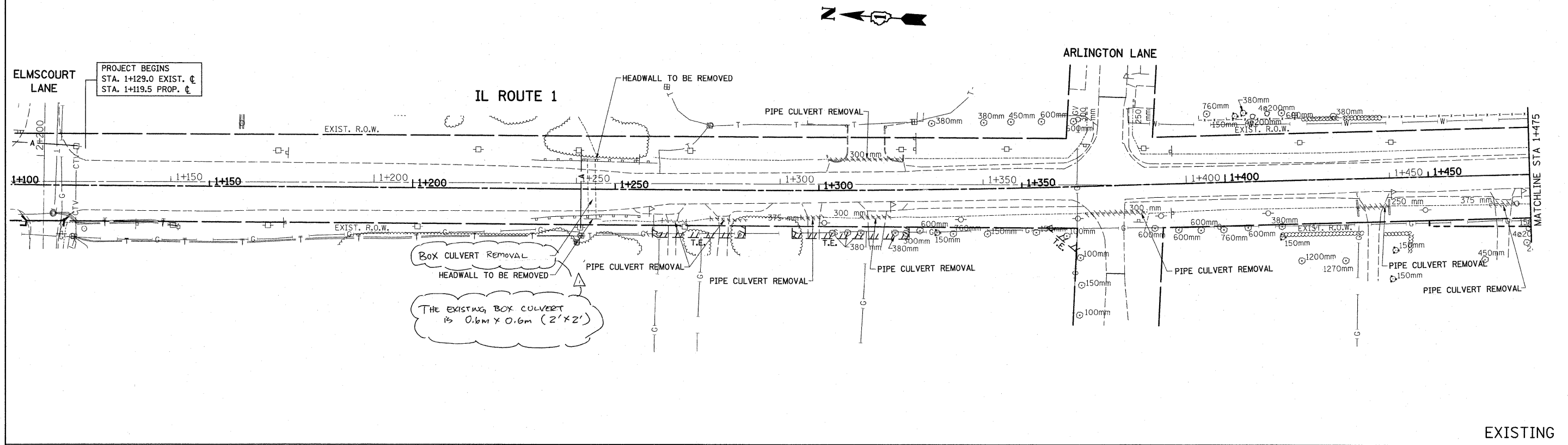

EXISTING

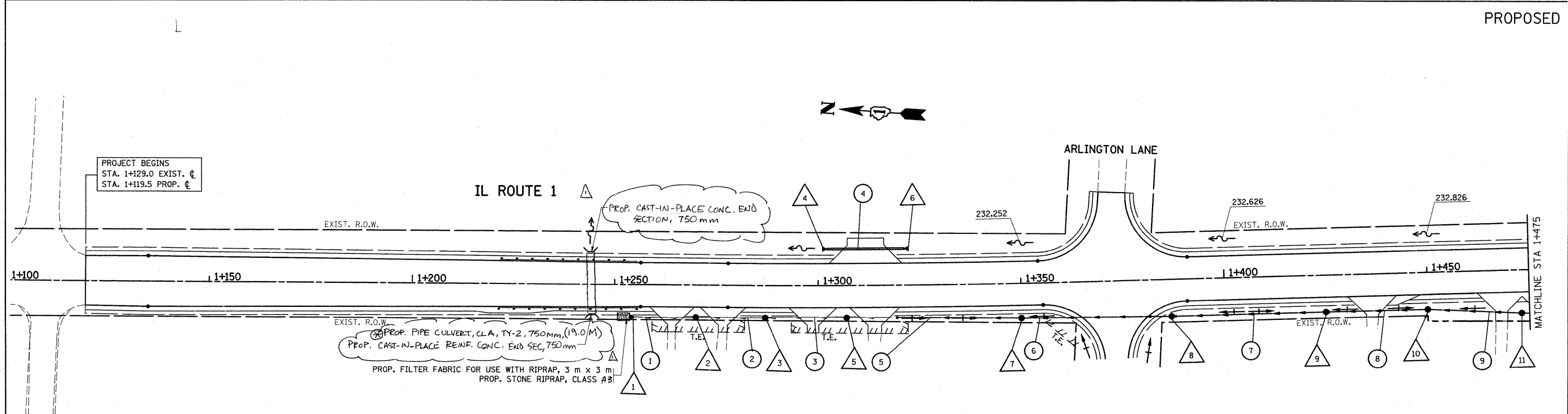

PROPOSED

⊗ INV W = 230.611  
INV E = 230.471

REVISIONS		ILLINOIS DEPARTMENT OF TRANSPORTATION
NAME	DATE	
		IL. ROUTE 1 EXISTING AND PROPOSED DRAINAGE PLAN
SCALE 1:500		DRAWN BY
DATE 8/28/2008		CHECKED BY