

F.A.P. RTE.	SECTION	COUNTY	TOTAL SHEETS	SHEET NO.
876	9Y-RS-7	WILL	100	69
STA. 1+700		TO STA. 2+400		
FED. ROAD DIST. NO. 1		ILLINOIS FED. AID PROJECT		
CONTRACT NO. 60E52				

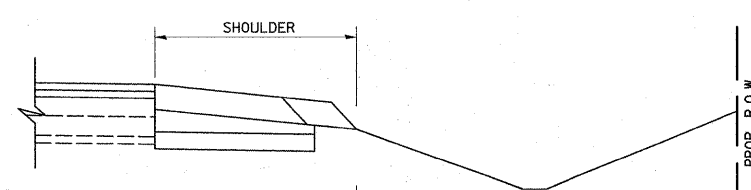
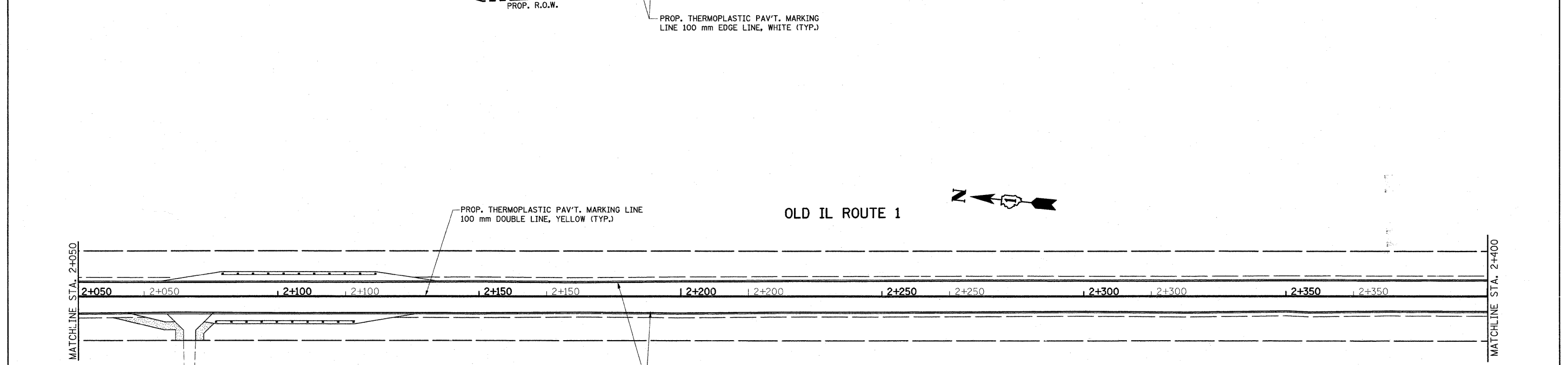
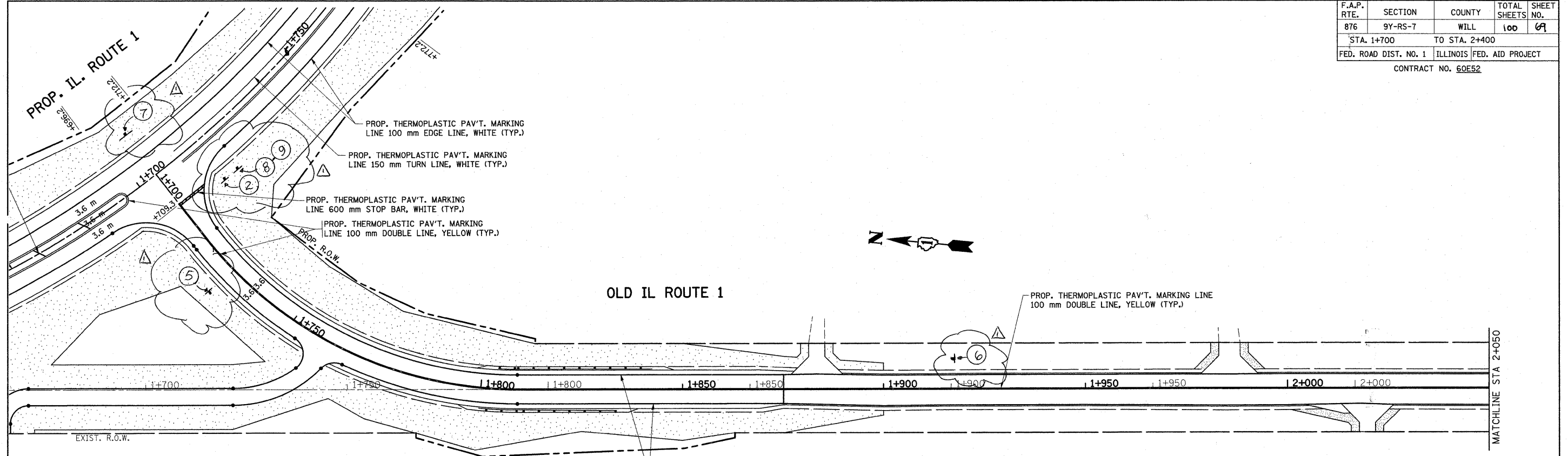

SEEDING DETAIL (TYPICAL)

* TOPSOIL FURNISH AND PLACE, 4"	* COMPOST FURNISH AND PLACE, 4"
* SEEDING CL. 2A	* SEEDING CL. 4
* EROSION CONTROL BLANKET	* EROSION CONTROL BLANKET
* NUTRIENTS	

LEGEND

[Hatched Box]	SODDING SALT TOLERANT
[Dotted Box]	SEEDING CLASS 2A
[Stippled Box]	SEEDING CLASS 4
[Cross-hatched Box]	EROSION CONTROL BLANKET (SEE SEEDING DETAIL THIS PAGE)

REVISIONS

NAME	DATE

ILLINOIS DEPARTMENT OF TRANSPORTATION
**IL. ROUTE 1
 PROPOSED
 LANDSCAPING AND
 PAVEMENT MARKING PLAN**
 SCALE 1:500 DRAWN BY
 DATE 9/3/2008 CHECKED BY