

ROUTE	SECTION	COUNTY	TOTAL SHEETS	SHEET NUMBER
VARIOUS	2008-053 BP	VARIOUS	69	9

CONTRACT NO. 60F04

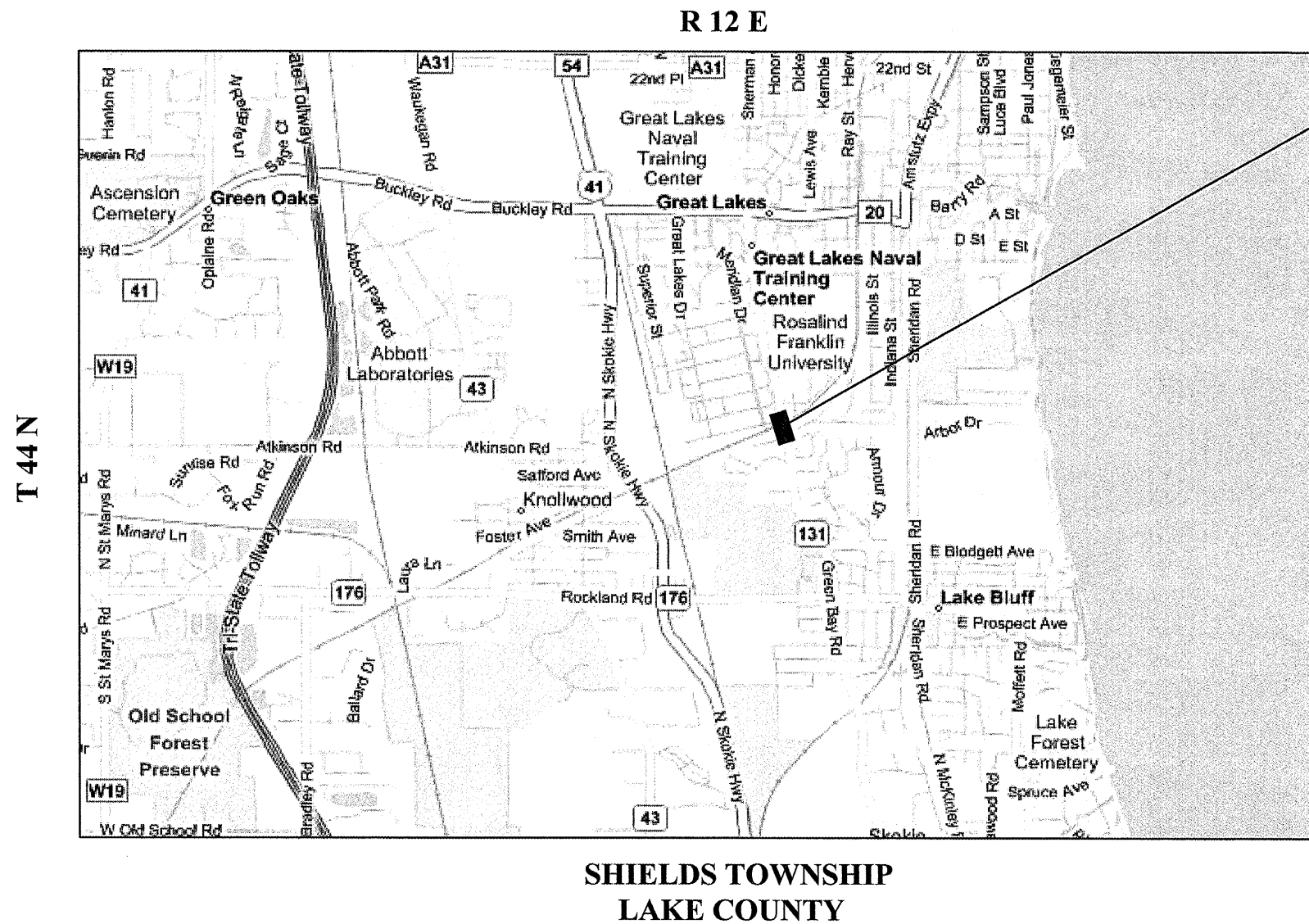

LOCATION 4:
SN 049-0012
 IL 131 OVER EJ&E RR
CITY OF NORTH CHICAGO



TRAFFIC DATA: IL 131

2007 ADT = 11,800
 POSTED SPEED LIMIT = 40 MPH

ILLINOIS DEPARTMENT OF TRANSPORTATION

LOCATION MAPS

LOCATION 4: IL 131 OVER EJ&E RR