

ROUTE	SECTION	COUNTY	TOTAL SHEETS	SHEET NUMBER
VARIOUS	2008-053BP	VARIOUS	69	30

CONTRACT NO. 60F04

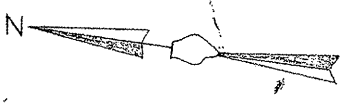
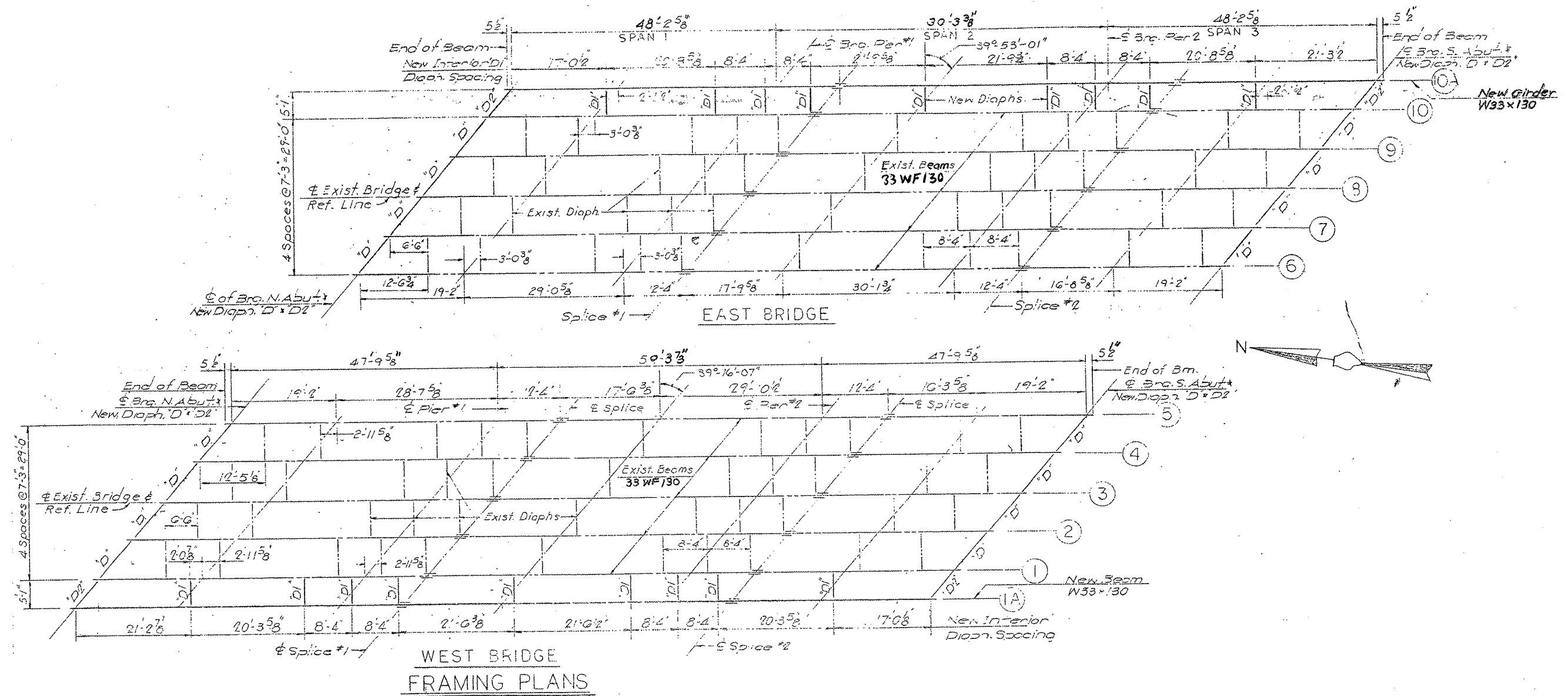

**LOCATION NO. 5**

**EXIST. BRIDGE PLANS**

**US 12 NB & SB OVER IL 176**

**SN'S 049-0022, 049-0023**