

STATE OF ILLINOIS  
DEPARTMENT OF TRANSPORTATION

ROUTE NO.	SECTION	COUNTY	IS/MS SHEETS	SHEET NO.	SHEET NO. 8 25 SHEETS
F.A.P. 324	23B-1	McHENRY	97	48	
FED. ROAD DIST. NO. 1		ILLINOIS	FED. AID PROJECT		

Contract # 62892

WEST CURB LINE

Location	Station	Offset	Theoretical Grade Elevations
End N. Appr. Pav't.	70+62.50	-22.42	805.86
A	70+52.50	-22.42	805.81
B	70+42.50	-22.42	805.76
Bk. N. Abut.	70+32.50	-22.42	805.71

WEST EDGE OF PAVEMENT

Location	Station	Offset	Theoretical Grade Elevations
End N. Appr. Pav't.	70+62.50	-12.00	806.08
A	70+52.50	-12.00	806.03
B	70+42.50	-12.00	805.97
Bk. N. Abut.	70+32.50	-12.00	805.92

℄ ROADWAY & PG

Location	Station	Offset	Theoretical Grade Elevations
End N. Appr. Pav't.	70+62.50	0.00	806.26
A	70+52.50	0.00	806.21
B	70+42.50	0.00	806.16
Bk. N. Abut.	70+32.50	0.00	806.12

EAST EDGE OF PAVEMENT

Location	Station	Offset	Theoretical Grade Elevations
End N. Appr. Pav't.	70+62.50	12.00	806.08
A	70+52.50	12.00	806.03
B	70+42.50	12.00	805.97
Bk. N. Abut.	70+32.50	12.00	805.92

EAST CURB LINE

Location	Station	Offset	Theoretical Grade Elevations
End N. Appr. Pav't.	70+62.50	22.42	805.86
A	70+52.50	22.42	805.81
B	70+42.50	22.42	805.76
Bk. N. Abut.	70+32.50	22.42	805.71

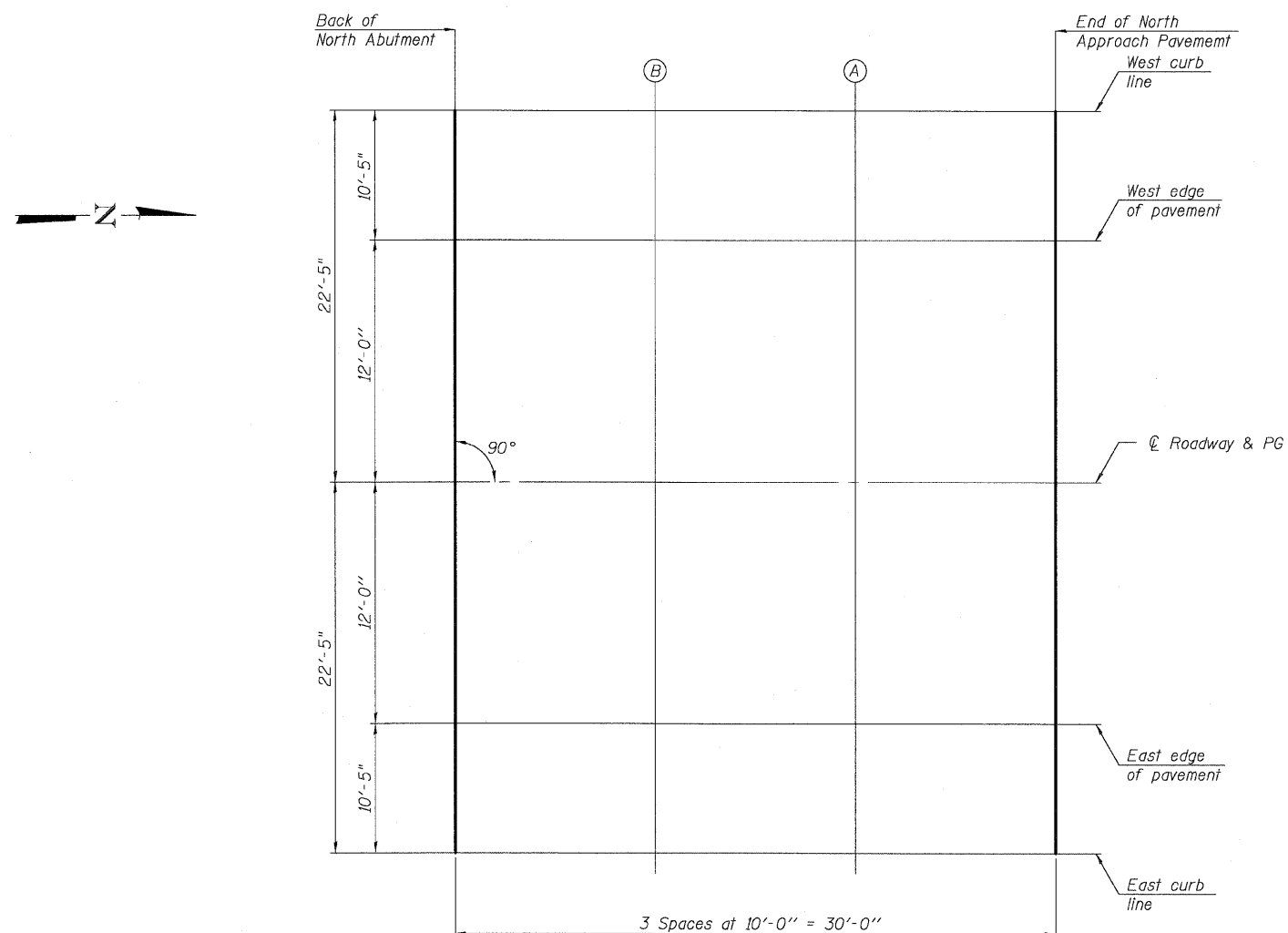

PLAN

DESIGNED	CJB
CHECKED	PWO
DRAWN	DRP
CHECKED	PJM



V3 Companies of Illinois Ltd.  
7325 Janes Avenue  
Woodridge, IL 60517  
630.724.9200 phone  
630.724.9202 fax  
www.v3co.com

TOP OF NORTH APPROACH  
SLAB ELEVATIONS  
ILL. ROUTE 23 OVER  
KISHWAUKEE RIVER  
F.A.P. RT. 324  
MCHEMRY COUNTY  
STATION 69+02.50  
STRUCTURE NO. 056-0001