

CONTRACT No. 63007

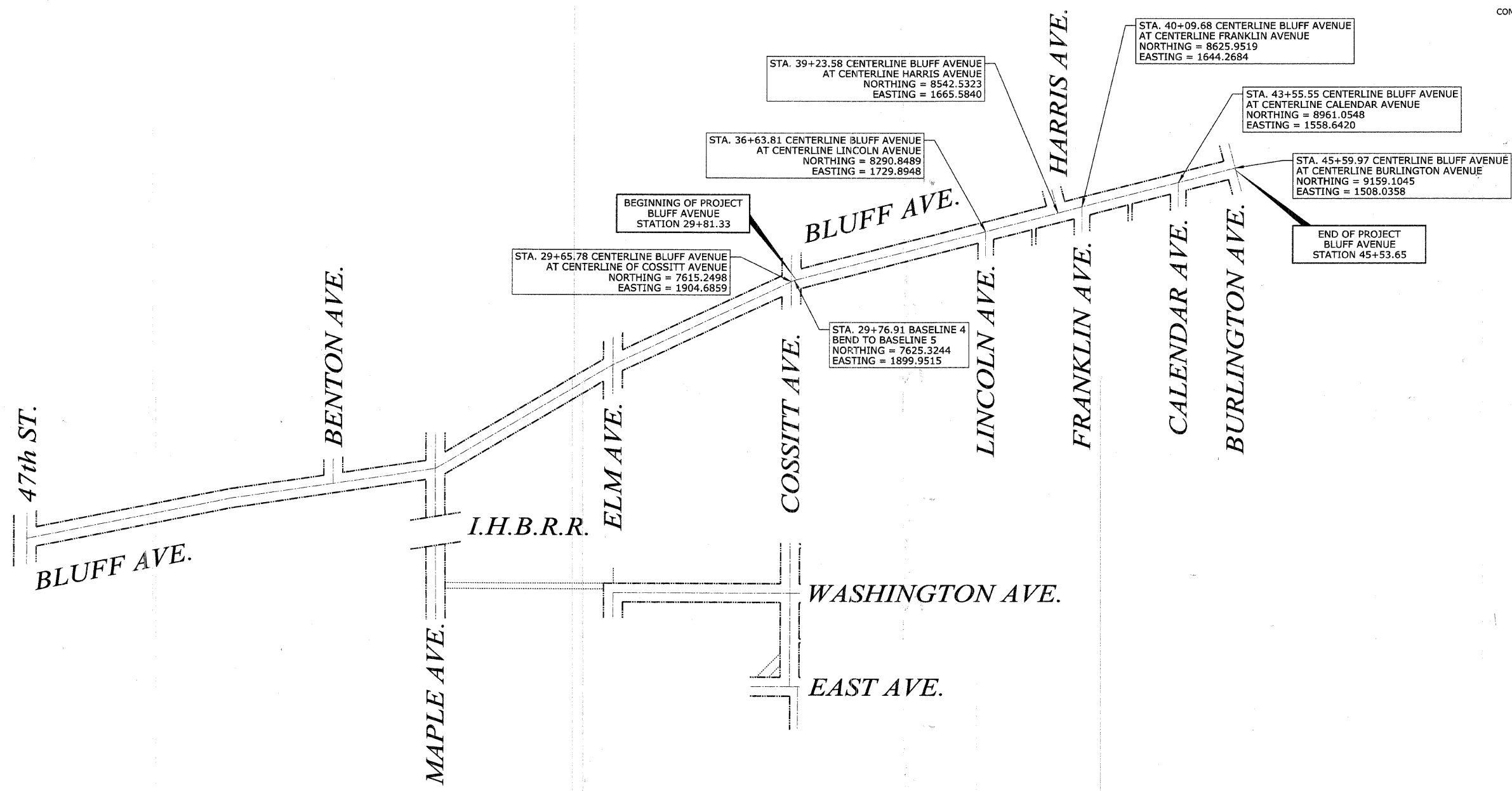

PLAN	SURVEYED	DATE
NOTE BOOK	ALIGNED	
NO.	RT. OF WAY CHECKED	
	PAID FILE NAME	

PROFILE	SURVEYED	DATE
NOTE BOOK	GRADES CHECKED	
NO.	PROPOSED NOTATIONS OK'D	

CONTROL POINTS				
LABEL	NORTHING	EASTING	ELEVATION	LOCATION
11	7,595.3440	1,873.8940	632.23	SW "x" Cossitt and Bluff
12	7,634.9600	1,932.4050	629.62	NE "x" Cossitt and Bluff
13	8,271.4843	1,781.6991	627.13	SE "x" Lincoln and Bluff
14	8,390.5377	1,769.6353	626.78	NE "x" Lincoln and Bluff
15	8,513.2888	1,626.2647	628.94	SW "x" Harris and Bluff
16	8,606.7540	1,703.4303	627.37	SE "x" Franklin and Bluff
17	8,943.0884	1,605.6827	627.69	SE "x" Calendar and Bluff
18	8,979.2506	1,598.5800	627.91	NE "x" Calendar and Bluff
19	9,183.1837	1,496.0622	629.89	North side Burlington and Bluff
20	9,188.5147	1,516.4589	629.40	NE "x" Burlington and Bluff

REVISIONS		ILLINOIS DEPARTMENT OF TRANSPORTATION <b>BLUFF AVENUE IMPROVEMENTS STAGE 1</b>
NAME	DATE	
		<b>ALIGNMENT, TIES AND ELEVATION CONTROL</b>
		SCALE: NTS
		DATE 07/18/2008
		DRAWN BY H&A
		CHECKED BY PFH