

STATE OF ILLINOIS
DEPARTMENT OF TRANSPORTATION

FIGURE NO.	SECTION	COUNTY	TOTAL SHEETS	SHEET NO.	SHEET NO. S-16
		KANE	72	35	SHEETS 33
FED. ROAD DIST. NO. 7		ILLINOIS PROJECT		Project No. BR05-DO01(641) Contract No. 63080	

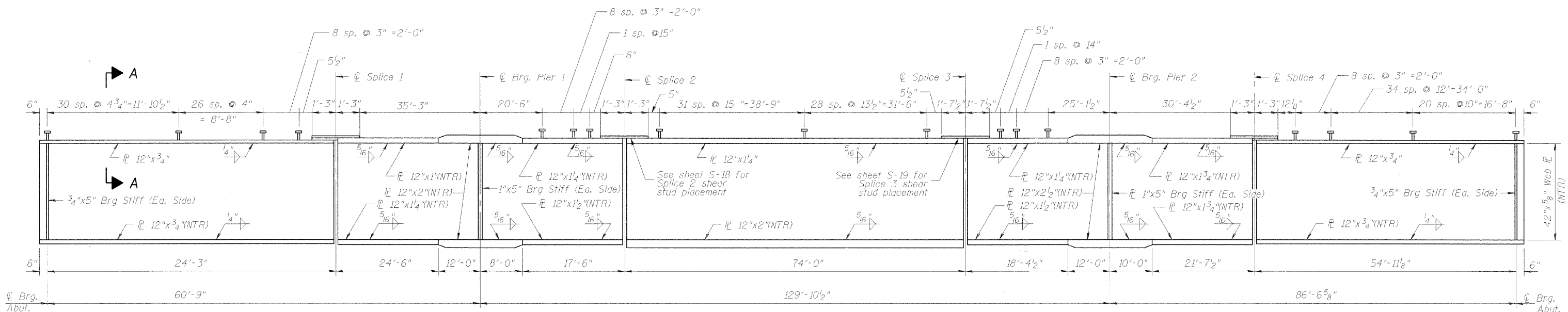
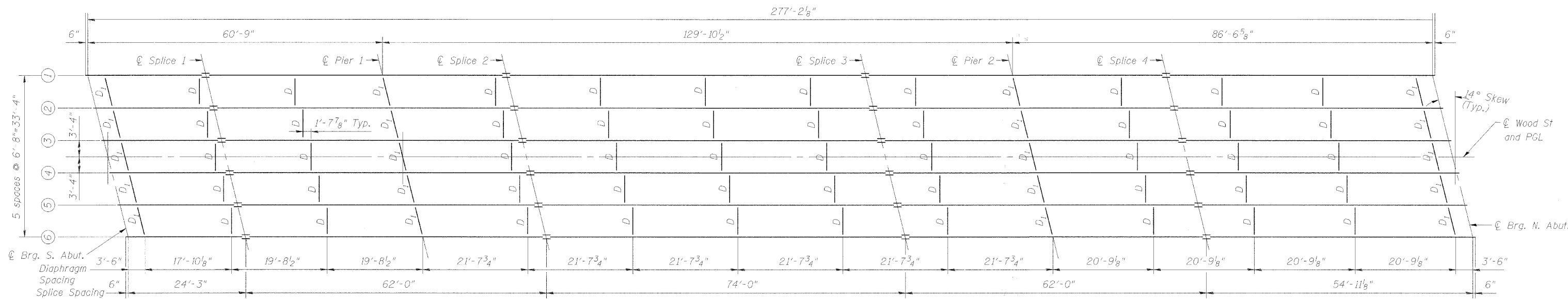

GIRDER ELEVATION

"NTR" denotes plates to which notch toughness requirements are applicable.

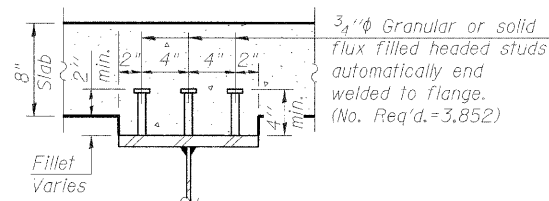

SECTION A-A

Note:

All structural steel shall be AASHTO M 270 Grade 50.
For General Notes, see Sheet S-2 of S-32.

DESIGNED	200
CHECKED	EXAMINED
DRAWN	PASSED
CHECKED	



REVISIONS	
NAME	DATE

ILLINOIS DEPARTMENT OF TRANSPORTATION
FRAMING PLAN AND ELEVATION
WOOD ST. BRIDGE OVER B.N.S.F. R.R.
AND INDIAN CREEK
SECTION - BR STATION 15+24.92
KANE COUNTY STRUCTURE NO. 045-6022

SCALE: DRAWN BY: MCC
DATE: SEPTEMBER 2008 CHECKED BY: ATI