

NOTES:  
 1. FINAL LOCATIONS OF HANDHOLES, POSTS, AND MAST ARMS SHALL BE LOCATED IN THE FIELD BY THE ENGINEER.  
 2. PROPOSED CONTROLLER TO BE IN SAME LOCATION AS EXISTING CONTROLLER.

SCALE: 1:250

THE EMERGENCY VEHICLE PREEMPTION EQUIPMENT FOR THIS PROJECT SHALL BE "OPTICOM" TO MATCH THE EXISTING SYSTEM AND MUNICIPAL REQUIREMENTS

CARE IS TO BE TAKEN BY THE CONTRACTOR TO AVOID DAMAGE TO THE EXISTING TRAFFIC SIGNAL CONDUIT, DETECTORS, AND EQUIPMENT. THE CONTRACTOR SHALL REPAIR OR REPLACE ANY DAMAGED CONDUIT OR EQUIPMENT AT NO COST TO THE COUNTY OR VILLAGE.

RESTORATION OF WORK AREA. RESTORATION OF THE TRAFFIC SIGNAL WORK AREA SHALL BE INCIDENTAL TO THE RELATED PAY ITEM SUCH AS FOUNDATION, CONDUIT, HANDHOLE, TRENCH AND BACKFILL, ETC., AND NO EXTRA COMPENSATION SHALL BE ALLOWED. ALL ROADWAY SURFACES SUCH AS SHOULDERS, MEDIANS, SIDEWALKS, PAVEMENT, ETC. SHALL BE REPLACED IN KIND. ALL DAMAGE TO MOWED LAWNS SHALL BE REPLACED WITH AN APPROVED SOD, AND ALL DAMAGE TO UNMOWED FIELDS SHALL BE SEED IN ACCORDANCE WITH STANDARD SPECIFICATIONS 252 AND 250 RESPECTIVELY.

TRAFFIC SIGNAL PLAN LEGEND

- CONTROLLER
- SERVICE INSTALLATION
- SIGNAL HEAD
- SIGNAL HEAD WITH BACKPLATE
- SIGNAL POST
- MAST ARM ASSEMBLY AND POLE
- HANDHOLE
- HEAVY DUTY HANDHOLE
- DOUBLE HANDHOLE
- GALVANIZED STEEL CONDUIT IN TRENCH (T) OR PUSHED (P)
- DETECTOR LOOP
- PEDESTRIAN SIGNAL HEAD
- PEDESTRIAN PUSH BUTTON
- MEDIAN REMOVAL AND REPLACEMENT
- EMERGENCY VEHICLE LIGHT DETECTOR
- CONFIRMATION BEACON

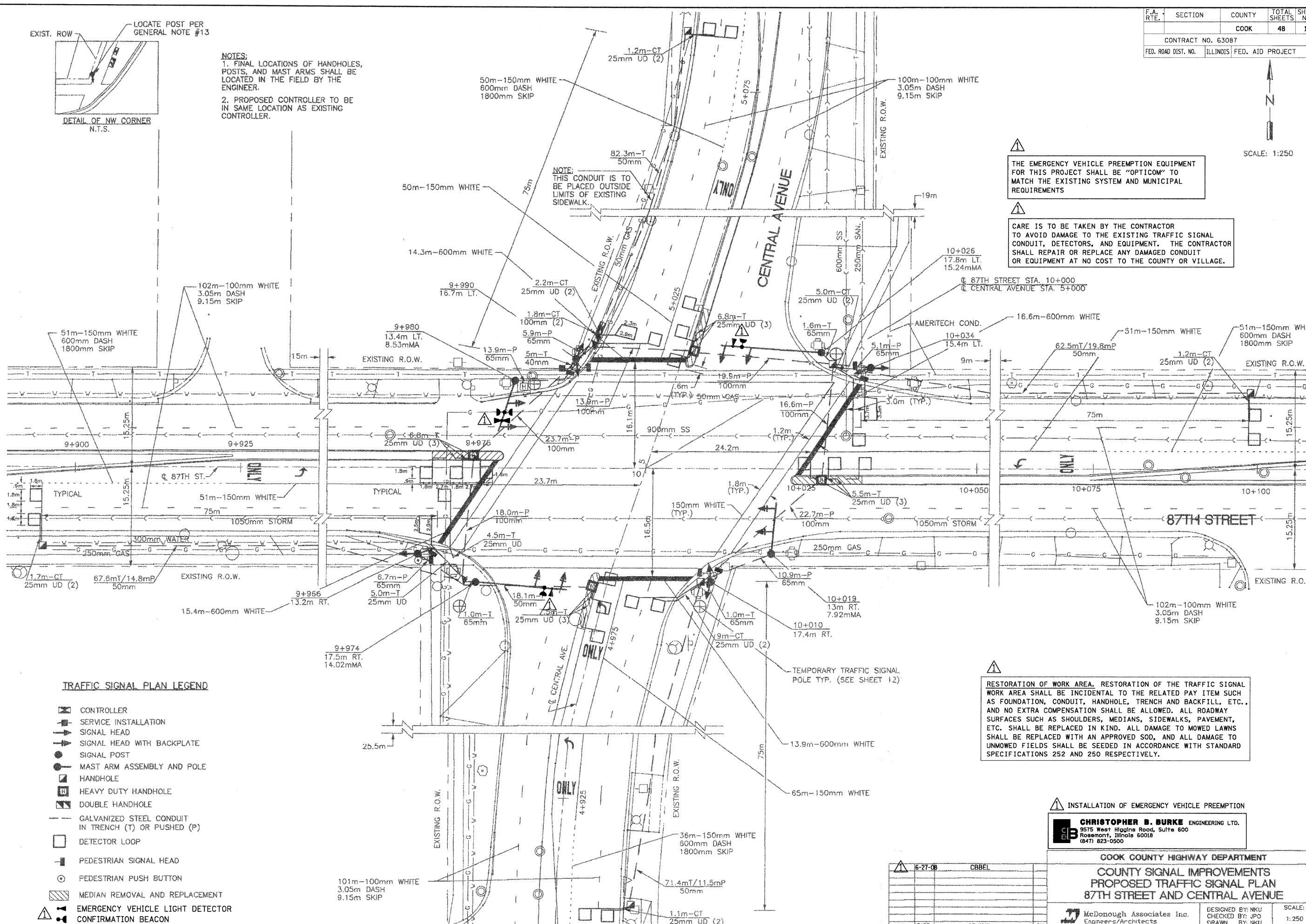

INSTALLATION OF EMERGENCY VEHICLE PREEMPTION

**CHRISTOPHER B. BURKE ENGINEERING LTD.**  
 9575 West Higgins Road, Suite 600  
 Rosemont, Illinois 60018  
 (647) 823-0500

COOK COUNTY HIGHWAY DEPARTMENT  
 COUNTY SIGNAL IMPROVEMENTS  
 PROPOSED TRAFFIC SIGNAL PLAN  
 87TH STREET AND CENTRAL AVENUE

NO.	DATE	REVISION	BY
6-27-06		CBBEL	

DESIGNED BY: NKU  
 CHECKED BY: JPO  
 DRAWN BY: NKU

SCALE: 1:250