

F.A. RTE.	SECTION	COUNTY	TOTAL SHEETS	SHEET NO.
		COOK	48	41
CONTRACT NO. 63087				
FED. ROAD DIST. NO.	ILLINOIS	FED. AID PROJECT		

### CONSTRUCTION NOTES

- INSTALL FOUNDATION AND REDFLEX CONTROL CABINET, 5/8"x15' GROUND ROD AND BOND TO CABINET AND POLE BASES WITH #8 BARE Cu. SEE CABINET FOUNDATION DETAIL.
- CONTRACTOR SHALL TERMINATE AND LAND ALL POWER CIRCUITS INTO REDFLEX CABINET.
- INSTALL INLINE FUSE HOLDER ON RED PHASE CONDUCTOR WITH 5 AMP FUSE INSIDE REDFLEX CABINET TO PROTECT CITY TRAFFIC CABINET.
- INSTALL A 40 AMP CIRCUIT BREAKER INTO EXISTING POWER PANEL FOR 120V SUPPLY TO REDFLEX CABINET.
- TERMINATE #14 WIRE TO RED PHASE AND NEUTRAL INSIDE CITY TRAFFIC CABINET. SEE CONDUCTOR SCHEDULE FOR APPROACHES. (NOTE: NOTIFY THE TRAFFIC OPERATIONS DEPARTMENT OF THE CITY 24 HOURS BEFORE CONNECTION).
- INSTALL JUNCTION BOX OF THE SIZE AND TYPE PER STANDARDS OF THE CITY-VERIFY BEFORE INSTALLATION.
- INSTALL LOOPS AND CONDUIT STUBOUT FOR REDFLEX DETECTION. EACH LOOP MUST HAVE A SEPARATE HOME RUN AND LOOP LEAD IN CABLE; MAXIMUM 2 LOOPS PER SAWCUT. REDFLEX LOOPS TO BE LABELED AT REDFLEX CABINET. REPLACE CITY LOOPS IF REQUIRED TO CITY STANDARDS. SEE LOOP DETAIL AND DRAWING FOR QUANTITY AND LOOP ID#.
- INSTALL FOUNDATION POLE AND GROUND ROD FOR REDFLEX EQUIPMENT. SEE DRAWING FOR LOCATION. SEE POLE DETAIL.
- INSTALL CAMERA AND FLASH ENCLOSURE ON REDFLEX POLE; AIM AT MONITORED APPROACHES. INCLUDE 3 #14 AWG CONDUCTOR CABLES FROM CAMERA ENCLOSURE TO FLASH.
- INSTALL A 250 WATT FLASH UNIT ON REDFLEX POLE. AIM AT MONITORED APPROACHES.
- CONNECT POLE TO SOLID BARE BOND GROUND AND GROUNDING ROD IN POLE FOUNDATION AND TO SYSTEM GROUND BONDED BACK AT THE REDFLEX CABINET.
- TRACER WIRE TO BE RUN THROUGH ALL CONDUIT FROM THE REDFLEX CABINET TO ALL REDFLEX EQUIPMENT.
- CONDUIT TO BE BORED UNDER ROADWAY TO MIN. STANDARD COVER DEPTH REQUIRED BY THE CITY (24" MINIMUM).
- VERIFY IF EXISTING SIGNAL HEADS HAVE LED'S INSTALLED. IF NOT, INSTALL RED AND AMBER GELCORE LED'S OF THE TYPE APPROVED BY THE CITY-VERIFY BEFORE INSTALLING. IF NEEDED ADJUST SIGNAL HEAD SO IT IS VISIBLE TO THE REDFLEX CAMERA.
- REFRESH STRIPING (VIOLATION LINE AND LANES ETC) AS NEEDED AT THE MONITORED APPROACHES.
- TERMINATE POLE TO REDFLEX CABINET POWER CIRCUIT #1 (HOT AND NEUTRAL).
- TERMINATE POLE TO REDFLEX CABINET POWER CIRCUIT #2 (HOT AND NEUTRAL).

### CONSTRUCTION NOTES:

- REMOVE EXISTING 14' TRAFFIC SIGNAL POST. INSTALL NEW 18' TRAFFIC SIGNAL POST ON EXISTING FOUNDATION AND RELOCATE EXISTING TRAFFIC SIGNAL HEAD, 1-FACE, 3-SECTION, PEDESTRIAN SIGNAL HEAD, 1-FACE, AND PUSH-BUTTON TO NEW POST. REUSE EXISTING CABLES. INSTALL NEW LIGHT DETECTOR ON NEW POST AND INSTALL NO. 20 3/C AND NO. 14 3/C CABLES.

### REMOVE EXISTING TRAFFIC SIGNAL EQUIPMENT EACH 1

THE FOLLOWING ITEMS SHALL BE REMOVED BY THE CONTRACTOR AND SHALL BE DISPOSED OF BY THEM OUTSIDE THE RIGHT-OF-WAY AT THEIR EXPENSE. THE SALVAGE VALUE OF THE REMOVED EQUIPMENT SHALL BE REFLECTED IN THE CONTRACT BID PRICE.

- 1 EACH SIGNAL POST 14 FT.

### TRAFFIC SIGNAL LEGEND

	PROPOSED	EXISTING
CONTROLLER CABINET		
SERVICE INSTALLATION		
SIGNAL HEAD		
SIGNAL HEAD WITH BACKPLATE		
SIGNAL HEAD, PEDESTRIAN		
SIGNAL POST		
MAST ARM ASSEMBLY AND POLE, STEEL		
MAST ARM ASSEMBLY AND POLE, ALUMINUM		
COMBINATION MAST ARM ASSEMBLY AND POLE, STEEL WITH LUMINAIRE		
UNIT DUCT	UD	
COMMON TRENCH	CT	
HANDHOLE		
HEAVY DUTY HANDHOLE		
DOUBLE HANDHOLE		
G.S. CONDUIT IN TRENCH (T) OR PUSHED (P)	T/P	
PEDESTRIAN PUSHBUTTON DETECTOR		
DETECTOR LOOP		
CAST IRON JUNCTION BOX		
EMERGENCY VEHICLE LIGHT DETECTOR		
CONFIRMATION BEACON		
SIGNAL HEAD OPTICALLY PROGRAMMED	"P"	"P"
CONDUIT SPLICE		
WOOD POLE		
RACEWAY FOR MAGNETIC DETECTOR, TYPE I OR TYPE II		
VEHICLE DETECTOR, NON COMPENSATED MAGNETIC TYPE		
RAILROAD CONTROL CABINET		
TELEPHONE CONNECTION		
ILLUMINATED SIGN "NO LEFT TURN"		
ILLUMINATED SIGN "NO RIGHT TURN"		
EMERGENCY VEHICLE LIGHT DETECTOR		
CONFIRMATION BEACON		
RELOCATED	"R"	"R"

POLE SCHEDULE			
NO.	TYPE	HEIGHT	NEW/EXISTING
1	REFLEX	10'	N

LEGEND	
	TRAFFIC CONTROL CABINET
	POWER CABINET
	REFLEX CONTROL CABINET
	CAMERA ENCLOSURE
	FLASH
	NEW PULL/JUNCTION BOX
	EXISTING PULL/JUNCTION BOX

ABBREVIATIONS	
CAT5	= CATEGORY FIVE CABLE
DLC	= DETECTOR LOOP CABLE (SHIELDED)
TSP	= TWISTED SHIELDED PAIR
LED	= LIGHT EMITTING DIODE
R/W	= RIGHT OF WAY
E.O.P.	= EDGE OF PAVEMENT

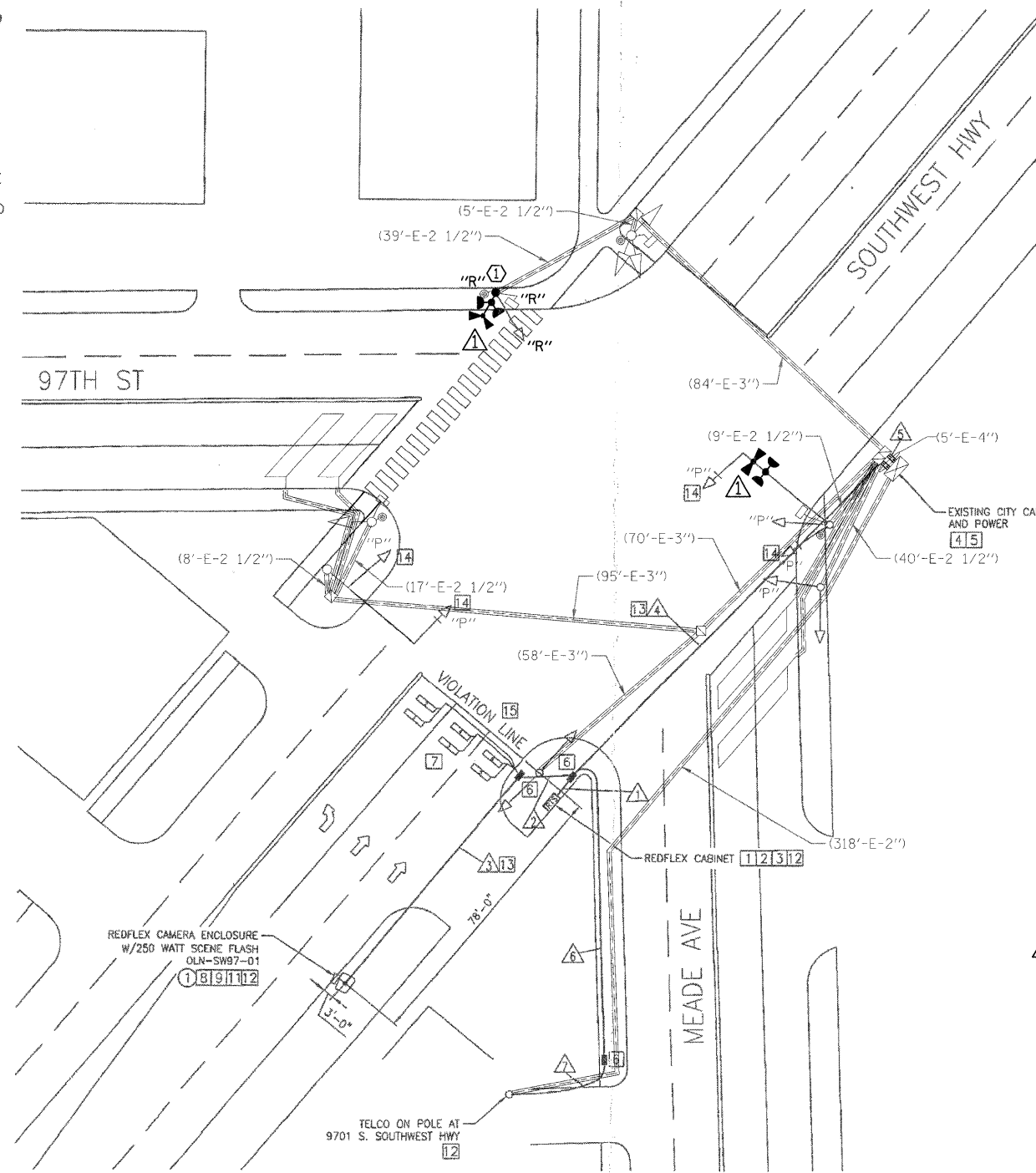

**RESTORATION OF WORK AREA.** RESTORATION OF THE TRAFFIC SIGNAL WORK AREA SHALL BE INCIDENTAL TO THE RELATED PAY ITEM SUCH AS FOUNDATION, CONDUIT, HANDHOLE, TRENCH AND BACKFILL, ETC., AND NO EXTRA COMPENSATION SHALL BE ALLOWED. ALL ROADWAY SURFACES SUCH AS SHOULDERS, MEDIANS, SIDEWALKS, PAVEMENT, ETC. SHALL BE REPLACED IN KIND. ALL DAMAGE TO MOWED LAWNS SHALL BE REPLACED WITH AN APPROVED SOD, AND ALL DAMAGE TO UNMOWED FIELDS SHALL BE SEEDED IN ACCORDANCE WITH STANDARD SPECIFICATIONS 252 AND 250 RESPECTIVELY.

MUST VERIFY EXISTING UTILITY INFO AND LOCATION

### GENERAL NOTES

- ALL EXISTING UTILITIES SHOWN WITHIN THE PLANS ARE PROVIDED BY THE BEST AVAILABLE INFORMATION PROVIDED BY COOPERATING UTILITY COMPANIES. NEITHER REDFLEX NOR THE CITY ASSUME RESPONSIBILITY AS TO THE PRECISE LOCATION OR ACCURACY OF SHOWN UTILITIES. THE CONTRACTOR SHALL PROPERLY FIELD VERIFY UTILITY LOCATIONS AND SHALL PROPERLY PROTECT, MAINTAIN AND/OR REPAIR ANY DAMAGE OF ALL KNOWN AND ANY EXPOSED UNKNOWN UTILITIES SHOWN WITHIN THE PLANS. REDFLEX AND THE CITY ASSUME NO LIABILITY RESULTING IN POSSIBLE DEFICIENCIES IN UTILITY LOCATIONS AND NO REMEDIAL OR ADDITIONAL COMPENSATION WILL BE ALLOWED.
- ALL WORK SHALL CONFORM TO ALL NATIONAL BUILDING AND ELECTRICAL CODES EXCEPT WHEN THE STATE D.O.T. AND/OR THE CITY STANDARDS SUPERSEDE.

THE EMERGENCY VEHICLE PREEMPTION EQUIPMENT FOR THIS PROJECT SHALL BE "OPTICOM" TO MATCH THE EXISTING SYSTEM AND MUNICIPAL REQUIREMENTS

INSTALLATION OF EMERGENCY VEHICLE PREEMPTION  
**CHRISTOPHER B. BURKE ENGINEERING LTD.**  
 3575 West Higgins Road, Suite 600  
 Rosemont, Illinois 60018  
 (847) 823-0500

SEAL	REVISIONS		RELAY SCHEDULE	<b>REDFLEX TRAFFIC SYSTEMS</b> 15020 N. 74TH STREET SCOTTSDALE, AZ 85260 PH: 480 607 0705	DRAWN BY: JPM DESIGNED BY: XXX CHECKED BY: - RECOMMENDED BY: - FIRE DEPT.	REVIEWED BY CITY STAFF DEPARTMENT: PUBLIC WORKS (OPER.) PUBLIC WORKS (ENV.) PUBLIC WORKS (WATER) PUBLIC WORKS (TRAF.)	APPROVED BY: _____ PUBLIC WORKS DIRECTOR / CITY ENGINEER DATE: _____ RECOMMENDED BY: _____ DEPUTY CITY ENGINEER	CITY OF: <b>OAK LAWN</b> TITLE: <b>REDLIGHT PHOTO ENFORCEMENT</b> <b>SOUTHWEST HWY AT 97TH ST</b>	DRAWING NO. <b>3025</b> <b>-103</b>																																								
	<table border="1"> <tr> <th>VER.</th> <th>DATE</th> <th>INITIAL</th> <th>DESCRIPTION</th> </tr> <tr> <td>1.0</td> <td>6-27-08</td> <td>CBBL</td> <td>INSTALLATION OF EMERGENCY VEHICLE PREEMPTION</td> </tr> </table>	VER.			DATE	INITIAL	DESCRIPTION	1.0	6-27-08	CBBL	INSTALLATION OF EMERGENCY VEHICLE PREEMPTION	<table border="1"> <tr> <th>NO.</th> <th>TYPE</th> <th>HEIGHT</th> <th>NEW/EXISTING</th> </tr> <tr> <td>1</td> <td>REFLEX</td> <td>10'</td> <td>N</td> </tr> </table>	NO.	TYPE	HEIGHT	NEW/EXISTING	1	REFLEX	10'	N	<table border="1"> <thead> <tr> <th colspan="2">LEGEND</th> </tr> </thead> <tbody> <tr> <td></td> <td>TRAFFIC CONTROL CABINET</td> </tr> <tr> <td></td> <td>POWER CABINET</td> </tr> <tr> <td></td> <td>REFLEX CONTROL CABINET</td> </tr> <tr> <td></td> <td>CAMERA ENCLOSURE</td> </tr> <tr> <td></td> <td>FLASH</td> </tr> <tr> <td></td> <td>NEW PULL/JUNCTION BOX</td> </tr> <tr> <td></td> <td>EXISTING PULL/JUNCTION BOX</td> </tr> </tbody> </table>	LEGEND			TRAFFIC CONTROL CABINET		POWER CABINET		REFLEX CONTROL CABINET		CAMERA ENCLOSURE		FLASH		NEW PULL/JUNCTION BOX		EXISTING PULL/JUNCTION BOX	<table border="1"> <thead> <tr> <th colspan="2">ABBREVIATIONS</th> </tr> </thead> <tbody> <tr> <td>CAT5</td> <td>= CATEGORY FIVE CABLE</td> </tr> <tr> <td>DLC</td> <td>= DETECTOR LOOP CABLE (SHIELDED)</td> </tr> <tr> <td>TSP</td> <td>= TWISTED SHIELDED PAIR</td> </tr> <tr> <td>LED</td> <td>= LIGHT EMITTING DIODE</td> </tr> <tr> <td>R/W</td> <td>= RIGHT OF WAY</td> </tr> <tr> <td>E.O.P.</td> <td>= EDGE OF PAVEMENT</td> </tr> </tbody> </table>	ABBREVIATIONS		CAT5	= CATEGORY FIVE CABLE	DLC	= DETECTOR LOOP CABLE (SHIELDED)	TSP	= TWISTED SHIELDED PAIR	LED	= LIGHT EMITTING DIODE	R/W
VER.	DATE	INITIAL	DESCRIPTION																																														
1.0	6-27-08	CBBL	INSTALLATION OF EMERGENCY VEHICLE PREEMPTION																																														
NO.	TYPE	HEIGHT	NEW/EXISTING																																														
1	REFLEX	10'	N																																														
LEGEND																																																	
	TRAFFIC CONTROL CABINET																																																
	POWER CABINET																																																
	REFLEX CONTROL CABINET																																																
	CAMERA ENCLOSURE																																																
	FLASH																																																
	NEW PULL/JUNCTION BOX																																																
	EXISTING PULL/JUNCTION BOX																																																
ABBREVIATIONS																																																	
CAT5	= CATEGORY FIVE CABLE																																																
DLC	= DETECTOR LOOP CABLE (SHIELDED)																																																
TSP	= TWISTED SHIELDED PAIR																																																
LED	= LIGHT EMITTING DIODE																																																
R/W	= RIGHT OF WAY																																																
E.O.P.	= EDGE OF PAVEMENT																																																

N:\orklawn\080363\T-Office\NVP\_Swhwy-97th.dgn