

PATH INTERSECTION ENLARGEMENT B - BRIDGE STREET

PHASING NOTES

1. STAGE CONSTRUCTION SO SIDEWALKS ON ONE SIDE OF STREET IS OPEN WITH NO OBSTRUCTIONS. USE LIGHTED BARRICADES AND SIGNS TO PREVENT ACCESS TO OPEN TRENCHES

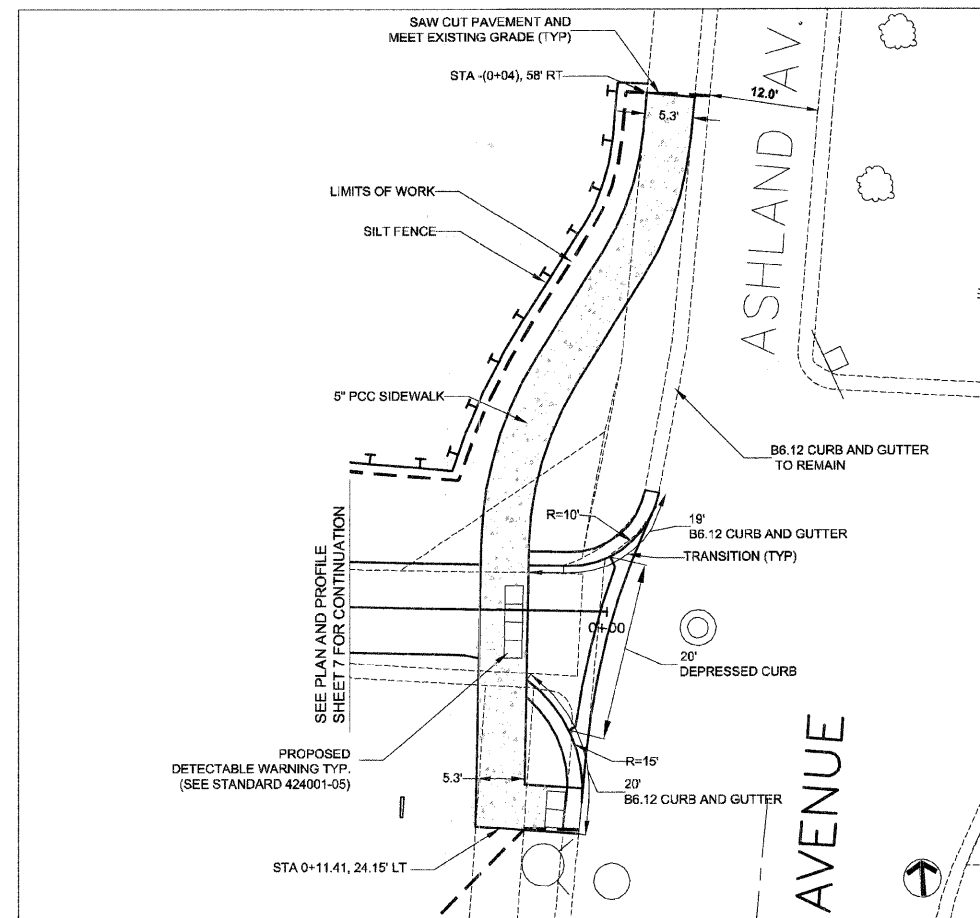

PATH INTERSECTION ENLARGEMENT A - ASHLAND AVENUE

PHASING NOTES

1. MAINTAIN 5' SIDEWALK DURING ALL PERIODS OF CONSTRUCTION USE LIGHTED BARRICADES AND SIGNS TO PREVENT ACCESS TO OPEN TRENCHES.
2. USE AGGREGATE SIDEWALKS 5' WIDE TO MAINTAIN SIDEWALKS IF NECESSARY. IN NO CASE WILL "SIDEWALK CLOSED USE OTHER SIDE" BE ALLOWED. NOR WILL USING A PORTION OF THE STREET AS SIDEWALK BE ALLOWED. AGGREGATE PAID FOR AS AGGREGATE BASE COURSE TYPE B 8"

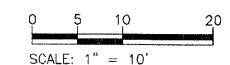

URS 100 S. WACKER DR., SUITE 500 TEL (312)-939-1000
CHICAGO IL, 60606 FAX (312)-939-4198

REVISIONS	
NAME	DATE

CITY OF EVANSTON
TWIGGS PARK
PATH INTERSECTION ENLARGEMENT

DATE : 6/20/08
DRAWN BY : LLM
CHECKED BY : BA