

Drainage Area =	108.0	acres		
Existing Low Grade Elevation:	777.12	ft @	778+69.	
Proposed Low Grade Elevation:	777.12	ft @	778+69.	
Flood	Frequency	Discharge	Headwater Elev. (ft)	
	Year	cfs	Existing	Proposed
Ten-Year	10	159	775.19	772.19
Design	50	223	777.37	773.51
Base	100	253	777.49	774.43
OVT (E)	26	193	777.12	
OVT (P)	420	342		777.12

10-Year Velocity through Existing Culvert = 17.11 fps
 10-Year Velocity through Proposed Culvert = 9.46 fps

GIANULIS FAMILY TRUST

CONSTRUCTION LIMITS

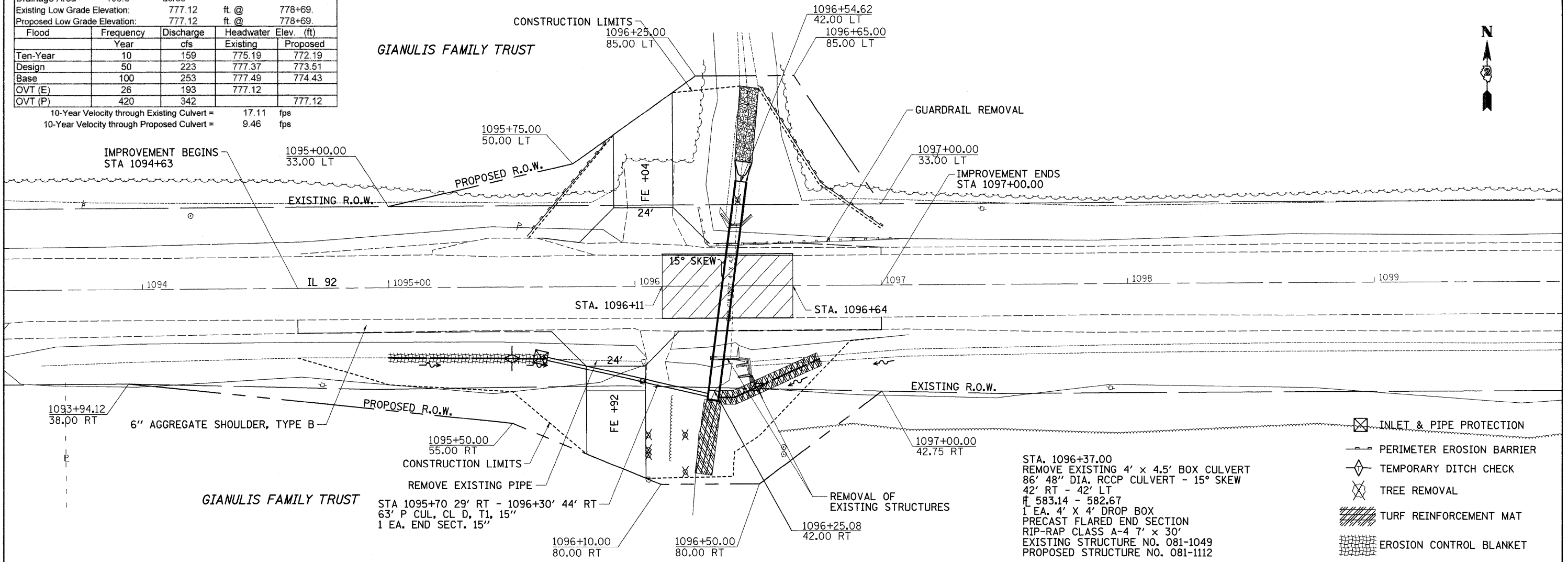

- INLET & PIPE PROTECTION
- PERIMETER EROSION BARRIER
- TEMPORARY DITCH CHECK
- TREE REMOVAL
- TURF REINFORCEMENT MAT
- EROSION CONTROL BLANKET

STA. 1096+37.00
 REMOVE EXISTING 4' x 4.5' BOX CULVERT
 86' 48" DIA. RCCP CULVERT - 15° SKEW
 42' RT - 42' LT
 # 583.14 - 582.67
 1 EA. 4' X 4' DROP BOX
 PRECAST FLARED END SECTION
 RIP-RAP CLASS A-4 7' x 30'
 EXISTING STRUCTURE NO. 081-1049
 PROPOSED STRUCTURE NO. 081-1112

REMOVE EXISTING PIPE
 STA 1095+70 29' RT - 1096+30' 44' RT
 63' P CUL, CL D, T1, 15"
 1 EA. END SECT. 15"

REMOVAL OF EXISTING STRUCTURES

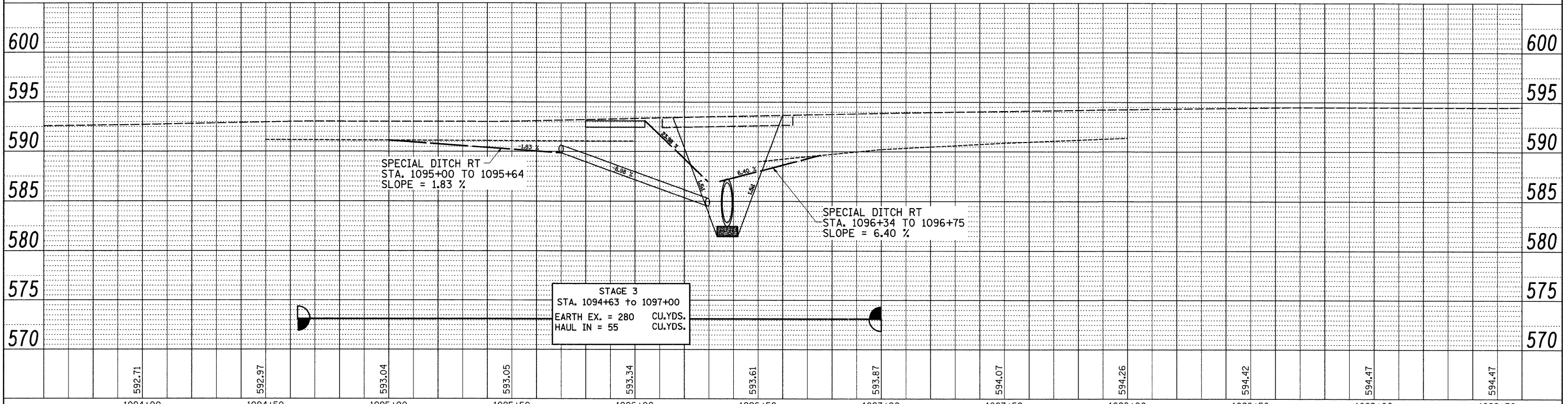

STAGE 3
 STA. 1094+63 to 1097+00
 EARTH EX. = 280 CU.YDS.
 HAUL IN = 55 CU.YDS.

DATE	
BY	
PLAN	
NO.	

DATE	
BY	
PROFILE	
NO.	

FILE NAME =	USER NAME = hensonke	DESIGNED -	REVISED -	STATE OF ILLINOIS		PLAN & PROFILE		F.A.P. RTE.	SECTION	COUNTY	TOTAL SHEETS	SHEET NO.
ct:\pw\work\p1\dot\hensonke\dms31385\d00707.pln.dgn		DRAWN -	REVISED -	DEPARTMENT OF TRANSPORTATION				599	(42MF1)T-1	ROCK ISLAND	26	12
PLOT SCALE = 20.0000' / IN.		CHECKED -	REVISED -			SCALE:		SHEET NO. OF SHEETS STA. TO STA.		CONTRACT NO. 64C76		
PLOT DATE = Thu Oct 29 07:37:17 2008		DATE -	REVISED -							ILLINOIS FED. AID PROJECT		