

| F.A. RTE. | SECTION | COUNTY | TOTAL SHEETS | SHEET NO. |
|-----------|---------|------------------------|--------------|-----------|
| 5 | D2 | STEPHENSON & WINNEBAGO | 14 | 1 |

- FAP 5 & FAI 39
- D2 Bridge Painting 2009-1
- Stephenson & Winnebago

D-92-005-09

STATE OF ILLINOIS
 DEPARTMENT OF TRANSPORTATION
 DIVISION OF HIGHWAYS

**PROPOSED
 HIGHWAY PLANS**

FAP ROUTE 5 & FAI ROUTE 39 (US Business 20 & I-39)
 SECTION D2 Bridge Painting 2009-1
 Stephenson & Winnebago Counties
 C-92-030-09

FOR INDEX OF SHEETS, SEE SHEET NO. 2

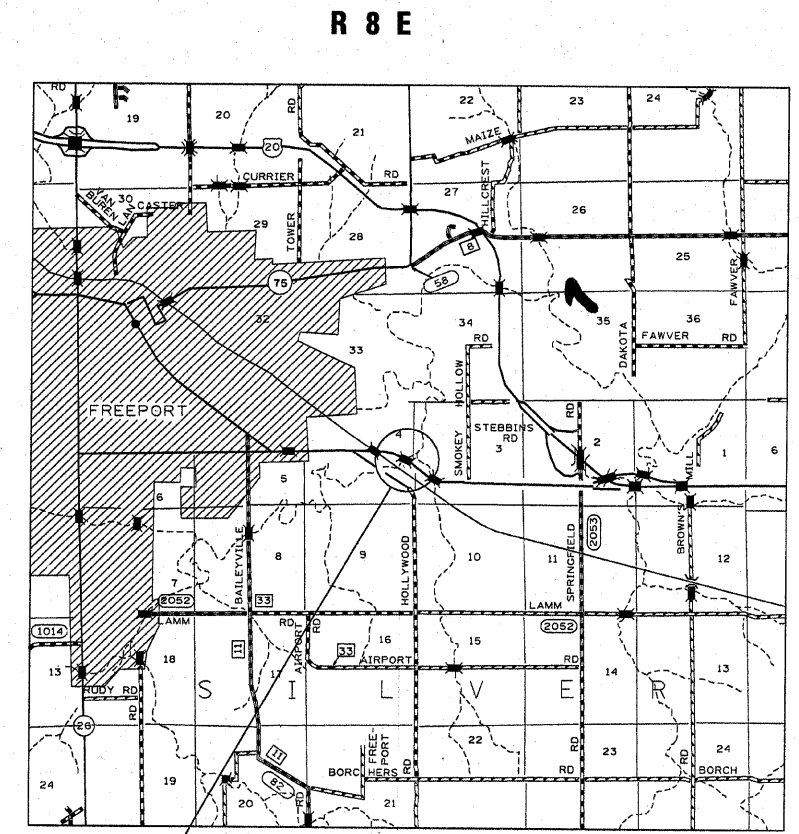
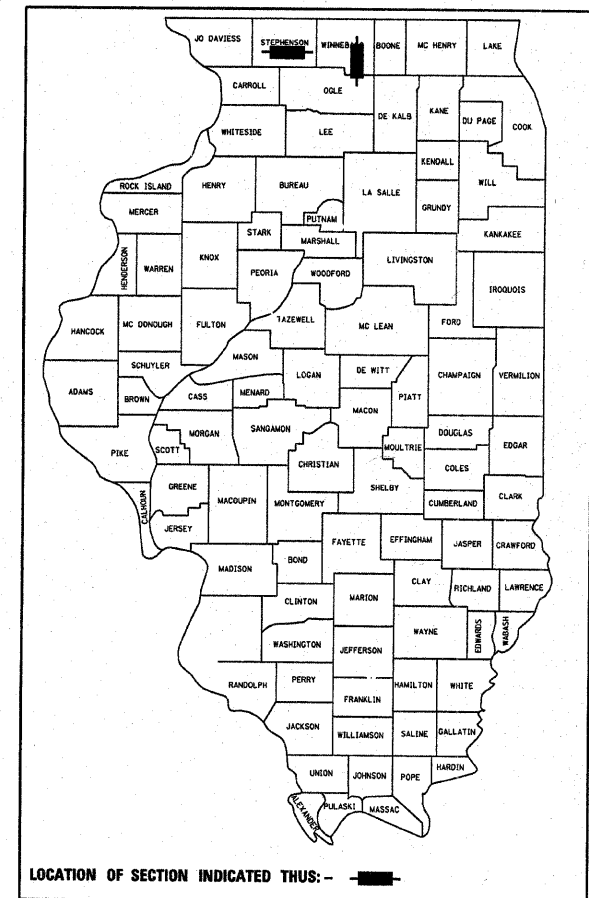

SN 089-0008

Stephenson

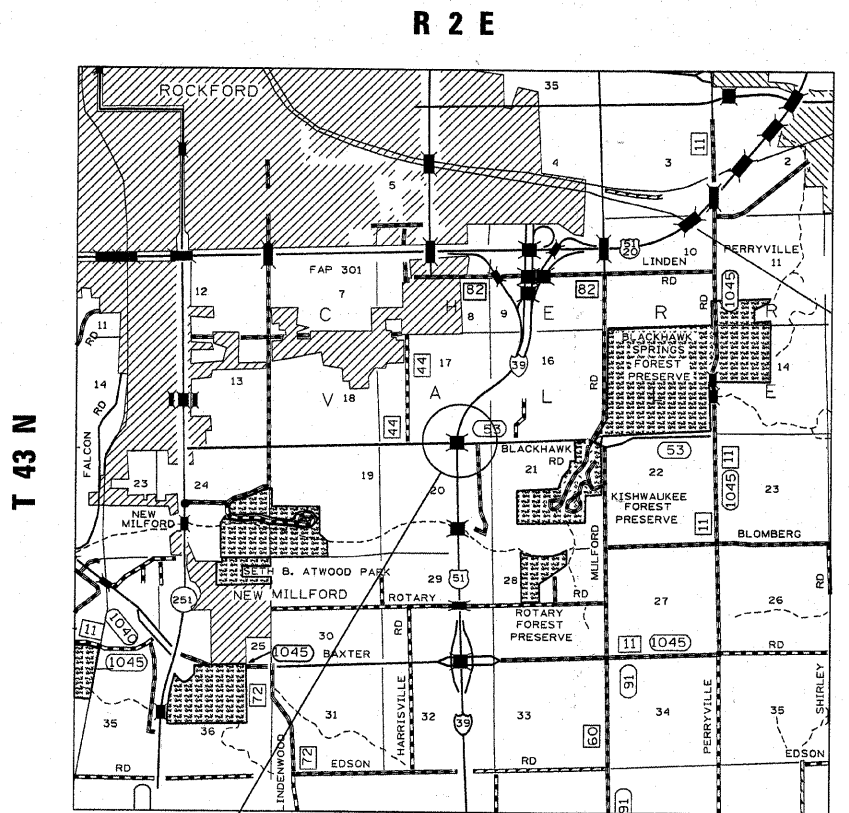

SN 101-0142
SN 101-0143

Winnebago

Bridge Maintenance Engineer
 Mahmoud Etemadi (815) 284-5393

Bridge Paint Technician
 Dan Link (815) 284-5416

J.U.L.I.E.
 JOINT UTILITY LOCATION INFORMATION FOR EXCAVATION
 1-800-892-0123

CONTRACT NO. 64E62

STATE OF ILLINOIS
 DEPARTMENT OF TRANSPORTATION
 DIVISION OF HIGHWAYS

10/15 2008
Eric E. Haral
 DEPUTY DIRECTOR OF HIGHWAYS, REGION ENGINEER

December 5, 2008
Christine M. Reed
 INTERIM ENGINEER OF DESIGN AND ENVIRONMENT

December 5, 2008
Christine M. Reed
 DIRECTOR OF HIGHWAYS, CHIEF ENGINEER

**PRINTED BY THE AUTHORITY
 OF THE STATE OF ILLINOIS**