

- ① ϕ CENTER ST. - LOCATION 1
- ② ϕ WATER ST. - LOCATION 2

ELEVATION

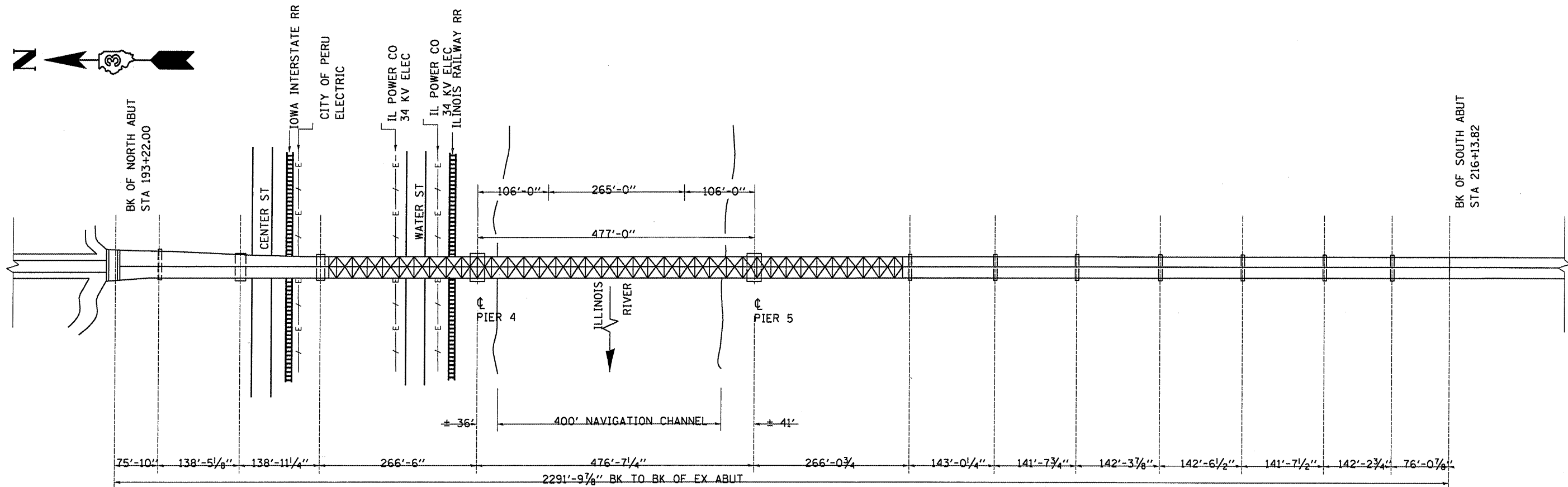

PLAN

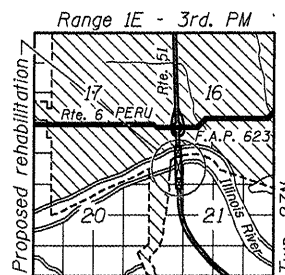

LOCATION SKETCH

PLAN AND ELEVATION
FAP RTE 46 SEC (1-BD)BP
LASALLE COUNTY
STA 204+67.75
SN 050-0079

FILE NAME =	USER NAME = woodshankr1	DESIGNED = RON WOODSHANK	REVISED =
c:\pw\work\PWIDOT\WOODSHANKR1\dms29370	d368854-sht-details.dgn	DRAWN = RON WOODSHANK	REVISED =
	PLOT SCALE = 100.0000 / IN.	CHECKED =	REVISED =
	PLOT DATE = Oct 15, 2008 - 07:05:32 AM	DATE =	REVISED =

STATE OF ILLINOIS
DEPARTMENT OF TRANSPORTATION

FOR INFORMATION ONLY

SCALE: _____ SHEET NO. 1 OF 30 SHEETS STA. 193+08.08 TO STA. 216+13.82

F.A.P. RTE.	SECTION	COUNTY	TOTAL SHEETS	SHEET NO.
46	(1-BD)BP	LASALLE	38	9
FED. ROAD DIST. NO. = [ILLINOIS] FED. AID PROJECT			CONTRACT NO. 66854	