

BILL OF MATERIALS (TEMPORARY LIGHTING)		
ITEM DESCRIPTION	UNIT	QTY
TEMPORARY LIGHTING SYSTEM	L SUM	1.0

CONSTRUCTION NOTES:

1. THE CONTRACTOR SHALL FURNISH AND INSTALL TEMPORARY LUMINAIRES AT THE LOCATIONS SHOWN ON THE PLAN SHEET. THE LUMINAIRES SHALL BE 250 WATT, HPS, TYPE III DISTRIBUTION AND SHALL BE WIRED INTO THE EXISTING LIGHTING CIRCUIT.
2. THE CONTRACTOR SHALL ATTACH THE TEMPORARY CABLE TO THE EXISTING LIGHT POLES AND TEMPORARY WOOD POLES AND WIRE THE EXISTING LIGHT POLES INTO THE TEMPORARY CIRCUIT.
3. THE CONTRACTOR SHALL MAINTAIN ALL ITEMS INSTALLED ON THIS CONTRACT FOR TEMPORARY LIGHTING (CABLE, ATTACHMENT BRACKETS, LUMINAIRES, ETC.) AND SHALL BE RESPONSIBLE FOR KEEPING THE TEMPORARY LIGHTING SYSTEM FULLY OPERATIONAL THROUGH ALL PHASES OF CONSTRUCTION.
4. THE CONTRACTOR SHALL FURNISH AND INSTALL ALL OTHER MISCELLANEOUS ITEMS REQUIRED FOR TEMPORARY LIGHTING, INCLUDING, BUT NOT LIMITED TO, ADDITIONAL WOOD POLES, CIRCUIT EXTENSIONS, ETC.
5. ALL LABOR, MATERIALS, AND EQUIPMENT REQUIRED TO COMPLY WITH THESE REQUIREMENTS SHALL BE INCLUDED IN THE UNIT BID PRICE FOR TEMPORARY LIGHTING SYSTEM. THERE WILL BE NO ADDITIONAL COMPENSATION.

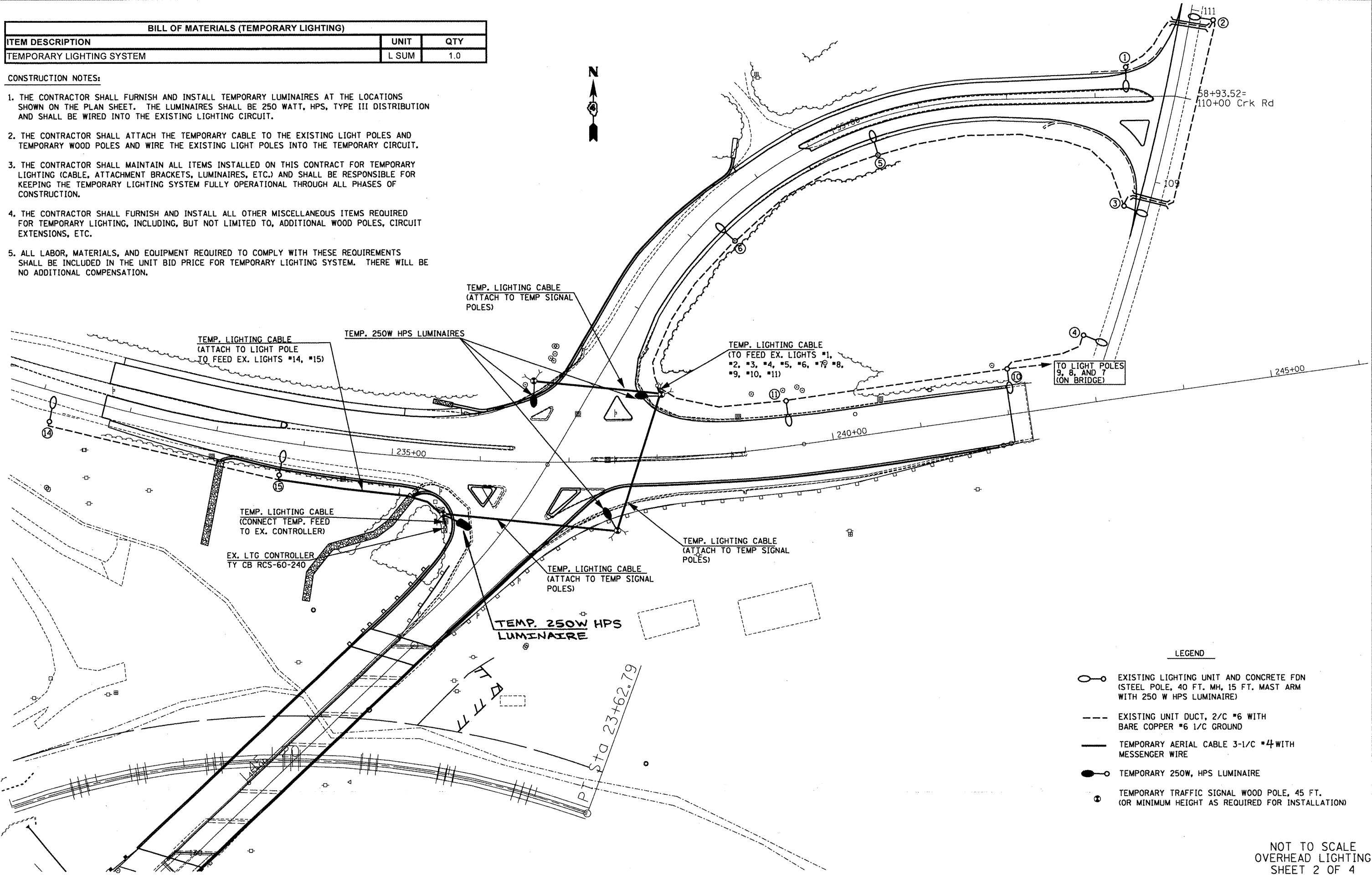

LEGEND

- EXISTING LIGHTING UNIT AND CONCRETE FDN (STEEL POLE, 40 FT. MH, 15 FT. MAST ARM WITH 250 W HPS LUMINAIRE)
- EXISTING UNIT DUCT, 2/C #6 WITH BARE COPPER #6 1/C GROUND
- TEMPORARY AERIAL CABLE 3-1/C #4 WITH MESSENGER WIRE
- TEMPORARY 250W, HPS LUMINAIRE
- TEMPORARY TRAFFIC SIGNAL WOOD POLE, 45 FT. (OR MINIMUM HEIGHT AS REQUIRED FOR INSTALLATION)

NOT TO SCALE
OVERHEAD LIGHTING
SHEET 2 OF 4

FILE NAME =	USER NAME = brucebm	DESIGNED -	REVISED -	STATE OF ILLINOIS DEPARTMENT OF TRANSPORTATION	IL 116 & AIRPORT RD. TEMPORARY LIGHTING SYSTEM	F.A.U. RTE.	SECTION	COUNTY	TOTAL SHEETS	SHEET NO.
C:\Documents and Settings\laynedm\Local Settings\Temporary Internet Files\OLK85688	Settings\Temporary Internet Files\OLK85688	DRAWN BY Airport Rd Signals and Light	REVISED Revised 12-14-08.dgn			6578	(1-R/R5 (1-VC)BR	Pearla	142	57
PLOT SCALE = 56.5714' / IN.		CHECKED -	REVISED -			CONTRACT NO. 68092				
PLOT DATE = 10/17/2008		DATE -	REVISED -			FED. ROAD DIST. NO. ILLINOIS FED. AID PROJECT				
SCALE: _____		SHEET NO. _____ OF _____ SHEETS		STA. _____ TO STA. _____						