

FAS RTE	SECTION	COUNTY	TOTAL SHEETS	SHEET NO.
253	68(BR, BR-1)	MARSHALL	97	68
STA. 170+15.00		TO STA. 171+00.00		
FED. ROAD DIST. NO.	ILLINOIS	FED. AID PROJECT		

DATE	BY

  

NO.	DATE	BY

DATE	BY

NO.	DATE	BY

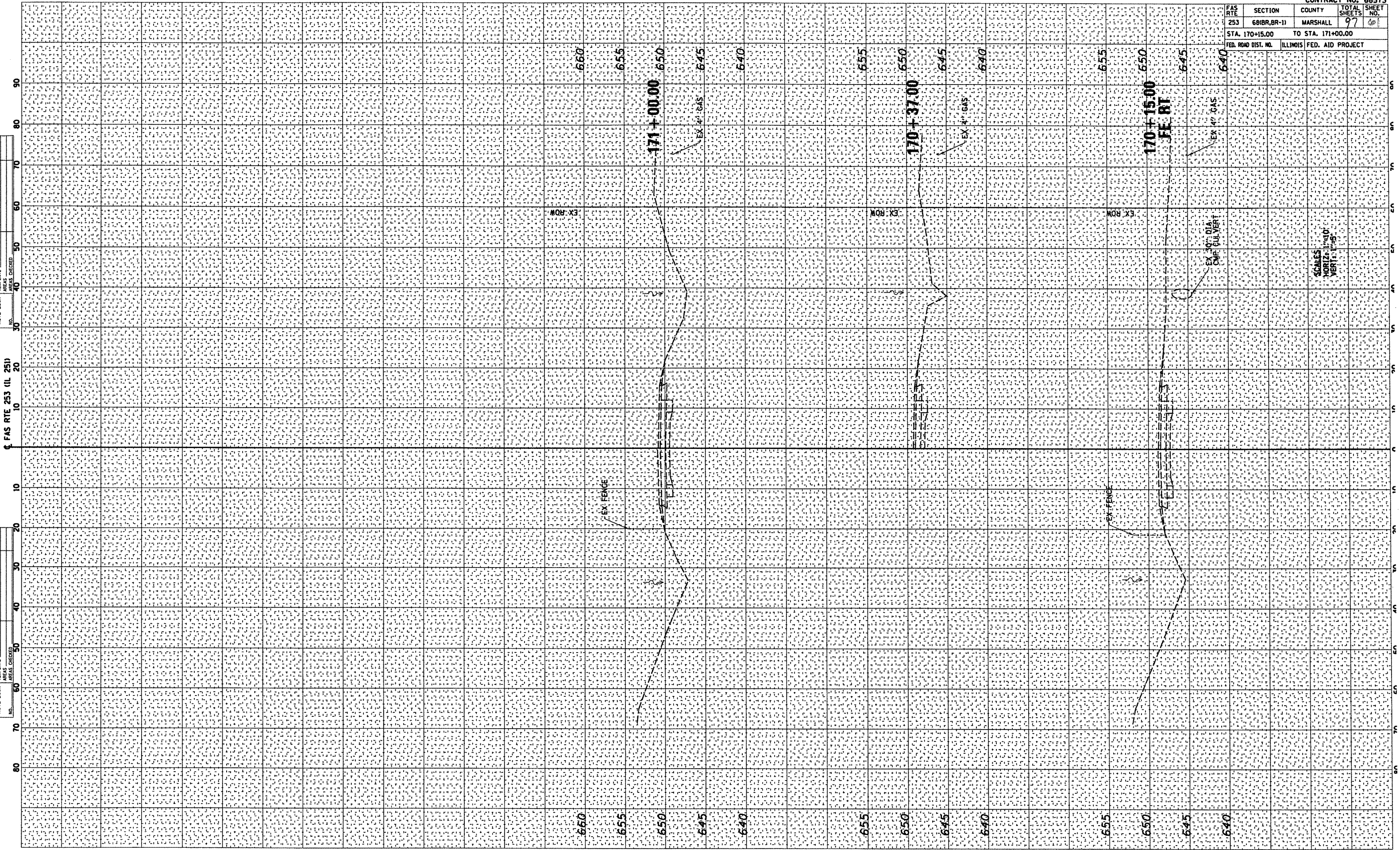

FAS RTE 253 (IL 251) CROSS SECTIONS  
STA 170+15.00 TO STA 171+00.00