

F.A.P. RTE.	SECTION	COUNTY	TOTAL SHEETS	SHEET NO.
313	(6BR-1)I	HENDERSON	14	1
FED. ROAD DIST. NO.	ILLINOIS	CONTRACT NO. 68849		

STATE OF ILLINOIS  
DEPARTMENT OF TRANSPORTATION  
DIVISION OF HIGHWAYS

**PROPOSED  
HIGHWAY PLANS**  
F.A.P. ROUTE 313  
US ROUTE 34  
SECTION (6BR-1)I  
PROJECT  
EMERGENCY BRIDGE BEAM REPLACEMENT  
HENDERSON COUNTY  
C-94-005-09

**INDEX OF SHEETS:**

- 1. COVER SHEET
- 2. COMMITMENTS & GENERAL NOTES
- 3-4. SUMMARY OF QUANTITIES
- 5. TYPICAL SECTION
- 6. SCHEDULE OF QUANTITIES
- 7-8. TRAFFIC CONTROL
- 9. WIDTH RESTRICTION SIGNING
- 10-14. REPAIR DETAILS

**STANDARDS:**

- 701001-02    701326-03
- 701006-03    701901-01
- 701201-03    704001-05
- 701321-10    780001-02

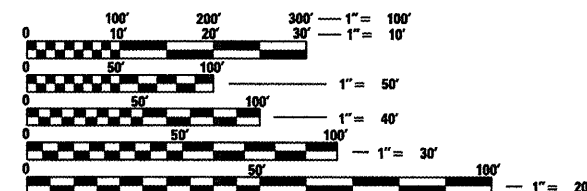

FULL SIZE PLANS HAVE BEEN PREPARED USING STANDARD ENGINEERING SCALES. REDUCED SIZED PLANS WILL NOT CONFORM TO STANDARD SCALES. IN MAKING MEASUREMENTS ON REDUCED PLANS, THE ABOVE SCALES MAY BE USED.

J.U.L.I.E.  
JOINT UTILITY LOCATION INFORMATION FOR EXCAVATION  
1-800-892-0123  
OR 811

PROJECT ENGINEER  
PROJECT MANAGER

CONTRACT NO. 68849

SN.036-0028

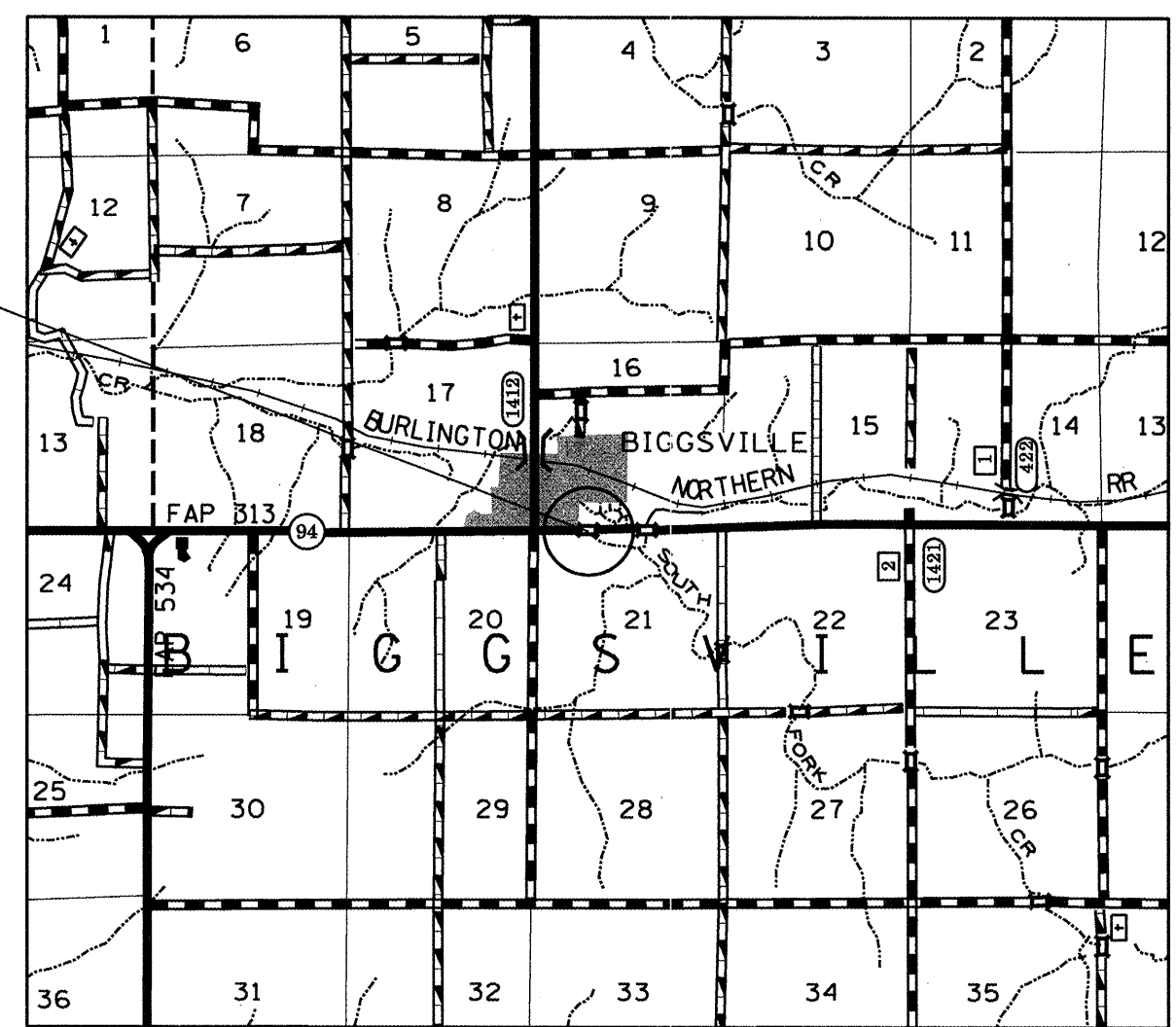

LOCATION MAP

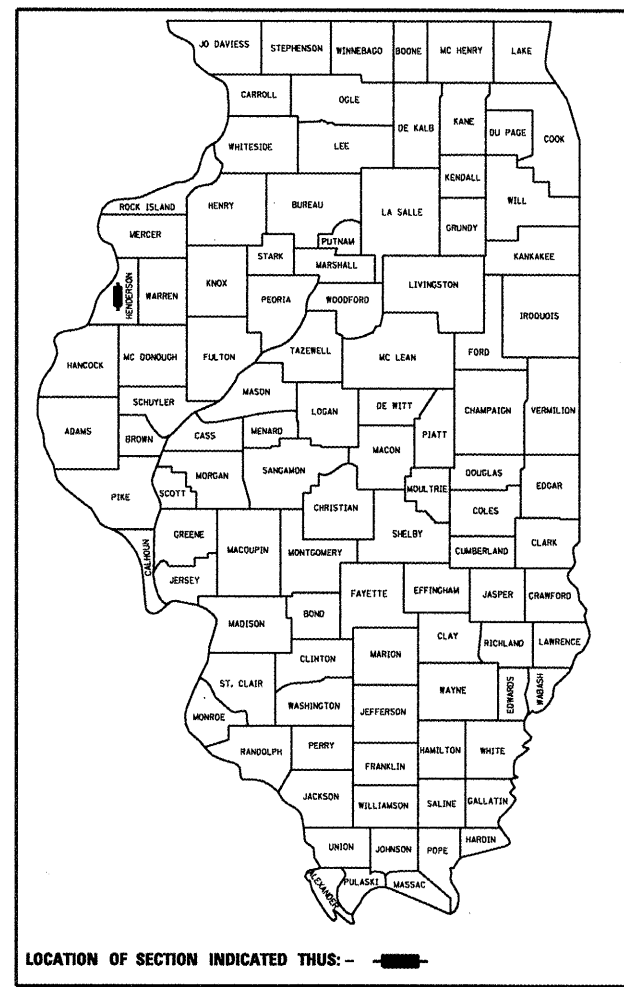

LOCATION OF SECTION INDICATED THUS: - [thick black line]

PROJECT CONSISTS OF EMERGENCY BEAM REPLACEMENT OF (12) PPC DECK BEAMS ON STRUCTURE CARRYING US. 34 OVER SOUTH HENDERSON CREEK (SN.036-0028), 0.3 MILES EAST OF IL. 94.

STATE OF ILLINOIS  
DEPARTMENT OF TRANSPORTATION  
DIVISION OF HIGHWAYS

SUBMITTED OCT 10 2008

*[Signature]*  
DEPUTY DIRECTOR OF HIGHWAYS, REGION ENGINEER

December 5, 2008  
*[Signature]*  
ENGINEER OF DESIGN AND ENVIRONMENT

December 5, 2008  
*[Signature]*  
DIRECTOR OF HIGHWAYS, CHIEF ENGINEER

PRINTED BY THE AUTHORITY  
OF THE STATE OF ILLINOIS