

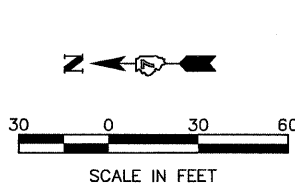

CONTRACT NO. 74107

FAP RTE	SECTION	COUNTY	TOTAL SHEETS	SHEET NO.
328	(6BR-1)B-1	CLAY	109	8
STA. 1409+00		TO STA. 1419+00		
FED. ROAD DIST. NO.		ILLINOIS	FED. AID PROJECT	



- LEGEND**
- TRAFFIC SIGNAL WITH BACKPLATE SIGNAL DIRECTION INDICATED
 - BASE COURSE WIDENING, 10"
 - PAVEMENT REMOVAL

SCHEDULE OF QUANTITIES

TEMPORARY CONCRETE BARRIER	STATION TO	STATION	FEET
	1412+24.25	1415+11.75	287.5
			TOTAL 287.5
TEMPORARY BRIDGE TRAFFIC SIGNALS	- 1 EACH		
TEMPORARY RUMBLE STRIPS	- 6 EACH		
IMPACT ATTENUATORS, TEMPORARY (NON-REDIRECTIVE), TEST LEVEL 3	- 2 EACH		

GENERAL NOTES

- TRAFFIC CONTROL SHALL BE ERECTED AS SHOWN AND ACCORDING TO "TRAFFIC CONTROL AND PROTECTION, STANDARD 701321."
- SEE SPECIAL PROVISIONS FOR ADDITIONAL TRAFFIC CONTROL REQUIREMENTS.
- COORDINATE LOCATION OF SIGNALS WITH FINAL WORK AS DIRECTED BY THE ENGINEER.
- CONSTRUCT TEMPORARY RUMBLE STRIPS AT LOCATIONS SHOWN ON STANDARD 701321.
- THE DIMENSION SHOWN ON THE WIDTH RESTRICTION SIGN (W12-1102(0)-48) SHOWN ON STANDARD 701321 SHALL BE 10'-9" FOR STAGE I CONSTRUCTION.

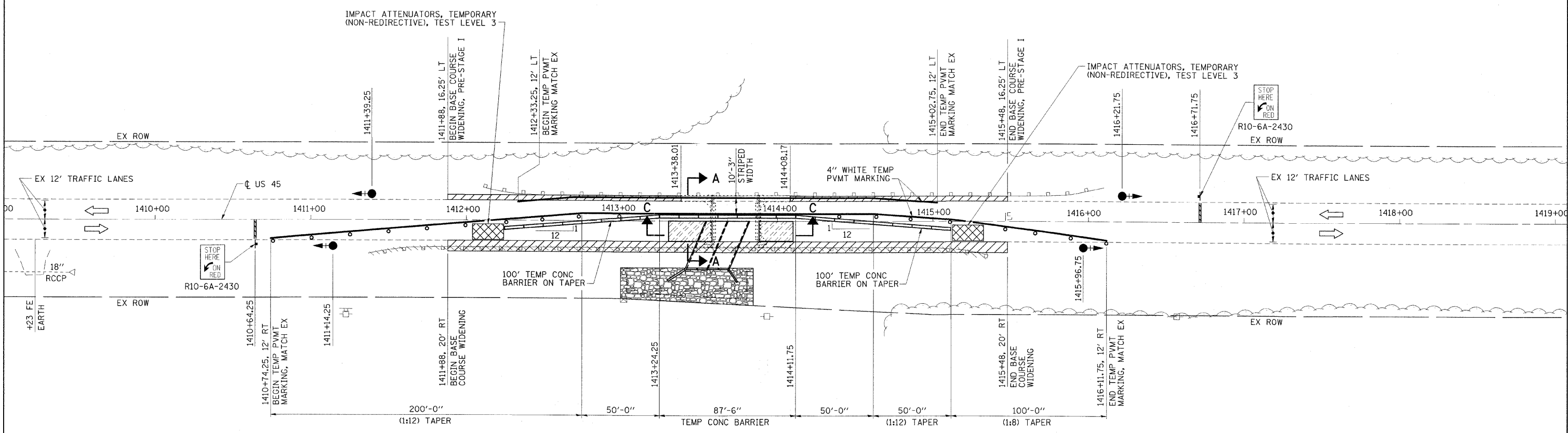

ESCA CONSULTANTS, INC.

DESIGNED BY:	JMS	05/08
DRAWN BY:	CJ	05/08
CHECKED BY:	MTD	05/08
APPROVED BY:	RDP	08/08

STAGE I CONSTRUCTION
 US 45 OVER GROVE CREEK
 FAP ROUTE 328 - SECTION (6BR-1)B-1
 CLAY COUNTY
 STATION 1413+68.00
 STRUCTURE NO. 013-2009

PLOT DATE =
 FILE NAME =
 PLOT SCALE =
 REFERENCE =