

STATE OF ILLINOIS
DEPARTMENT OF TRANSPORTATION

ROUTE NO. FAP 328	SECTION **	COUNTY CLAY	SHEETS 109	SHEET 38	SHEET NO. 2 6 SHEETS
FED. ROAD DIST. NO.		ILLINOIS	FED. AID PROJECT		Contract #74107
					**6BR-31B-1

STAGE CONSTRUCTION NOTES

- Hatched areas indicate Removal of Existing Structures.
- For details of Temporary Concrete Barrier, see Sht. No. 6 of 6.
- Removal of existing bridge rail is included with Removal of Existing Structures.
- All sections are looking South.

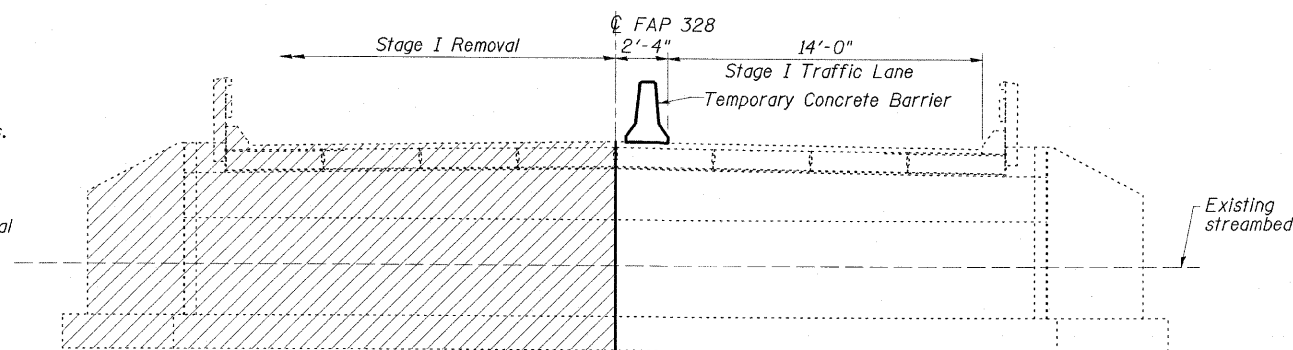

STAGE I REMOVAL

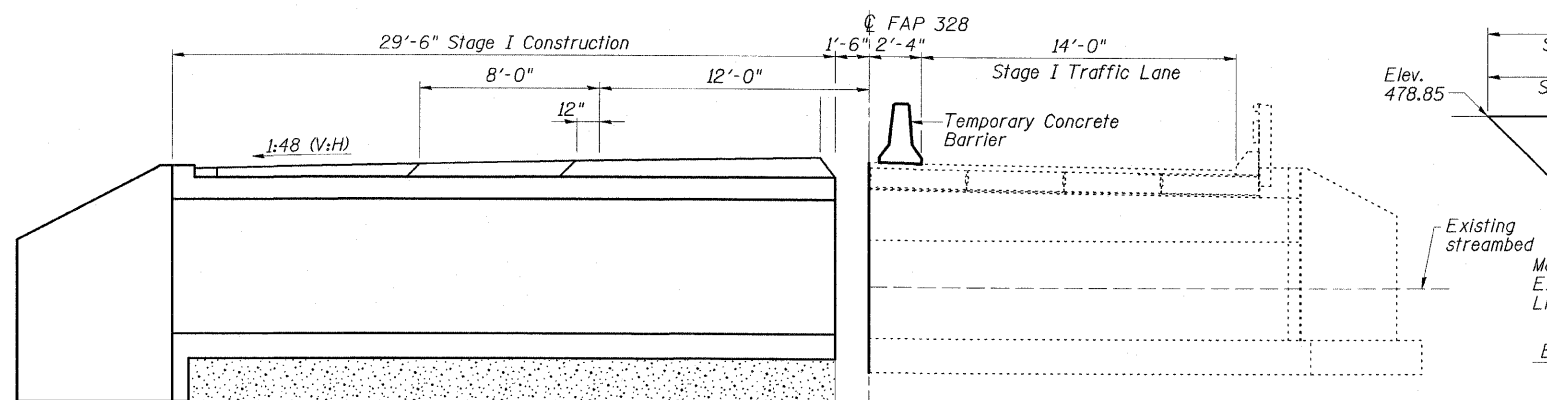

STAGE I CONSTRUCTION

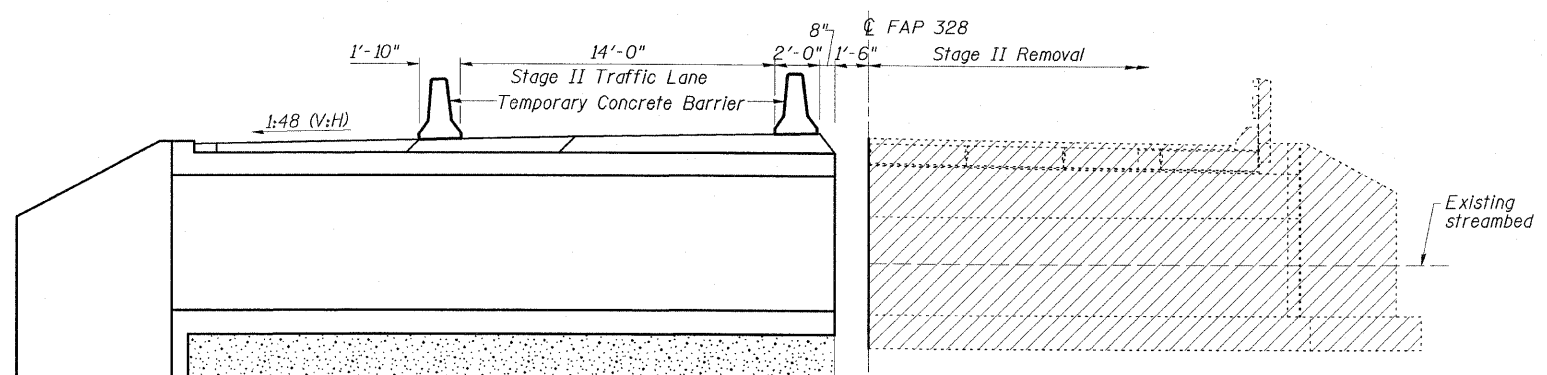

STAGE II REMOVAL

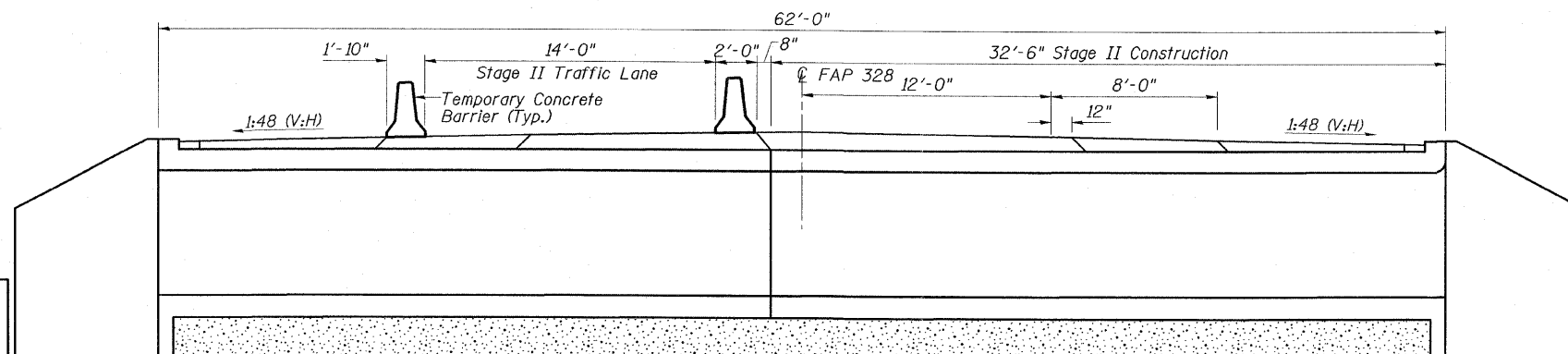

STAGE II CONSTRUCTION

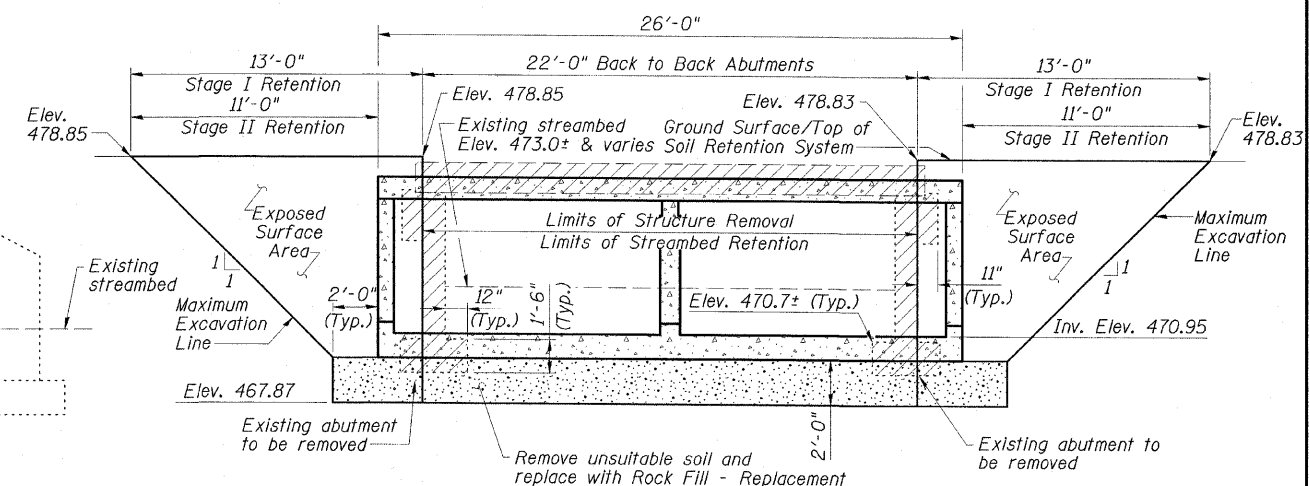

TEMPORARY SOIL RETENTION SYSTEM LIMITS

(Looking East)
Note: Dimensions along \bar{C} of FAP 328

TEMPORARY SOIL RETENTION SYSTEM NOTES

- Existing structure details are based on the best available information from existing bridge plans.
- A cantilevered sheet piling design does not appear feasible and additional members or other retention systems may be necessary. The Contractor shall submit a temporary soil retention system design including plan details and calculations for review and acceptance by the Engineer.

ESCA
CONSULTANTS, INC.

DESIGNED BY:	FMA	03/08
DRAWN BY:	CJ	03/08
CHECKED BY:	ELH	05/08
APPROVED BY:	RDP	08/08

STAGE CONSTRUCTION DETAILS
US 45 OVER BRANCH OF ELM CREEK
FAP ROUTE 328 - SECTION (6BR-3)B-1
CLAY COUNTY
STATION 1638+03.20
STRUCTURE NO. 013-2010