

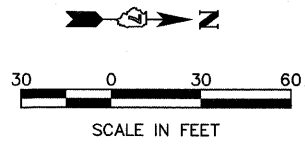

CONTRACT NO. 74107

FAP RTE	SECTION	COUNTY	TOTAL SHEETS	SHEET NO.
328		CLAY	109	61
STA. 963+00		TO STA. 972+00		
FED. ROAD DIST. NO.		ILLINOIS FED. AID PROJECT		
*18BR-3, 8BR-4/B-1				



**LEGEND**

- TRAFFIC SIGNAL WITH BACKPLATE, SIGNAL DIRECTION INDICATED
- TEMPORARY RAMP
- PAVEMENT REMOVAL
- BASE COURSE WIDENING, 10"
- HMA SHOULDER

**SCHEDULE OF QUANTITIES**

RELOCATE TEMPORARY CONCRETE BARRIER		
STATION TO	STATION	FEET
964+65	970+65	600
		TOTAL 600

IMPACT ATTENUATORS, RELOCATE (NON-REDIRECTIVE), TEST LEVEL 3 - 2 EACH		
TOTAL 600		

**GENERAL NOTES**

- TRAFFIC CONTROL SHALL BE ERECTED AS SHOWN AND ACCORDING TO "TRAFFIC CONTROL AND PROTECTION, STANDARD 701321."
- SEE SPECIAL PROVISIONS FOR ADDITIONAL TRAFFIC CONTROL REQUIREMENTS.
- COORDINATE LOCATION OF SIGNALS WITH FINAL WORK AS DIRECTED BY THE ENGINEER.
- CONSTRUCT TEMPORARY RUMBLE STRIPS AT LOCATIONS SHOWN ON STANDARD 701321.
- THE DIMENSION SHOWN ON THE WIDTH RESTRICTION SIGN (W12-1102(0)-48) SHOWN ON STANDARD 701321 SHALL BE 14'-6" FOR STAGE II CONSTRUCTION.

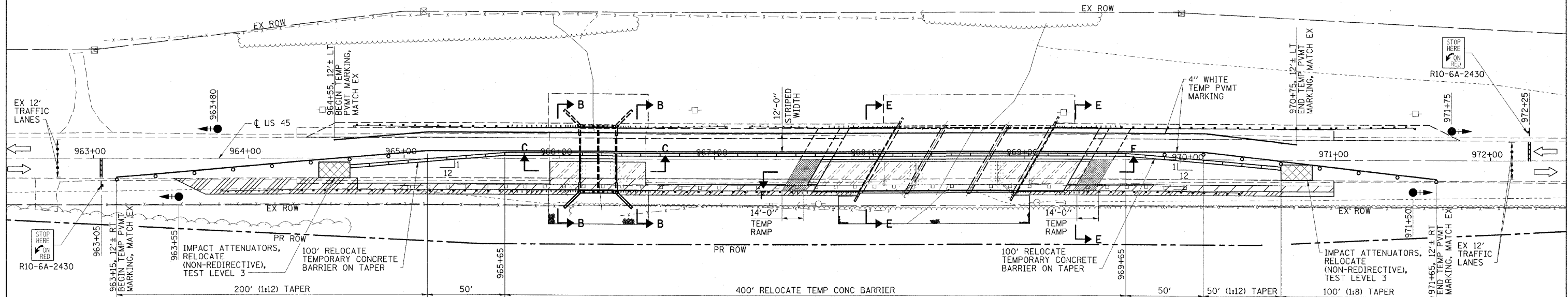

**ESCA**  
CONSULTANTS, INC.

DESIGNED BY:	DAJ	03/08
DRAWN BY:	HAS	03/08
CHECKED BY:	MTD	05/08
APPROVED BY:	RDP	08/08

STAGE II CONSTRUCTION  
US 45 OVER SEMINARY CREEK & OVERFLOW  
FAP ROUTE 328 - SECTIONS (8BR-3, 8BR-4)B-1  
CLAY COUNTY