

STATE OF ILLINOIS
DEPARTMENT OF TRANSPORTATION
DIVISION OF HIGHWAYS
PROPOSED
HIGHWAY PLANS

F.A.P. RTE.	SECTION	COUNTY	TOTAL SHEETS	SHEET NO.
91	(5,4)RS-3	COLES	79	1
FED. ROAD DIST. NO.	ILLINOIS	CONTRACT NO. 74318		

FOR INDEX OF SHEETS, SEE SHEET NO. 2

STATION EQUATION:
 STA 196+97BK=STA 191+40AH

PAVING OMISSIONS:
 STA 153+64 TO STA 156+54

FAP ROUTE 91 (IL 16)
SECTION (5,4)RS-3
PROJECT: F-0091(069)
BITUMINOUS RESURFACING
COLES COUNTY

C-97-081-08

2007 ADT = 5,800

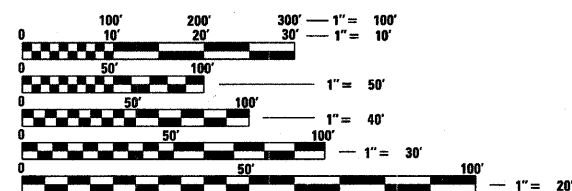

FULL SIZE PLANS HAVE BEEN PREPARED USING STANDARD ENGINEERING SCALES. REDUCED SIZED PLANS WILL NOT CONFORM TO STANDARD SCALES. IN MAKING MEASUREMENTS ON REDUCED PLANS, THE ABOVE SCALES MAY BE USED.

J.U.L.I.E.
 JOINT UTILITY LOCATION INFORMATION FOR EXCAVATION
 1-800-892-0123
 OR 811

PROJECT ENGINEER: MARK DAUGHERTY
PROJECT MANAGER: BRIAN J. BIERMAN

CONTRACT NO. 74318

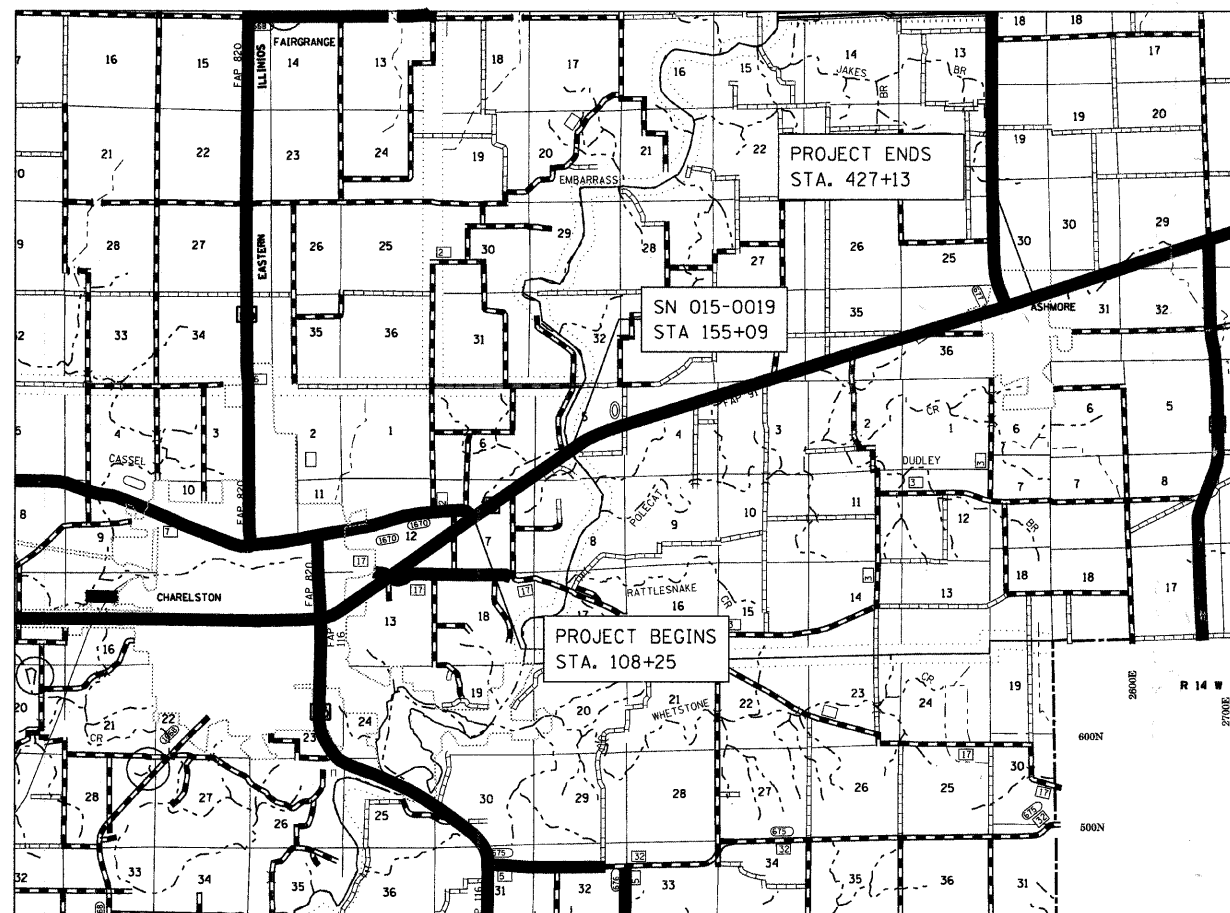

GROSS LENGTH = 32,445 FT. = 6.14 MILE
 NET LENGTH = 32,155 FT. = 6.09 MILE



STATE OF ILLINOIS
 DEPARTMENT OF TRANSPORTATION
 DIVISION OF HIGHWAYS

SUBMITTED October 21 20 08

Roger K. Dickells
 DEPUTY DIRECTOR OF HIGHWAYS, REGION ENGINEER

December 5, 20 08
Eric E. Haran
 INTERIM ENGINEER OF DESIGN AND ENVIRONMENT

December 5, 20 08
Christine M. Reed
 DIRECTOR OF HIGHWAYS, CHIEF ENGINEER

PRINTED BY THE AUTHORITY
OF THE STATE OF ILLINOIS