

**GENERAL NOTES**

1. ALL WORK & MATERIAL INVOLVED IN SPLICING THE NEW CONDUIT TO EXISTING FOUNDATIONS & HANDHOLES SHALL BE INCLUDED IN THE COST OF CONDUIT.
2. MATCH EXISTING GROUND ELEVATIONS FOR PROPOSED HANDHOLES, GULFBXES, AND FOUNDATIONS.
3. ALL EXISTING CONDUIT TO BE ABANDONED IN PLACE.
4. ALIGNMENTS AND STATIONING ARE FOR REFERENCE ONLY. ALL STATIONS AND OFFSETS ARE BASED ON IL 149.
5. THE ANCHOR BOLTS SHALL BE CUT OFF AND THE CONDUIT SHALL BE SEALED ON THE FOUNDATION IN THE SW ISLAND.
6. COAXIAL CABLE IN CONDUIT, 73' FROM RELOCATED CABINET TO EXISTING ANTENNA ON MAST ARM IN NW QUADRANT.
7. ALL RELOCATED SIGNAL POSTS SHALL BE LOCATED NO CLOSER THAN 6 FT. FROM FACE OF CURB TO CENTER OF POLE.

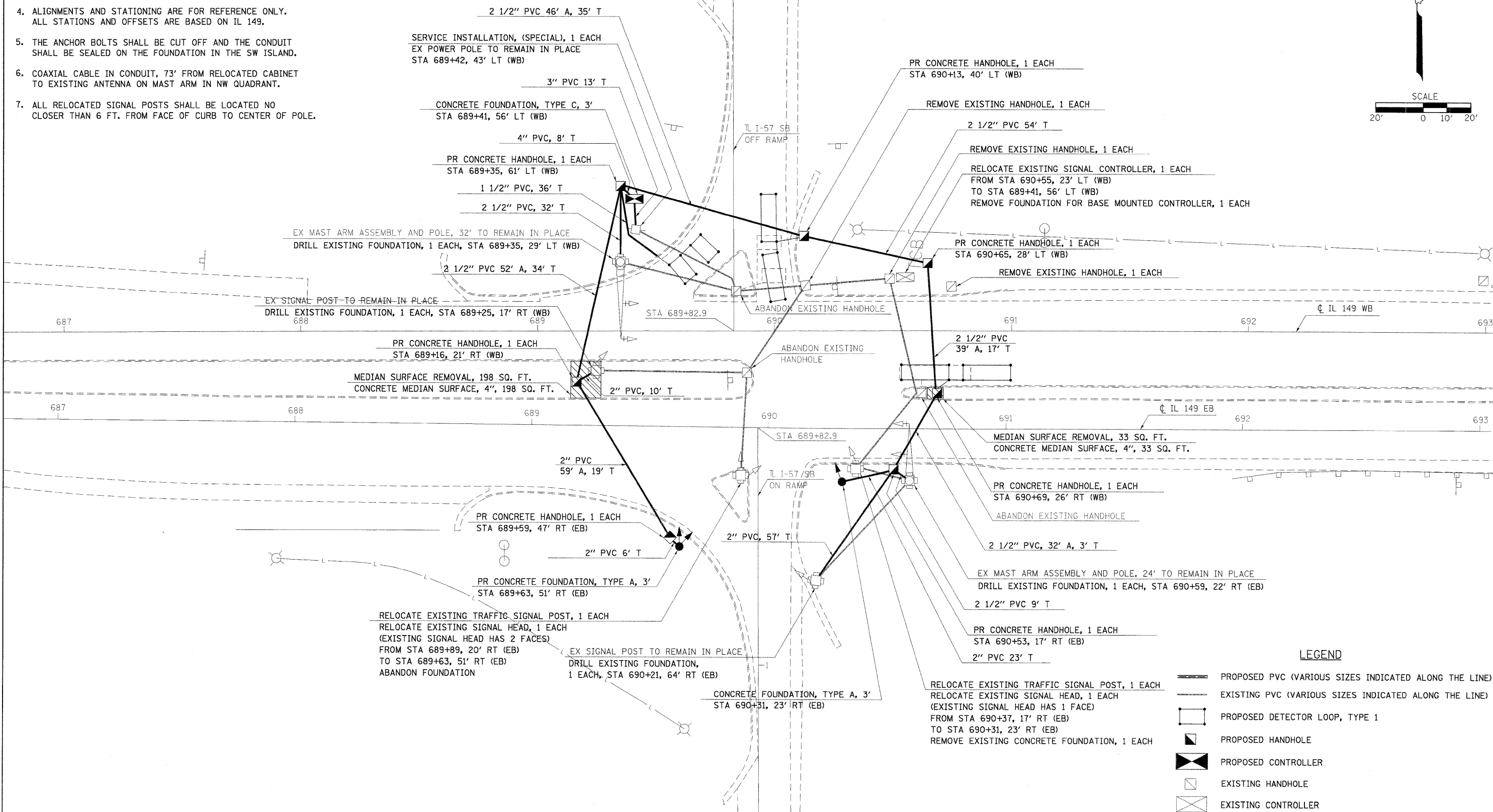
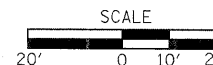

**LEGEND**

- PROPOSED PVC (VARIOUS SIZES INDICATED ALONG THE LINE)
- EXISTING PVC (VARIOUS SIZES INDICATED ALONG THE LINE)
- PROPOSED DETECTOR LOOP, TYPE 1
- PROPOSED HANDHOLE
- PROPOSED CONTROLLER
- EXISTING HANDHOLE
- EXISTING CONTROLLER

FILE NAME = c:\projects\78076\978076-shs.dgn	USER NAME = carlsonej	DESIGNED -	REVISED -	<b>STATE OF ILLINOIS DEPARTMENT OF TRANSPORTATION</b>	<b>TRAFFIC SIGNAL PLAN SB I-57 RAMPS AND ILLINOIS 149</b>	F.A.P RTE.	SECTION	COUNTY	TOTAL SHEETS	SHEET NO.
PLOT SCALE = 20.0000' / IN.	CHECKED -	REVISED -	873			(28-5)TS-4	FRANKLIN	6	4	
PLOT DATE = 9/2/2008	DATE -	REVISED -	CONTRACT NO. 78076							

SCALE: 1"=20'    SHEET NO.    OF    SHEETS    STA.    TO STA.