

F.A.P. RTE.	SECTION	COUNTY	TOTAL SHEETS	SHEET NO.
873	(28-5)TS-4	FRANKLIN	6	1
FED. ROAD DIST. NO.	ILLINOIS	CONTRACT NO. 78076		

STATE OF ILLINOIS
DEPARTMENT OF TRANSPORTATION
DIVISION OF HIGHWAYS

PROPOSED
HIGHWAY PLANS

FAP ROUTE 873 (IL 149)
SECTION (28-5)TS-4

SIGNAL MODIFICATIONS
FRANKLIN COUNTY
C-99-062-08

FOR INDEX OF SHEETS, SEE SHEET NO. 2
FOR SUMMARY OF QUANTITIES, SEE SHEET NO. 3

APPROACH	ADT (2008)	% TRUCKS
IL 149 AND I-57 SB RAMPS	16,000	9%

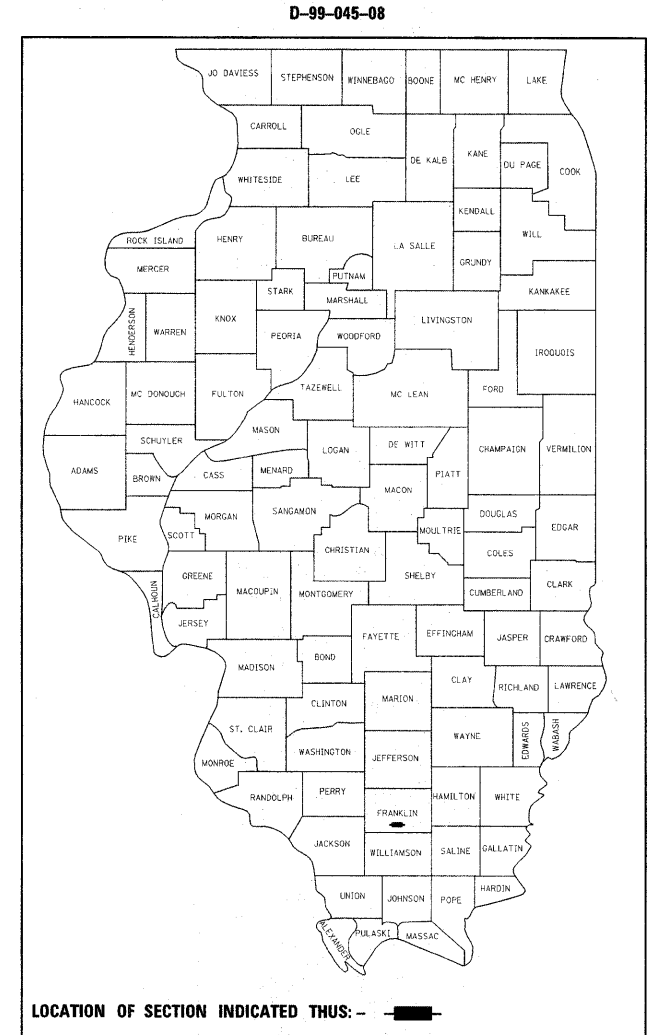

PROJECT LOCATION
 FAP (873) IL 149 & I-57
 SB RAMPS IN WEST FRANKFORT

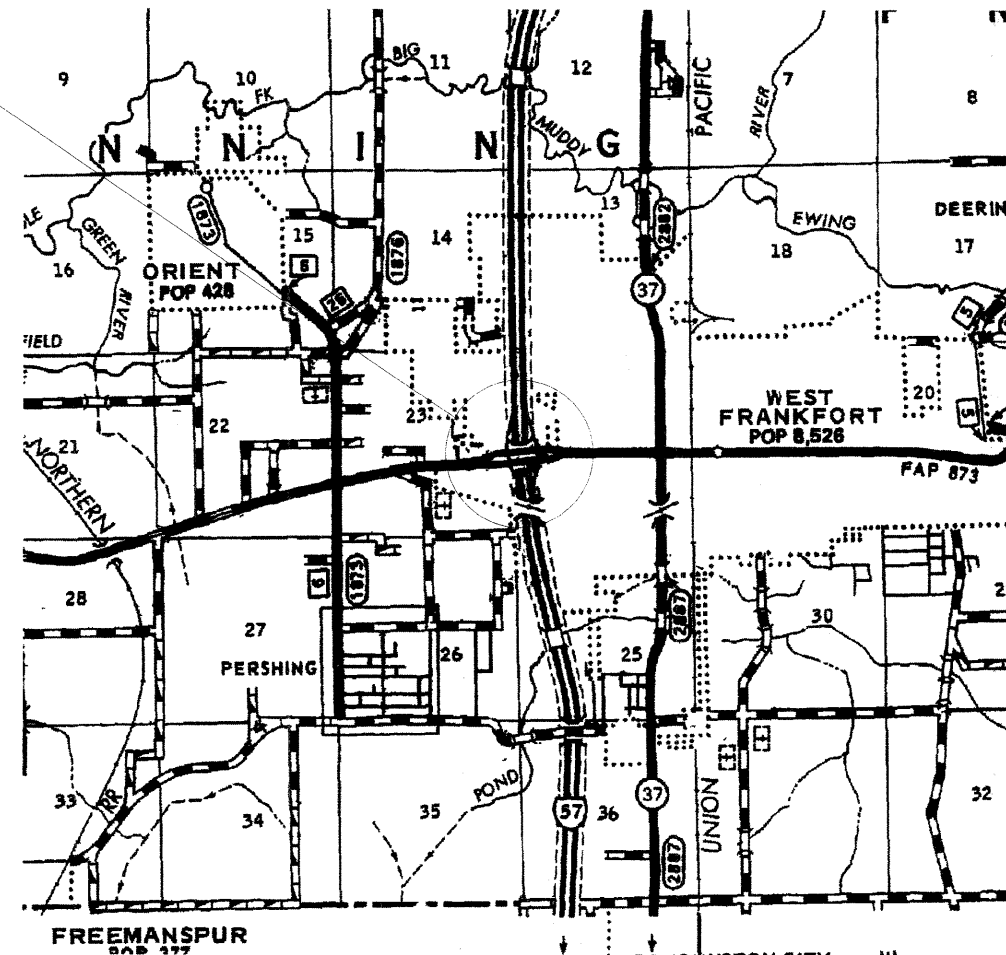

DENNING TOWNSHIP

FULL SIZE PLANS HAVE BEEN PREPARED USING STANDARD ENGINEERING SCALES. REDUCED SIZED PLANS WILL NOT CONFORM TO STANDARD SCALES. IN MAKING MEASUREMENTS ON REDUCED PLANS, THE ABOVE SCALES MAY BE USED.

J.U.L.I.E.
 JOINT UTILITY LOCATION INFORMATION FOR EXCAVATION
 1-800-892-0123
 OR 811

PROJECT ENGINEER ERIC CARLSON
PROJECT MANAGER SUSAN POE

CONTRACT NO. 78076

GROSS LENGTH = 200 FT. = 0.004 MILE
 NET LENGTH = 200 FT. = 0.004 MILE

STATE OF ILLINOIS
 DEPARTMENT OF TRANSPORTATION
 DIVISION OF HIGHWAYS

SUBMITTED Sept 9 20 08
May C. Lami
 DEPUTY DIRECTOR OF HIGHWAYS, REGION ENGINEER

December 5, 20 08
Eric F. Abner
 INTERIM ENGINEER OF DESIGN AND ENVIRONMENT

December 5, 20 08
Christine M. Reed
 DIRECTOR OF HIGHWAYS, CHIEF ENGINEER

PRINTED BY THE AUTHORITY
OF THE STATE OF ILLINOIS

GENERAL NOTES

THE FURNISHING AND INSTALLATION OF THE 1 1/2" CONDUIT WITH ITS TRENCHING AND BACKFILL FROM THE LOOP SAWCUT TO THE SPLICE POINT SHALL BE INCLUDED IN THE LOOP INSTALLATION UNLESS SHOWN OTHERWISE ON THE PLANS.

THE INDUCTION LOOP WIRE AND LEAD-IN WIRE SHALL BE INSTALLED IN ACCORDANCE WITH THE MANUFACTURER'S RECOMMENDATION.

SHIELDED CABLE TO LOOP LEADS SHALL BE GROUNDED AT THE CONTROLLER TERMINAL ONLY.

ALL DETECTOR LOOP CORNERS SHALL BE CORE DRILLED 2 IN. MINIMUM DIAMETER.

SAWED SLOTS FOR TWISTED PAIR ELECTRIC CABLES SHALL BE LARGER THAN SINGLE CONDUCTOR LOOP SLOTS.

EXISTING SURFACE DISTURBED DURING EXCAVATION FOR FOUNDATIONS AND PUSH PITS SHALL BE RESTORED TO THE LIMITS AND CONDITIONS SPECIFIED BY THE ENGINEER OR AS SHOWN ON THE PLANS. UNLESS OTHERWISE NOTED ON THE PLANS THE REMOVAL AND RESTORATION SHALL BE INCLUDED IN THE CONTRACT.

CABLE QUANTITIES ARE MEASURED IN PLAN VIEW.

THE FINAL LOCATION OF THE DETECTOR LOOPS AND HANDHOLES MAY BE ADJUSTED TO FIT FIELD CONDITIONS AS DIRECTED BY THE ENGINEER OF TRAFFIC OPERATIONS.

THE CONTRACTOR SHALL NOTIFY THE IDOT ENGINEER OF TRAFFIC OPERATIONS 72 HOURS PRIOR TO THE SHUT-DOWN OR CUTTING OF EXISTING DETECTOR LOOPS.

THE NEW LOOP SHALL ENTER THE HANDHOLE THROUGH THE EXISTING LOOP CONDUIT IN THE CURB AND GUTTER.

INDEX OF SHEETS

SHT NO	DESCRIPTION
1	COVER SHEET
2	GENERAL NOTES, INDEX OF SHEETS, STANDARDS
3	SUMMARY OF QUANTITIES
4	TRAFFIC SIGNAL PLAN - SB I-57 RAMPS AND IL 149
5	DETAILS: WIRING DIAGRAM - SB I-57 RAMPS AND IL 149
6	DETAILS: DETECTOR LOOPS

STANDARDS

000001-05	STANDARD SYMBOLS, ABBREVIATIONS, AND PATTERNS
001006	DECIMAL OF AN INCH AND OF A FOOT
701001-02	OFF-ROAD OPERATIONS 2L, 2W, MORE THAN 15' AWAY
701006-03	OFF-ROAD OPERATIONS 2L, 2W, 15' TO 24" FROM PAVEMENT EDGE
701101-02	OFF-ROAD OPERATIONS, MULTILANE, 15' TO 24" FROM PAVEMENT EDGE
701106-02	OFF-ROAD OPERATIONS, MULTILANE, MORE THAN 15' AWAY
701701-06	URBAN LANE CLOSURE, MULTILANE INTERSECTION
701901-01	TRAFFIC CONTROL DEVICES
814001-02	CONCRETE HANDHOLES
857001-01	STANDARD PHASE DESIGNATION DIAGRAMS AND PHASE SEQUENCES
878001-07	CONCRETE FOUNDATION DETAILS
886001-01	DETECTOR LOOP INSTALLATIONS
886006-01	TYPICAL LAYOUT FOR DETECTION LOOPS

Prepared By: *[Signature]*
DISTRICT STUDY PLANS ENGINEER

Examined By: *[Signature]*
DISTRICT LAND ACQUISITION ENGINEER

Examined By: *[Signature]*
DISTRICT PROGRAM DEVELOPMENT ENGINEER

Examined By: *[Signature]*
DISTRICT OPERATIONS ENGINEER

Examined By: *[Signature]*
DISTRICT CONSTRUCTION ENGINEER

Examined By: *[Signature]*
DISTRICT MATERIALS ENGINEER

Examined By: *[Signature]*
DISTRICT PROJECT IMPLEMENTATION ENGINEER

Approved By: *[Signature]*
ASSISTANT REGIONAL ENGINEER

Approved By: *[Signature]*
DEPUTY DIRECTOR OF HIGHWAYS, REGION ENGINEER

DATE: *Sept 9* 20 *08*

FILE NAME =	USER NAME = carlsonej	DESIGNED -	REVISED -	STATE OF ILLINOIS DEPARTMENT OF TRANSPORTATION	GENERAL NOTES, INDEX OF SHEETS AND STANDARDS	F.A.P RTE.	SECTION	COUNTY	TOTAL SHEETS	SHEET NO.
c:\projects\78076\j978076-shs.dgn		DRAWN -	REVISED -			873	(28-5)TS-4	FRANKLIN	6	2
	PLOT SCALE = 50.0000' / 1"	CHECKED -	REVISED -							
	PLOT DATE = 7/22/2008	DATE -	REVISED -							
						SCALE:	SHEET NO. OF SHEETS	STA.	TO STA.	CONTRACT NO. 78076
						FED. ROAD DIST. NO.	ILLINOIS	FED. AID PROJECT		

SUMMARY OF QUANTITIES

CODE NUMBER	ITEM	URBAN CONSTRUCTION TYPE CODE Y031-1/F 100 % STATE	
		UNIT	TOTAL QUANTITIES
44003800	MEDIAN SURFACE REMOVAL	SQ FT	231
60618300	CONCRETE MEDIAN SURFACE , 4 INCH	SQ FT	231
67100100	MOBILIZATION	L SUM	1
70102635	TRAFFIC CONTROL AND PROTECTION, STANDARD 701701	L SUM	1
80300100	LOCATING UNDERGROUND CABLE	FOOT	10
80501000	SERVICE INSTALLATION (SPECIAL)	EACH	1
81012500	CONDUIT IN TRENCH, 1 1/2" DIA., PVC	FOOT	36
81012600	CONDUIT IN TRENCH, 2" DIA., PVC	FOOT	115
81012700	CONDUIT IN TRENCH, 2 1/2" DIA., PVC	FOOT	184
81012800	CONDUIT IN TRENCH, 3" DIA., PVC	FOOT	13
81013000	CONDUIT IN TRENCH, 4" DIA., PVC	FOOT	8
81021550	CONDUIT, AUGURED, 2" DIA., PVC	FOOT	59
81021560	CONDUIT, AUGURED, 2 1/2" DIA., PVC	FOOT	169
81400100	HANDHOLE	EACH	7
81900200	TRENCH AND BACKFILL FOR ELECTRICAL WORK	FOOT	356
87301245	ELECTRIC CABLE IN CONDUIT, SIGNAL NO. 14 5/C	FOOT	1295
87301255	ELECTRIC CABLE IN CONDUIT, SIGNAL NO. 14 7/C	FOOT	279
87301305	ELECTRIC CABLE IN CONDUIT, LEAD-IN, NO. 14 1 PAIR	FOOT	387
87301855	ELECTRIC CABLE IN CONDUIT, SERVICE, NO. 8 2C	FOOT	22
87800100	CONCRETE FOUNDATION, TYPE A	FOOT	6
87800150	CONCRETE FOUNDATION, TYPE C	FOOT	3
87900100	DRILL EXISTING FOUNDATION	EACH	4
88500100	INDUCTIVE LOOP DETECTOR	EACH	3
88600100	DETECTOR LOOP, TYPE I	FOOT	305
89500100	RELOCATE EXISTING SIGNAL HEAD	EACH	2
89501100	RELOCATE EXISTING TRAFFIC SIGNAL CONTROLLER	EACH	1
89501150	RELOCATE EXISTING TRAFFIC SIGNAL POST	EACH	2
89502380	REMOVE EXISTING HANDHOLE	EACH	3
89502385	RELOCATE EXISTING CONCRETE FOUNDATION	EACH	1
X0301576	COAXIAL CABLE IN CONDUIT	FOOT	73
X0324523	REMOVE FOUNDATION FOR BASE MOUNTED CONTROLLER	EACH	1

GENERAL NOTES

1. ALL WORK & MATERIAL INVOLVED IN SPLICING THE NEW CONDUIT TO EXISTING FOUNDATIONS & HANDHOLES SHALL BE INCLUDED IN THE COST OF CONDUIT.
2. MATCH EXISTING GROUND ELEVATIONS FOR PROPOSED HANDHOLES, GULFBXES, AND FOUNDATIONS.
3. ALL EXISTING CONDUIT TO BE ABANDONED IN PLACE.
4. ALIGNMENTS AND STATIONING ARE FOR REFERENCE ONLY. ALL STATIONS AND OFFSETS ARE BASED ON IL 149.
5. THE ANCHOR BOLTS SHALL BE CUT OFF AND THE CONDUIT SHALL BE SEALED ON THE FOUNDATION IN THE SW ISLAND.
6. COAXIAL CABLE IN CONDUIT, 73' FROM RELOCATED CABINET TO EXISTING ANTENNA ON MAST ARM IN NW QUADRANT.
7. ALL RELOCATED SIGNAL POSTS SHALL BE LOCATED NO CLOSER THAN 6 FT. FROM FACE OF CURB TO CENTER OF POLE.

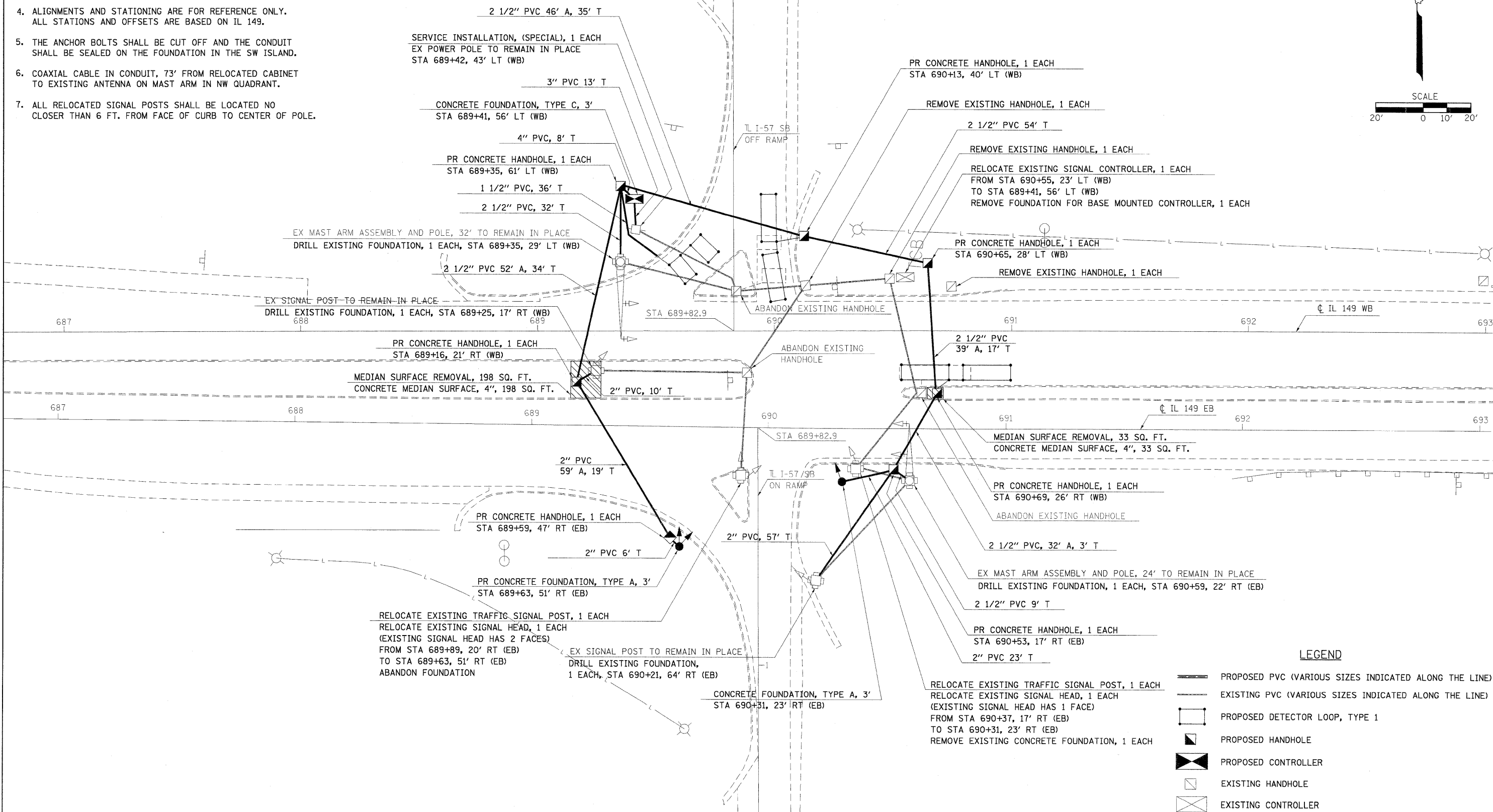

LEGEND

- PROPOSED PVC (VARIOUS SIZES INDICATED ALONG THE LINE)
- EXISTING PVC (VARIOUS SIZES INDICATED ALONG THE LINE)
- PROPOSED DETECTOR LOOP, TYPE 1
- PROPOSED HANDHOLE
- PROPOSED CONTROLLER
- EXISTING HANDHOLE
- EXISTING CONTROLLER

FILE NAME = c:\projects\78076\978076-shs.dgn	USER NAME = carlsonej	DESIGNED -	REVISED -	STATE OF ILLINOIS DEPARTMENT OF TRANSPORTATION	TRAFFIC SIGNAL PLAN SB I-57 RAMPS AND ILLINOIS 149	F.A.P. RTE. 873	SECTION (28-5)TS-4	COUNTY FRANKLIN	TOTAL SHEETS 6	SHEET NO. 4	
PLOT SCALE = 20.0000' / IN.	CHECKED -	REVISED -	SCALE: 1"=20'			SHEET NO. OF SHEETS	STA. TO STA.	CONTRACT NO. 78076			
PLOT DATE = 9/2/2008	DATE -	REVISED -					ILLINOIS FED. AID PROJECT				

LEGEND

- ☒ PROPOSED TRAFFIC SIGNAL CONTROLLER CABINET
- ☐ EX SERVICE INSTALLATION, TYPE "A" TO REMAIN IN PLACE
- ☐ INDICATES EX TERMINAL BLOCK ON MAST ARM POLE
- 8a INDICATES 6' X 20' DETECTOR LOOP WITH 2" CORE DRILLED CORNERS. NUMBER INDICATES PHASE, LOWER CASE LETTER INDICATES AMPLIFIER
- 8b INDICATES 6' X 10' DETECTOR LOOP WITH 2" CORE DRILLED CORNERS. NUMBER INDICATES PHASE, LOWER CASE LETTER INDICATES AMPLIFIER
- ② INDICATES 2/C TWISTED, SHIELDED CABLE IN CONDUIT
- ② NUMBER IN CIRCLE INDICATES NUMBER OF CONDUCTORS IN THAT CABLE
- (3) NUMBER IN PARENTHESIS INDICATES PHASE
- 1a NUMBER INDICATES PHASE; LETTER OR LETTERS IDENTIFY AMPLIFIER

NOTES:

1. ALL CABLES SHALL BE A.W.G. #14 UNLESS OTHERWISE NOTED.

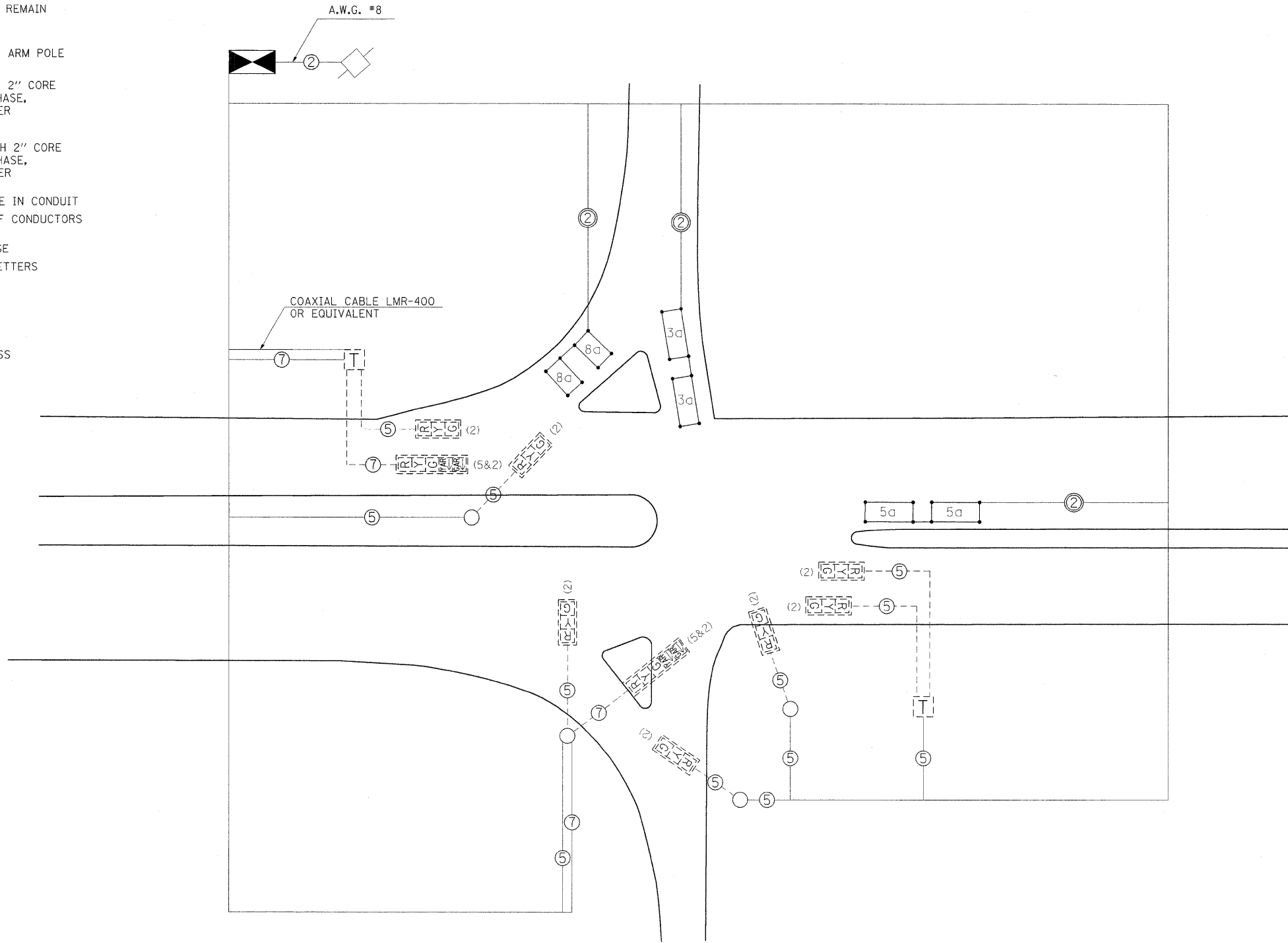

FILE NAME = c:\projects\78076\978076-shs.dgn	USER NAME = carlsonej	DESIGNED -	REVISED -	STATE OF ILLINOIS DEPARTMENT OF TRANSPORTATION	TRAFFIC SIGNAL CABLE DIAGRAM & WIRING DIAGRAM FOR ROADWAY LIGHTING	F.A.P. RTE. 873	SECTION (28-5)TS-4	COUNTY FRANKLIN	TOTAL SHEETS 6	SHEET NO. 5
PLOT SCALE = 20.0000' / IN.	CHECKED -	REVISIED -	REVISIED -	SCALE: 1"=20' SHEET NO. OF SHEETS STA. TO STA.		FED. ROAD DIST. NO. ILLINOIS FED. AID PROJECT		CONTRACT NO. 78076		
PLOT DATE = 9/2/2008	DATE -	REVISIED -	REVISIED -							

DETAIL OF DETECTOR LOOPS

NOTES

(APPLIES TO 6' x 6' LOOPS ONLY)

1. THE DETECTOR LOOPS SHALL BE TYPE I. EACH DETECTOR LOOP SHALL HAVE 3 TURNS OF LOOP WIRE AND BE INSTALLED IN ACCORDANCE WITH THE APPLICABLE PORTIONS OF SECTION 886 OF THE STANDARD SPECIFICATIONS FOR TRAFFIC CONTROL ITEMS.
2. BEGINNING LEAD WIRES SHALL BE CONNECTED TO THE BLACK LEAD AND THE ENDING LEAD WIRES SHALL BE CONNECTED TO THE WHITE LEAD OF THE TWIN TWISTED FEED CABLES AT THE SPLICE POINT.
3. WHERE THE LOOPS ARE INSTALLED PRIOR TO RESURFACING, THE LOOP CORNERS SHALL BE DIAGONALLY CUT.

LOOP LEGEND

- CLOCKWISE ROTATION FOR LOOP WIRES
- S** INDICATES SPLICE POINT FOR DETECTOR LOOP LEAD
- INDICATES 2" CORE-DRILL

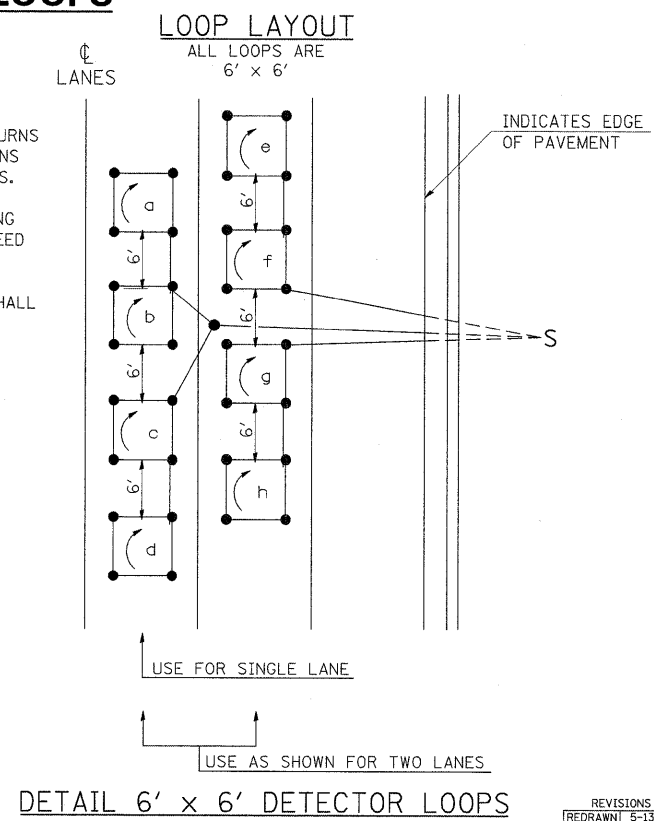

REVISIONS	
REDRAWN	5-13-02
REVISED	10-27-05
REVISED	
REVISED	

STD. 9-92

FILE NAME =
c:\projects\78076\d978076-shs.dgn

USER NAME = carlsonaj
PLOT SCALE = 50.0000' / IN.
PLOT DATE = 9/2/2008

DESIGNED -
DRAWN -
CHECKED -
DATE -

REVISED -
REVISED -
REVISED -
REVISED -

**STATE OF ILLINOIS
DEPARTMENT OF TRANSPORTATION**

DETAILS: DETECTOR LOOPS

SCALE: SHEET NO. OF SHEETS STA. TO STA.

F.A.P. RTE.	SECTION	COUNTY	TOTAL SHEETS	SHEET NO.
873	(28-5)TS-4	FRANKLIN	6	6
FED. ROAD DIST. NO. ILLINOIS FED. AID PROJECT			CONTRACT NO. 78076	