

**STATE OF ILLINOIS
DEPARTMENT OF TRANSPORTATION
DIVISION OF HIGHWAYS**

**PLANS FOR PROPOSED
HIGHWAY BRIDGE PROGRAM
FAU ROUTE 5208 (ORTH ROAD)
over UNNAMED BRANCH OF BEAVER CREEK**

**SECTION 07-00081-00-BR
BOONE COUNTY
PROJECT BRM-5099(078)
JOB # C-92-060-08**

PROJECT LOCATION



INDEX OF SHEETS

1. TITLE SHEET
2. GENERAL NOTES, SUMMARY OF QUANTITIES, TYPICAL SECTION AND REMOVAL PLAN
3. PLAN AND PROFILE
4. EROSION CONTROL PLAN
5. TRAFFIC CONTROL PLAN
6. CULVERT GENERAL PLAN AND ELEVATION
7. CULVERT END SECTION DETAILS
8. SOIL BORINGS
- 9-12. CROSS SECTIONS

LIST OF STANDARDS

- | | |
|-----------|---|
| 280001-04 | TEMPORARY EROSION CONTROL SYSTEMS |
| 442201-03 | CLASS C AND D PATCHES |
| 515001-03 | NAME PLATE FOR BRIDGES |
| 630001-08 | STEEL PLATE BEAM GUARDRAIL |
| 630101-08 | GUARDRAIL MOUNTED ON EXISTING CULVERTS |
| 630301-05 | SHOULDER WIDENING FOR TYPE 1 SPL GUARDRAIL TERMINALS |
| 631011-05 | TRAFFIC BARRIER TERMINAL, TYPE 2 |
| 635006-03 | REFLECTOR AND TERMINAL MARKER REPLACEMENT |
| 701006-03 | OFF-RD OPERATIONS, 2L, 2W, 15' TO 24" FROM PAVEMENT EDGE |
| 701301-03 | LANE CLOSURE, 2L, 2W, SHORT TIME OPERATION |
| 701901-01 | TRAFFIC CONTROL DEVICES |
| 720011-01 | METAL POSTS FOR SIGNS, MARKERS & DELINEATORS |
| 728001-01 | TELESCOPING STEEL SIGN SUPPORT |
| 729001-01 | APPLICATIONS OF TYPES A & B METAL POSTS |
| BLR 21-8 | TYPICAL APPLICATION OF TRAFFIC CONTROL DEVICES FOR CONSTRUCTION ON RURAL LOCAL HIGHWAYS |
| BLR 22-6 | TYPICAL APPLICATION OF TRAFFIC CONTROL DEVICES FOR CONSTRUCTION ON RURAL LOCAL HIGHWAYS |

UTILITY NAME	TYPE	PHONE NUMBER
SBC 2404 8th AVENUE ROCKFORD, IL 61108	TELEPHONE	(815) 394-7276
VERIZON NORTH, INC. 112 WEST ELM SYCAMORE, IL. 60178	TELEPHONE	(815) 895-1538
NICOR 4651 LINDEN ROAD ROCKFORD, IL 61109	GAS	(815) 965-5416
COMED 123 ENERGY AVENUE ROCKFORD, IL 61109	ELECTRIC	(815) 490-2320
COMCAST 4450 KISHWAUKEE ST. ROCKFORD, IL 61109	CABLE TV	(815) 395-8977

UTILITY NOTE

THE LOCATIONS OF THOSE BURIED AND ABOVEGROUND UTILITIES SHOWN ARE APPROXIMATE, ARE SHOWN FOR CONTRACTOR INFORMATIONAL USE ONLY, AND ARE NOT TO BE REFERENCED FOR CONSTRUCTION PURPOSES. THE IMPLIED PRESENCE OR ABSENCE OF UTILITIES IS NOT TO BE CONSTRUED BY THE OWNER, ENGINEER, CONTRACTOR, OR SUBCONTRACTORS TO BE AN ACCURATE AND COMPLETE REPRESENTATION OF UTILITIES THAT MAY OR MAY NOT EXIST ON THE CONSTRUCTION SITE. BURIED AND ABOVEGROUND UTILITY LOCATION, IDENTIFICATION, AND MARKING ARE THE SOLE RESPONSIBILITY OF THE CONTRACTOR. REROUTING, DISCONNECTION, PROTECTION, ETC. OF ANY UTILITIES MUST BE COORDINATED AMONG THE CONTRACTOR, UTILITY COMPANY, AND OWNER. SITE SAFETY, INCLUDING THE AVOIDANCE OF HAZARDS, ASSOCIATED WITH BURIED AND ABOVEGROUND UTILITIES REMAIN THE SOLE RESPONSIBILITY OF THE CONTRACTOR.

**J.U.L.I.E.
JOINT UTILITY LOCATION INFORMATION FOR EXCAVATION
1-800-892-0123**

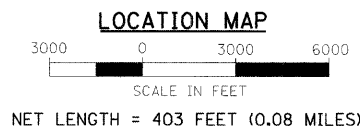
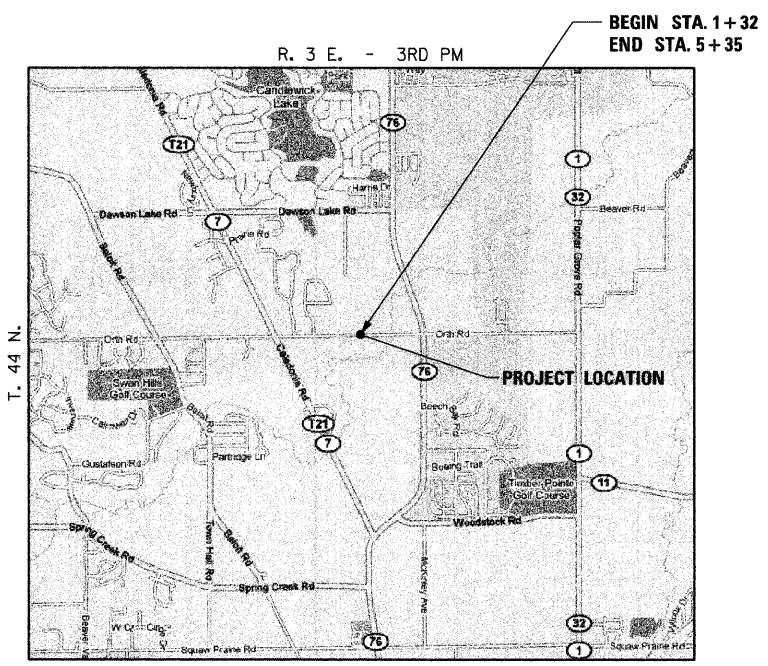

PROPOSED IMPROVEMENTS:

REMOVAL AND REPLACEMENT OF THE EXISTING CULVERT CARRYING ORTH ROAD OVER UNNAMED BRANCH OF BEAVER CREEK AT STA. 3+41. NEW STRUCTURE CONSISTS OF A TWO-CELL PRECAST CONCRETE BOX CULVERT. PROPOSED STR. NO. 004-5013.

TRAFFIC DATA:

FUNCTIONAL CLASSIFICATION: RURAL COLLECTOR
2008 ADT : 1800
DESIGN SPEED : 50 MPH (LEVEL) 3 R POLICY

PLAN SHEET SCALES: HORIZ. = 20
 VERT. = 5

CROSS SECTION SHT. SCALES: HORIZ. = 10
 VERT. = 5

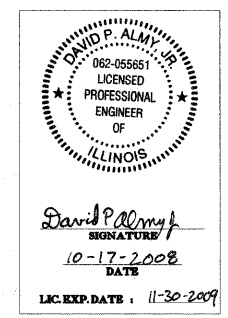

**ILLINOIS DESIGN FIRM
LICENSE NO: 184-001-084**

CONTRACT NO. 85442

APPROVED <u>Oct. 17th</u> 20 <u>08</u> <i>[Signature]</i> TIMBERLAKE VILLAGE PRESIDENT
APPROVED <u>Oct. 17th</u> 20 <u>08</u> <i>[Signature]</i> BOONE COUNTY ENGINEER
PASSED <u>20</u> <i>[Signature]</i> DISTRICT 2 ENGINEER OF LOCAL ROADS & STREETS
RELEASING FOR BID BASED ON LIMITED REVIEW <u>20</u> <i>[Signature]</i> DEPUTY DIRECTOR OF HIGHWAYS, REGION 2 ENGINEER STATE OF ILLINOIS DEPARTMENT OF TRANSPORTATION

**PRINTED BY THE AUTHORITY
OF THE STATE OF ILLINOIS**