

- LEGEND**
- U.P. DND - UTILITY POLE DO NOT DISTURB
 - L.P. DND - LIGHT POLE DO NOT DISTURB
 - U.P. TBRBO - UTILITY POLE TO BE RELOCATED BY OTHERS
 - L.P. TBRBO - LIGHT POLE TO BE RELOCATED BY OTHERS
 - (M) - MAILBOX TO BE RELOCATED
 - (A) - STRUCTURE TO BE ADJUSTED
 - (R) - STRUCTURE TO BE REMOVED
 - OR (OR) - TREE REMOVAL
 - PR1 - TREE PRUNING
 - (Hatched pattern) - PORTLAND CEMENT CONCRETE SURFACE REMOVAL-BUTT JOINT (SEE DETAIL)
 - (Hatched pattern) - HOT-MIX ASPHALT SURFACE REMOVAL - BUTT JOINT (SEE DETAIL)
 - (Hatched pattern) - PAVEMENT REMOVAL
 - (Hatched pattern) - PAVEMENT REMOVAL (SPECIAL) (SEE NOTE)
 - (Hatched pattern) - DRIVEWAY PAVEMENT REMOVAL
 - (Hatched pattern) - COMBINATION CURB AND GUTTER REMOVAL
 - (Hatched pattern) - SIDEWALK REMOVAL
 - X-X-X - EXISTING FENCE
 - X-X-X - FENCE REMOVAL

NOTE
 THE EXISTING ASPHALT AND OIL AND CHIP PAVEMENTS SHALL BE REMOVED BY MILLING AND THE SALVAGED MATERIAL SHALL BE STOCKPILED AT LOCATIONS APPROVED BY THE ENGINEER. THE SALVAGED MATERIAL SHALL BE REUSED IN PLACE OF THE LIME MODIFIED SOIL AT LOCATIONS DESIGNATED BY THE ENGINEER. SEE THE SPECIAL PROVISIONS.

FOR PROPOSED CONSTRUCTION IN THIS AREA SEE PLAN AND PROFILE SHEET NO'S. 59-61.

MAILBOXES SHALL BE RELOCATED AS DIRECTED BY THE ENGINEER IN ACCORDANCE WITH ARTICLE 107.20 OF THE STANDARD SPECIFICATIONS.

SEE PLAN AND PROFILE SHEETS FOR STORM SEWER REMOVAL AND STRUCTURE REMOVAL AND ADJUSTMENT SCHEDULES.

EXISTING PAVEMENTS, CURBS AND GUTTERS, AND SIDEWALKS IN WHICH THE TOP SURFACE IS TO BE JOINED TO THE PROPOSED WORK SHALL BE SO JOINED THROUGH SAW CUT JUNCTURES.

THE REMOVAL AND RELOCATION OF VARIOUS TRAFFIC SIGNS NOTED HEREON SHALL BE AS DIRECTED BY THE ENGINEER AND AS SPECIFIED IN THE STANDARD SPECIFICATIONS. THIS WORK SHALL NOT BE PAID FOR SEPARATELY AND IS CONSIDERED INCLUDED IN THE VARIOUS REMOVAL ITEMS.

ILLINOIS DEPARTMENT OF TRANSPORTATION
REMOVALS/RELOCATIONS PLAN

DATE : 10-08
 DRAWN BY : J.L.B.
 CHECKED BY : R.L.H.
 SCALE : 1"=20'

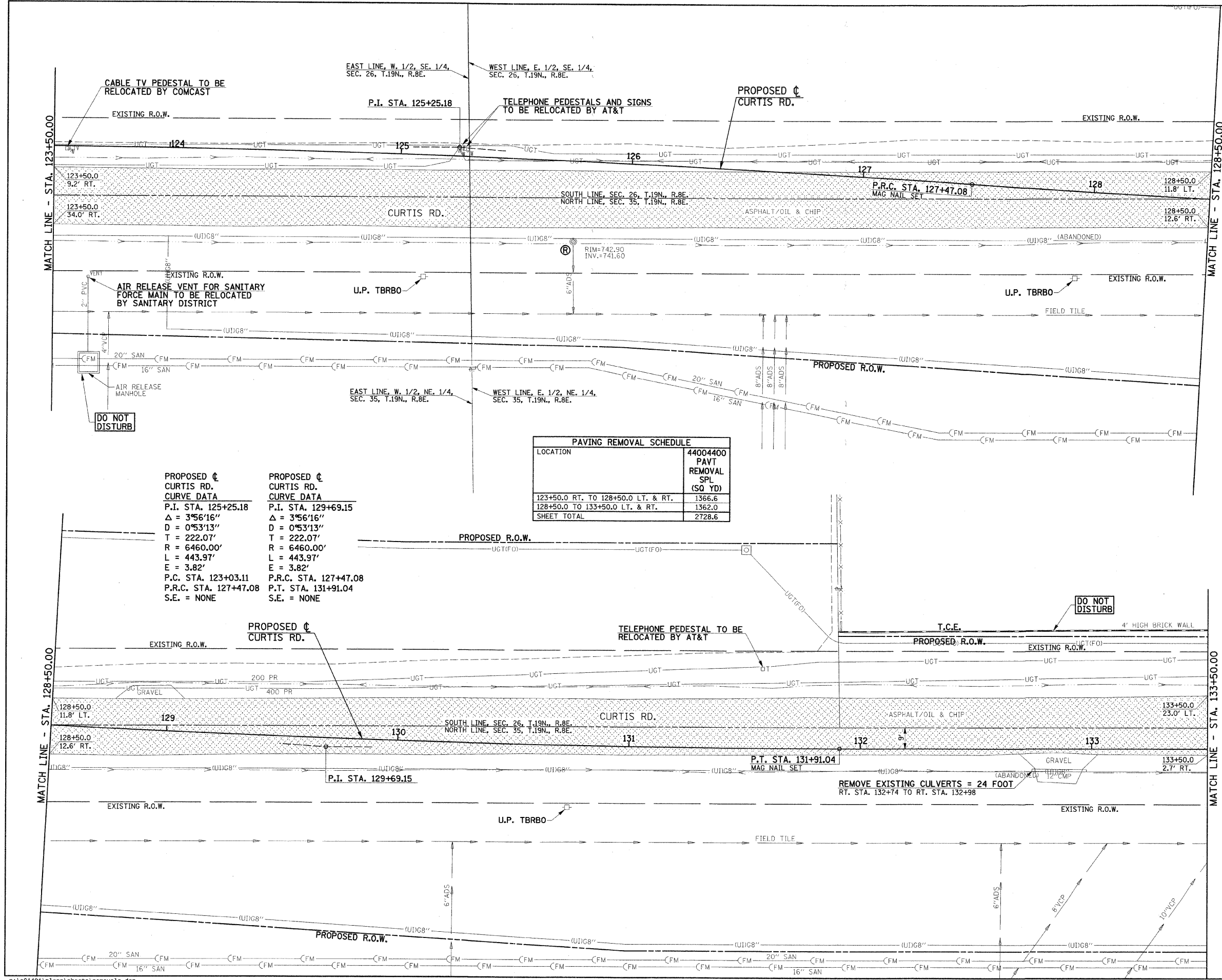

PROPOSED CURTIS RD. CURVE DATA
 P.I. STA. 125+25.18
 $\Delta = 3^{\circ}56'16''$
 $D = 0^{\circ}53'13''$
 $T = 222.07'$
 $R = 6460.00'$
 $L = 443.97'$
 $E = 3.82'$
 P.C. STA. 123+03.11
 P.R.C. STA. 127+47.08
 S.E. = NONE

PROPOSED CURTIS RD. CURVE DATA
 P.I. STA. 129+69.15
 $\Delta = 3^{\circ}56'16''$
 $D = 0^{\circ}53'13''$
 $T = 222.07'$
 $R = 6460.00'$
 $L = 443.97'$
 $E = 3.82'$
 P.R.C. STA. 127+47.08
 P.T. STA. 131+91.04
 S.E. = NONE

| PAVING REMOVAL SCHEDULE | |
|------------------------------------|-----------------------------------|
| LOCATION | 44004400 PAVT REMOVAL SPL (SQ YD) |
| 123+50.0 RT. TO 128+50.0 LT. & RT. | 1366.6 |
| 128+50.0 TO 133+50.0 LT. & RT. | 1362.0 |
| SHEET TOTAL | 2728.6 |