

SEC. 27, T.19N., R.8E., 3rd P.M.
CHAMPAIGN COUNTY, ILLINOIS

F.A.P. RTE.	SECTION	COUNTY	TOTAL SHEETS	SHEET NO.
807	00-00374-01-PV	CHAMPAIGN	242	47
STA. 63+20.00		TO STA. 68+00.00		
ILLINOIS F.A. PROJ. NO. RS-HPP-1805/001				
CONTRACT NO. 91368				

PROPOSED CURTIS RD. CURVE DATA	PROPOSED CURTIS RD. CURVE DATA
P.I. STA. 61+84.04	P.I. STA. 67+00.29
Δ = 4°30'28"	Δ = 4°38'59"
D = 0°53'13"	D = 0°53'13"
T = 254.25'	T = 262.27'
R = 6460.00'	R = 6460.00'
L = 508.24'	L = 524.24'
E = 5.00'	E = 5.32'
P.C. STA. 59+29.79	P.R.C. STA. 64+38.03
P.R.C. STA. 64+38.03	P.T. STA. 69+62.27
S.E. = NONE	S.E. = NONE

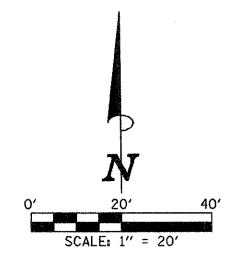

LEGEND
 PROPOSED SODDING FOR DITCH LINING

FURNISHING AND ERECTING RIGHT-OF-WAY MARKERS = 3 EACH
 • STA. 65+50.00, 84.52' RT.
 • STA. 67+00.00, 102.91' LT.
 • STA. 68+00.00, 83.49' RT.
 • OMIT MARKER IF IN CONFLICT WITH FIELD TILE

NOTE 1
 THE RAMPED CONCRETE MEDIAN NOSES SHALL BE CONSTRUCTED IN ACCORDANCE WITH STD. 606301. THE RAMPED NOSES SHALL BE 6 FEET LONG MEASURED FROM THE END OF THE RAMP TO THE BACK OF THE CURB. THE RAMPED NOSES SHALL BE PAID FOR AS CONCRETE MEDIAN, TYPE SB-6.12.

FOR REMOVAL/RELOCATION PLAN IN THIS AREA SEE SHEET NO. 32

SEE SCHEDULE OF QUANTITIES FOR TYPICAL SECTION PAVEMENT PAY ITEMS AND THEIR LOCATIONS.

SEE THE STAGE CONSTRUCTION AND MAINTENANCE OF TRAFFIC PLANS FOR THE VARIOUS STAGES AND CONSTRUCTION SEQUENCES ON CURTIS RD.

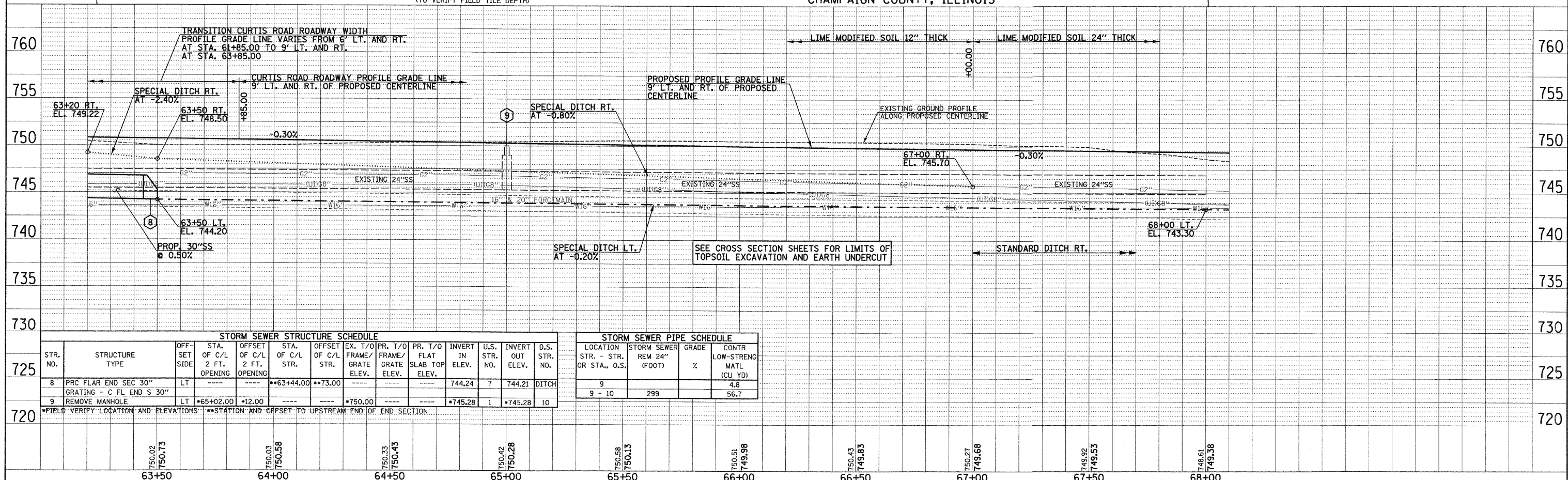
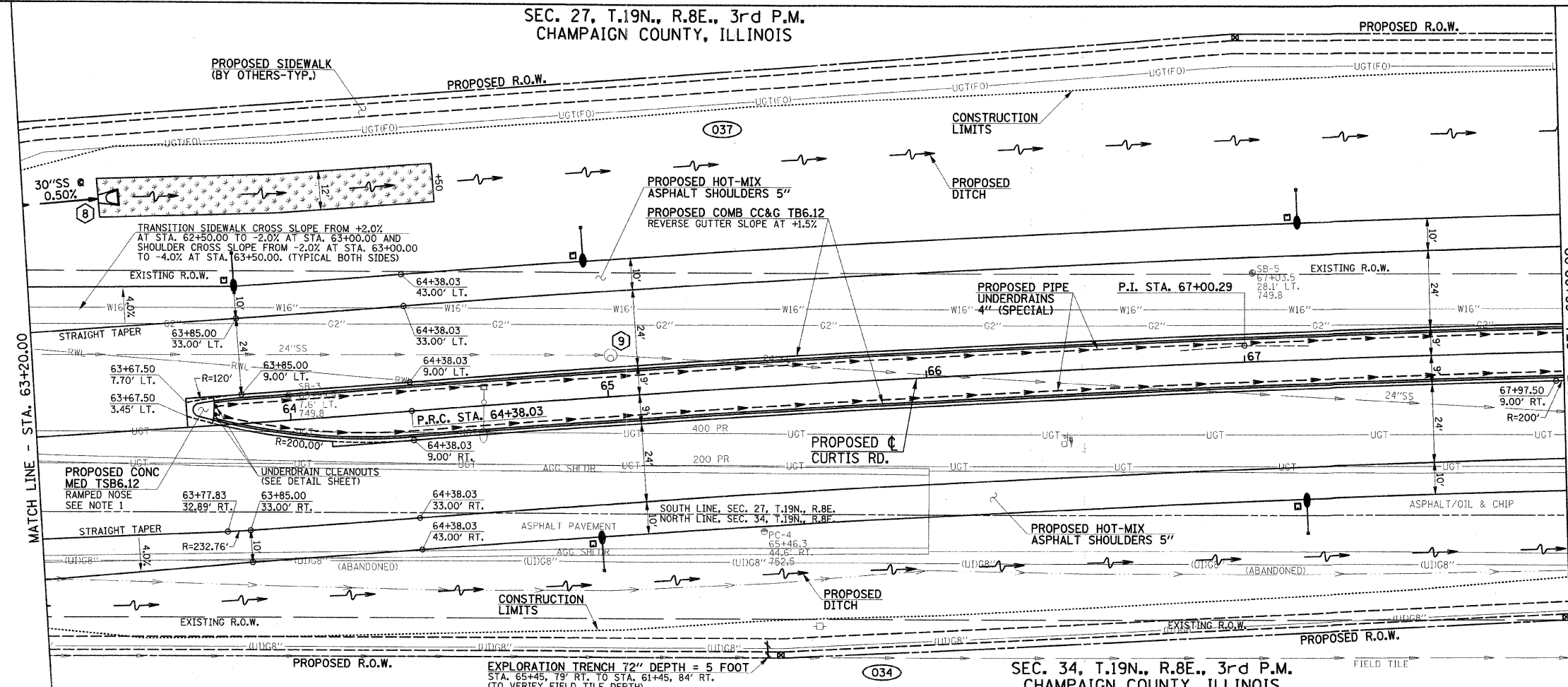

STR. NO.	STRUCTURE TYPE	OFF-SET SIDE	STA. OF C/L 2 FT. OPENING	OFFSET OF C/L 2 FT. OPENING	STA. OF C/L STR.	OFFSET OF C/L STR.	EX. T/O FRAME/GRATE ELEV.	PR. T/O FRAME/GRATE ELEV.	PR. T/O FLAT SLAB TOP ELEV.	INVERT IN ELEV.	U.S. STR. NO.	INVERT OUT ELEV.	D.S. STR. NO.
8	PRC FLAR END SEC 30"	LT			63+44.00	73.00				744.24	7	744.21	DITCH
9	GRATING - C FL END S 30"	LT	65+02.00	12.00			750.00			745.28	1	745.28	10
*FIELD VERIFY LOCATION AND ELEVATIONS **STATION AND OFFSET TO UPSTREAM END OF END SECTION													

LOCATION STR. OR STA., O.S.	STORM SEWER REM 24" (FOOT)	GRADE %	CONTR LOW-STRENG MATL (CU YD)
9			4.8
9 - 10	299		56.7