

SEC. 27, T.19N., R.8E., 3rd P.M.
CHAMPAIGN COUNTY, ILLINOIS

SEC. 26, T.19N.,
R.8E., 3rd P.M.,
CHAMPAIGN COUNTY,
ILLINOIS

F.A.P. RTE.	SECTION	COUNTY	TOTAL SHEETS	SHEET NO.
807	00-00374-01-PV	CHAMPAIGN	242	51
STA. 83+00.00	TO STA. 88+00.00			
491+40.00	493+50.00			
ILLINOIS F.A. PROJ. NO. RS-HPP-1805(00)				
CONTRACT NO. 91368				

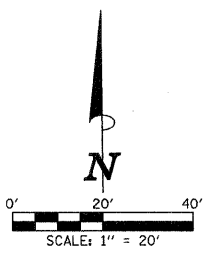

NOTE 2
PROVIDE 24" DIA. OPENING IN TOP OF BOX CULVERTS WITH TYPE I FRAME WITH CLOSED LID. SEE DETAIL SHEET.

NOTE 1
THE RAMPED CONCRETE MEDIAN NOSES SHALL BE CONSTRUCTED IN ACCORDANCE WITH STD. 606301. THE RAMPED NOSES SHALL BE 6 FEET LONG MEASURED FROM THE END OF THE RAMP TO THE BACK OF THE CURB. THE RAMPED NOSES SHALL BE PAID FOR AS CONCRETE MEDIAN, TYPE SB-6.12.

FOR REMOVAL/RELOCATION PLAN IN THIS AREA SEE SHEET NO. 34

SEE SCHEDULE OF QUANTITIES FOR TYPICAL SECTION PAVEMENT PAY ITEMS AND THEIR LOCATIONS.

SEE PAVEMENT JOINTS AND INTERSECTION DETAILS FOR ADDITIONAL INFORMATION.

SEE THE STAGE CONSTRUCTION AND MAINTENANCE OF TRAFFIC PLANS FOR THE VARIOUS STAGES AND CONSTRUCTION SEQUENCES ON CURTIS RD.

LOCATION STR.-STR. OR STA. O.S.	CONCRETE COLLAR (EACH)	STORM SEWER REM 8" (FOOT)	SS 1 WMO 24" (FOOT)	STORM SEWER CL A 2 12" (FOOT)	GRADE %	CONTR LOW-STRENG MATL (CU YD)
13 - 13a			28		0.50	
14 - 14a				23	0.50	
14a - 14b	1	150		6		15.3
14b - EAST						

CONCRETE COLLARS SHALL BE USED TO CONNECT STORM SEWERS

LOCATION STR.-STR. OR STA. O.S.	STORM SEWER CL A 1 12" (FOOT)	STORM SEWER CL A 1 15" (FOOT)	STORM SEWER CL A 1 24" (FOOT)	GRADE %	CONTR LOW-STRENG MATL (CU YD)
14c - 14d			34	3.20	
15 - 15a			34	3.20	
17 - 18	63			0.80	3.0
18 - 20	21			1.00	
19 - 20		16		3.00	5.4
20 - 20a		12		3.00	
21 - 21a		14		0.60	

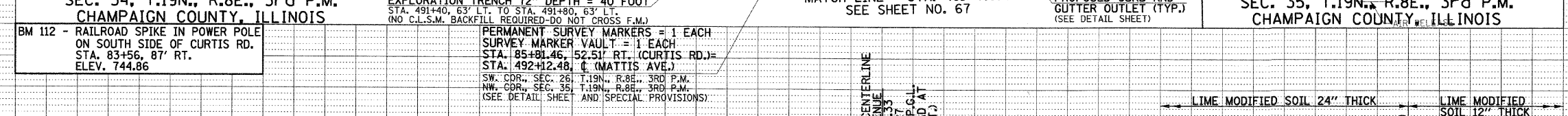
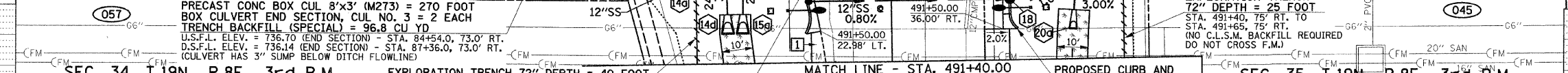
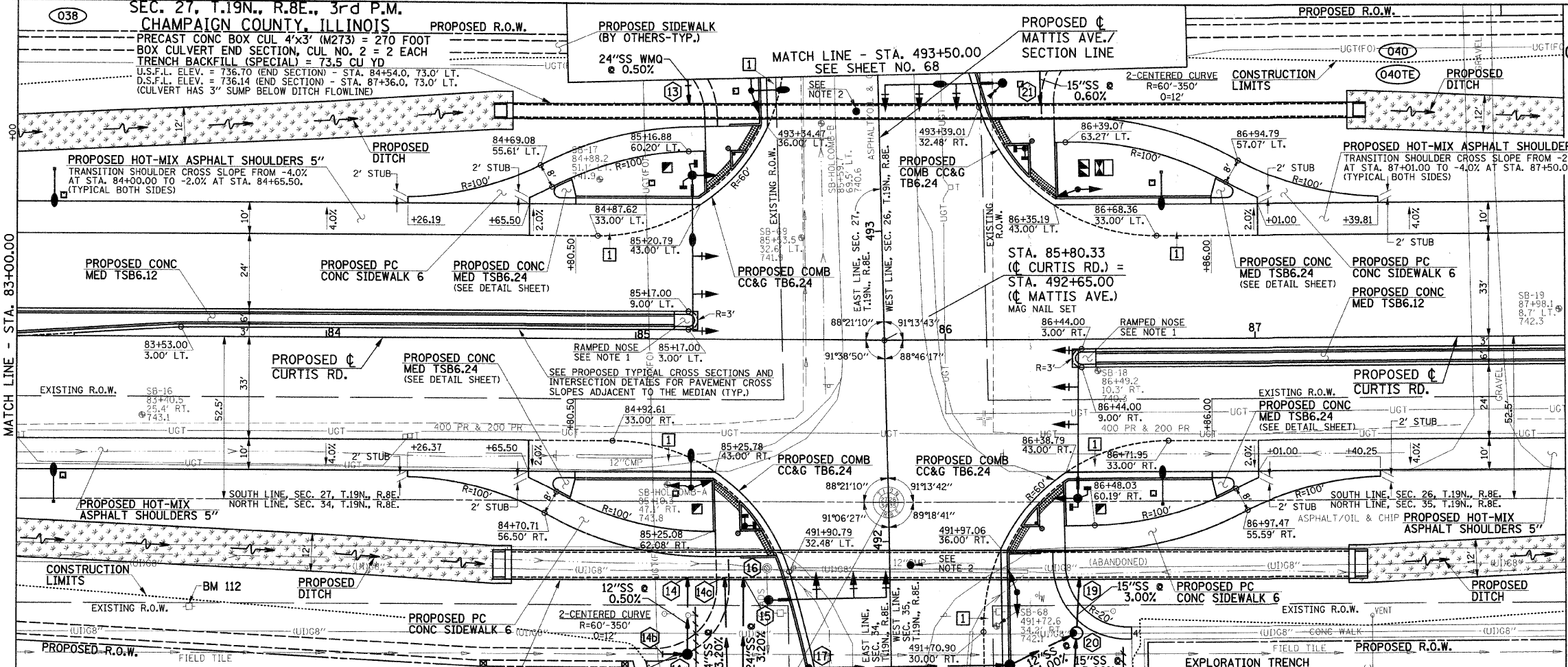

STR. NO.	STRUCTURE TYPE	OFF-SET SIDE	STA. OF C/L 2 FT. OPENING	OFFSET OF C/L 2 FT. OPENING	STA. OF C/L STR.	OFFSET OF C/L STR.	EX. T/O FRAME/GRATE ELEV.	PR. T/O FRAME/GRATE ELEV.	PR. T/O FLAT SLAB TOP ELEV.	INVERT IN ELEV.	U.S. STR. NO.	INVERT OUT ELEV.	D.S. STR. NO.
13	CONNECT S.S. TO BOX CUL.	LT	85+17.00	75.25	85+17.00	75.25				736.83	13a	736.58	BOX CUL
14	CONNECT S.S. TO BOX CUL.	RT	85+17.00	76.75	85+17.00	76.75				736.78	14a	736.57	BOX CUL
14a	RD INLETS TB T1 CLOSED	RT	85+17.50	101.30	85+17.00	101.30		742.80	741.80	737.00	14b	736.90	14
14b	CONNECT TO EXISTING S.S.	RT	85+09.00	101.30	85+09.00	101.30				736.81	14d	736.55	BOX CUL
14c	CONNECT S.S. TO BOX CUL.	RT	85+29.00	76.70	85+29.00	76.70				738.09	17	738.80	18
14d	PRC FLAR END SEC 24"	LT	491+56.00	53.00	491+56.00	53.00				738.09	17	738.20	20

STR. NO.	STRUCTURE TYPE	OFF-SET SIDE	STA. OF C/L 2 FT. OPENING	OFFSET OF C/L 2 FT. OPENING	STA. OF C/L STR.	OFFSET OF C/L STR.	EX. T/O FRAME/GRATE ELEV.	PR. T/O FRAME/GRATE ELEV.	PR. T/O FLAT SLAB TOP ELEV.	INVERT IN ELEV.	U.S. STR. NO.	INVERT OUT ELEV.	D.S. STR. NO.
15	CONNECT S.S. TO BOX CUL.	RT	85+35.00	76.70	85+35.00	76.70				736.81	15a	736.54	BOX CUL
15a	PRC FLAR END SEC 24"	LT	491+56.00	48.00	491+56.00	48.00				738.09	DITCH	737.90	15
16	REMOVE INLET	RT	85+42.60	73.80	85+42.60	73.80		741.74		739.94		739.94	SOUTH
17	INLETS TA T3V F & G	LT	491+60.00	26.65	491+60.00	26.65		742.28		738.80		738.80	18
18	RD INLETS TB T3V F & G	RT	491+60.00	37.80	491+60.00	37.80		741.90	740.82	738.30	17	738.20	20

STR. NO.	STRUCTURE TYPE	OFF-SET SIDE	STA. OF C/L 2 FT. OPENING	OFFSET OF C/L 2 FT. OPENING	STA. OF C/L STR.	OFFSET OF C/L STR.	EX. T/O FRAME/GRATE ELEV.	PR. T/O FRAME/GRATE ELEV.	PR. T/O FLAT SLAB TOP ELEV.	INVERT IN ELEV.	U.S. STR. NO.	INVERT OUT ELEV.	D.S. STR. NO.
19	CONNECT S.S. TO BOX CUL.	RT	86+43.00	76.70	86+43.00	76.70				736.92	20	736.32	BOX CUL
20	RD MAN TA 4 DIA T1 CLOSED	RT	491+70.00	60.00	491+70.00	60.00		741.70	740.70	737.99	18	737.40	19
20a	PRC FLAR END SEC 15"	RT	491+56.00	59.00	491+56.00	59.00				737.49	20a	737.85	20
21	CONNECT S.S. TO BOX CUL.	RT	86+31.00	75.35	86+31.00	75.35				736.72	22	736.35	BOX CUL