

TYPICAL PAVEMENT MARKING LEGEND			
1	4" SKIP-DASH (YELLOW)	8	4" SOLID (WHITE)
2	4" SOLID (YELLOW)	9	12" DIAGONAL (WHITE)
3	12" DIAGONAL (YELLOW)	10	6" CROSSWALK (WHITE)
4	4" DOUBLE YELLOW (NARROW)	11	24" STOP BAR (WHITE)
5	4" DOUBLE YELLOW (WIDE) N/A	12	8" SOLID (WHITE) N/A
6	6" DIAGONAL (YELLOW) N/A	13	4" LANE LINE EXTENSIONS (WHITE)
7	4" SKIP-DASH (WHITE)	14	RESERVED

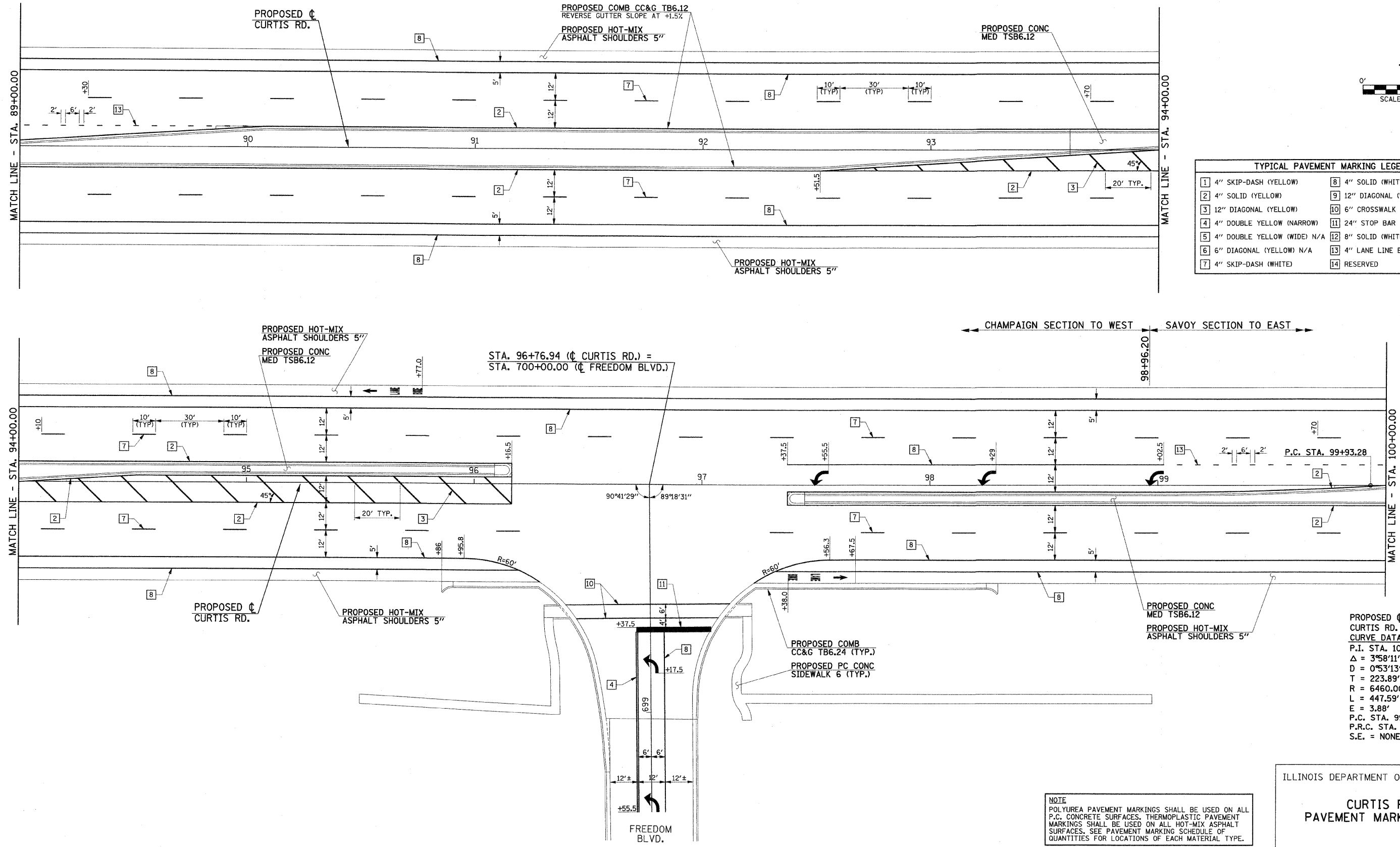

← CHAMPAIGN SECTION TO WEST SAVOY SECTION TO EAST →

STA. 96+76.94 (CURTIS RD.) =
STA. 700+00.00 (FREEDOM BLVD.)

PROPOSED C
CURTIS RD.
CURVE DATA
P.I. STA. 102+17.17
Δ = 3°58'11"
D = 0°53'13"
T = 223.89'
R = 6460.00'
L = 447.59'
E = 3.88'
P.C. STA. 99+93.28
P.R.C. STA. 104+40.88
S.E. = NONE

NOTE
POLYUREA PAVEMENT MARKINGS SHALL BE USED ON ALL P.C. CONCRETE SURFACES. THERMOPLASTIC PAVEMENT MARKINGS SHALL BE USED ON ALL HOT-MIX ASPHALT SURFACES. SEE PAVEMENT MARKING SCHEDULE OF QUANTITIES FOR LOCATIONS OF EACH MATERIAL TYPE.

ILLINOIS DEPARTMENT OF TRANSPORTATION

**CURTIS ROAD
PAVEMENT MARKING PLANS**

DATE : 10-08
DRAWN BY : J.L.B.
CHECKED BY : R.L.H.

SCALE : 1"=20'