

F.A.P. RTE.	SECTION	COUNTY	TOTAL SHEETS	SHEET NO.
807	00-00374-01-PV	CHAMPAIGN	242	137
STA. 67+00.00		TO STA. 78+00.00		
ILLINOIS F.A. PROJ. NO. RS-HPP-1805(000)				
CONTRACT NO. 91368				

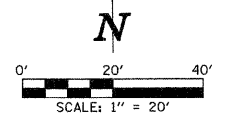

ROADWAY LIGHTING LEGEND

- PROPOSED TRAFFIC SIGNAL HANDHOLE. (SEE TRAFFIC SIGNAL PLANS FOR LOCATION)
- PROPOSED 250W HPS LUMINAIRE, WITH M-C-III DISTRIBUTION, WITH 15' TRUSS ARM MOUNTED ON 40' TRAFFIC SIGNAL MAST ARM POLE. TRUSS ARM ORIENTATION SHALL BE AS INDICATED ON PLANS. TRUSS ARM, POLE, FOUNDATION, AND INTERNALLY ILLUMINATED STREET NAME SIGN TO BE PROVIDED AND INSTALLED AS PART OF THE TRAFFIC SIGNAL INSTALLATION. COORDINATE LUMINAIRE INSTALLATION AND SIGN WIRING WITH POLE AND SIGNAL INSTALLATION.
- PROPOSED TRAFFIC SIGNAL CONTROLLER CABINET.
- PROPOSED LIGHTING CONTROLLER (X INDICATES CONTROLLER #).
- PROPOSED 250W HPS LUMINAIRE, WITH M-C-III DISTRIBUTION, WITH 8' TRUSS ARM MOUNTED ON 40' POLE, WITH AUGERED STEEL FOUNDATION.
- PROPOSED 250W HPS LUMINAIRE, WITH M-C-III DISTRIBUTION, WITH 8' TRUSS ARM MOUNTED ON 40' POLE, WITH CONCRETE FOUNDATION. (SEE NOTE 13)
- PROPOSED JUNCTION BOX, SPECIAL. ALL JUNCTION BOXES SHALL BE 12"W x 12"L x 12"D UNLESS OTHERWISE NOTED.
- PROPOSED PVC CONDUIT (SCH. 80), AUGERED. SEE CONDUIT/CABLE SCHEDULE FOR QUANTITIES. (SEE NOTE 14)
- PROPOSED PVC CONDUIT (SCH. 40) IN TRENCH. SEE CONDUIT/CABLE SCHEDULE FOR QUANTITIES

CIRCUIT DESIGNATION SCHEME

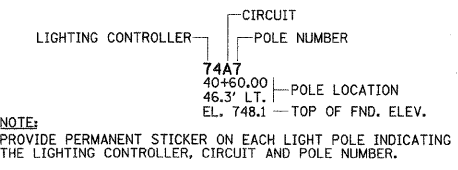

CONDUIT/CABLE SCHEDULE

- ① (1) 1 1/4" PVC CONDUIT WITH 2-#10, 1-#10 GND.
- ② (1) 2" PVC CONDUIT WITH 2-#6, 1-#6 GND.
- ③ (1) 2" PVC CONDUIT WITH 4-#6, 1-#6 GND.
- ④ (1) 2" PVC CONDUIT WITH 2-#4, 1-#4 GND.
- ⑤ (1) 2" PVC CONDUIT WITH 4-#4, 1-#4 GND.

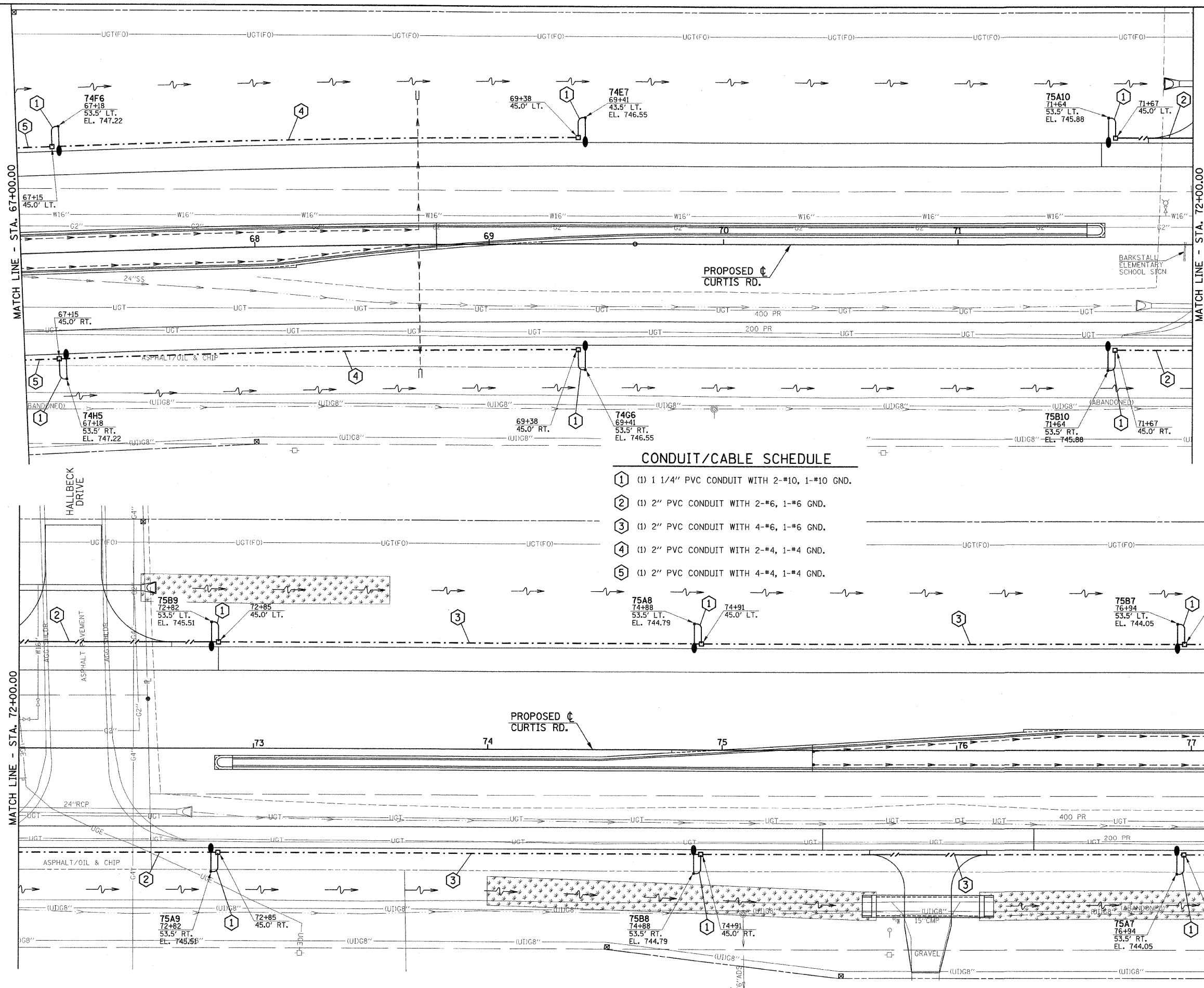

ILLINOIS DEPARTMENT OF TRANSPORTATION
**CURTIS ROAD
 ROADWAY LIGHTING PLANS**

DATE : 10-08
 DRAWN BY : JRM/JAJ
 CHECKED BY : JJF
 SCALE : 1"=20'

p:\c01401\plans\sheet\lighting.dgn
 10/2/2008 9:25:47 AM