

RTE. NO.	SECTION	COUNTY	TOTAL SHEETS	SHEET NO.
CH 12	07-00118-00-BR	LOGAN	12	11
STA. 20+00		STA.		
FED. ROAD DIST.	ILLINOIS	FED. AID PROJECT		

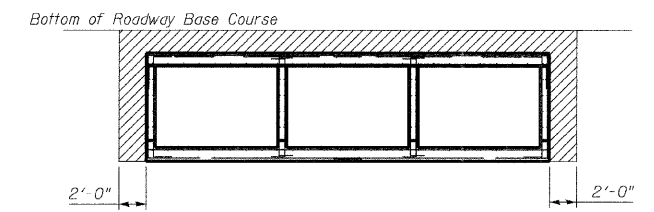
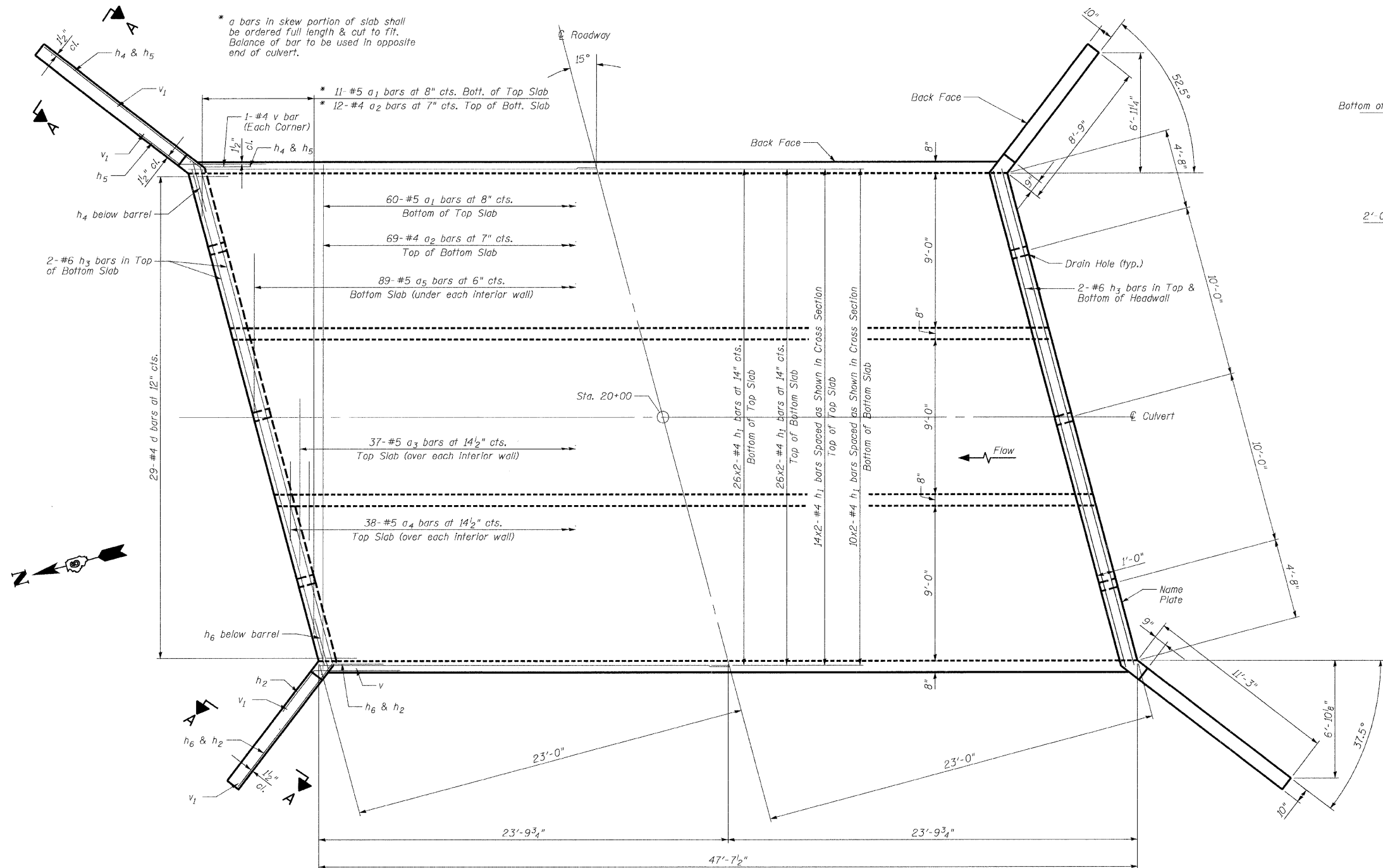

LIMITS OF GRANULAR CULVERT BACKFILL

Backfill Entire Length of Culvert
Backfill Limits Behind Wingwalls = 2'-0"

NOTES

- A distance of half the length of the wingwall but not less than six feet of the barrel shall be poured monolithically with the wingwalls.
- Reinforcement Bars shall conform to the requirements of ASTM A 706, Grade 60.
- Bars indicated thus 12 x 4-#5 etc. indicates 12 lines of bars with 4 lengths per line.
- All construction joints shall be banded.
- Minimum lap lengths:
#4 bar: 1'-4"
#5 bar: 1'-8"
- Precast culvert option is allowed as long as the hydraulic requirements are met.

SHOWING OUTLINES

SUMMARY OF QUANTITIES

CODE NO.	ITEM	UNIT	QUANTITY
* 50100200	REMOVAL OF EXISTING STRUCTURES	L. SUM	1
50200100	STRUCTURE EXCAVATION	CU. YD.	71
50800105	REINFORCEMENT BARS	POUND	19840
51500100	NAME PLATES	EACH	1
54003000	CONCRETE BOX CULVERTS	CU. YD.	143.9
* 63000025	STEEL PLATE BEAM GUARDRAIL, ATTACHED TO STRUCTURES	FOOT	75
* X0324118	GRANULAR CULVERT BACKFILL	CU. YD.	170

* SEE SPECIAL PROVISIONS

CULVERT LAYOUT
CH 12 OVER
LAKE FORK CREEK TRIBUTARY
STATION 20+00.00

FILE NAME = R07013_Plan.dgn	USER NAME = default	DESIGNED - JLS	REVISED -
		DRAWN - JLS	REVISED -
		CHECKED - CSB	REVISED -
		DATE - JUN 2008	REVISED -

STATE OF ILLINOIS
DEPARTMENT OF TRANSPORTATION

CULVERT LAYOUT

SCALE: SHEET NO. 2 OF 3 SHEETS STA. 20+00 TO STA.

F.A. RTE.	SECTION	COUNTY	TOTAL SHEETS	SHEET NO.
	07-00118-00-BR	LOGAN	12	11
SN 054-3921		CONTRACT NO.		
FED. ROAD DIST. NO.	ILLINOIS	FED. AID PROJECT		