

F.A.P. RTE.	SECTION	COUNTY	TOTAL SHEETS	SHEET NO.
781	1YRS, 2ZRS-1	CRAWFORD	378	124
STA. 3+150		TO STA. 3+325		
FED. ROAD DIST. NO.	ILLINOIS		FED. AID PROJECT	

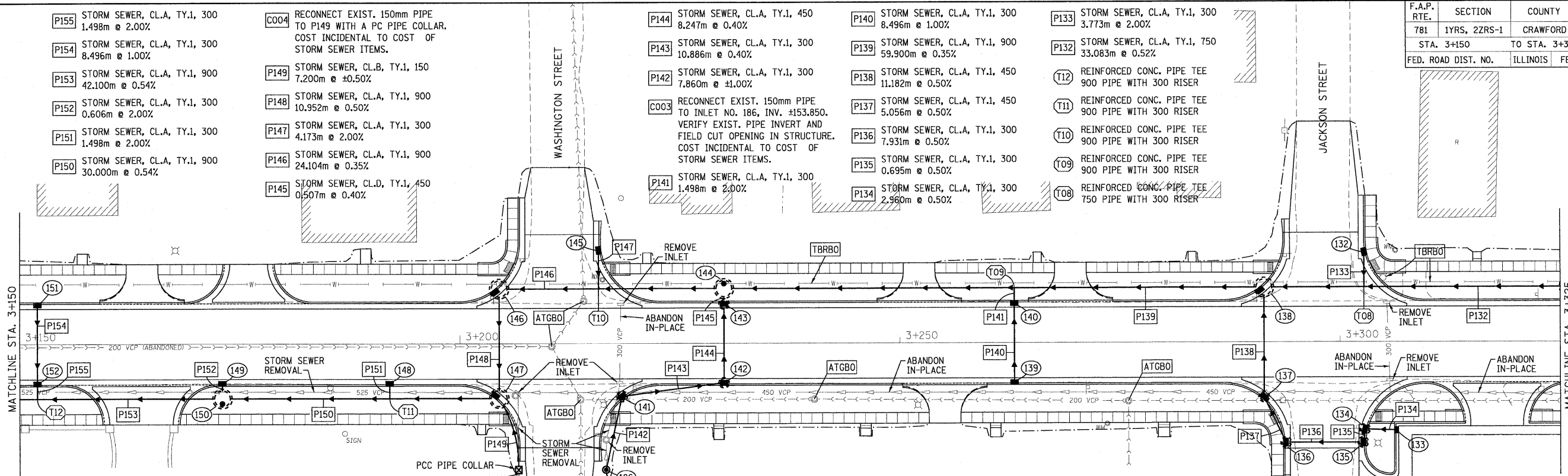

- 152 INLET TY.A, TY.3 F&G
STA. 3+152.000, 4.475m RT.
GRATE 154.303
INV. 152.596
- 151 INLET TY.A, TY.3 F&G
STA. 3+152.000, 4.475m LT.
GRATE 154.303
INV. 153.041
- 150 MH, TY.A, RESTRICTED DEPTH
1.8m DIA., TY.1 FRAME, CL. LID
STA. 3+173.000, 6.200m RT.
SEE DETAIL FOR FRAME OFFSET
TOP 154.660
INV.(E,W) 152.731
INV.(N) 153.341
- 149 INLET TY.A, TY.3 F&G
STA. 3+173.000, 4.475m RT.
GRATE 154.412
INV. 153.353
- 148 INLET TY.A, TY.3 F&G
STA. 3+192.000, 4.475m RT.
GRATE 154.511
INV. 153.164
- 147 MH, TY.A, RESTRICTED DEPTH
1.8m DIA., TY.3 F&G
STA. 3+204.448, 6.200m RT.
SEE DETAIL FOR GRATE OFFSET
GRATE 154.578
INV.(E,N) 152.893
- 146 MH, TY.A, RESTRICTED DEPTH
1.8m DIA., TY.3 F&G
STA. 3+204.448, 6.200m LT.
SEE DETAIL FOR GRATE OFFSET
GRATE 154.577
INV.(E) 153.100
INV.(S) 152.948
- 145 INLET TY.A, TY.3 F&G
STA. 3+215.745, 10.600m LT.
GRATE 154.589
INV. 153.525
- 144 MH, TY.A, RESTRICTED DEPTH
1.8m DIA., TY.1 FRAME, CL. LID
STA. 3+230.000, 6.200m LT.
SEE DETAIL FOR FRAME OFFSET
TOP 154.897
INV.(E,W) 153.185
INV.(S) 153.489
- 143 INLET TY.B, RESTRICTED DEPTH
0.9m DIA., TY.3 F&G
STA. 3+230.000, 4.475m LT.
GRATE 154.708
INV. 153.491
- 142 INLET TY.B, RESTRICTED DEPTH
0.9m DIA., TY.3 F&G
STA. 3+230.000, 4.475m RT.
GRATE 154.708
INV.(S) 153.676
- 141 INLET TY.B, RESTRICTED DEPTH
0.9m DIA., TY.3 F&G
STA. 3+218.395, 6.000m RT.
GRATE 154.621
INV. 153.720
- 186 INLET TY.A, TY.8 GRATE
STA. 3+216.576, 14.300m RT.
TOP 155.000
INV. 153.798
- 140 INLET TY.A, TY.3 F&G
STA. 3+263.000, 4.475m LT.
GRATE 154.880
INV. 153.632
- 139 INLET TY.A, TY.3 F&G
STA. 3+263.000, 4.475m RT.
GRATE 154.880
INV. 153.717
- 138 MH, TY.A, RESTRICTED DEPTH
1.8m DIA., TY.3 F&G
STA. 3+291.348, 6.200m LT.
SEE DETAIL FOR GRATE OFFSET
GRATE 155.028
INV.(E) 153.547
INV.(W) 153.394
INV.(S) 153.699
- 137 INLET TY.B, RESTRICTED DEPTH
0.9m DIA., TY.3 F&G
STA. 3+291.348, 6.200m RT.
GRATE 155.031
INV. 153.755
- 136 INLET TY.B, RESTRICTED DEPTH
0.9m DIA., TY.3 F&G
STA. 3+293.825, 11.400m RT.
GRATE 155.100
INV.(N) 153.932
INV.(E) 153.780
- 135 INLET TY.B, RESTRICTED DEPTH
0.9m DIA., TY.3 F&G
STA. 3+302.575, 11.400m RT.
GRATE 155.100
INV. 153.972
- 134 INLET TY.B, RESTRICTED DEPTH
0.9m DIA., TY.3 F&G
STA. 3+302.780, 9.900m RT.
GRATE 155.068
INV. 153.975
- 133 INLET TY.A, TY.11 F&G
STA. 3+306.375, 10.000m RT.
GRATE 155.348
INV. 153.990
- 132 INLET TY.A, TY.3 F&G
STA. 3+302.713, 10.200m LT.
GRATE 155.069
INV. 153.907

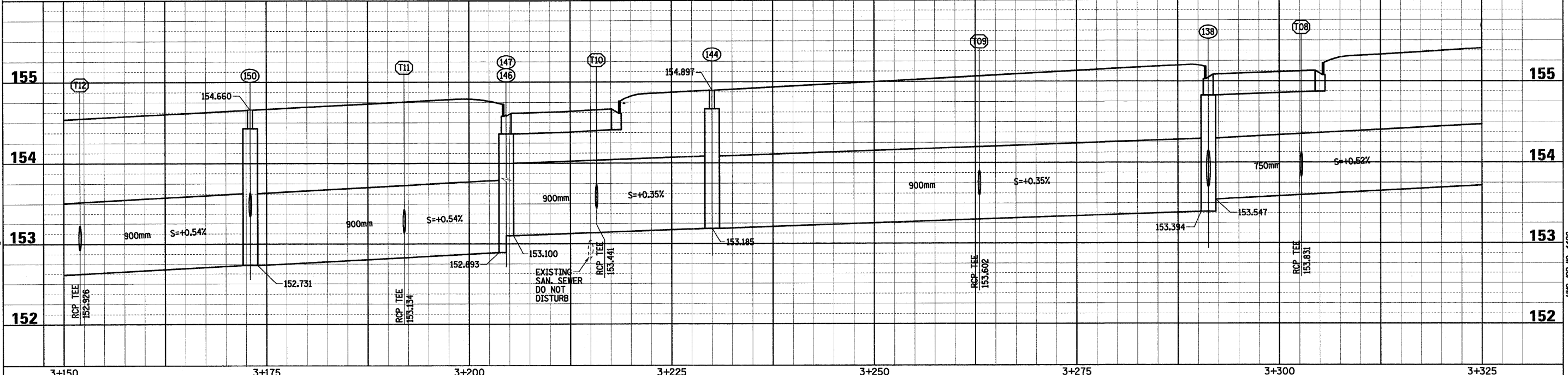
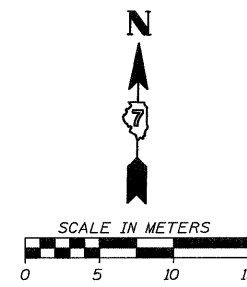

Sheet: 4
Angle: 0.9785
Chain: P_IL33

PLOT DATE = 3/20/2009
FILE NAME = H:\4428\7024_ss_B4.dgn

HMG JOB NO. 4420