

The existing 3 span precast prestressed I-beam structures were constructed in 1965 as section 26-0B-2 at Sta. 126+25. SN 026-0007 carries FAI-70 eastbound and SN 026-0008 carries FAI-70 westbound. The proposed project consists of new expansion joints, partial and full depth deck patching, new microsilica wearing surface, and new deck drains.

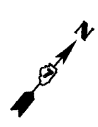
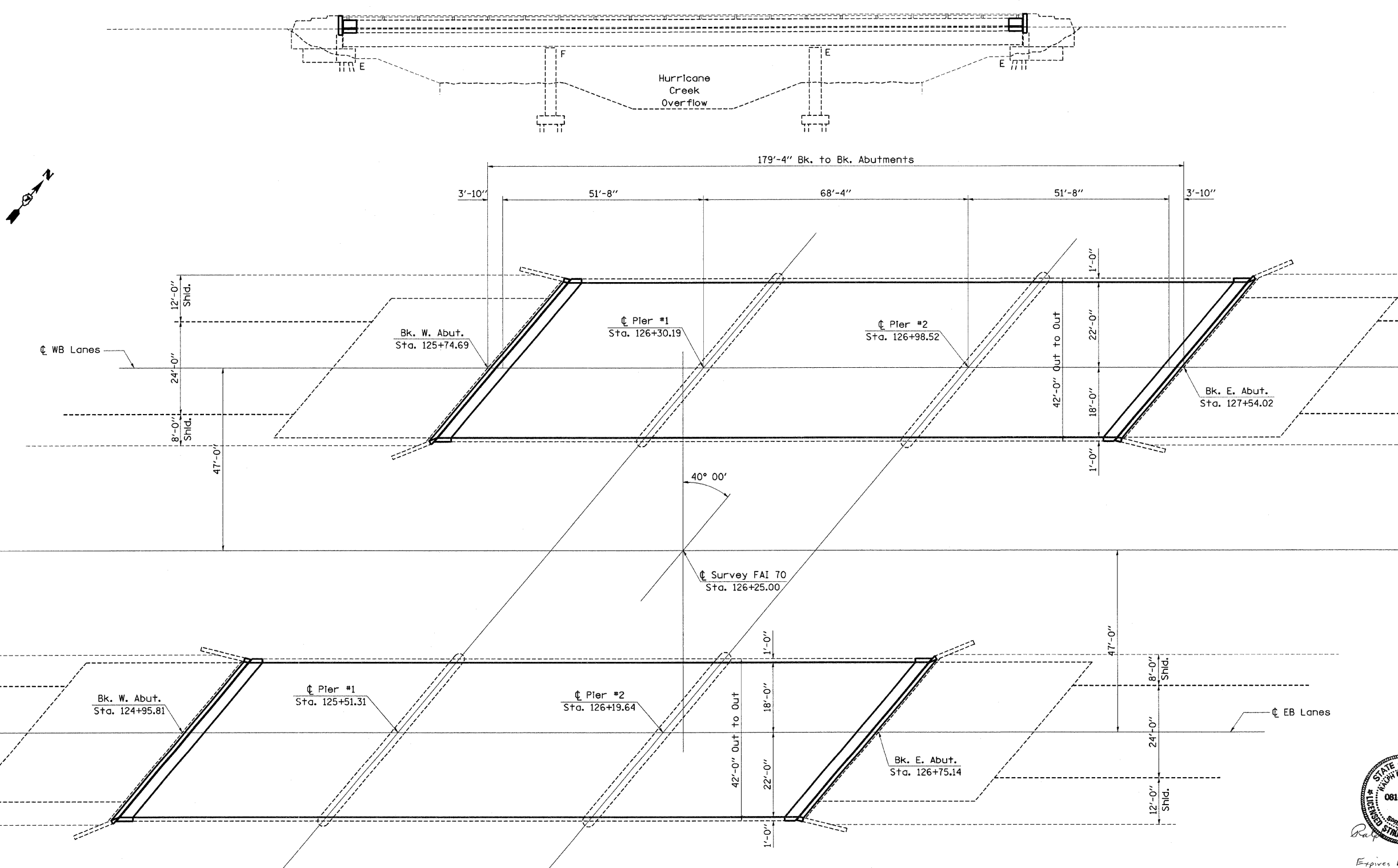

Expires Nov. 30, 2010

FILE NAME =	USER NAME = swartzw	DESIGNED -	REVISED -	STATE OF ILLINOIS DEPARTMENT OF TRANSPORTATION	GENERAL PLAN & ELEVATION SN. 026-0007 (EB) & SN. 026-0008 (WB)		F.A.I. RTE.	SECTION	COUNTY	TOTAL SHEETS	SHEET NO.	
c:\pwwork\FWIDOT\SWARTZRW\dms36208\sheladesign_94993.dgn		DRAWN -	REVISED -		SCALE: N/A	SHEET NO. 2 OF 12 SHEETS	STA.	TO STA.	70	D-7 BRIDGE DECK REPAIRS	FAYETTE	59 35
PLOT SCALE = 20,0000' / IN.		CHECKED -	REVISED -						CONTRACT NO. 94993			
PLOT DATE = 10/17/2008		DATE -	REVISED -						FED. ROAD DIST. NO. ILLINOIS FED. AID PROJECT			

SHEET NO. 2
12 SHEETS