

DATE	
BY	
FINAL SURVEY	SURVEYED
NOTE BOOK	TEMPLATE
NO.	AREAS CHECKED

DATE	
BY	
ORIGINAL SURVEY	SURVEYED
NOTE BOOK	TEMPLATE
NO.	AREAS CHECKED

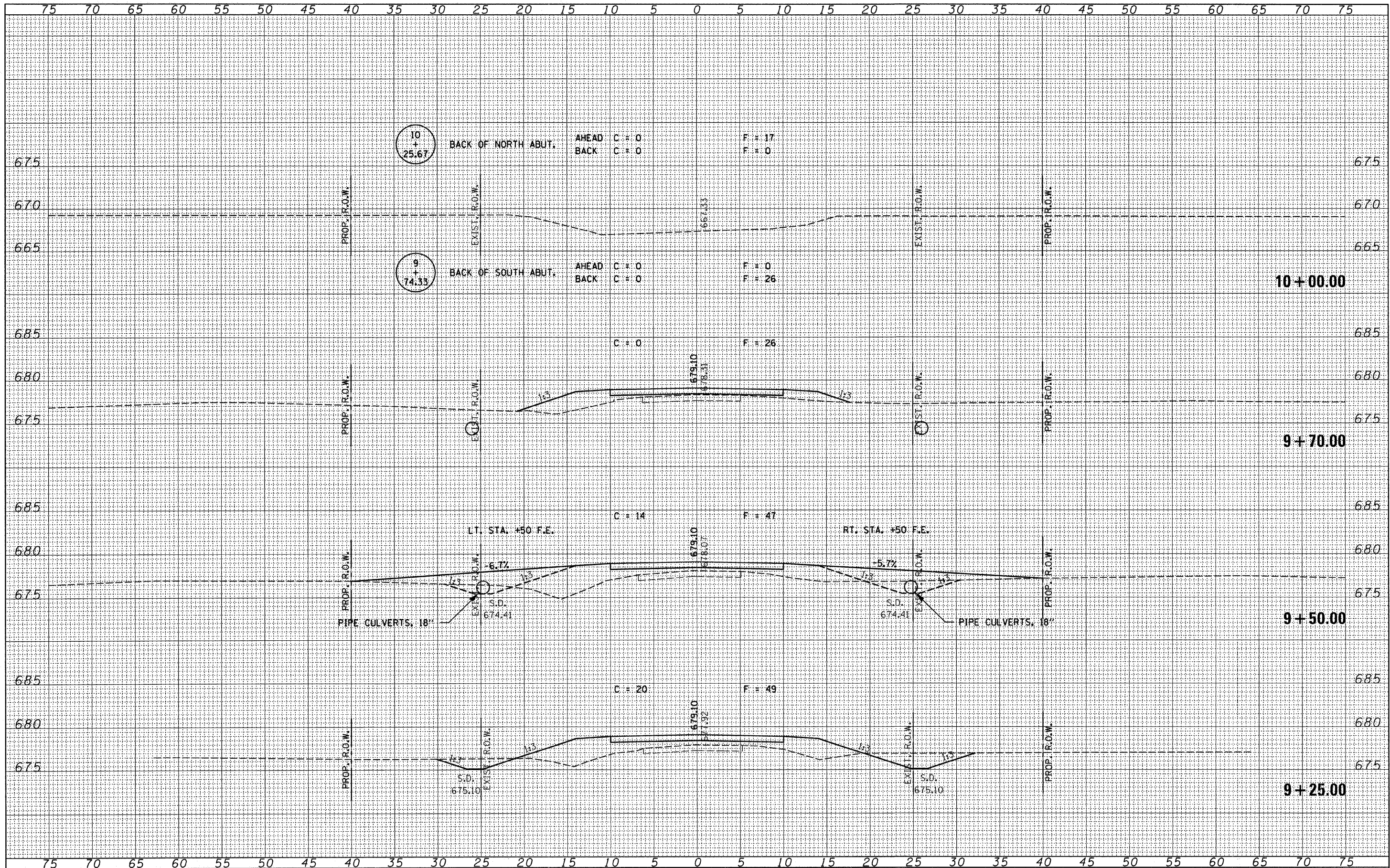

FILE NAME = 080894-ah1-ave.dgn

USER NAME =	DESIGNED - J.W.F.	REVISED -
PLOT SCALE =	DRAWN - D.T.M.	REVISED -
PLOT DATE = 10/29/2008	CHECKED - S.W.M.	REVISED - S.W.M.
	DATE - 04/08/08	REVISED - 10/29/08

STATE OF ILLINOIS
MOULTRIE COUNTY HIGHWAY DEPARTMENT

HLR HAMPTON, LENZINI & RENWICK, INC.
CIVIL & STRUCTURAL ENGINEERS
LAND SURVEYORS

**CROSS SECTIONS
LOWE ROAD DISTRICT**

T.R.	SECTION	COUNTY	TOTAL SHEETS	SHEET NO.
146	08-05125-00-BR	MOULTRIE	15	5
FED. ROAD DIST. NO.			ILLINOIS FED. AID PROJECT	

SCALE: SHEET NO. OF SHEETS STA. 9+25.00 TO STA. 10+00.00